

OWNER: RTA OF ALLON, L.L.C.
 ZONED: R3 - GARDEN APARTMENT & CONDO DISTRICT
 SUBDIVISION: N/A

TR HUGHES BOULEVARD
 (51' CONCRETE W/ CURB - R/W VARIES)

ARC=186.66'
 CH=N 82°12'41"E 185.72'
 R=535.96'

REVISION NOTE:
 1. REVISED SILT FENCE AND TREE PROTECTION BARRIER ON EAST SIDE

6.65 ACRES
 "NO BUILDINGS"

LOT 2 MEADOWLANDS

MEADOWLAND ESTATES LANE (PRIVATE DRIVE)
 (31' ASPHALT W/ CONCRETE ROLLBACK CURB & GUTTER)

ARHC ANGLIMOODI, L.L.C.
 ZONED: R4 - APARTMENT HOUSE DISTRICT
 & C2 - GENERAL BUSINESS DISTRICT
 SUBDIVISION: MEADOWLANDS

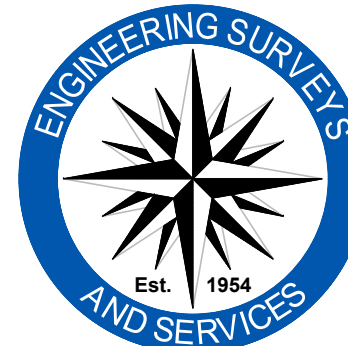

Engineering Surveys & Services
 Consulting Engineers, Land Surveyors, and Geoprosessionals
 Analytical and Material Laboratories
 1113 Ivy Street, Columbia, Missouri 65201
 573-449-2646 | www.ess-mo.com
 Other Offices:
 Jefferson City - Sedalia - Wildwood
 Missouri Engineering Corporation #200400018

MEADOWWOOD ESTATES
 LOT 1 - MEADOWWOOD ESTATES SUBDIVISION
 OF ALLON, ST. CHARLES COUNTY, MISSOURI

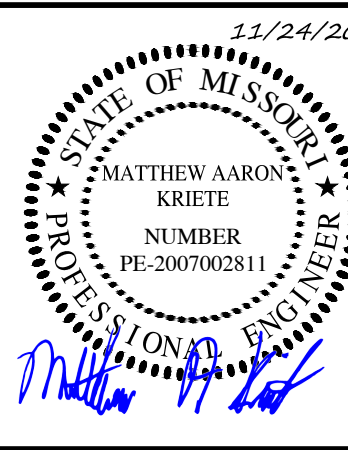

MATTHEW A. KRIETE
 PROFESSIONAL ENGINEER
 PE-200700281

IF ORIGINAL SIGNATURE OR DIGITAL AUTHENTICATION IS NOT PRESENT THIS MEDIA SHOULD NOT BE CONSIDERED A CERTIFIED DOCUMENT.

Date
MAY 22, 2020

Revised
1 JULY 14, 2020
2 CITY COMMENTS
3 NOVEMBER 24, 2020
4 ESJ #4

Design: KAH Draw: MJS

INITIAL EROSION CONTROL PLAN
 Sheet
C9.01