

REVISION NOTE:
 1. REVISED SILT FENCE AND TREE PROTECTION BARRIER ON EAST SIDE

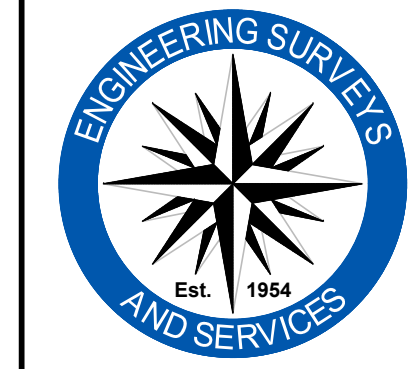

Engineering Surveys & Services
 Consulting Engineers, Land Surveyors, and Geoprosessionals
 Analytical and Material Laboratories
 1113 Ivy Street, Columbia, Missouri 65201
 573-449-2646 | www.ess-inc.com
 Other Offices:
 Jefferson City - Sedalia - Wildwood
 Missouri Engineering Corporation #200400018

MEADOWWOOD ESTATES
 LOT 1 - MEADOWWOOD ESTATES SUBDIVISION
 OF FALLON, ST. CHARLES COUNTY, MISSOURI

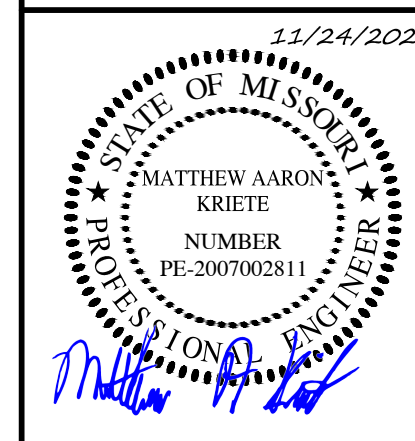

MATTHEW A. KRIETE
 PROFESSIONAL ENGINEER
 PE-200700281

IF ORIGINAL SIGNATURE OR DIGITAL AUTHENTICATION IS NOT PRESENT THIS MEDIA SHOULD NOT BE CONSIDERED A CERTIFIED DOCUMENT

Date
MAY 22, 2020

Revised
 JULY 14, 2020
 CITY COMMENTS
 NOVEMBER 24, 2020
 ESJ #4

Design: KAH Drawn: MJS
INITIAL EROSION CONTROL PLAN

Sheet
C9.02

ES&S PROJECT NO. 14481

Y:\CURRENTDRAWINGS\14481\14481_02\EROSION.DWG 11/24/2020

PLANNING & ZONING #20-002498 APPROVED MAY 7, 2020