

Notes:  
1- See planting soil specifications for additional requirements.

**MODIFIED EXISTING SOIL - COMPACTED SURFACE SOIL** URBAN TREE FOUNDATION © 2014 OPEN SOURCE FREE TO USE

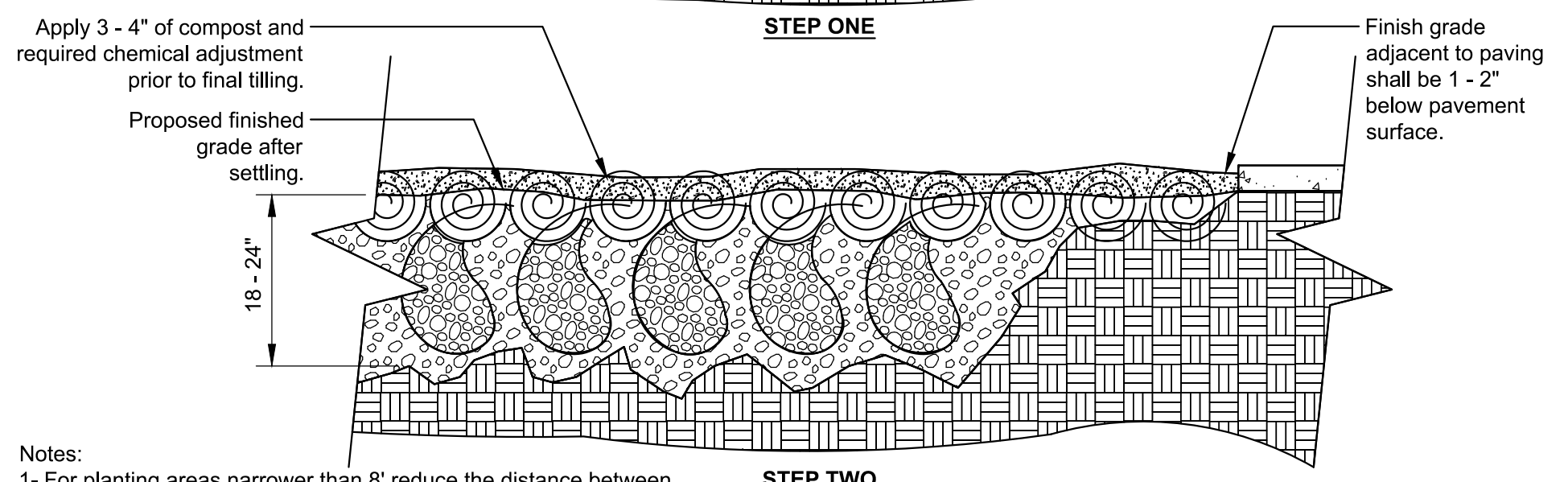
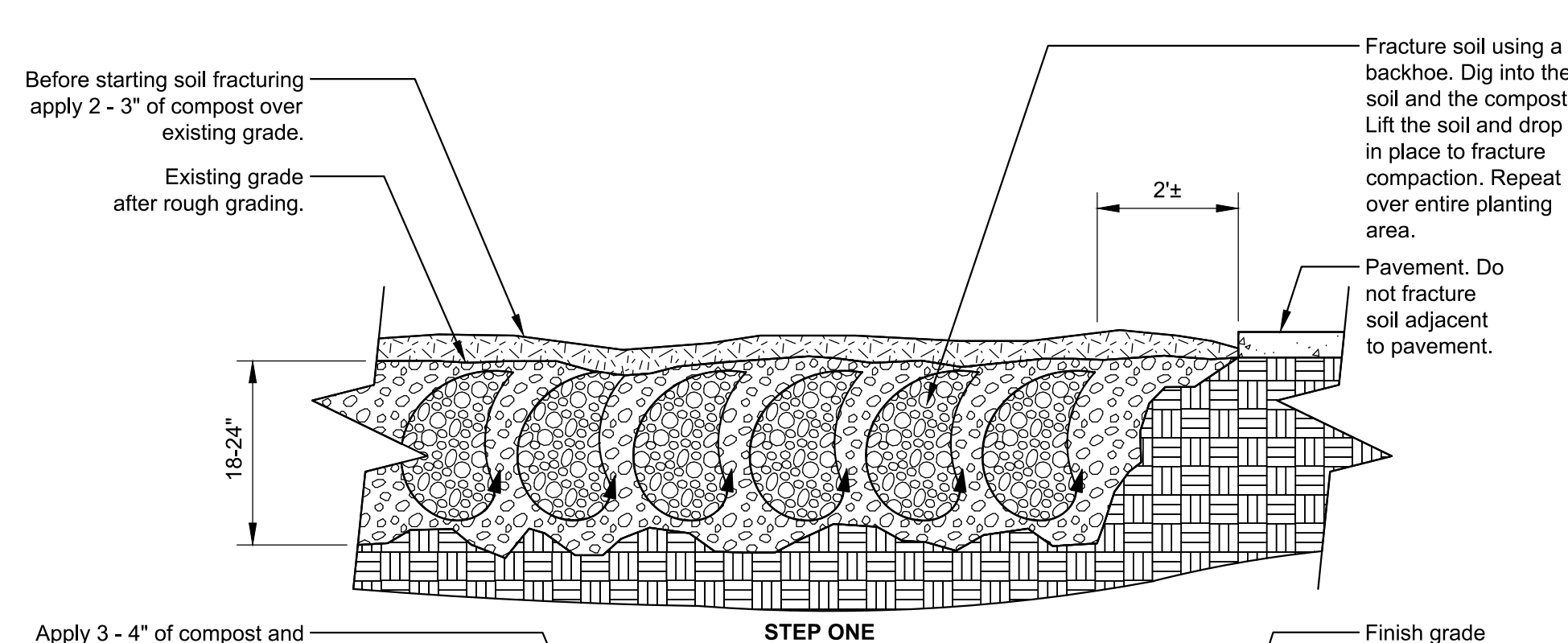

Notes:  
1- For planting areas narrower than 8' reduce the distance between paving and soil fracturing from 2' to 1'.  
2- See planting soil specification for additional requirements.

**MODIFIED EXISTING SOIL - COMPACTED SUB SOIL (FRACTURING)** URBAN TREE FOUNDATION © 2014 OPEN SOURCE FREE TO USE

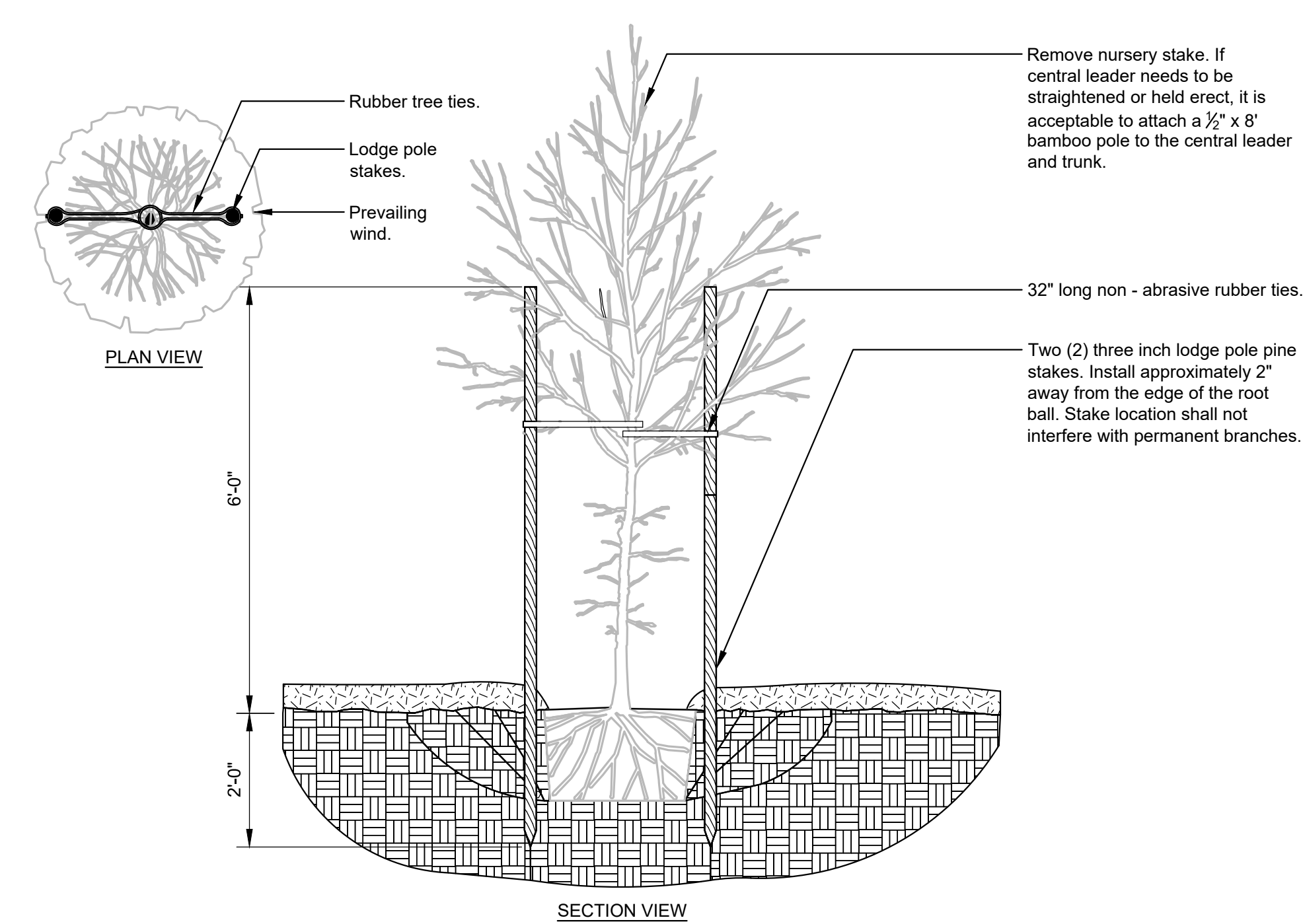

**TREE STAKING - LODGE POLES (2)** URBAN TREE FOUNDATION © 2014 OPEN SOURCE FREE TO USE

**LANDSCAPING NOTES**

1. ALL TRANSFORMERS, A/C UNITS, AND OTHER VISIBLE UTILITIES TO BE SCREENED WITH PLANT MATERIAL. (SET UP ON SITE)
2. ALL PLANTING BEDS TO BE MULCH.
3. ALL LAWN AREAS TO BE SOD AROUND & WITHIN 15 FEET OF BUILDINGS AND WALKS.
4. BUFFER ZONE TO BE SEED AND STRAW.
5. ALL AREAS TO BE IRRIGATED.

**TREE NOTE**

| LOT 1 CONSTRUCTION                        | WHOLE SITE |
|---|------------|
| LOT 1 EXISTING TREE MASS                  | 0.30 ACRES |
| LOT 1 TREE MASS REMOVED                   | 0.30 ACRES |
| REMAINDER OF SITE TREE MASS REMOVED       | 0.99 ACRES |
| TOTAL TREE REMOVAL FOR LOT 1 CONSTRUCTION | 1.29 ACRES |
| EXISTING TREE MASS                        | 9.59 ACRES |
| TREE MASS REMOVED                         | 1.29 ACRES |
| TOTAL MASS PRESERVED                      | 8.30 ACRES |
| 20% TOTAL MASS TO BE PRESERVED            | 1.66 ACRES |

NEW TREES PROVIDED ARE SHOWN IN THE LANDSCAPE PLAN. SEE MEADOWOOD ESTATES FINAL PLAN FOR DETAILS ON THE WHOLE SITE TREE PRESERVATION PLAN.

SENIOR COMMUNITY PARKING FACILITIES (CODE 400.162.E.3.d)

| LOCATION | PARKING STALLS | REQUIRED TREES PER PARKING SPACE | REQUIRED TREES | PROVIDED TREES |
|----------|----------------|----------------------------------|----------------|----------------|
| LOT 1    | 95             | 2 TREES/3 SPACES                 | 64             | 64             |

STREET FRONTAGE TREES (CODE 402.080 & 402.090)

| STREET FRONTAGE                              | LENGTH (FT) | REQUIRED TREE PER LENGTH | REQUIRED TREES | PROVIDED TREES |
|--|-------------|--------------------------|----------------|----------------|
| R4 ZONED PORTION ALONG TR HUGHES BLVD        | 154         | 1:50 FT                  | 3              | 4              |
| C2 ZONED PORTION ALONG TR HUGHES BLVD        | 190         | 1:40 FT                  | 5              | 5              |
| R4 ZONED PORTION ALONG MEADOWLAND ESTATES LN | 269         | 1:50 FT                  | 5              | 7              |
| C2 ZONED PORTION ALONG MEADOWLAND ESTATES LN | 297         | 1:40 FT                  | 7              | 7              |

TREE SCHEDULE

| LABEL                                   | QTY | COMMON NAME                 | BOTANICAL NAME                                    | MATURE HEIGHT (ft) |
|---|-----|-----------------------------|---|--------------------|
| <b>LARGE DECIDUOUS CANOPY TREES</b>     |     |                             |   |                    |
| WO                                      | 3   | WHITE OAK                   | QUERCUS ALBA                                      | 50-80              |
| RO                                      | 3   | NORTHERN RED OAK            | QUERCUS RUBRA                                     | 50-75              |
| KC                                      | 3   | KENTUCKY COFFEE TREE        | GYMNOCLADUS DIOICUS 'PRAIRIE TITAN' OR 'ESPRESSO' | 60-80              |
| <b>MEDIUM DECIDUOUS CANOPY TREES</b>    |     |                             |   |                    |
| HB                                      | 10  | HERITAGE RIVER BIRCH        | BETULA NIGRA 'HERITAGE'                           | 40-70              |
| RM                                      | 8   | RED SUNSET RED MAPLE        | ACER RUBRUM 'RED SUNSET'                          | 40-50              |
| HH                                      | 9   | AMERICAN HOP HORNBEAM       | Ostrya virginiana                                 | 25-40              |
| BG                                      | 10  | BLACK GUM                   | NYSSA SYLVATICA 'WILDFIRE'                        | 30-50              |
| <b>ORNAMENTAL DECIDUOUS SHADE TREES</b> |     |                             |   |                    |
| CP                                      | 8   | PRAIRIFIRE CRABAPPLE        | MALUS 'PRAIRIFIRE'                                | 15-20              |
| RB                                      | 4   | EASTERN REDBUD              | CERCIS CANADENSIS                                 | 20-30              |
| FT                                      | 4   | FRINGETREE                  | CHIONANTHUS VIRGINICUS                            | 12-20              |
| CA                                      | 6   | CRABAPPLE 'ADIRONDACK'      | MALUS ADIRONDACK                                  | 12                 |
| <b>EVERGREEN TREE</b>                   |     |                             |   |                    |
| AA                                      | 13  | AMERICAN ARBORVITAE         | THUJA OCCIDENTALIS 'HOLMSTRUP'                    | 12-14              |
| HC                                      | 5   | HILLSPIRE EASTERN RED CEDAR | JUNIPERUS VIRGINIANA 'HILLSPIRE'                  | 15-30              |
| GG                                      | 3   | GREEN GIANT ARBORVITAE      | THUJA 'GREEN GIANT'                               | 40-60              |
| JS                                      | 0   | JUNIPER 'SKYROCKET'         | JUNIPERUS SCOPULORUM 'SKYROCKET'                  | 15-20              |

SHRUB SCHEDULE

| LABEL                   | QTY | COMMON NAME                   | BOTANICAL NAME                                 |
|-------------------------|-----|-------------------------------|--|
| <b>DECIDUOUS SHRUBS</b> |     |                               |  |
| HM                      | 69  | MUNCHKIN HYDRANGEA            | HYDRANGEA QUERCIFOLIA 'MUNCHKIN'               |
| NJ                      | 24  | NEW JERSEY TEA                | CEANOTHUS AMERICANUS                           |
| GB                      | 50  | INKBERRY HOLLY                | ILEX GLABRA 'GEM BOX'                          |
| LH                      | 41  | VIRGINA SWEETSPIRE            | ITEA VIRGINICA 'SPRICH' LITTLE HENRY           |
| LG                      | 62  | LITTLE GIANT DWARF ARBORVITAE | THUJA OCCIDENTALIS 'LITTLE GIANT'              |
| BB                      | 21  | BUTTON BUSH 'SUGAR SHACK'     | CEPHALANTHUS OCCIDENTALIS 'SMCOSS' SUGAR SHACK |
| WJ                      | 13  | WINTERBERRY 'JIM DANDY'       | ILEX VERTICILLATA 'JIM DANDY'                  |
| WS                      | 81  | WINTERBERRY 'RED SPRITE'      | ILEX VERTICILLATA 'NANA' RED SPRITE            |

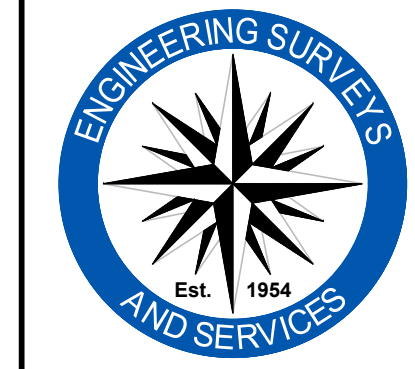

Engineering Surveys & Services  
Consulting Engineers, Land Surveyors, and Geoprosessionals  
Analytical and Material Laboratories  
1113 Ivy Street, Columbia, Missouri 65201  
573-449-2646 | www.ess-inc.com  
Other Offices: Jefferson City - Sedalia - Wildwood  
Missouri Engineering Corporation # 200400018

**MEADOWOOD ESTATES - PHASE I**  
LOT 1 - MEADOWOOD ESTATES SUBDIVISION  
OFALLON, ST. CHARLES COUNTY, MISSOURI

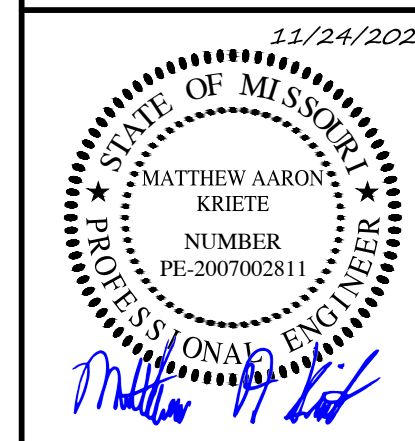

MATTHEW A. KRIETE  
PROFESSIONAL ENGINEER  
PE-2007002811

IF ORIGINAL SIGNATURE OR DIGITAL AUTHENTICATION IS NOT PRESENT THIS MEDIA SHOULD NOT BE CONSIDERED A CERTIFIED DOCUMENT.

Date  
**MAY 22, 2020**

Revised

|   |                   |               |
|---|-------------------|---------------|
| 1 | JULY 14, 2020     | CITY COMMENTS |
| 2 | NOVEMBER 2, 2020  | ESI #3        |
| 3 | NOVEMBER 24, 2020 | ESI #4        |

Design: KH Drawn: MJS

LANDSCAPE PLAN

Sheet

**L1.04**

ES&S PROJECT NO. 14481