

**ASPHALT PAVEMENT DETAIL (HEAVY DUTY)**  
N.T.S.

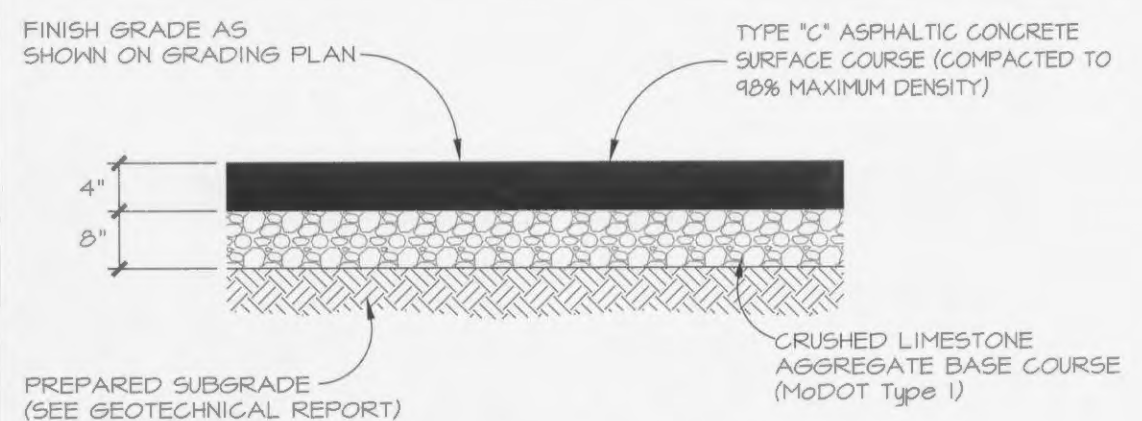

**ASPHALT PAVEMENT DETAIL (MEDIUM DUTY)**  
N.T.S.

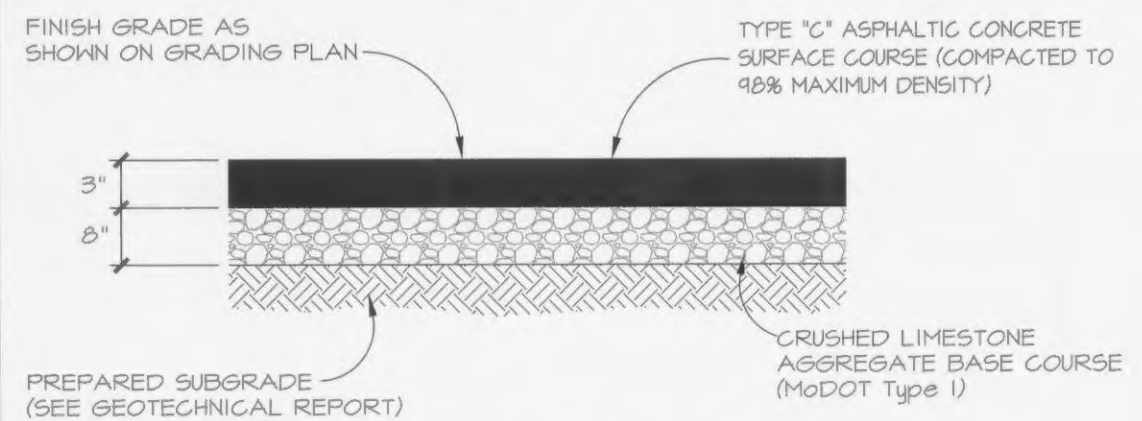

**ASPHALT PAVEMENT DETAIL (STANDARD DUTY)**  
N.T.S.

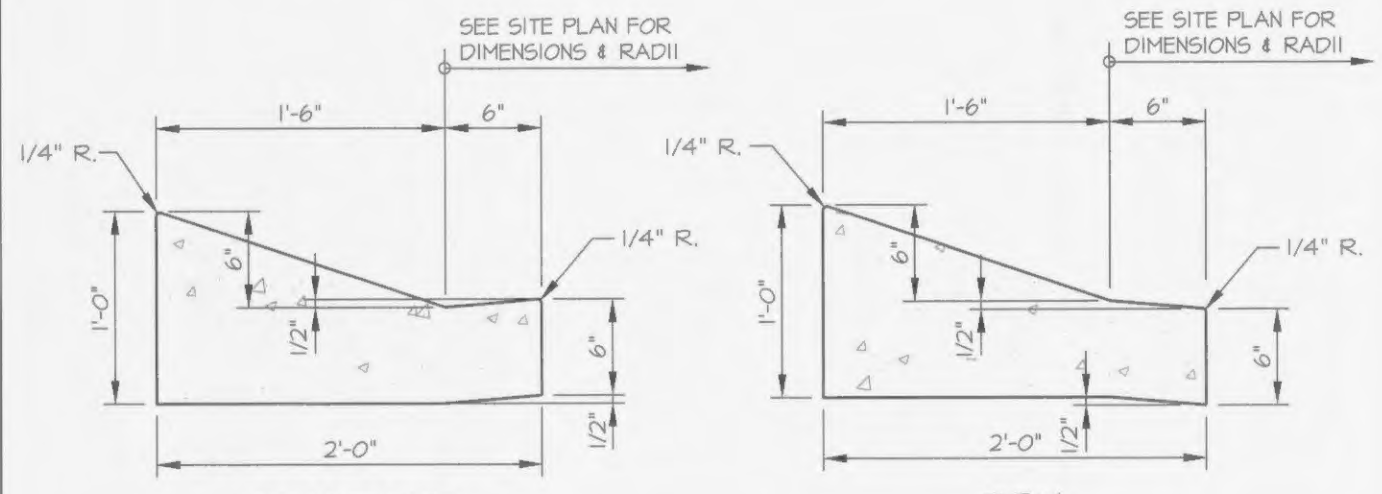

**SLANT CURB & GUTTER**  
N.T.S.

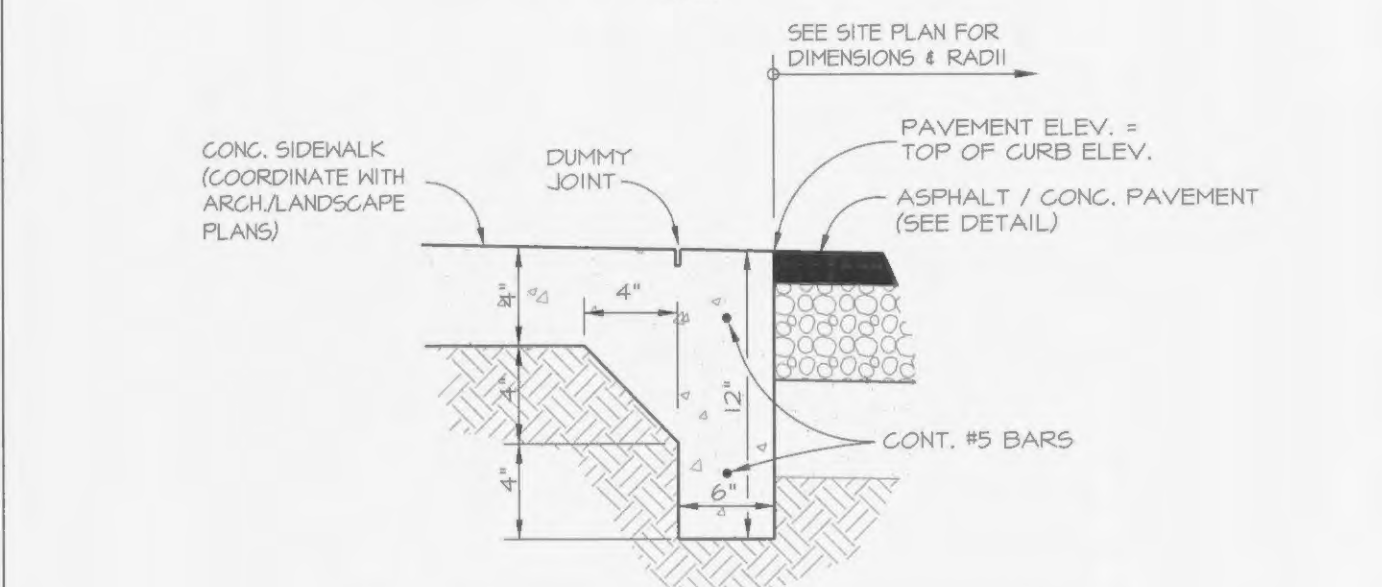

**FLUSH / RECESSED CURB DETAIL**  
N.T.S.

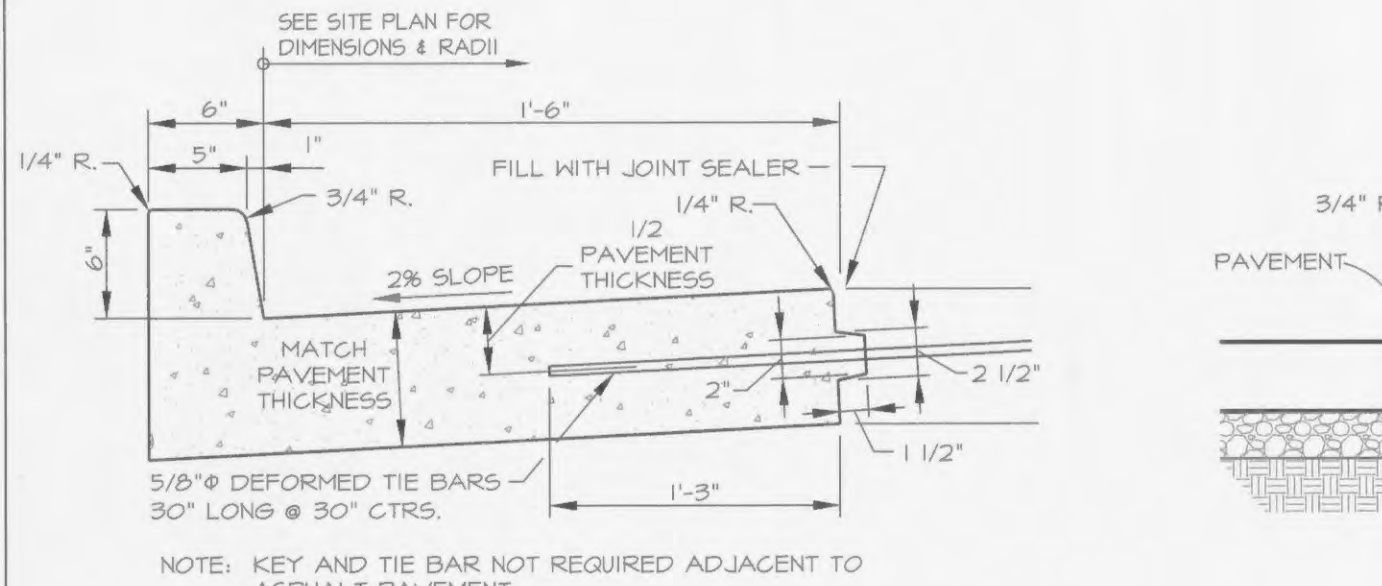

**VERTICAL CURB AND GUTTER**  
N.T.S.

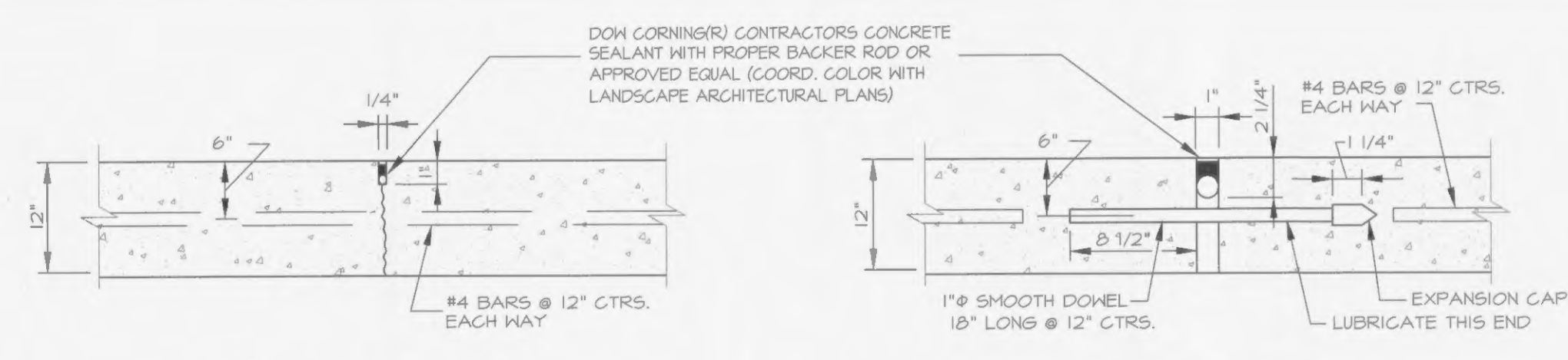

**CONTROL JOINT** and **EXPANSION JOINT**

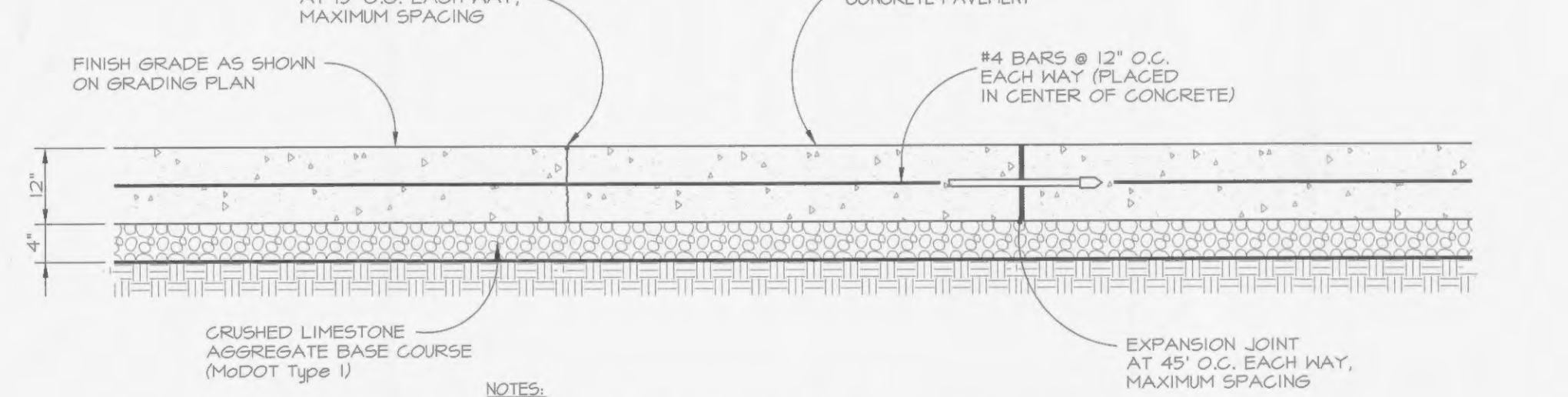

**CONCRETE PAVEMENT DETAILS (M.R.I. PAD)**  
N.T.S.

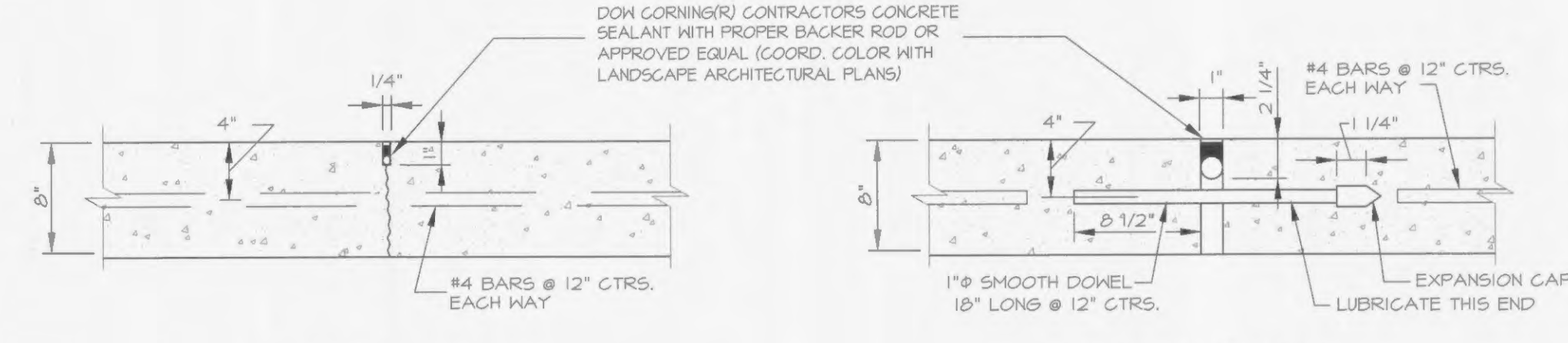

**CONTROL JOINT** and **EXPANSION JOINT**

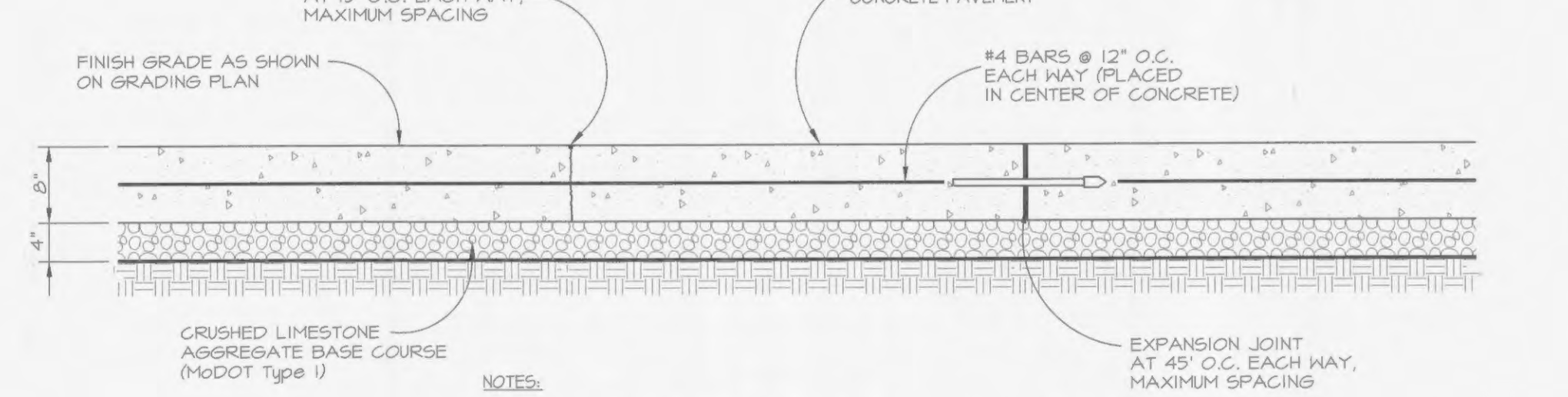

**CONCRETE PAVEMENT DETAILS**  
N.T.S.

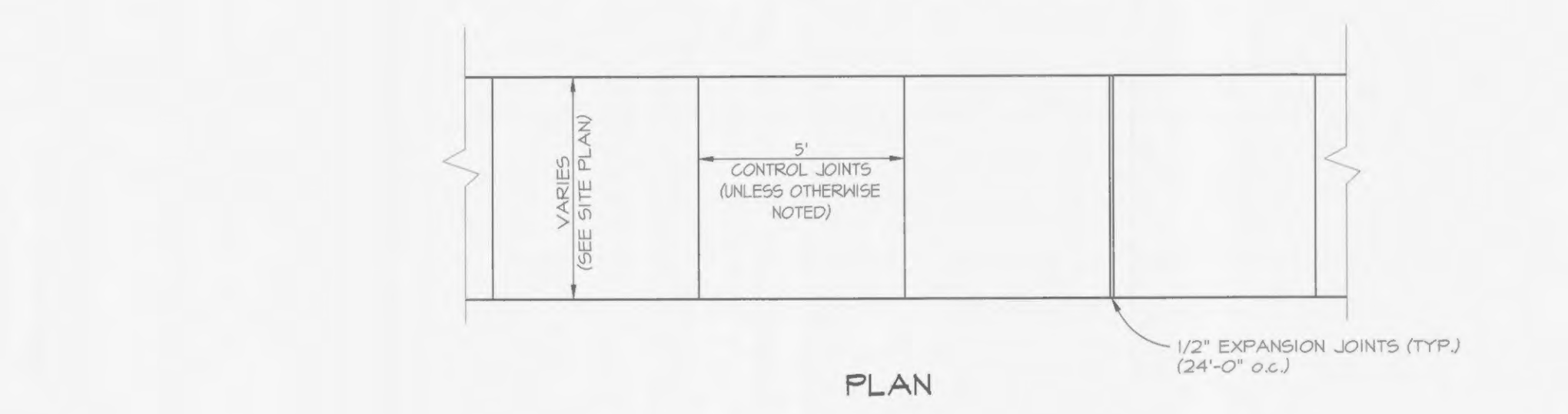

**CONCRETE SIDEWALK / PATIO DETAIL**  
N.T.S.

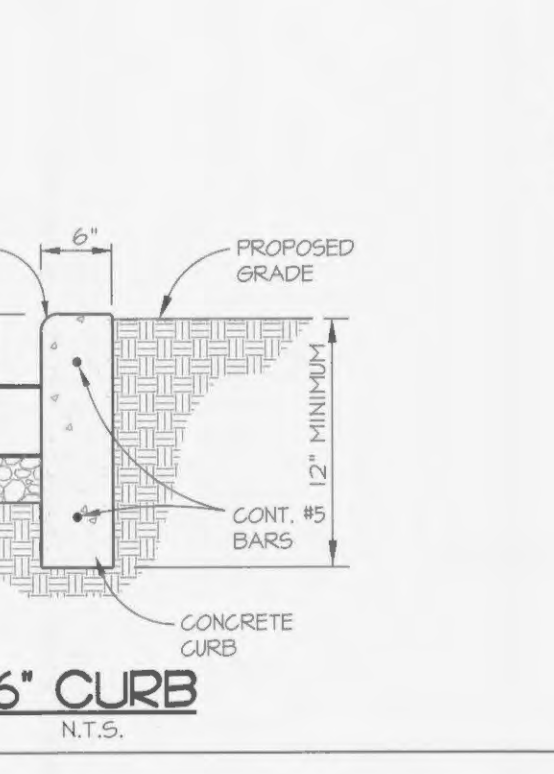

**6\"/>**

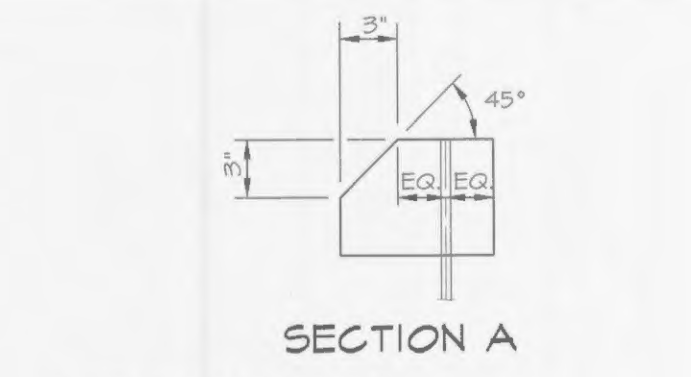

**SECTION A**

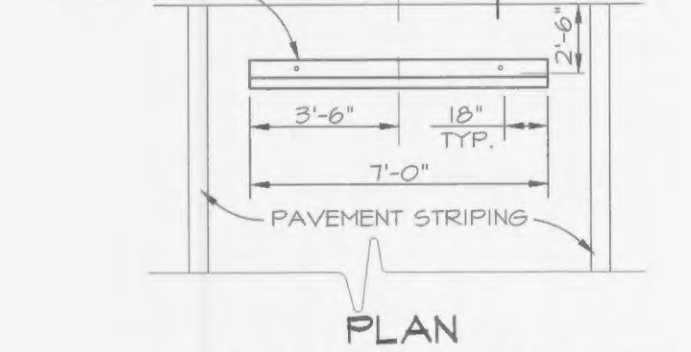

**PLAN PRECAST CONCRETE WHEEL STOP**  
N.T.S.

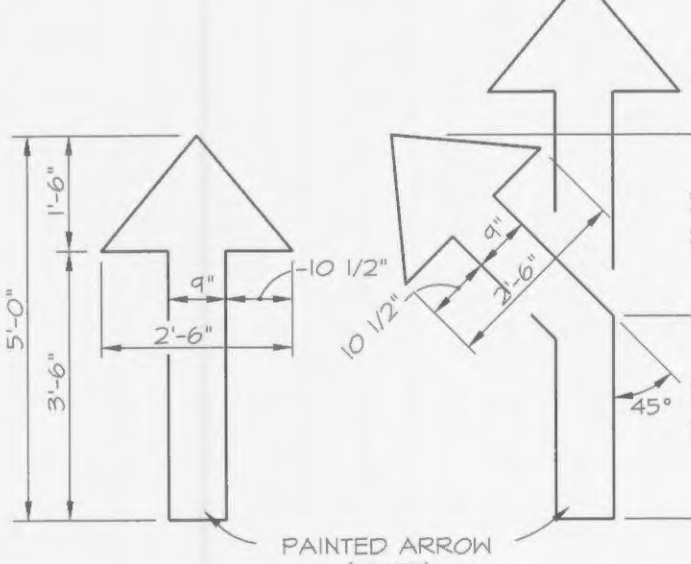

**PAINTED DIRECTIONAL ARROW**  
N.T.S.

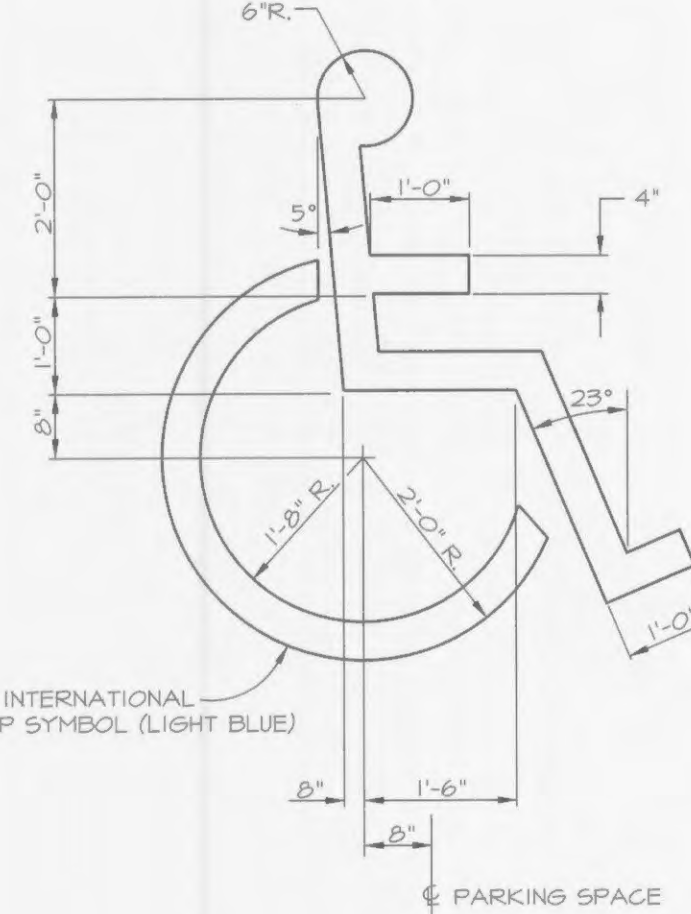

**INTERNATIONAL HANDICAP SYMBOL**  
N.T.S.

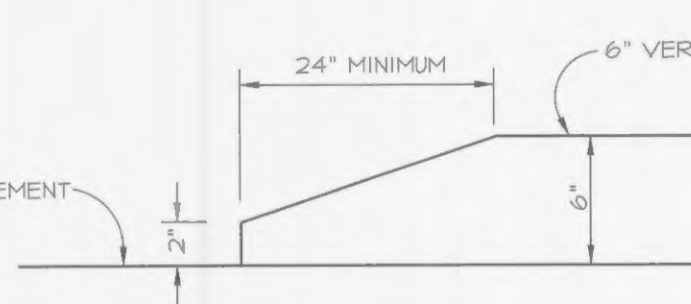

**CURB TERMINUS DETAIL**  
N.T.S.

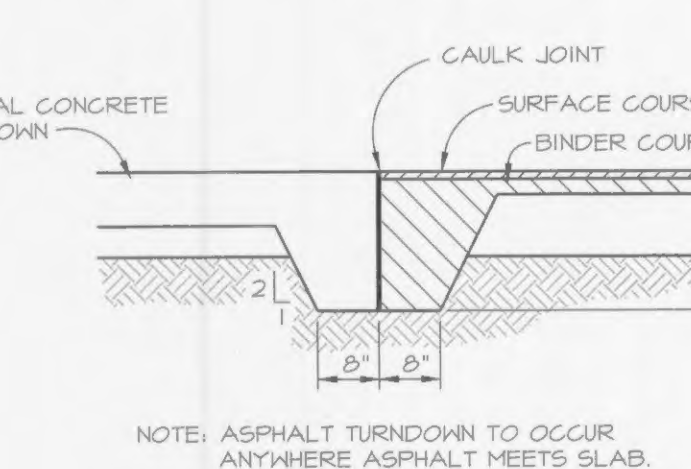

**ASPHALT TURNDOWN**  
N.T.S.

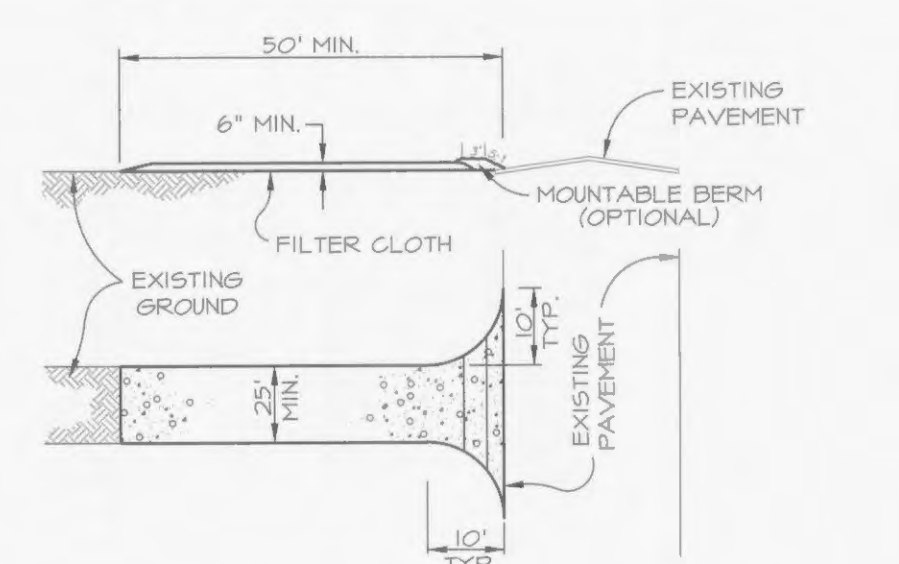

**STABILIZED CONSTRUCTION ENTRANCE / WASH DOWN AREA**  
N.T.S.

- NOTES:**
- ALL TRUCKS MUST BE WASHED DOWN PRIOR TO LEAVING THE SITE.
  - STONE SIZE, USE 2" STONE OR RECLAIMED OR RECYCLED CONCRETE EQUIVALENT.
  - LENGTH, AS REQUIRED, BUT NOT LESS THAN FIFTY (50) FEET.
  - THICKNESS, NOT LESS THAN SIX (6) INCHES.
  - WIDTH, TWENTY-FIVE (25) FOOT MINIMUM, BUT NOT LESS THAN THE FULL WIDTH AT POINTS WHERE INGRESS OR EGRESS OCCURS.
  - FILTER CLOTH, WILL BE PLACED OVER THE ENTIRE AREA PRIOR TO PLACING OF THE STONE.
  - SURFACE WATER, ALL SURFACE WATER FLOWING OR DIVERTED TOWARD CONSTRUCTION ENTRANCES SHALL BE PIPED ACROSS THE ENTRANCE. IF PIPING IS IMPRACTICAL, A MOUNTABLE BERM WITH A 5:1 SLOPE WILL BE PERMITTED.
  - MAINTENANCE, THE ENTRANCE SHALL BE MAINTAINED IN A CONDITION WHICH WILL PREVENT TRACKING OR FLOWING OF SEDIMENT ONTO A PUBLIC RIGHT-OF-WAY. THIS MAY REQUIRE PERIODIC TOP DRESSING WITH ADDITIONAL STONE AS CONDITIONS DEMAND AND REPAIR AND/OR CLEAN OUT OF ANY MEASURES SHALL TO TRAP SEDIMENT. ALL EXCESSIVE SEDIMENT SPILLED, DROPPED, WASHED OR TRACKED ONTO THE PUBLIC RIGHT-OF-WAY MUST BE REMOVED PROMPTLY.
  - PERIODIC INSPECTION AND NEEDED MAINTENANCE SHALL BE PROVIDED AFTER EACH RAIN.

**STABILIZED CONSTRUCTION ENTRANCE / WASH DOWN AREA**  
N.T.S.

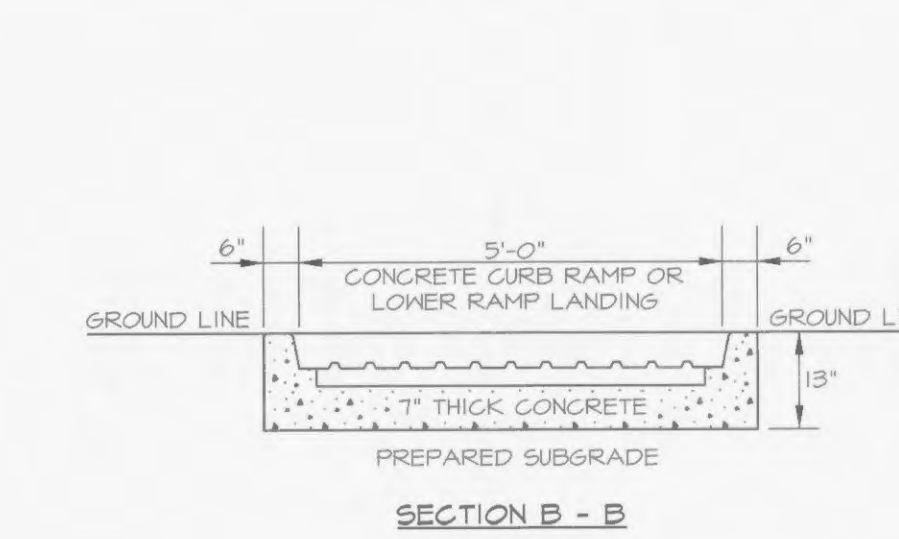

**SECTION B - B**

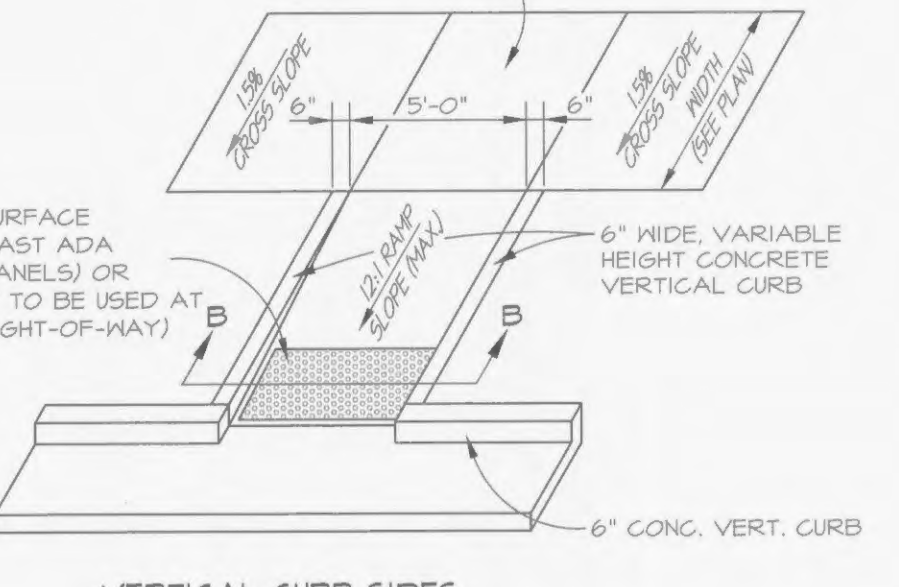

**VERTICAL CURB SIDES**

- GENERAL NOTES:**
- DO NOT SCALE DRAWINGS, FOLLOW DIMENSIONS.
  - SIDEWALKS, CURB RAMPS & CROSSWALKS SHALL BE CONSTRUCTED IN ACCORDANCE WITH THESE DETAILS AND THE CURRENT APPROVED "AMERICANS WITH DISABILITY ACT (ADA) STANDARDS FOR ACCESSIBLE DESIGN". FOR AREAS WITHIN MoDOT'S RIGHT-OF-WAY REFER TO MoDOT'S ERS (ENGINEERING POLICY) GUIDE (642).
  - MAXIMUM SIDEWALK CROSS SLOPE 0.02' / FT.
  - ALL SIDEWALK SECTIONS SHALL BE 4" THICK, EXCEPT WHERE OTHERWISE NOTED.
  - WHERE CURB RAMP MEETS PAVEMENT, BULLNOSE WILL NOT BE PERMITTED.
  - IF INTEGRAL CONCRETE CURB IS CONSTRUCTED, STRIKE A DUMMY JOINT ACROSS BOTTOM OF RAMP AT CURB LINE. IF CONCRETE CURB IS DOWN-ON, BLOCK OUT PAVEMENT TO PROVIDE FULL DEPTH CURB ACROSS RAMP FROM OUTER POINT OF CURB TAPER TO OUTER POINT OF CURB TAPER.

**CURB RAMP DETAILS**  
N.T.S.

No.	Date	Revision
1	11/01/2012	MoDOT COMMENTS
-	-	-
-	-	-
-	-	-
-	-	-

**MERCY CLINIC - WINGHAVEN BLVD.**  
2223 Technology Dr.  
O'Fallon, Missouri 63366

**HEIDEMAN ASSOCIATES, INC.**  
A Zaki Company  
13545 Barrett Parkway Drive p. 314.822.2217  
Suite 200 St. Louis, Missouri 63021 www.zakicompanies.com  
Contact: Dennis Pruitt  
e-mail: dpruitt@zakicompanies.com

**Michael J. Velloff**  
Professional Engineer  
No. E-2000161862

**MercyT**  
SMS JOB NUMBER: 1510-153209-0521  
DATE: 2012-10-05  
SCALE: NOTED

**TEA PROPERTIES MISSOURI, LLC**  
NAME: 600 WASHINGTON AVENUE, 15TH FLOOR  
ADDRESS: ST. LOUIS, MO 63101-1313  
CONTACT: ELIZABETH A. MURPHY, C/O SANDBERG PHOENIX & VON GONTARD, P.C.  
PHONE: (314) 446-4262  
FAX: (314) 241-7604  
E-MAIL: emurphy@sandbergphoenix.com

P+Z No. 983162  
Approved Sept. 6, 2012  
Page No.

**C15**