

- LEGEND:**
- 4" ASPHALT OVER 8" ROCK
  - 4" CONCRETE OVER 4" ROCK
  - 7" CONCRETE OVER 4" ROCK
  - 2% MAX. CROSS SLOPE

**Entrance Detail**  
SCALE: 1"=10'

- ENTRANCE DETAIL NOTES:**
1. ALL ELEVATIONS ARE TOP OF PAVEMENT.
  2. ALL DIMENSIONS ARE TO FACE OF CURB.
  3. "A" = EXISTING ELEVATION  
"SW" = TOP OF SIDEWALK
  4. ENTRANCE DRIVE SHALL NOT EXCEED 2% CROSS SLOPE ACROSS CONTINUATION OF TRAIL THROUGH DRIVE.

UNDERGROUND UTILITIES HAVE BEEN PLOTTED FROM AVAILABLE INFORMATION AND THEREFORE THEIR LOCATIONS SHALL BE CONSIDERED APPROXIMATE ONLY. THE VERIFICATION OF THE LOCATION OF ALL UNDERGROUND UTILITIES, EITHER SHOWN OR NOT SHOWN ON THESE PLANS SHALL BE THE RESPONSIBILITY OF THE CONTRACTOR, AND SHALL BE LOCATED PRIOR TO ANY GRADING OR CONSTRUCTION OF THE IMPROVEMENTS.



**CALL BEFORE YOU DIG!**  
1-800-DIG-RITE

**616.8.10 (TA-10) Lane Closure on Two-Lane Highways With Edgelines Using Flaggers - MT**

SPEED Posted (mph)	SIGN SPACING (ft.) Undivided (S)	Divided (D)	SHOULDER (ft.) (T1)	(T2)	OPTIONAL BUFFER LENGTH (ft.) (B)	CHANNERIZER SPACING (ft.) Tapers	Work Areas
0-35	200	-	-	-	280	-	40
40-45	350	-	-	-	400	-	80
50-55	500	-	-	-	560	-	80
60-70	1000	-	-	-	840	-	120

1 Shoulder taper length based on 10 ft. (standard shoulder width) offset. 2. Lane taper length based on 12 ft. (standard lane width) offset.

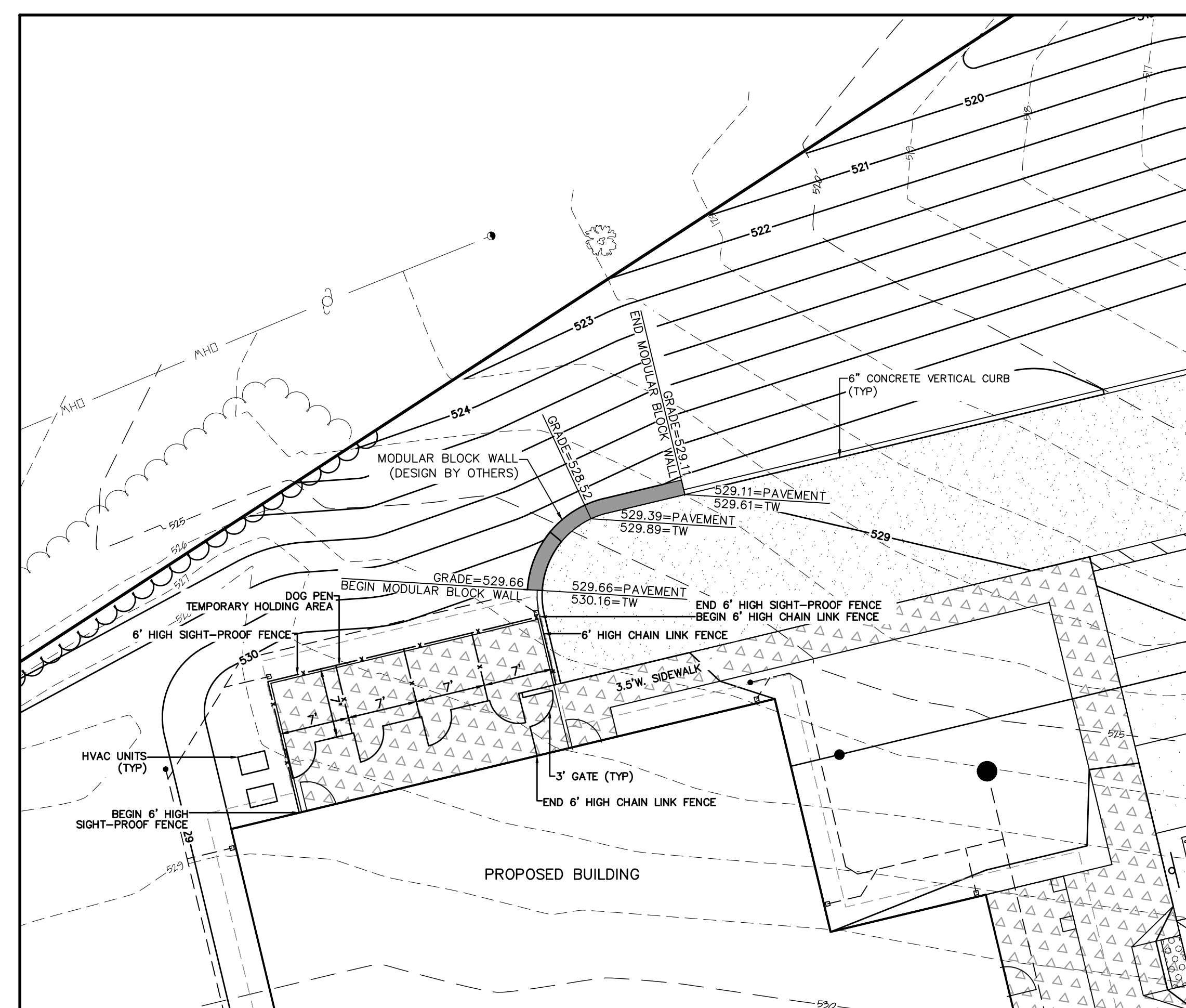
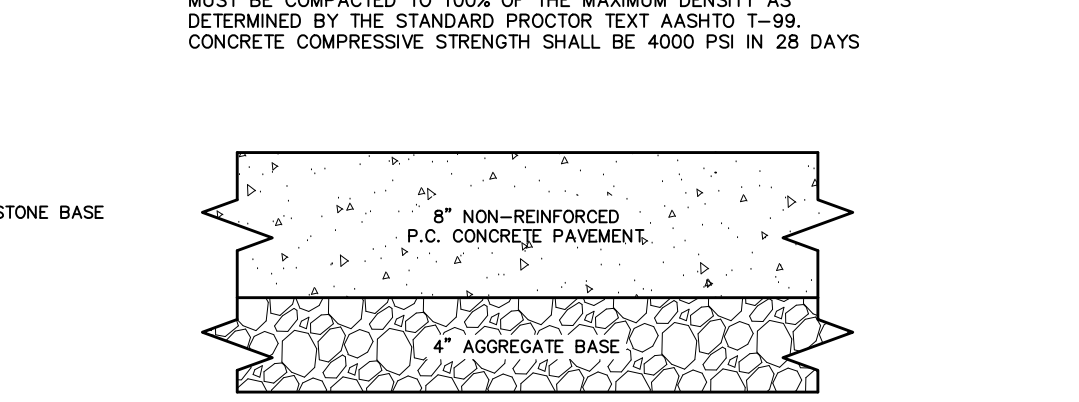
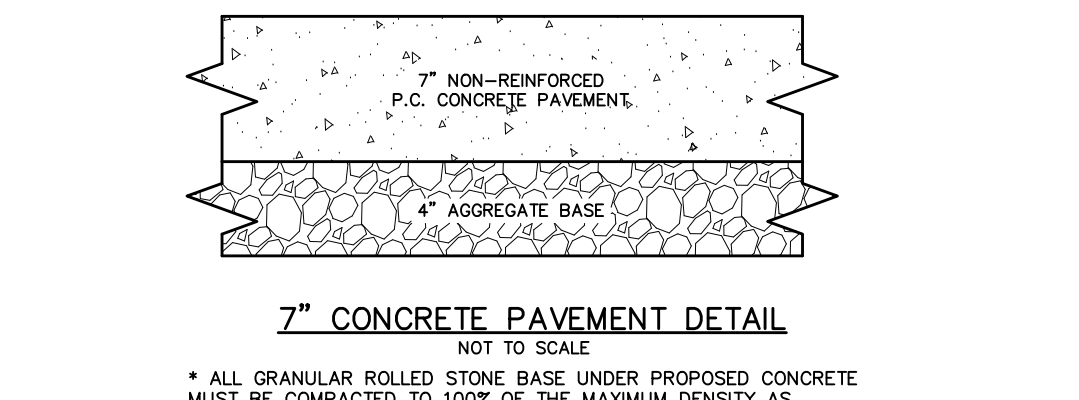
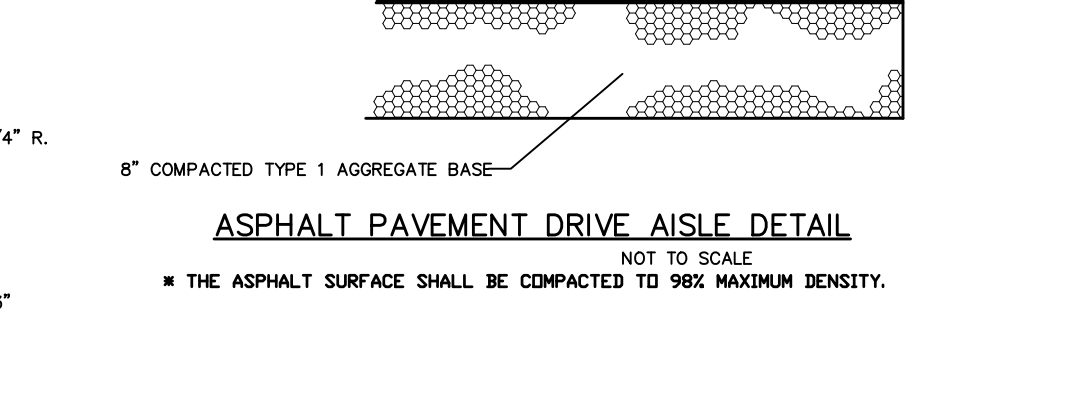
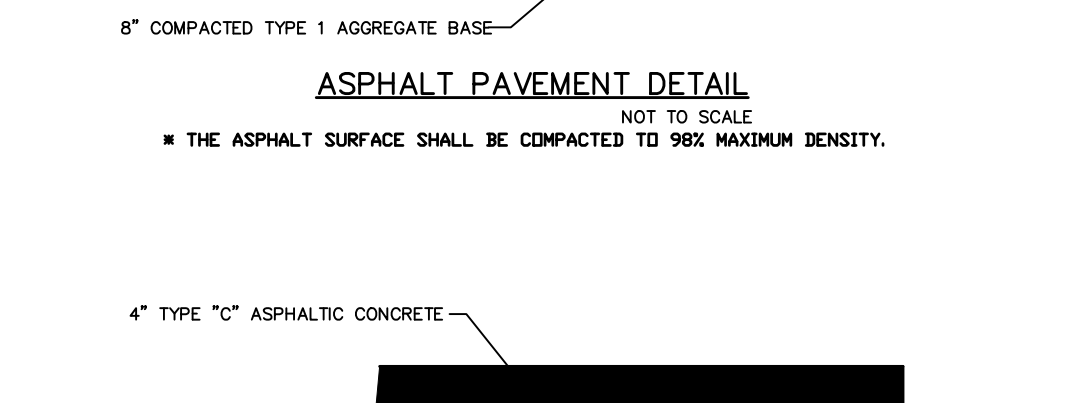
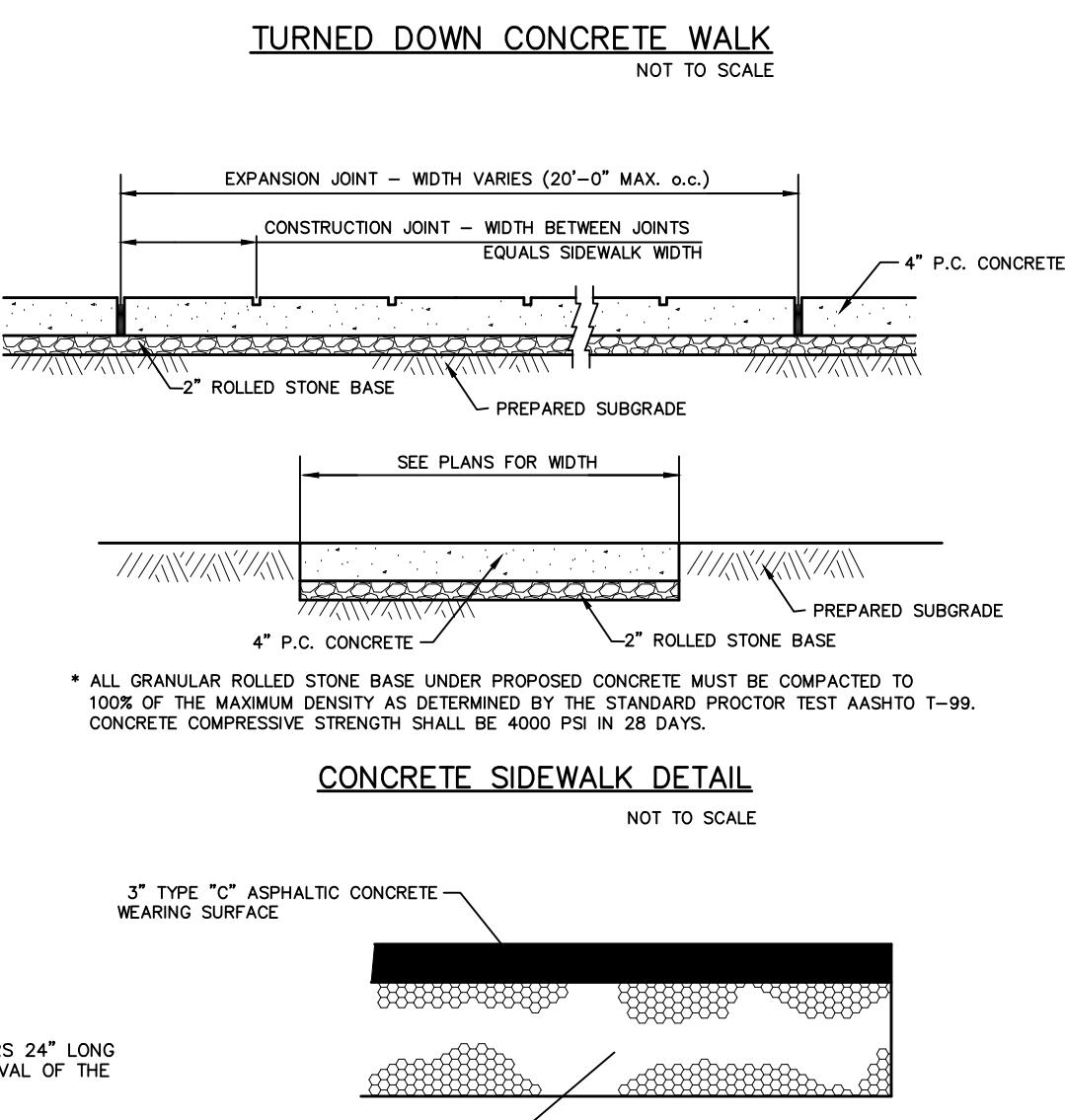
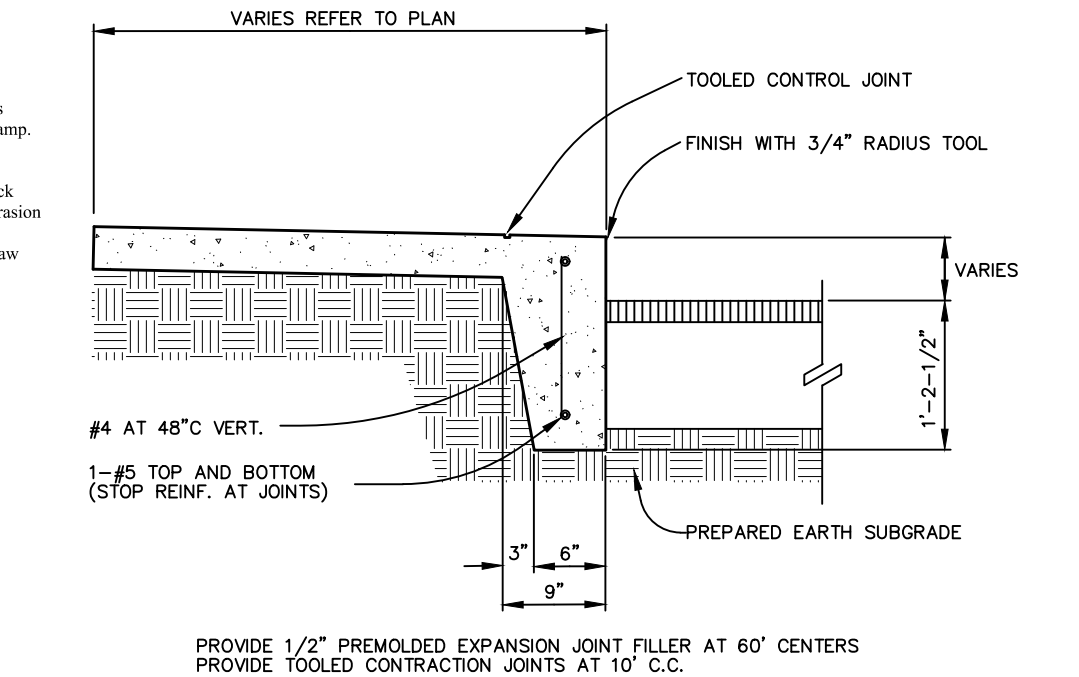
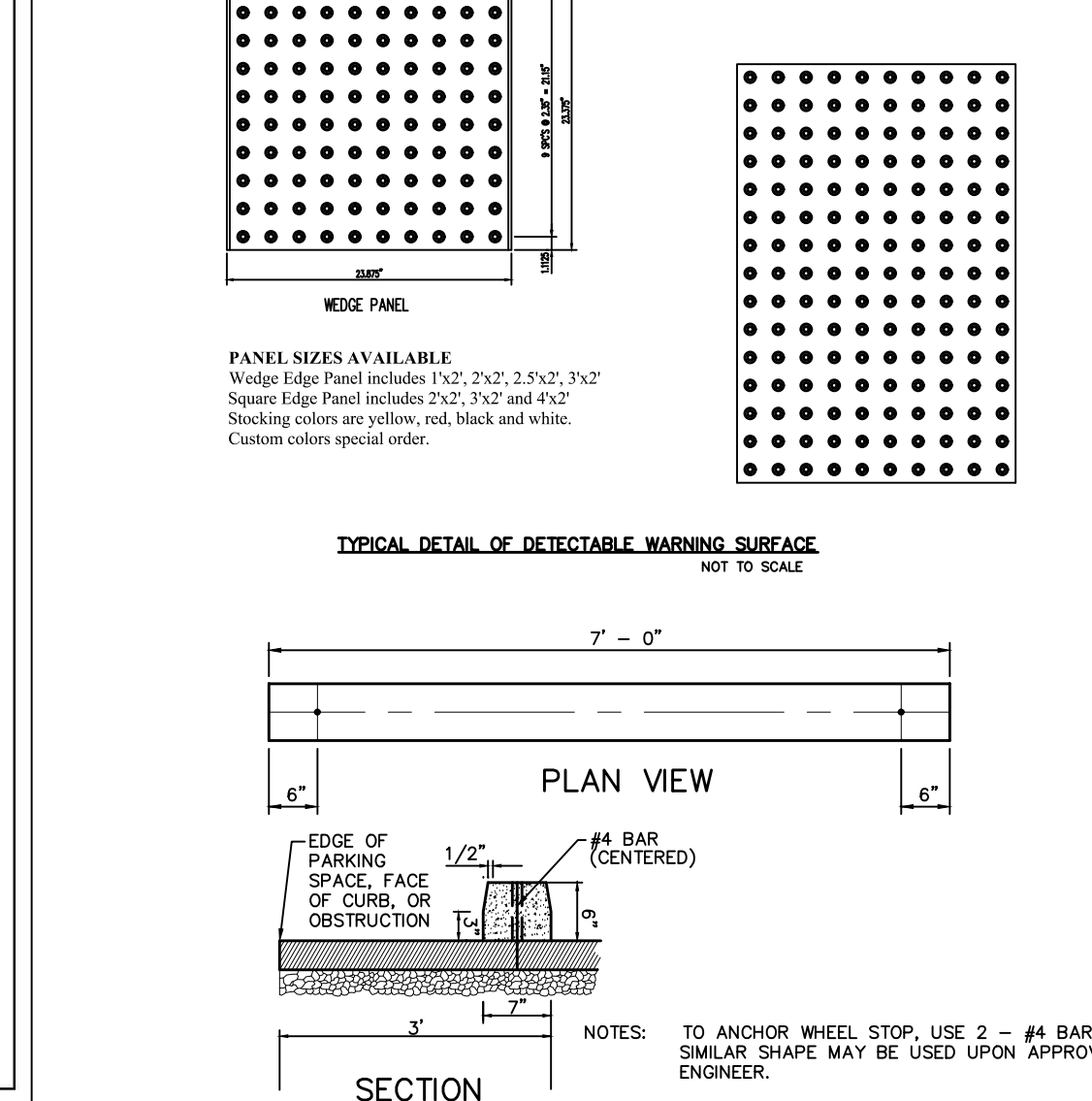
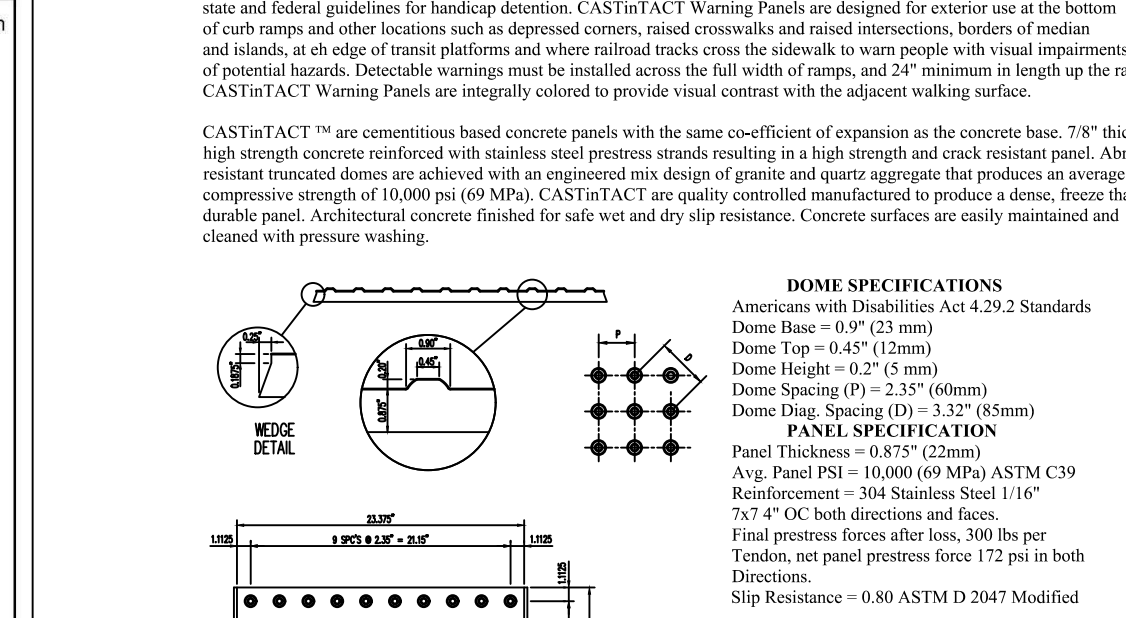
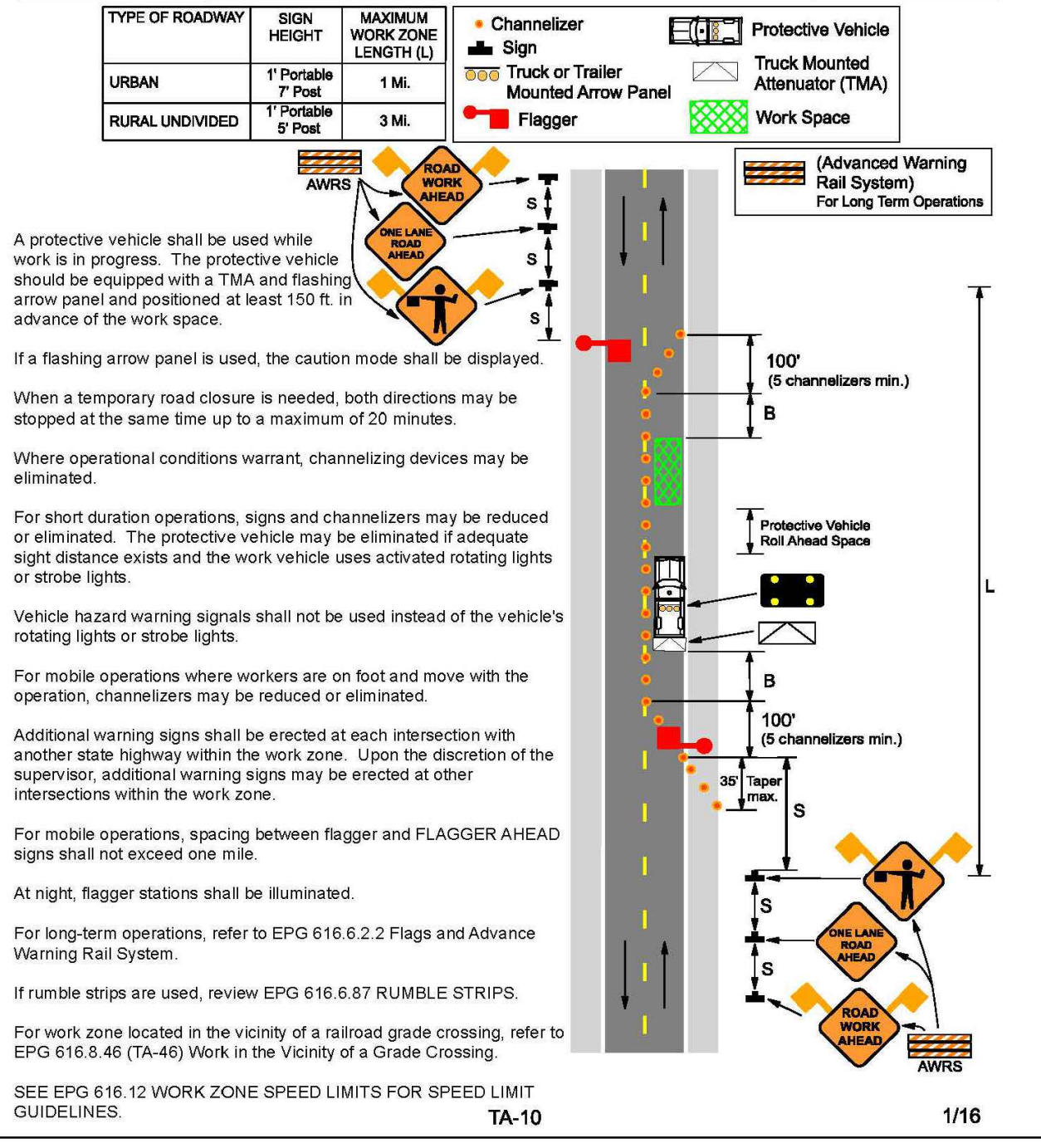

**Dog Pen and Retaining Wall Detail**  
SCALE: 1"=10'

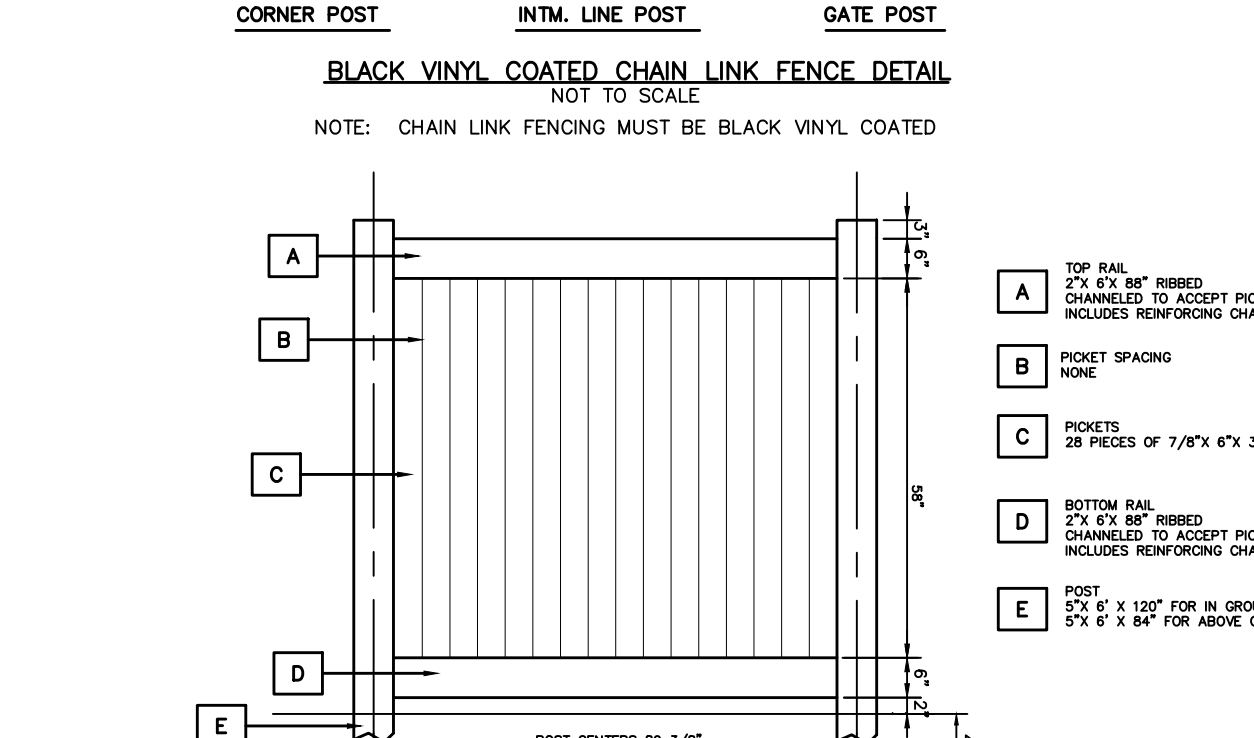
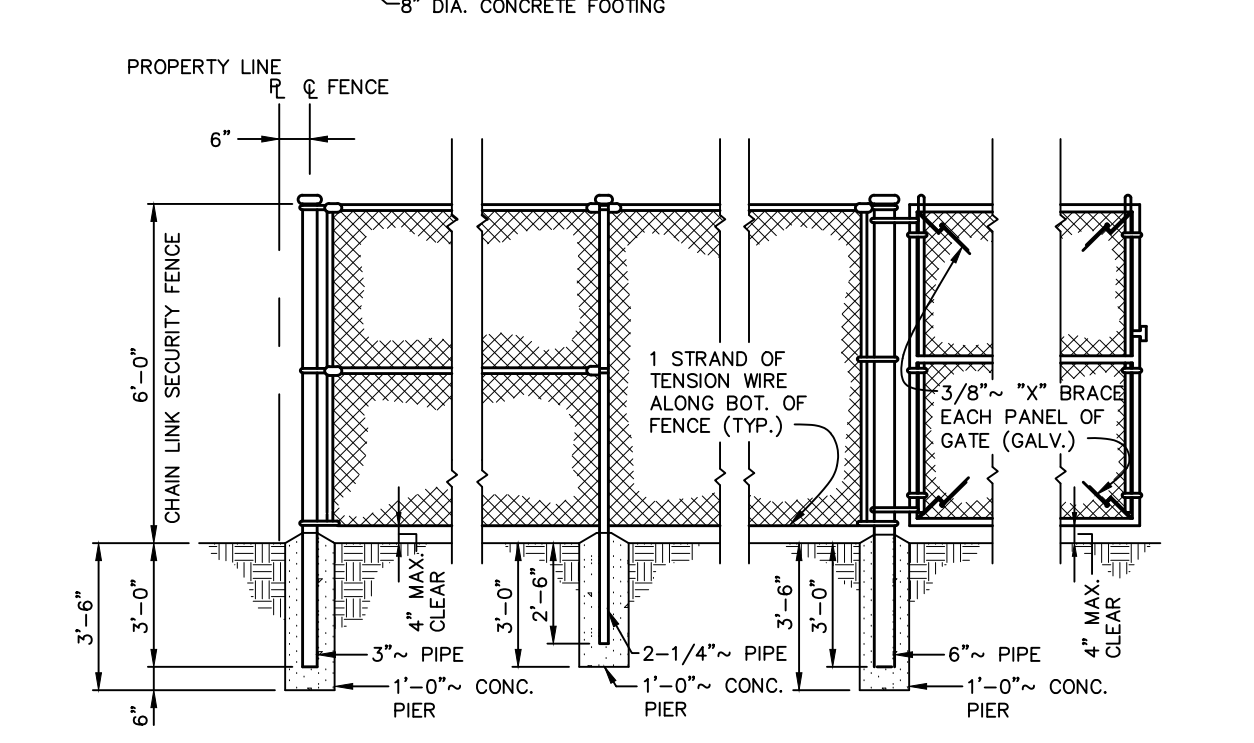
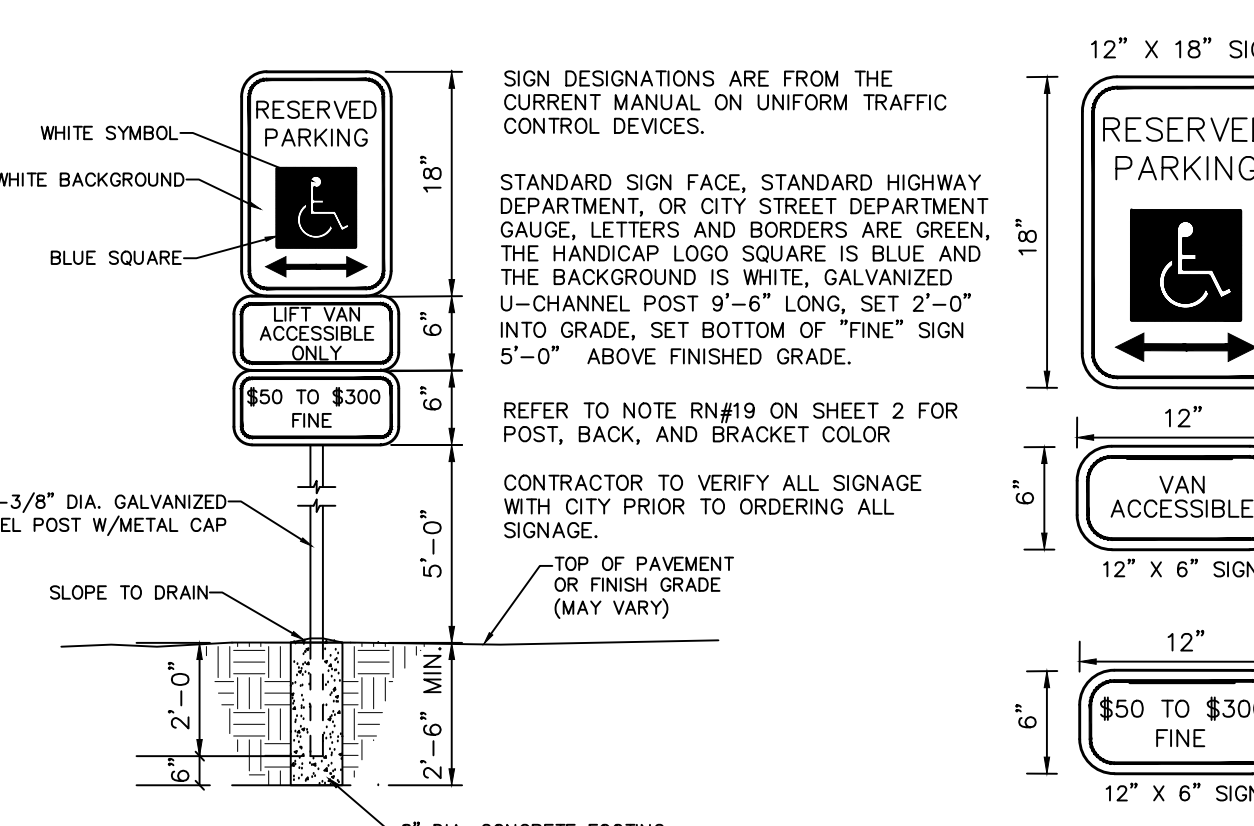

**6" HIGH VINYL PRIVACY FENCE**  
NOT TO SCALE

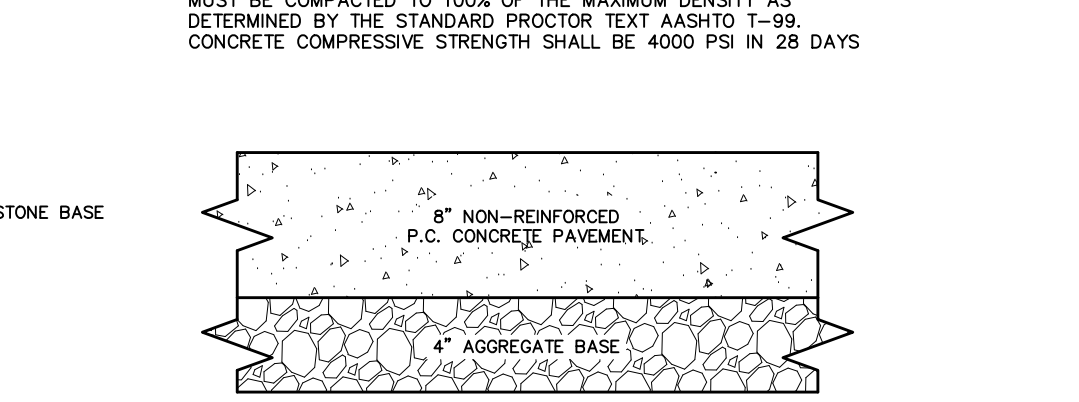
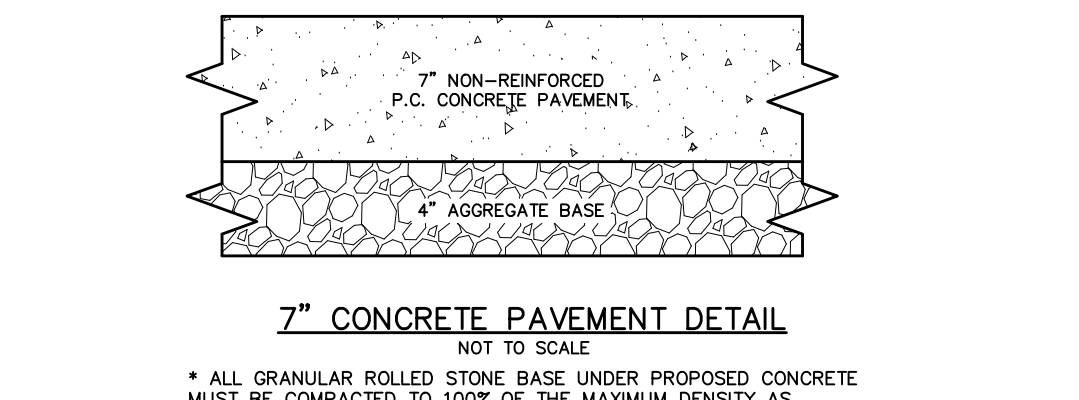
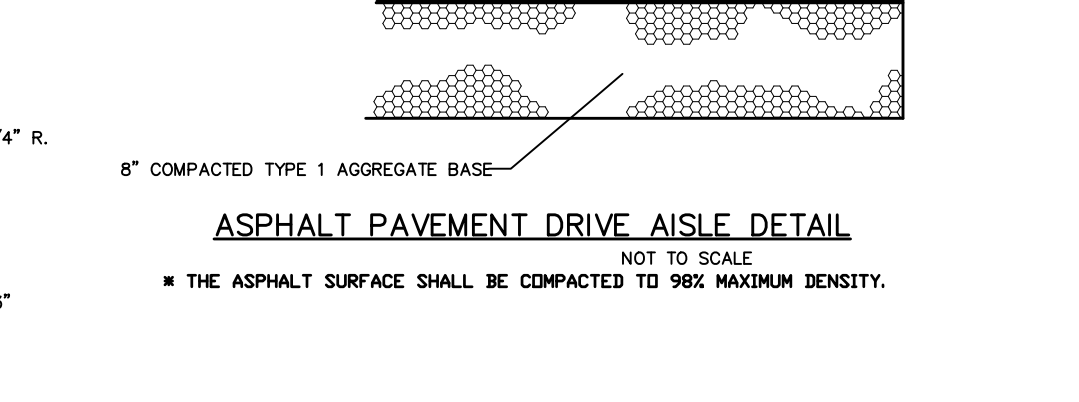
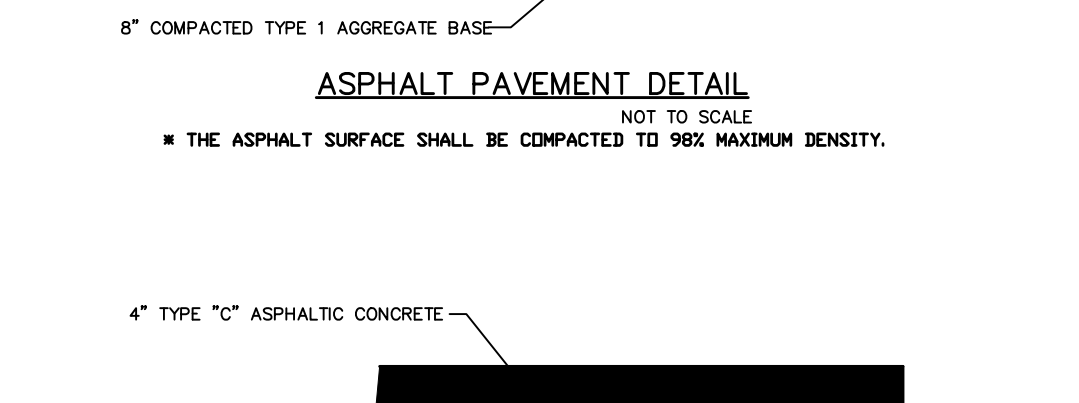
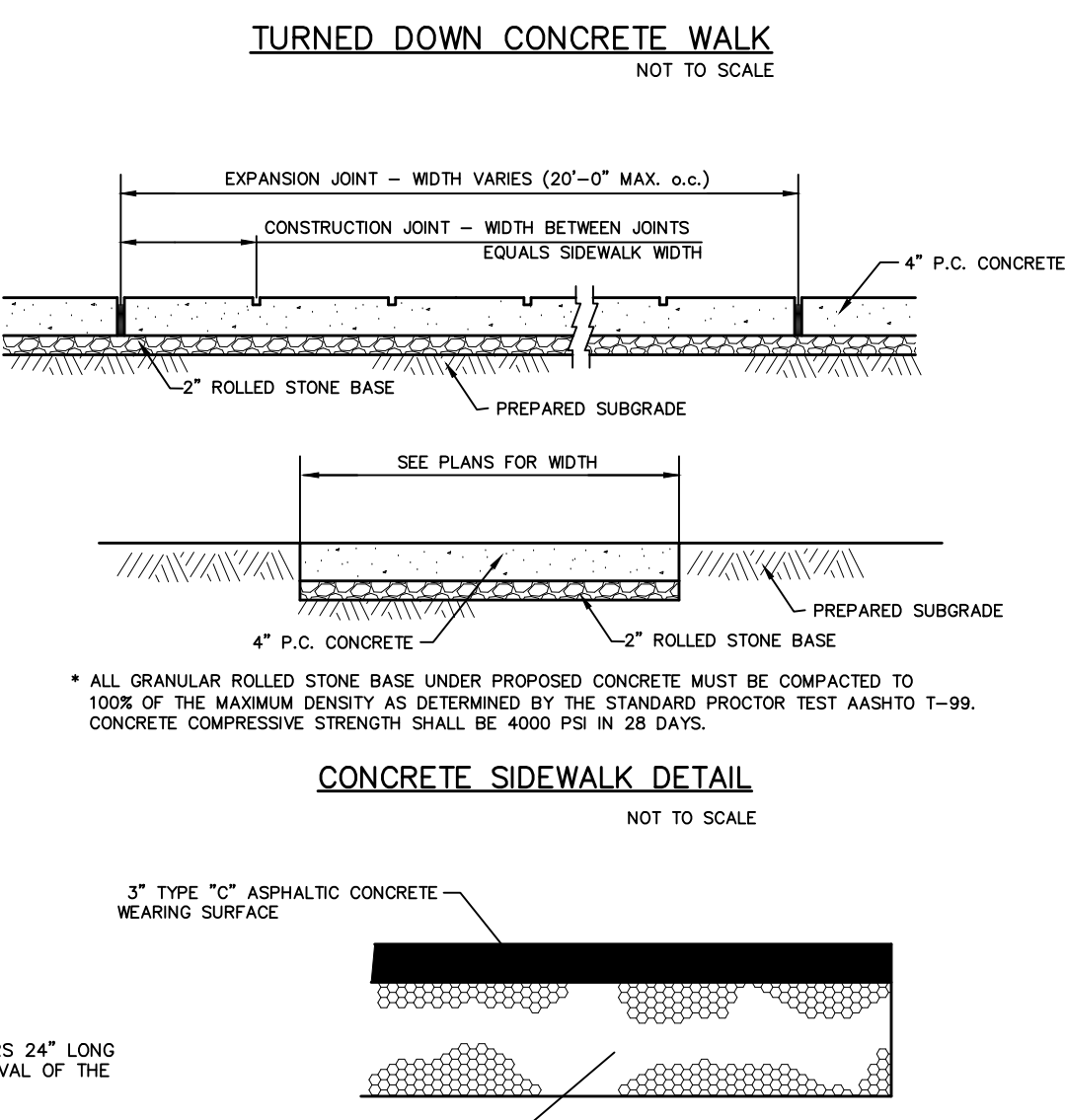
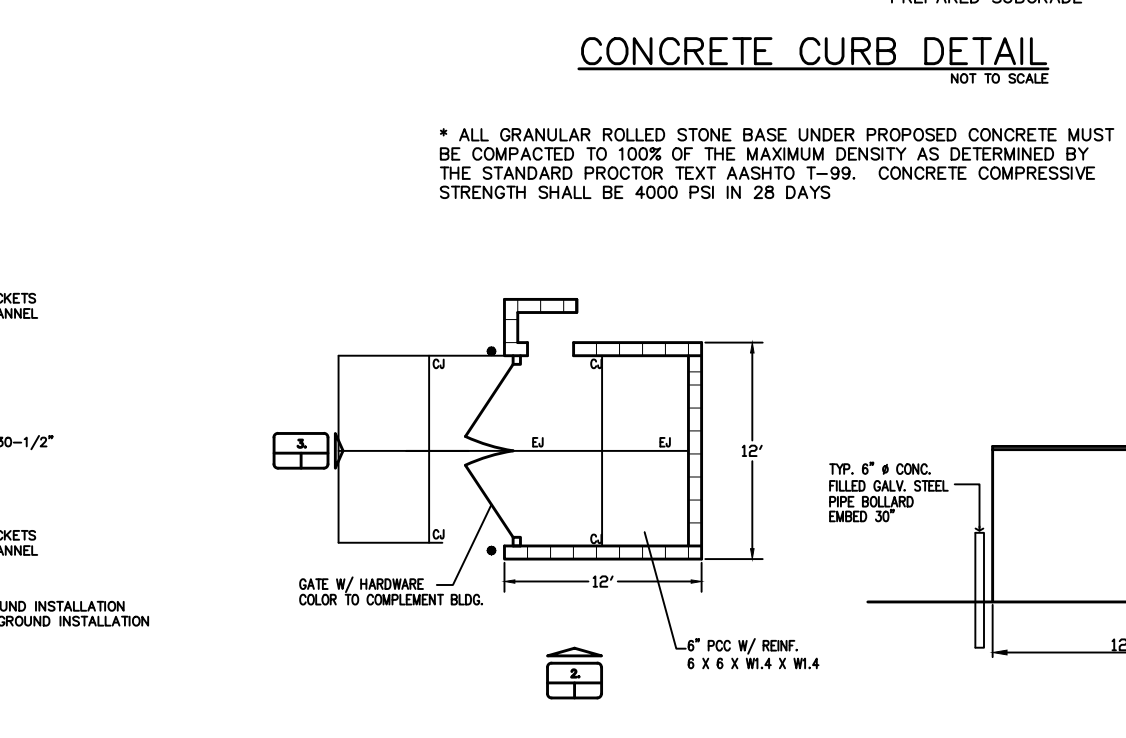
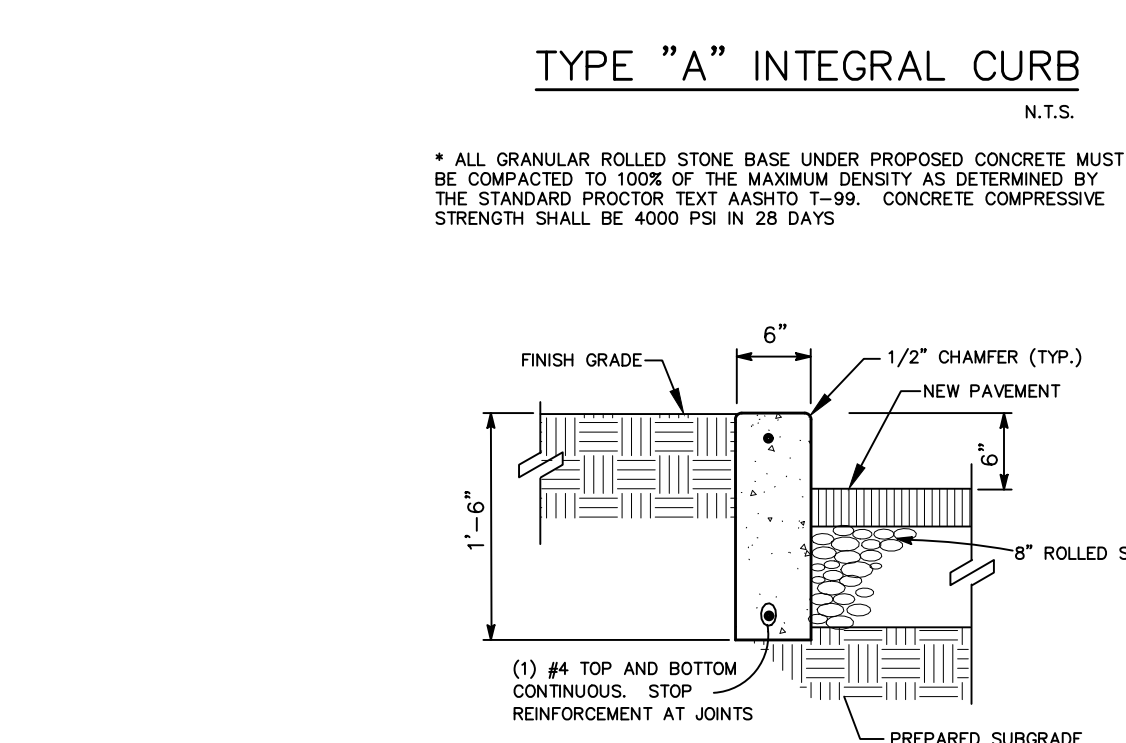
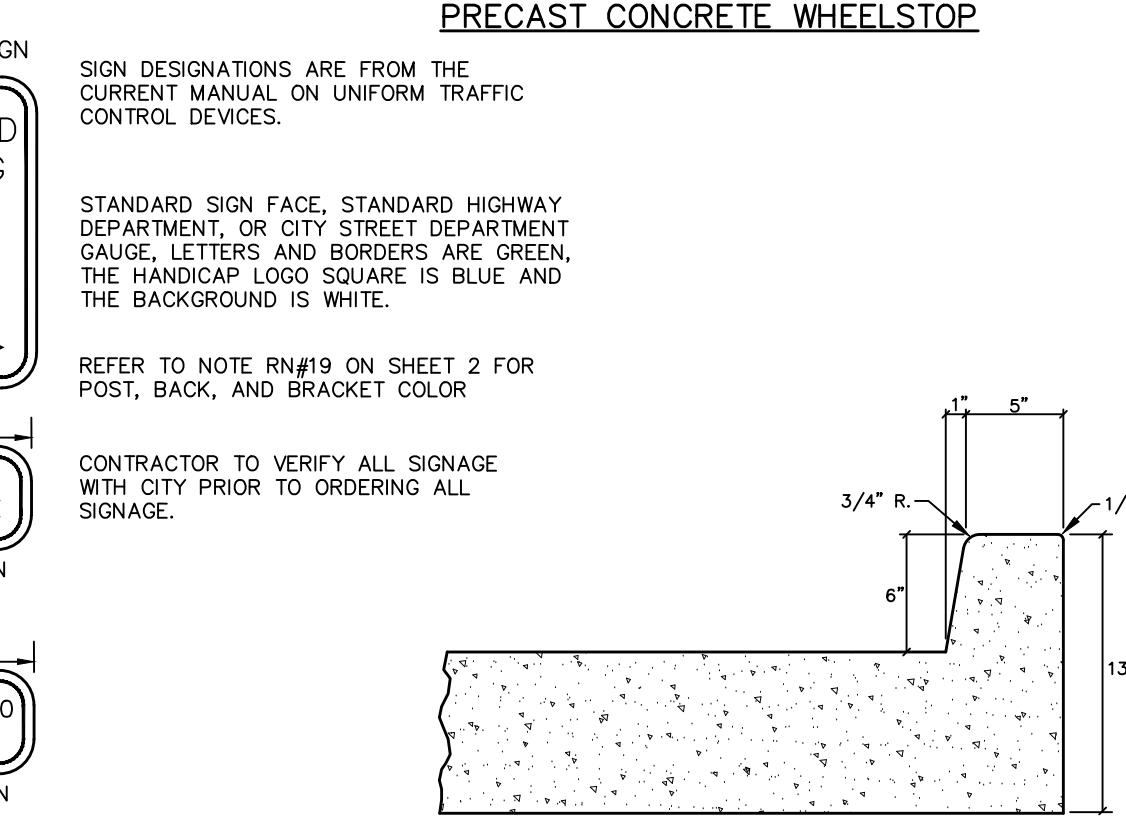

**ENGINEER SEAL DOES NOT APPLY TO CAST INTACT DETAILS**

**PROJECT TITLE:**  
CONSTRUCTION PLANS FOR  
Mexico Road Animal Hospital  
1190 Sonderen Street  
O'Fallon, MO 63376

Box Project # 00-1124J Issue Date: 12/17/2021

**ENGINEERING FIRM:**  
PLANNING SURVEYING

Larry D. Walker  
Civil Engineer  
2007020343

03/01/22

Copyright 2022  
Box Engineering Company, Inc.  
Authority No. 000555  
All Rights Reserved

**REVISIONS**

01-06-22	CITY COMMENTS
01-06-22	FIRE DIST. COMMENTS
03-01-22	CITY COMMENTS

**Developer / Owner:**  
Hoernig Veterinary Services L.L.C.  
25 Smetana  
Wentzville, MO 63385  
(573) 513-1525

**P+Z No.** 21-004881  
Approved: 07-01-21

**City No.** #

**Page No.**

**15 of 15**