



**ABBREVIATIONS**

AI	AREA INLET	MO	MIDDLE ORDINATE
ASPH	ASPHALT	NO	NUMBER
ATG	ADJUST TO GRADE	NTS	NOT TO SCALE
ATGBO	ADJUST TO GRADE BY OTHERS	OF	OUTFALL
B	BASELINE	PB	PULL BOX
BEG	BACK OF CURB	PC	POINT OF CURVATURE
BLD	BUILDING	PCC	PORTLAND CEMENT CONCRETE
BM	BENCHMARK	PDE	PERMANENT DRAINAGE EASEMENT
BPE	BIKE PATH EASEMENT	PE	PRIVATE ENTRANCE
C or Q	CENTERLINE	PI	POINT OF INTERSECTION
CE	COMMERCIAL ENTRANCE	PP	POWER POLE
CHIS	CHISELED	PROP	PROPOSED
CI	CURB INLET	PS	PRIVATE SIGN
CL	CONSTRUCTION LIMIT	PT	POINT OF TANGENT
CLF	CHAIN LINK FENCE	PVC	POINT OF VERTICAL CURVATURE OR POLYVINYL CHLORIDE
CMP	CORRUGATED METAL PIPE	PVI	POINT OF VERTICAL INTERSECTION
CONC	CONCRETE	PVMT	PAVEMENT
CONST	CONSTRUCTION/CONSTRUCT	PVT	POINT OF VERTICAL TANGENT
COR	CORNER	R	RADIUS
CSB	CABLE SPLICE BOX	R/W	RIGHT-OF-WAY
CT	COURT	RCP	REINFORCED CONCRETE PIPE
DCI	DOUBLE CURB INLET	RD	ROAD
DR	DRIVE	REQ'D	REQUIRED
EL	ELEVATION	RET	RETAINING
DP	EDGE OF PAVEMENT	RT	RIGHT
ELEV	ELEVATION	SDWK	SIDEWALK
EX	EXISTING	SGI	SPECIAL GRATE INLET
EXIST	EXISTING	SHLDR	SHOULDER
FC	FACE OF CURB	SS	STREET SIGN
FES	FLARED END SECTION	SSD	STOPPING SIGN DISTANCE
FL	FLOWLINE	STA	STATION
GD	GAS DRIP	SURF	SURFACE
GDP	GUARD POST	TBA	TO BE ABANDONED
GI	GRATE INLET	TBADJ	TO BE ADJUSTED
GM	GAS METER	TBM	TEMPORARY BENCHMARK
GT	GRATED TROUGH	TBR	TO BE REMOVED
GV	GAS VALVE	TBR&R	TO BE REMOVED AND REPLACED
GWA	GUY WIRE ANCHOR	TBR&RBO	TO BE REMOVED AND REPLACED BY OTHERS
GWS/OVS	GAS/OIL WARNING SIGN	TBR&REL	TO BE REMOVED AND RELOCATED
HOR	HORIZONTAL	TBREL	TO BE RELOCATED
INV	INVERT	TCE	TEMPORARY CONSTRUCTION EASEMENT
IP	IRON PIN	TEMP	TEMPORARY
K	RATE OF VERTICAL CURVE	TSB	TELEPHONE SPLICE BOX
LN	LANE	TL	TRAFFIC LIGHT
LS	LIGHT STANDARD	TYP	TYPICAL
LT	LEFT	UIP	USE IN PLACE
M	METER	VC	VERTICAL CURVE
MB	MAIL BOX	VCP	VITRIFIED CLAY PIPE
MH	MANHOLE	WM	WATER METER
MISC	MISCELLANEOUS	WV	WATER VALVE

**UTILITY COMPANIES**

WATER: (636) 281-2858	TELEPHONE: (636) 332-7392
ALLIANCE	CENTURYTEL
410 EAST ELM STREET	1151 CENTURYTEL DRIVE
O'FALLON, MO 63366	WENTZVILLE, MO 63385
WATER: (636) 922-9163	CABLE: (314) 738-0091
MISSOURI-AMERICAN WATER CO.	CHARTER CABLE SERVICES
1290 MOTHERHEAD ROAD	4282 SHORELINE DRIVE
P.O. BOX 390	EARTH CITY, MO 63045
COTTLEVILLE, MO 63338	
SANITARY SEWER DISTRICT: (636) 281-2858	SCHOOL DISTRICT: (636) 272-6620
ALLIANCE	FORT ZUMWALT SCHOOL DISTRICT
410 EAST ELM STREET	110 VIRGIL
O'FALLON, MO 63366	O'FALLON, MO 63366
ELECTRIC: (636) 639-8312	FIRE DEPARTMENT: (636) 272-3493
AMEREN UE	O'FALLON FIRE PROTECTION DISTRICT
200 NORTH CALLAHAN RD.	119 EAST ELM ST
WENTZVILLE, MO 63385	O'FALLON, MO 63366
ELECTRIC: (636) 327-5282	GAS: (314) 658-5417
CUIRVE RIVER ELECTRIC COOPERATIVE	LACLEDE GAS
1112 EAST CHERRY STREET	3950 FOREST PARK AVE.
TROY, MO 63379	ST. LOUIS, MO 63108

**MEXICO ROAD LANE ADDITIONS**

**CITY OF O'FALLON  
COMMUNITY DEVELOPMENT  
100 N. MAIN ST.  
O'FALLON, MO 63366  
(636) 240-2000**

**PROJECT NO. 00-034**

**LEGEND**

	TREE
	EX TELEPHONE PEDESTAL
	EX WATER VALVE
	EX FIRE HYDRANT
	EX POWER POLE
	CONSTRUCTION LIMITS
	EASEMENT
	EX PROPERTY LINE
	FLOW LINE
	OVERHEAD LINE
	TELEPHONE LINE
	WATER LINE W/ SIZE
	GAS LINE

REFERENCE BENCHMARK RM-60 ELEV=480.00  
2 INCH CUT SQUARE IN CENTER OF NORTH END OF WALKWAY AT NORTHWEST CORNER OF BELLEAU CREEK ROAD BRIDGE OVER BELLEAU CREEK PER FLOOD INSURANCE RATE MAP NO. 29183C0241.

SITE BENCHMARK "A" ELEV= 530.54  
OLD IRON PIPE AT THE SOUTHWEST CORNER OF LOT 210 OF COPPERFIELD PLAT 2.

SITE BENCHMARK "B" ELEV. 557.42  
OLD IRON PIPE AT THE NORTHEAST CORNER OF LOT 5 OF WINCHESTER ESTATES.

**CONSTRUCTION PLANS**

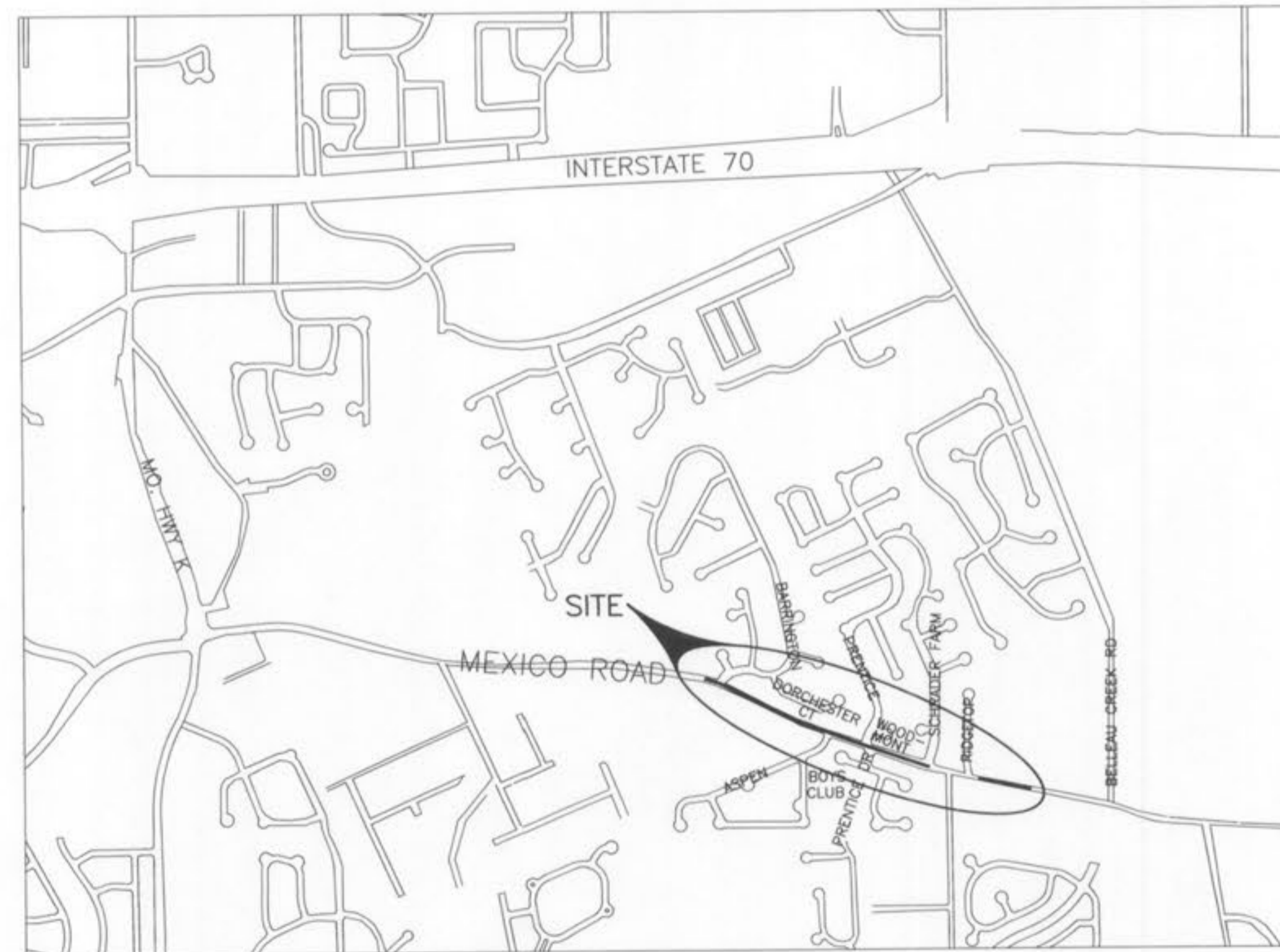

**LOCATION MAP  
NOT TO SCALE**

DESIGN SPEED = 45 M.P.H.  
ADT = 27,600 (5-11-2000)

**INDEX OF SHEETS**

SHEET NO.	DESCRIPTION
1	COVER
2	GENERAL NOTES
3	TYPICAL SECTIONS
4-10	PLAN AND PROFILE
11	INTERSECTION WARPING
12-13	EROSION CONTROL / STRIPING PLAN
14-15	TRAFFIC HANDLING PLANS
16-29	ROADWAY SECTIONS
30-33	DETAILS

**CITY OF O'FALLON  
COMMUNITY DEVELOPMENT  
DESIGN DIVISION  
O'FALLON, MISSOURI**

DISCLAIMER OF RESPONSIBILITY  
I HEREBY CERTIFY THAT THE DOCUMENTS REFERENCED TO IN THIS SHEET AND I HEREBY DISCLAIM ANY RESPONSIBILITY FOR ALL OTHER DRAWINGS, SPECIFICATIONS, ESTIMATES, REPORTS OR OTHER DOCUMENTS OF INSTRUMENTS RELATING TO OR INTENDED TO BE USED FOR ANY PART OR PARTS OF THE ARCHITECTURAL OR ENGINEERING PROJECT OF SURVEY.



PLAN SUBMITTAL DATE:

11/7/03

APPROVED:

CHARLES E. MOBLEY, P.E.  
DIRECTOR OF PUBLIC WORKS

DATE: 11/7/03

PROJECT: 00-034