

REVISED DATE
7-26-01
8-01-01
10-26-01
11-2-01
11-5-01
11-16-01
11-20-01

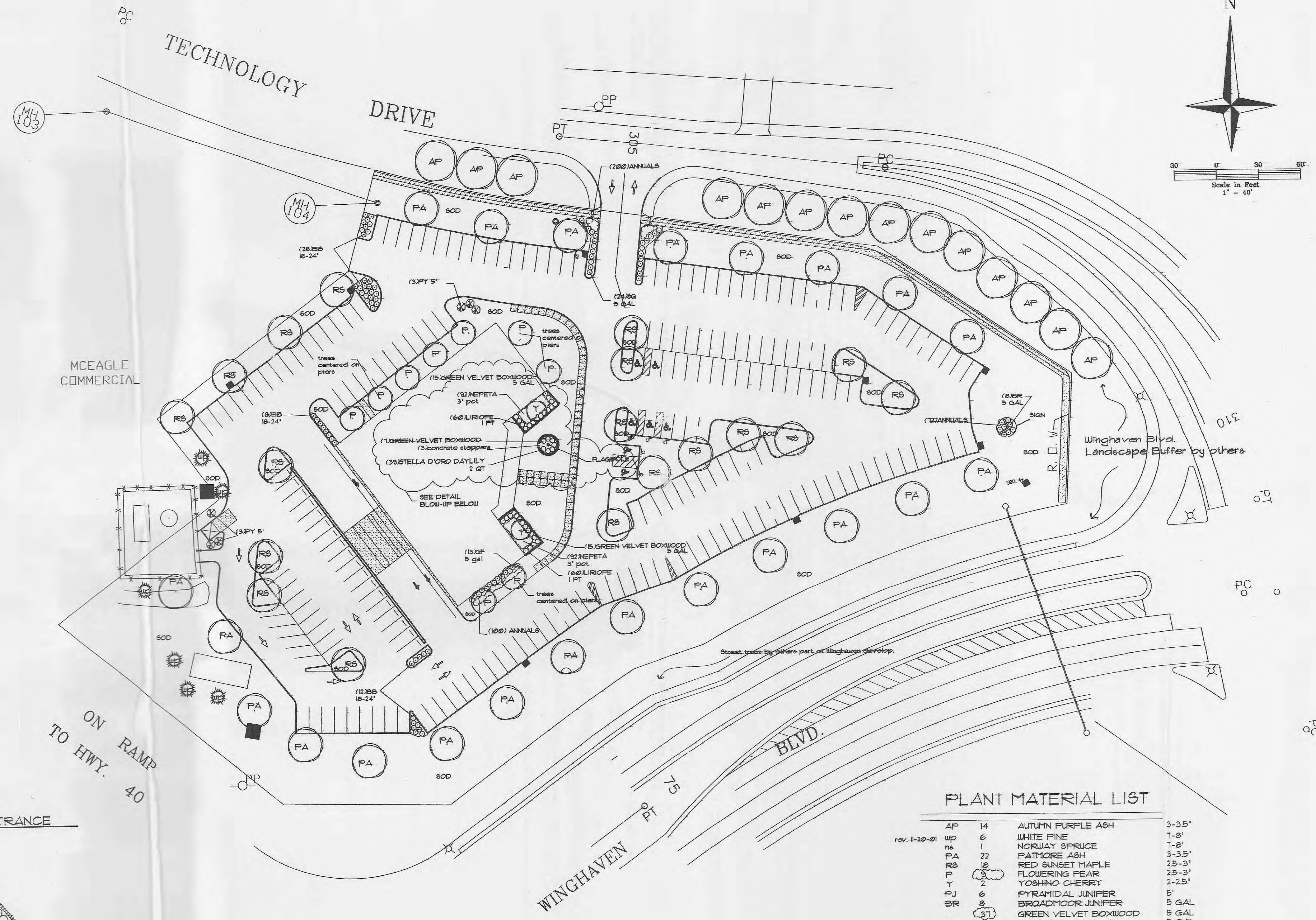

DETAIL OF BLDG. ENTRANCE
NOT TO SCALE

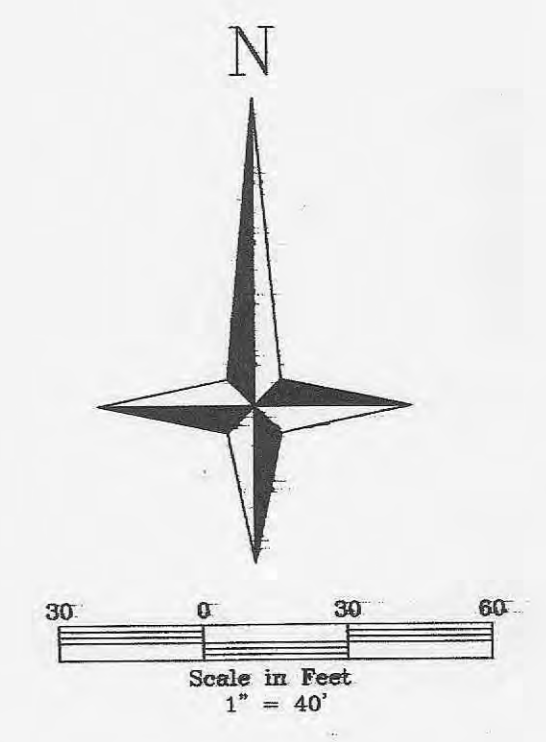
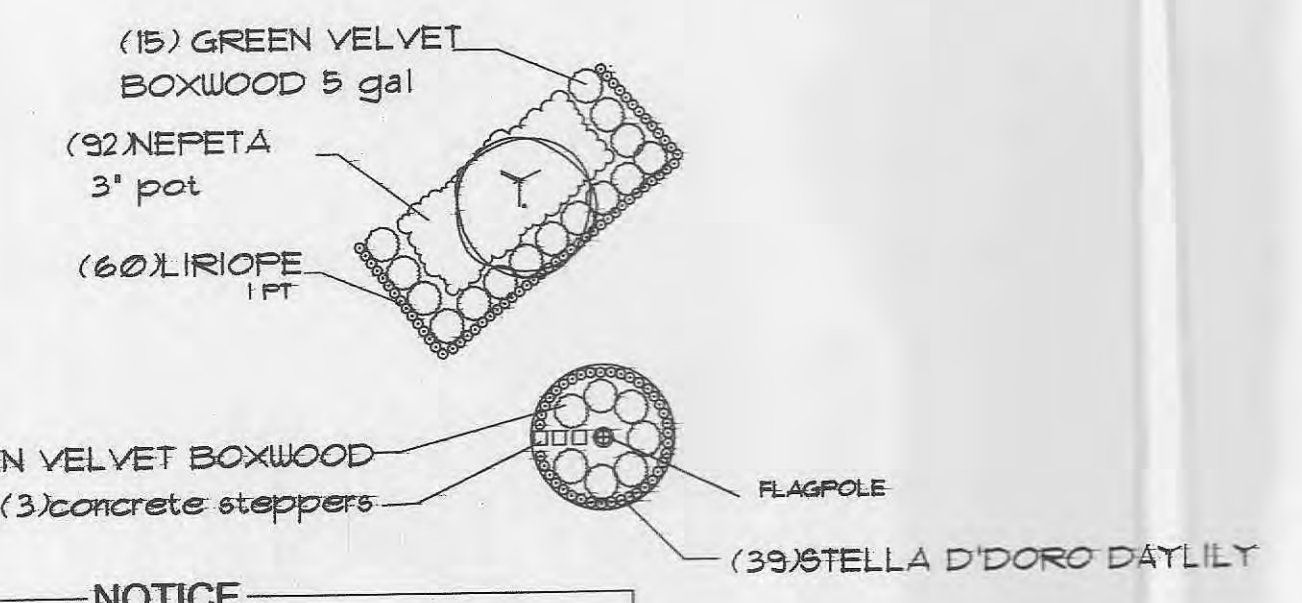

PLANT MATERIAL LIST

AP	14	AUTUMN PURPLE ASH	3-3.5'
WP	6	WHITE PINE	1-8'
NS	1	NORWAY SPRUCE	1-8'
PA	22	PATHMORE ASH	3-3.5'
RS	18	RED SUNSET MAPLE	2.5-3'
P	3	FLOWERING PEAR	2.5-3'
Y	2	YOSHINO CHERRY	2-2.5'
PJ	6	PYRAMIDAL JUNIPER	5'
BR	8	BROADMOOR JUNIPER	5 GAL
	31	GREEN VELVET BOXWOOD	5 GAL
GF	15	GOLDFLAME SPIREA	18-24"
BB	40	BURNING BUSH	5 GAL
SG	24	SEAGREEN JUNIPER	5 GAL
	120	LIRIOPE	1 FT.
	39	STELLA D'ORO DAYLILY	2 QT
	392	ANNUALS seasonal color	3'pot
	184	NEPETA	2.5'pot
	32	BARK MULCH	CYTD.
	3	CONCRETE STEPPERS	8"
		8160 SOD inside P/L approx. to be re-measured once construction completed.	SQ.YD.

NOTE: All planting beds shall be mulched with shredded bark and spaced cut edge.
All landscaped areas to be irrigated.

NOTICE
This drawing is the property of A. Waldbart and Sons Nursery. Each plan formulated by our firm involves original thought and ideas; therefore, we reserve the copyright to any design prepared by our staff. Use of this plan and/or any portion thereof for competitive bids, pricing, or related purposes is illegal without our written permission.

MIDWEST BANK
PARIC

895-4589

A WALDBART AND SONS
Nursery
Established 1872

Landscape Designers, Landscape Contractors & Nurserymen
1420 Teson Rd., Hazelwood, MO 63042

Sheet L-1
Revised
Date 6-12-01
Scale 1" = 40'-0"
Approved
Drawn By LKH