

SCALE:  
HORIZ: 1" = 50'  
VERT: 1" = 10'

SANITARY SEWER PROFILES  
MONTICELLO - VILLAGE A  
February, 1992  
85-004U

FINAL SURVEY  
BY: \_\_\_\_\_ DATE: \_\_\_\_\_  
UNREVISED PLOTTED  
TEMPLATE NO. \_\_\_\_\_  
NOTE BOOK NO. \_\_\_\_\_  
AREAS CHECKED: \_\_\_\_\_

ORIGINAL SURVEY  
BY: \_\_\_\_\_ DATE: \_\_\_\_\_  
UNREVISED PLOTTED  
TEMPLATE NO. \_\_\_\_\_  
NOTE BOOK NO. \_\_\_\_\_  
AREAS CHECKED: \_\_\_\_\_

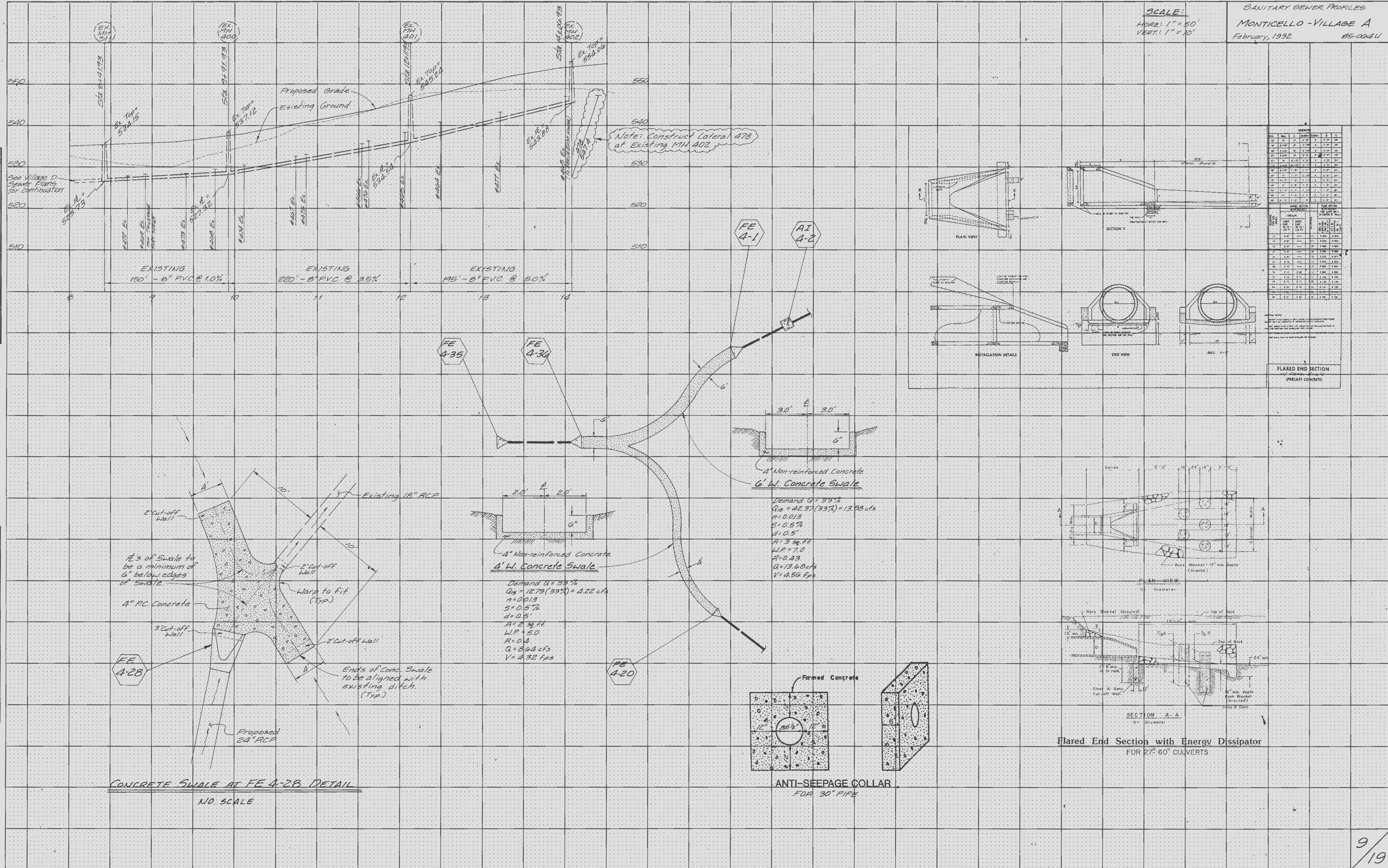

CONCRETE SWALE AT FE 4-28 DETAIL  
N.O. SCALE

ANTI-SEEPAGE COLLAR FOR 30" PIPE

Flared End Section with Energy Dissipator FOR 27"-60" CULVERTS

Station	Profile	Material	Notes
8+00	150' - 8" PVC @ 1.0%	PVC	EXISTING
9+00	220' - 8" PVC @ 3.5%	PVC	EXISTING
10+00	195' - 8" PVC @ 5.0%	PVC	EXISTING
11+00	4" Non-reinforced Concrete Swale	Concrete	Proposed
12+00	4" Non-reinforced Concrete Swale	Concrete	Proposed
13+00	4" Non-reinforced Concrete Swale	Concrete	Proposed
14+00	4" Non-reinforced Concrete Swale	Concrete	Proposed