

- ADDITIONAL GRADING NOTES:**
- UPON COMPLETION OF CONSTRUCTION OR COMPACTION, ALL DISTURBED AREAS SHALL EITHER BE PAVED, LANDSCAPED, OR SOODED FOR THESE PROJECT IMPROVEMENTS. PERMANENT SEEDING WILL NOT BE PERMITTED ON THIS DEVELOPMENT. IN ADDITION, PUBLIC RIGHT-OF-WAYS, ALL SLOPES STEEPER THAN 5:1, AND ALL DRAINAGE SWALES SHALL BE PROTECTED BY SODDING OR PAVING UPON COMPLETION OF CONSTRUCTION OR COMPACTION.
  - SODDING MUST BE PINNED ON SIDE SLOPES STEEPER THAN 5:1, AND ESPECIALLY IN THE AREAS WHERE NEW DRAINAGE SWALES HAVE BEEN CREATED TO RELEASE STORMWATER RUNOFF. INSTALL THE PINNED SODDING FROM TOP OF SLOPE TO BOTTOM OF SLOPE TO HELP PREVENT EROSION.
  - BEFORE FILLING, THE CONTRACTOR SHALL THOROUGHLY CLEAN OUT AND REMOVE ALL OBJECTIONABLE MATERIAL, ORGANIC MATERIAL, RUBBISH AND DEBRIS.
  - REFER TO SHEET C6.0 - C6.4 FOR SIDEWALK, RAMPS, PAVEMENT, AND CURB DETAILS.
  - TOP OF PAVEMENT GRADES (TP) SHOWN AT THE GASOLINE PUMP ISLANDS REPRESENT CONCRETE DRIVE PAVEMENT GRADES, NOT TOP OF ISLAND GRADES. REFER TO GASOLINE PLANS FOR PUMP ISLAND HEIGHTS. ALL ON-SITE CURB SHALL BE 6" HIGH CONCRETE CURB, UNLESS NOTED OTHERWISE. INTEGRAL SIDEWALK / CURB SHALL BE INSTALLED ADJACENT TO CONCRETE SIDEWALKS, AND VERTICAL AT ALL OTHER LOCATIONS, INCLUDING ADJACENT TO EXISTING PAVEMENTS.
  - CURB HEIGHTS VARY ALONG THE NORTH CURB & GUTTER LINE OF THE EXISTING DRIVE LANE IN AREA 'A' WHERE THE EXISTING TOP OF PAVEMENT IS BEING MATCHED IN ELEVATION. IF THE CURB HEIGHT IS NOT THE 6" TYPICAL, THEN HEIGHTS ARE NOTED AS (X"H) WITH THE SPOT GRADE CALLOUTS.
  - ADA PARKING AREA SLOPES MUST NOT EXCEED 2% IN ANY DIRECTION. ALL NEW CONCRETE SIDEWALK, ADA RAMPS, ADA LANDING AREAS, AND ADA PATH (ZEBRA PAINTED PATH) MUST HAVE A CROSS SLOPE OF LESS THAN THE 2% MAXIMUM.
  - ADA RAMP SLOPES MUST NOT EXCEED 1:12. ADA CURB RAMPS SHALL NOT RISE MORE THAN 6 INCHES FROM TOP OF RAMP TO THE LANDING AREA (BOTTOM OF RAMP).
  - PAVEMENT / SIDEWALK INSTALLATION TOLERANCE = 1/4" INCH.
  - A BUILDING PERMIT IS REQUIRED FROM THE CITY BUILDING DEPARTMENT FOR THE CONSTRUCTION OF THE RETAINING WALLS. THE GENERAL CONTRACTOR IS RESPONSIBLE TO SUBMIT ALL REQUIREMENTS FOR THIS PERMIT, INCLUDING BUT NOT LIMITED TO PROVIDING RETAINING WALL STRUCTURAL DESIGN PLANS, SIGNED AND SEALED BY A MISSOURI LICENSED PROFESSIONAL ENGINEER, FOR SUBMITTAL TO THE CITY. THESE WALL DESIGN PLANS MUST INCLUDE THE REQUIRED CONTINUOUS REINFORCED FOOTING OR GRADE BEAMS AT CROSSING WITH SEWERS.
  - RETAINING WALL PLANS SHALL BE SUBMITTED TO CLAYTON ENGINEERING FOR REVIEW PRIOR TO SUBMITTAL TO THE CITY BY THE CONTRACTOR. THIS REVIEW SHALL CHECK WALL DESIGN AGAINST PROJECT SPECIFIC PARAMETERS SHOWN ON THIS GRADING PLAN. STRUCTURAL DESIGN WILL NOT BE A PART OF THAT REVIEW.
  - MODULAR BLOCK RETAINING WALL UNITS SHALL BE VERSA-LOK MOSAIC BLOCK UNITS (COLOR: BETHANY LEDGE BLENDED BY MIDWEST BLOCK ST. LOUIS, WEATHERED FINISH). THE CONTRACTOR SHALL SUBMIT THE PROPOSED COLOR AND FINISH TO THE ARCHITECT AND OWNER FOR APPROVAL.
  - TW = TOP OF WALL, FG = FINISH GRADE.
  - FOOTING GRADES FOR RETAINING WALL ARE NOT A PART OF THIS PLAN. THE FOOTING DESIGN AND GRADES MUST BE PROVIDED WITH THE RETAINING WALL PLANS. THE RETAINING WALL PLAN GRADES SHALL SUPERCEDE THE WALL GRADES SHOWN ON THIS PLAN.
  - USE CONTINUOUS REINFORCED FOOTING OR GRADE BEAM & PIERS FOR NEW RETAINING WALLS OVER NEW SANITARY AND STORM SEWER PIPES.
  - THE RETAINING WALL UNDERDRAINS SHOULD BE DAYLIGHTED TO PENETRATE THE FACE OF THE WALL AT INTERVALS DESCRIBED ON THE STRUCTURAL RETAINING WALL DESIGN PLANS OR CONNECTED TO THE NEAREST NEW STORM SEWER STRUCTURES.
  - A BUILDING PERMIT IS REQUIRED FROM THE CITY BUILDING DEPARTMENT FOR THE CONSTRUCTION OF THE FENCING. THE GENERAL CONTRACTOR IS RESPONSIBLE TO SUBMIT ALL REQUIREMENTS FOR THIS PERMIT.
  - LIMITS OF DISTURBANCE: THE CONTRACTOR SHALL STAY WITHIN THE LIMITS OF DISTURBANCE AS SHOWN ON THE PLANS AND MINIMIZE DISTURBANCE WITHIN THE WORK AREA WHEREVER POSSIBLE.
  - ORNAMENTAL METAL FENCE AT TOP OF NEW RETAINING WALL SHALL BE 4-FOOT HIGH (COLOR: BLACK), MANUFACTURER: AMERISTAR, STYLE: MONTAGE II MAJESTIC (3-RAIL).
  - ALL ITEMS LABELED AS "FUTURE... (BY OTHERS)" ARE ITEMS TO BE CONSTRUCTED BY THE CONTRACTORS OF CALEDONIA PROJECT OR OTHERS TO BE SUBMITTED AND PERMITTED SEPARATELY FROM THIS MOTOMART PROJECT. THESE ITEMS ARE REPRESENTED AS BEING EXISTING ON THESE MOTOMART PLANS TO SHOW THE OVERALL INTENT OF THE DEVELOPMENT.

**LANDSCAPING MAINTENANCE NOTE:**  
THE CONTRACTOR SHALL WATER AND MAINTAIN ALL SODDING & PLANTINGS FOR A MINIMUM OF 30 DAYS AFTER INSTALLATION.

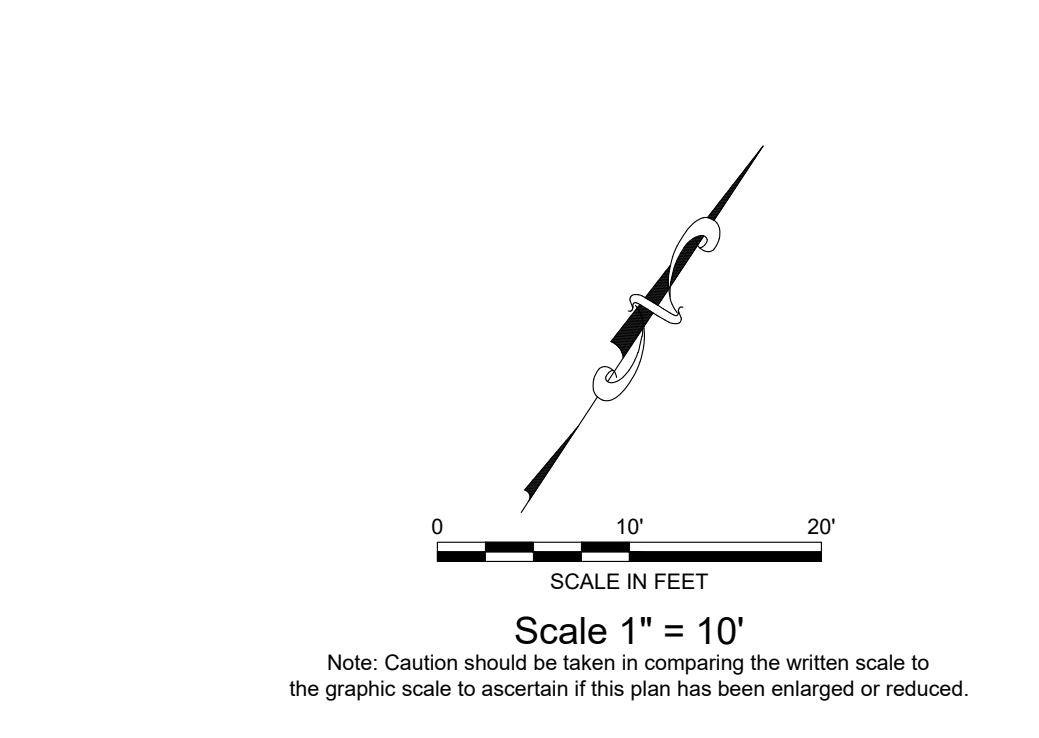

**GRADING PLAN SHEET INDEX MAP**

D (C3.3)	A (C3.0)
C (C3.2)	B (C3.1)

Project Number: 20350  
 Designed: EJS / RPK  
 Drawn: EJS / RPK  
 Checked: TJB / RPK

Copyright 2021 Clayton Engineering Co. All Rights Reserved.  
 ENGINEERS - SURVEYORS - PLANNERS  
 2388 WELSH INDUSTRIAL COURT  
 ST. LOUIS, MISSOURI 63106  
 (314) 892-8888 FAX: (314) 892-8888 claytoneng.com  
 No. Cert. of Authority - Prof. Engineering #000067  
 & Prof. Surveying #000014  
 IL Dept. Financial & Prof. Reg. Prof. Design & Engineering Corp. #184.000879

**fgma**

**FGM Architects Inc.**  
 1 Metropolitan Sq, Ste. 1945  
 St. Louis, Missouri 63102

314.439.1601 OFFICE  
 314.439.1602 FAX

MISSOURI CERTIFICATE OF AUTHORITY #000311

**ARCHITECTURE**  
**FGM ARCHITECTS**  
 1 METROPOLITAN SQ, STE. 1945  
 ST. LOUIS, MISSOURI, 63102  
 314.439.1601 (O) 314.439.1602(F)  
 MO STATE CERTIFICATE OF AUTHORITY NO. 000311

**CIVIL**  
**THE CLAYTON ENGINEERING COMPANY, INC.**  
 2388 WELSH INDUSTRIAL CT.  
 ST. LOUIS, MO 63146  
 314.692.8888 (O) 314.692.8888(F)  
 MO STATE CERTIFICATE OF AUTHORITY NO. 000067 & PROF. SURVEYING NO. 000014

**STRUCTURAL**  
**ASDG, LLC**  
 1200 LINCOLN HIGHWAY  
 FAIRVIEW HEIGHTS, IL 62208  
 618.228.0887 (O) 618.228.0889(F)  
 IL STATE CERTIFICATE OF AUTHORITY NO. 184-003843

**M.E.P**  
**BRIC PARTNERSHIP, LLC**  
 100 EAST WASHINGTON, SUITE 220  
 BELLVILLE, IL 62220  
 618.277.5200 (O) 618.277.5277(F)  
 IL STATE CERTIFICATE OF AUTHORITY NO. 184-003843

Erik J. Staley - Professional Engineer (PE-200600132)  
 PROFESSIONAL ENGINEER  
 NUMBER PE-200600132  
 1/22/2021

**ERIK J. STALEY, PE**  
**ENGINEER No. 200600132**  
 The professional engineer seal offered to this sheet applies only to the material and items shown on this sheet. All approvals, instruments or other documents not exhibiting this seal shall not be considered prepared by this engineer, and this engineer expressly disclaims any and all responsibility for such plans, drawings or documents not exhibiting this seal.  
**DATE 08/25/2021**

**ISSUANCE**

NO	DATE	DESCRIPTION
1.	08/25/21	CITY SUBMITTAL
2.	09/22/21	2nd CITY SUBMITTAL
3.	10/04/21	3rd CITY SUBMITTAL
4.	11/22/21	4th CITY SUBMITTAL (BID SET)

**O'FALLON, MO MOTOMART NEW CONVENIENCE CENTER AND CARWASH AND CARWASH FKG OIL COMPANY**

**GRADING PLAN 'C'**

**SHEET NO. C3.2**

**JOB NO. 21-31331.01**

© 2021 FGM Architects Inc.

**Call Before you DIG**  
 Dial 811 or TOLL FREE 1-800-344-7483  
 mo1call.com  
 MISSOURI ONE-CALL SYSTEM INC.

Underground facilities, structures & utilities have been plotted from available surveys, records & information, and therefore, do not necessarily reflect the actual existence, nonexistence, size, type, number, or location of these facilities, structures, & utilities.

The Contractor shall be responsible for verifying the actual location of all underground facilities, structures, & utilities, either shown or not shown on these plans. The underground facilities, structures, & utilities shall be located in the field prior to any grading, excavation or construction of improvements. These provisions shall in no way absolve any party from complying with the Underground Facility Safety and Damage Prevention Act.

The original signed and sealed of this drawing is on file at the office of The Clayton Engineering Company. Any modifications to this drawing shall release said The Clayton Engineering Company, the Engineer and/or Surveyor whose seal appears hereon from any liability resulting from said unauthorized modifications. The signed and sealed original is the official document and shall take precedence over any digital version.

MISSOURI ROUTE DD

PRINTED ON 24" x 36" SHEET