

Call Before you DIG
Dial 811 or TOLL FREE
1-800-344-7483
mo1call.com
MISSOURI ONE-CALL SYSTEM INC.

Underground facilities, structures & utilities have been plotted from available surveys, records & information, and therefore, do not necessarily reflect the actual existence, nonexistence, size, type, number, or location of these facilities, structures, & utilities.

The Contractor shall be responsible for verifying the actual location of all underground facilities, structures, & utilities, either shown or not shown on these plans. The underground facilities, structures, & utilities shall be located in the field prior to any grading, excavation or construction of improvements. These provisions shall in no way absolve any party from complying with the Underground Facility Safety and Damage Prevention Act.

The original signed and sealed of this drawing is on file at the office of The Clayton Engineering Company. Any modifications to this drawing shall be made by The Clayton Engineering Company, the Engineer and/or Surveyor whose seal appears hereon from any liability resulting from said unapproved modifications. The signed and sealed original is the official document and shall take precedence over any digital version.

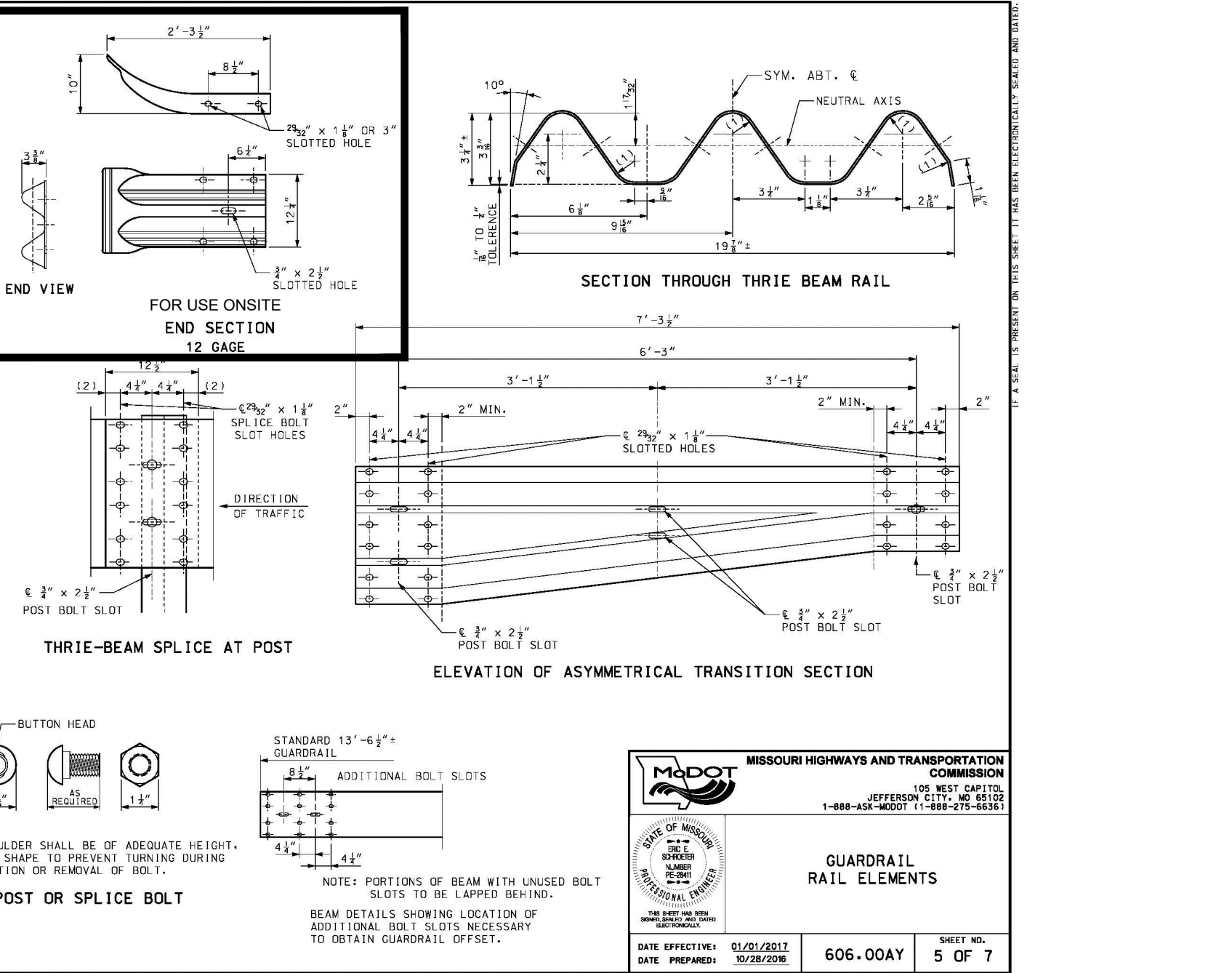
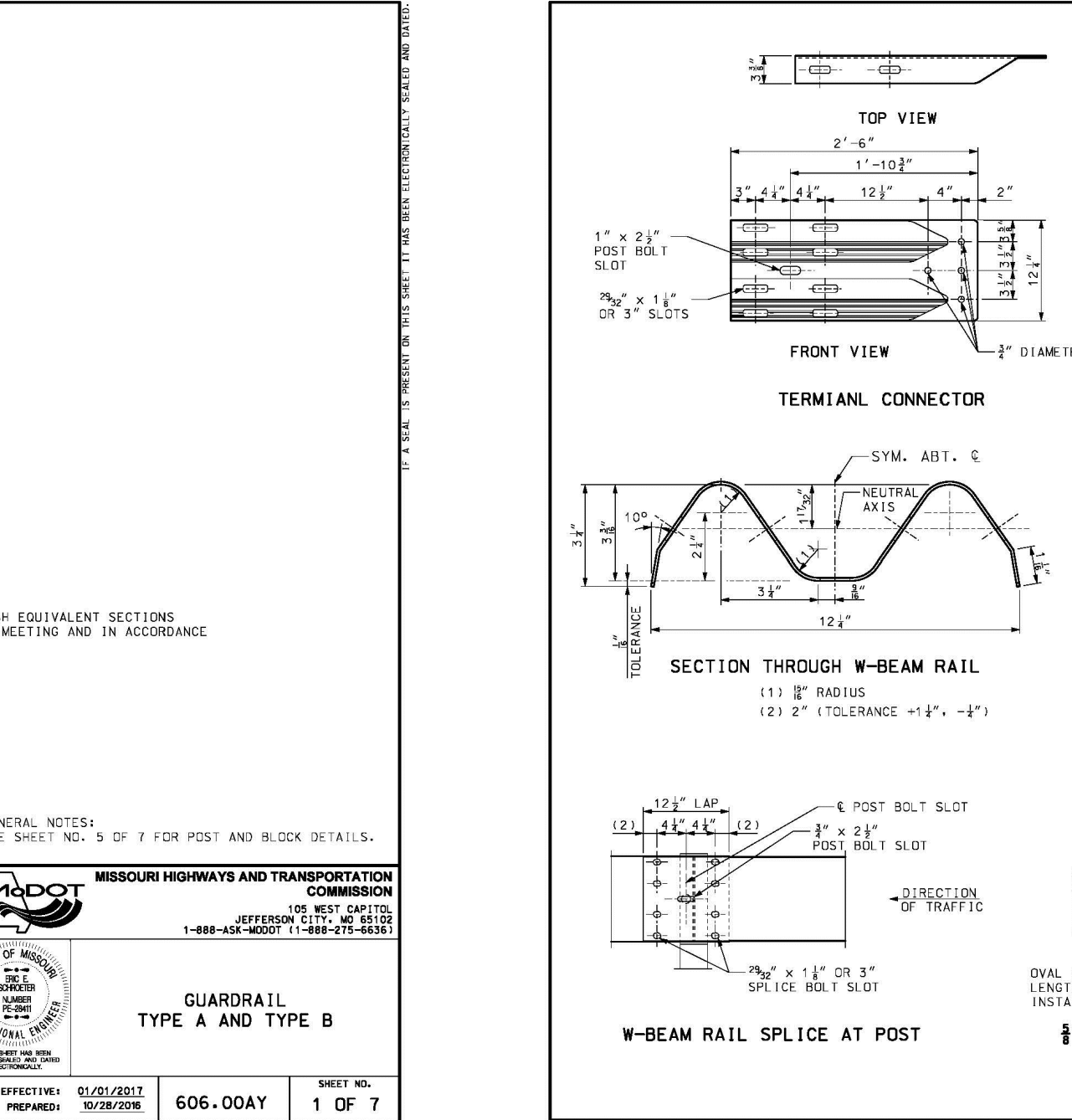
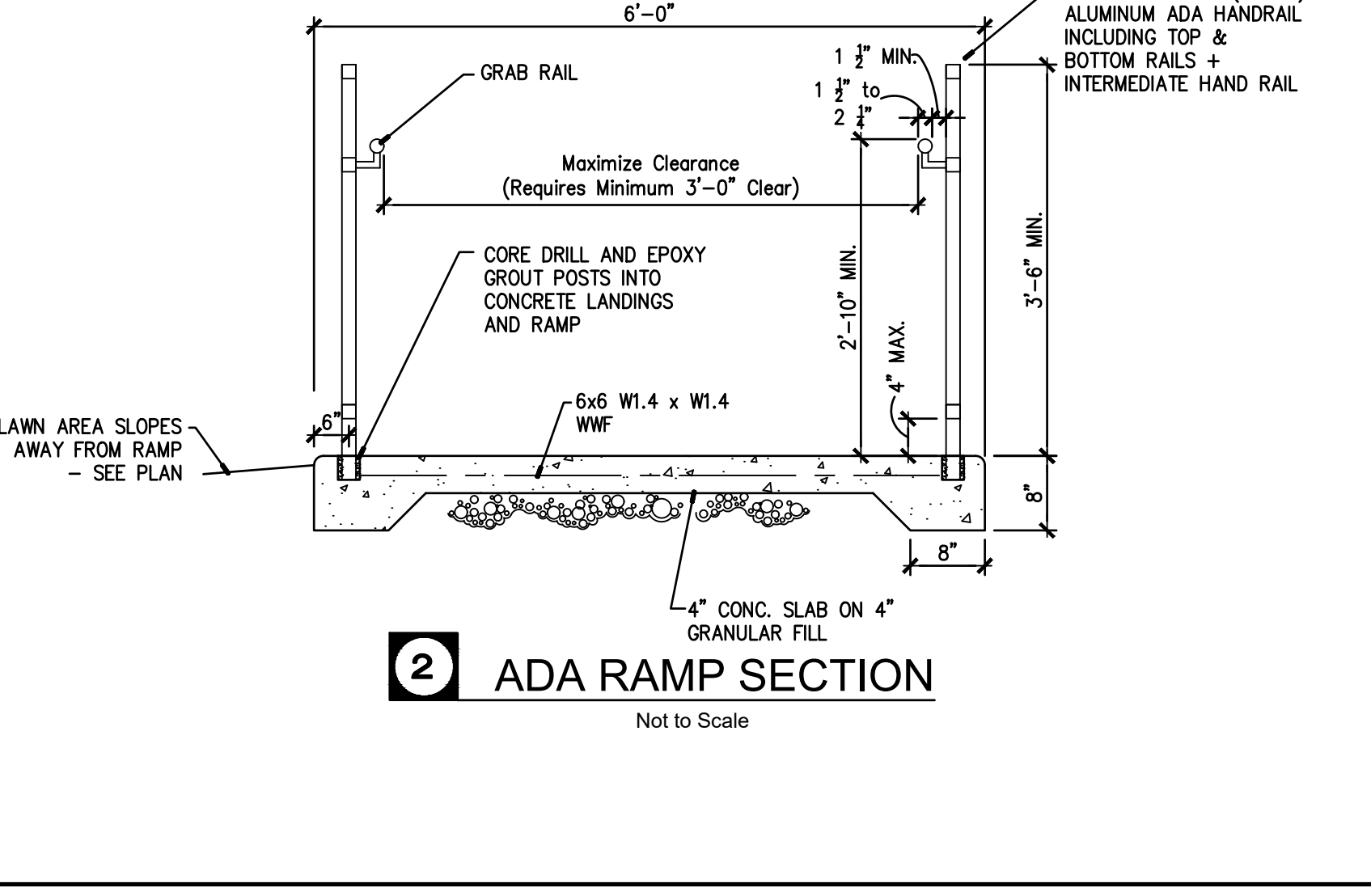
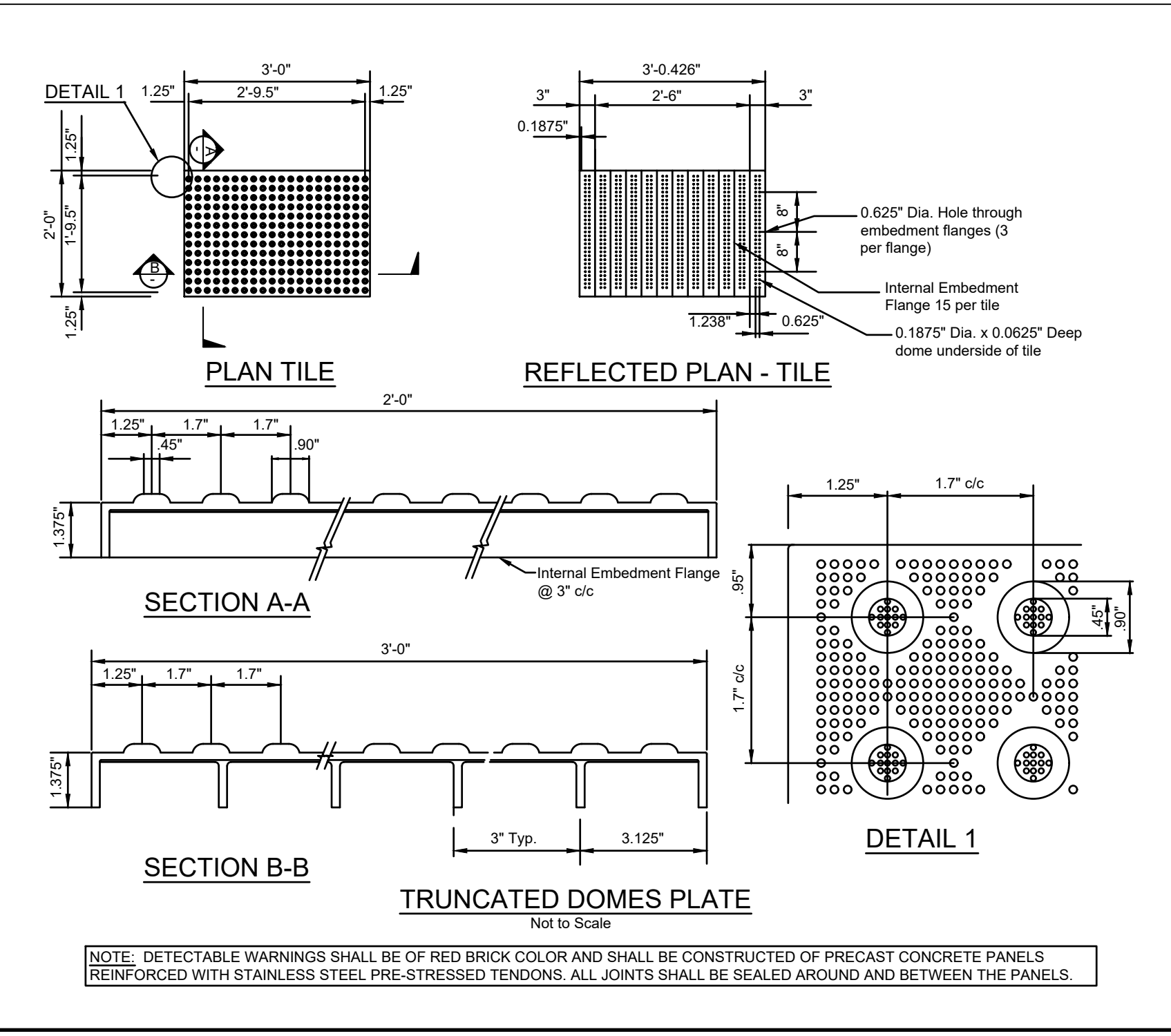
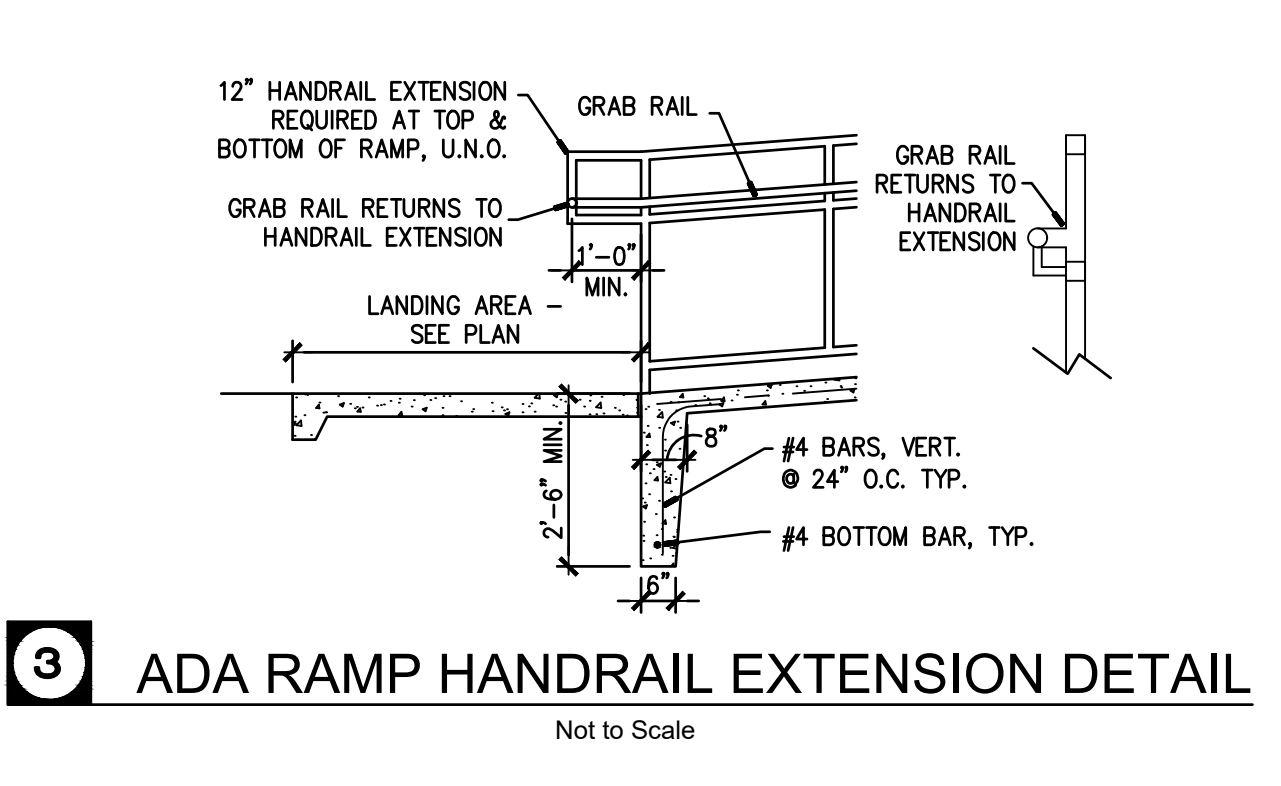
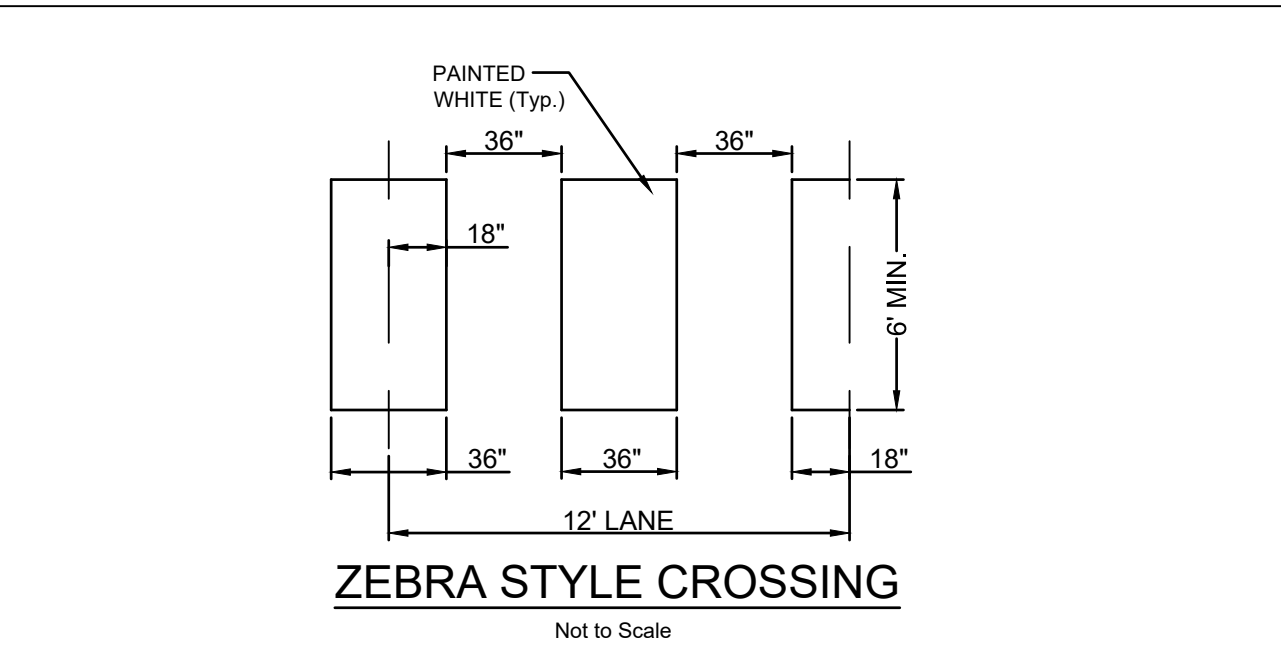
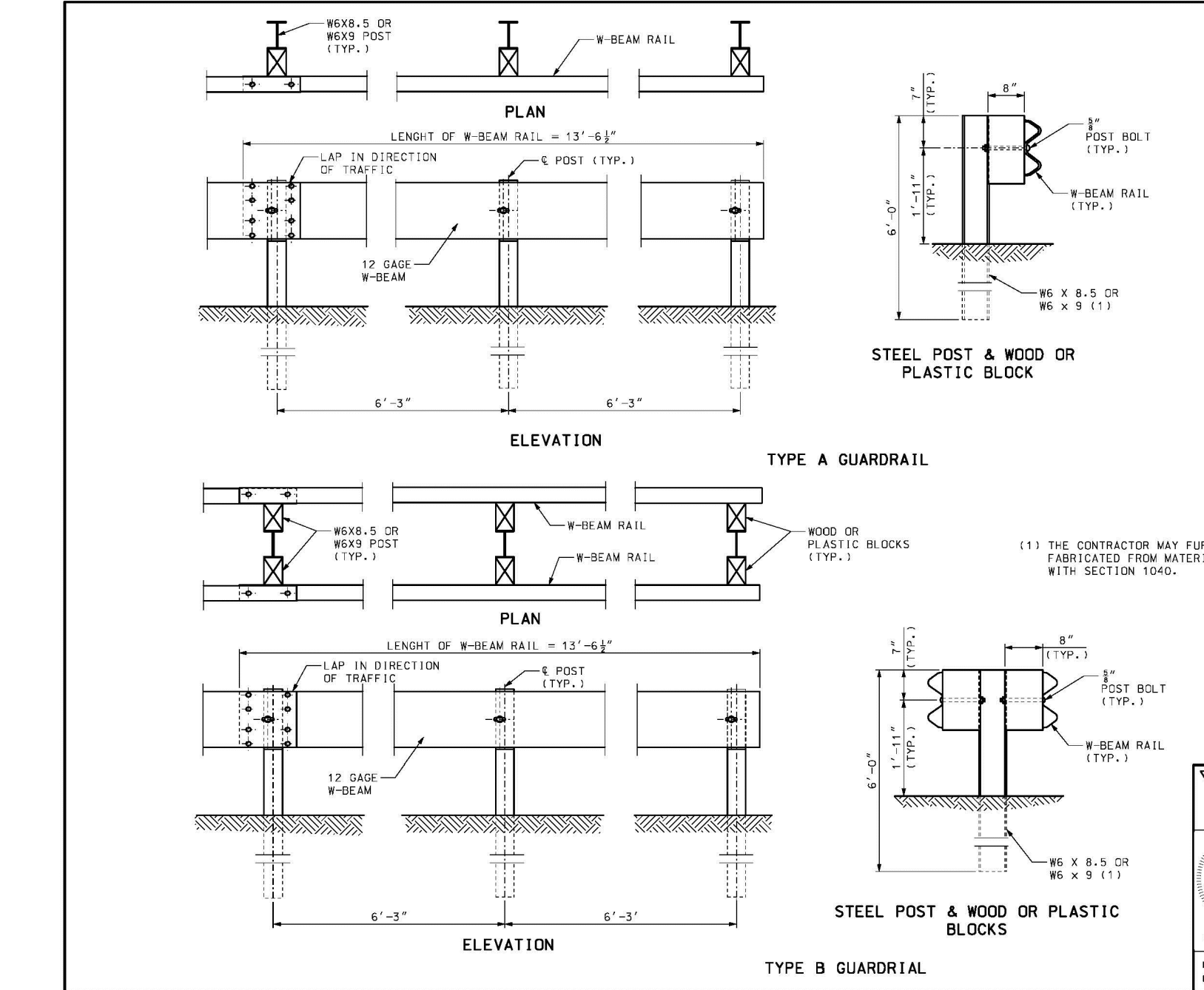
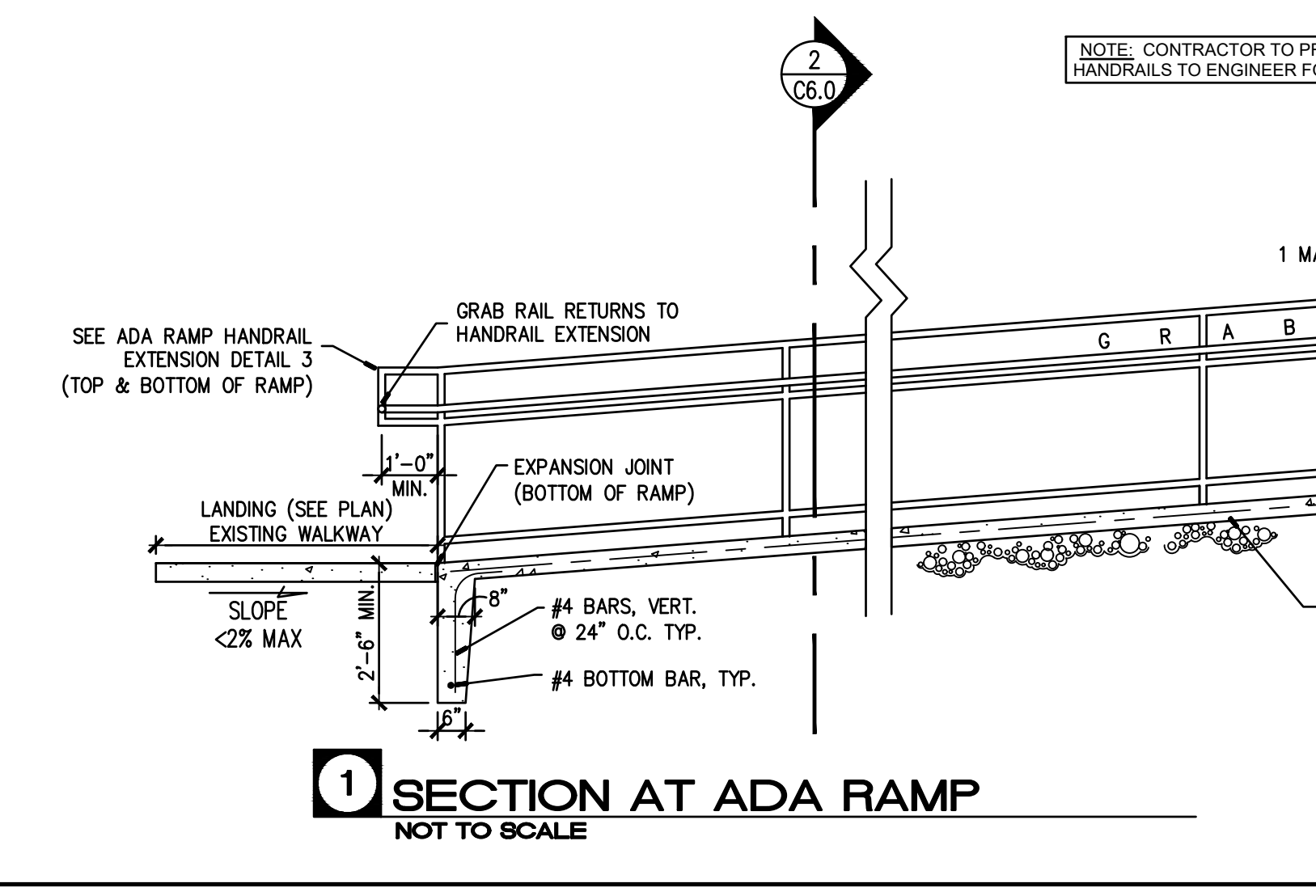
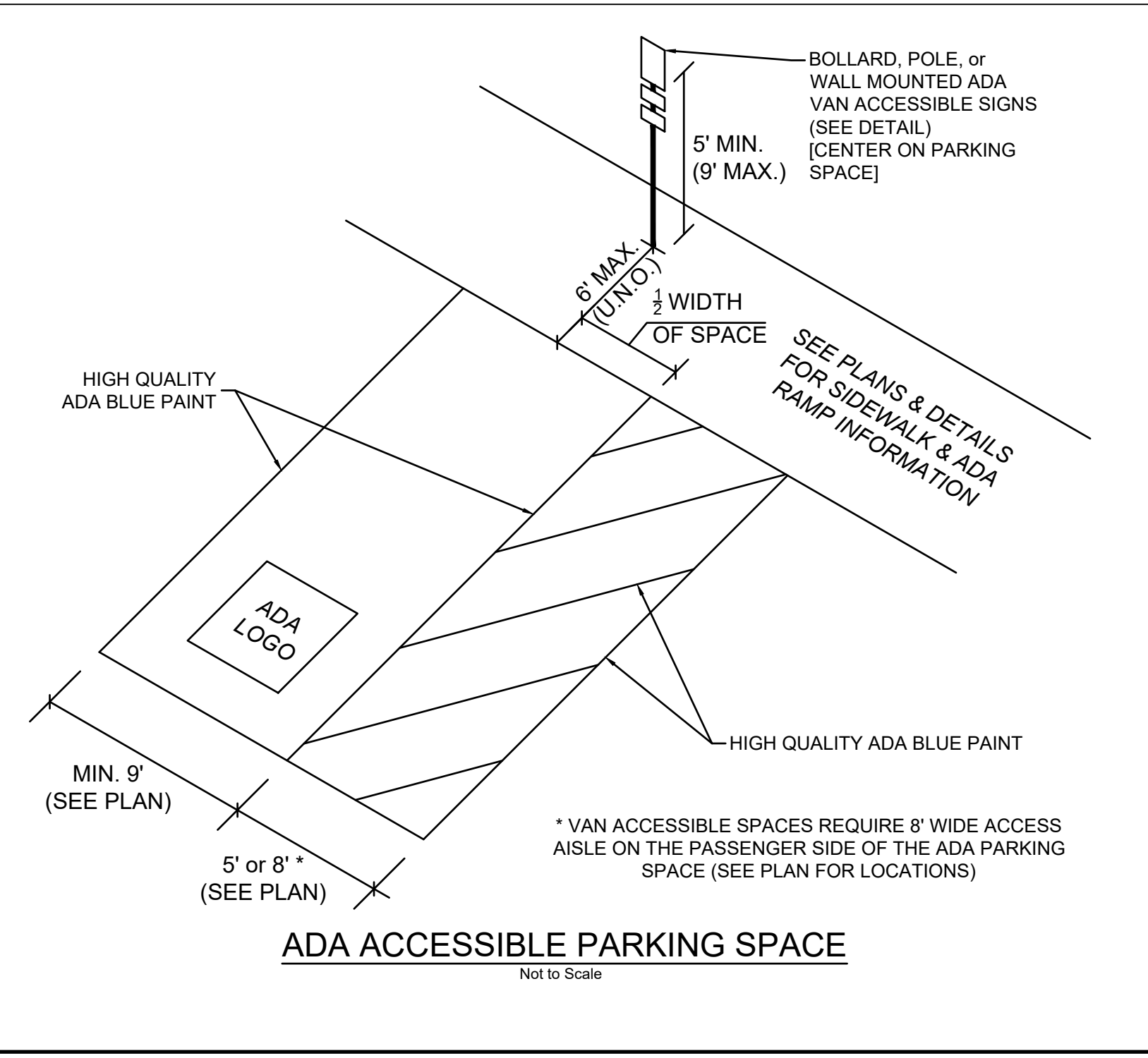

MISSOURI HIGHWAYS AND TRANSPORTATION COMMISSION
DATE EFFECTIVE: 01/01/2011
DATE PREPARED: 07/26/2009
606.00AY
SHEET NO. 1 OF 7

MISSOURI HIGHWAYS AND TRANSPORTATION COMMISSION
DATE EFFECTIVE: 01/01/2011
DATE PREPARED: 07/26/2009
606.00AY
SHEET NO. 5 OF 7

Copyright 2021
Clayton Engineering Co.
All Rights Reserved

Project Number: 20350
DESIGNED: EJS / RPK
DRAWN: EJS / RPK
CHECKED: EJS / RPK
DATE: 7-8-2007

Printed on 24" x 36" SHEET

fgma

FGM Architects Inc.
1 Metropolitan Sq, Ste. 1945
St. Louis, Missouri 63102

314.439.1601 OFFICE
314.439.1602 FAX

MISSOURI CERTIFICATE OF AUTHORITY #000311

ARCHITECTURE
FGM ARCHITECTS
1 METROPOLITAN SQ, STE. 1945
ST. LOUIS, MISSOURI, 63102
314.439.1601 (O) 314.439.1602(F)
MO STATE CERTIFICATE OF AUTHORITY
NO. 000311

CIVIL
THE CLAYTON ENGINEERING COMPANY, INC.
2388 WELSH INDUSTRIAL CT.
ST. LOUIS, MO 63146
314.692.8888 (O) 314.692.8888(F)
MO STATE CERTIFICATE OF AUTHORITY
PROF. ENG. NO. 000067 & PROF. SURVEYING NO. 000014

STRUCTURAL
ASDG, LLC
1009 LINCOLN HIGHWAY
FAIRVIEW HEIGHTS, IL 62208
618.628.0887 (O) 618.628.0889(F)
IL STATE CERTIFICATE OF AUTHORITY
NO. 184-003843

M.E.P
BRIC PARTNERSHIP, LLC
100 EAST WASHINGTON, SUITE 220
BELLVILLE, IL 62220
618.277.5200 (O) 618.277.5277(F)
IL STATE CERTIFICATE OF AUTHORITY
NO. 184-003479

Erik J. Staley - Professional Engineer
(PE-200600132)

ERIK J. STALEY, PE
ENGINEER No. 200600132

The professional engineer seal affixed to this sheet applies only to the material and items shown on this sheet. All drawings, instruments or other documents not exhibiting this seal shall not be considered prepared by this engineer, and this engineer expressly disclaims any and all responsibility for such plans, drawings or documents not exhibiting this seal.

DATE 08/25/2021

NO	DATE	DESCRIPTION
1.	08/25/21	CITY SUBMITTAL
2.	09/22/21	2nd CITY SUBMITTAL
3.	10/04/21	3rd CITY SUBMITTAL
4.	11/22/21	4th CITY SUBMITTAL (BID SET)

O'FALLON, MO MOTOMART
NEW CONVENIENCE CENTER
AND CARWASH
FKG OIL COMPANY

CONSTRUCTION DETAILS 1

SHEET NO. **C6.0**

JOB NO. 21-31331.01
© 2021 FGM Architects Inc.