

**ERIK J. STALEY, PE**  
ENGINEER No. 200600132  
The professional engineer seal offered to this sheet applies only to the material and items shown on this sheet. All drawings, instruments or other documents not containing this seal shall not be considered prepared by this engineer, and this engineer expressly disclaims any and all responsibility for such plans, drawings or documents not exhibiting this seal.  
**DATE 08/25/2021**

ISSUANCE		
NO.	DATE	DESCRIPTION
1.	08/25/21	CITY SUBMITTAL
2.	09/22/21	2nd CITY SUBMITTAL
3.	10/04/21	3rd CITY SUBMITTAL
4.	11/22/21	4th CITY SUBMITTAL (BID SET)

**O'FALLON, MO MOTOMART  
NEW CONVENIENCE CENTER  
AND CARWASH**  
FKG OIL COMPANY

**CONSTRUCTION DETAILS 3**

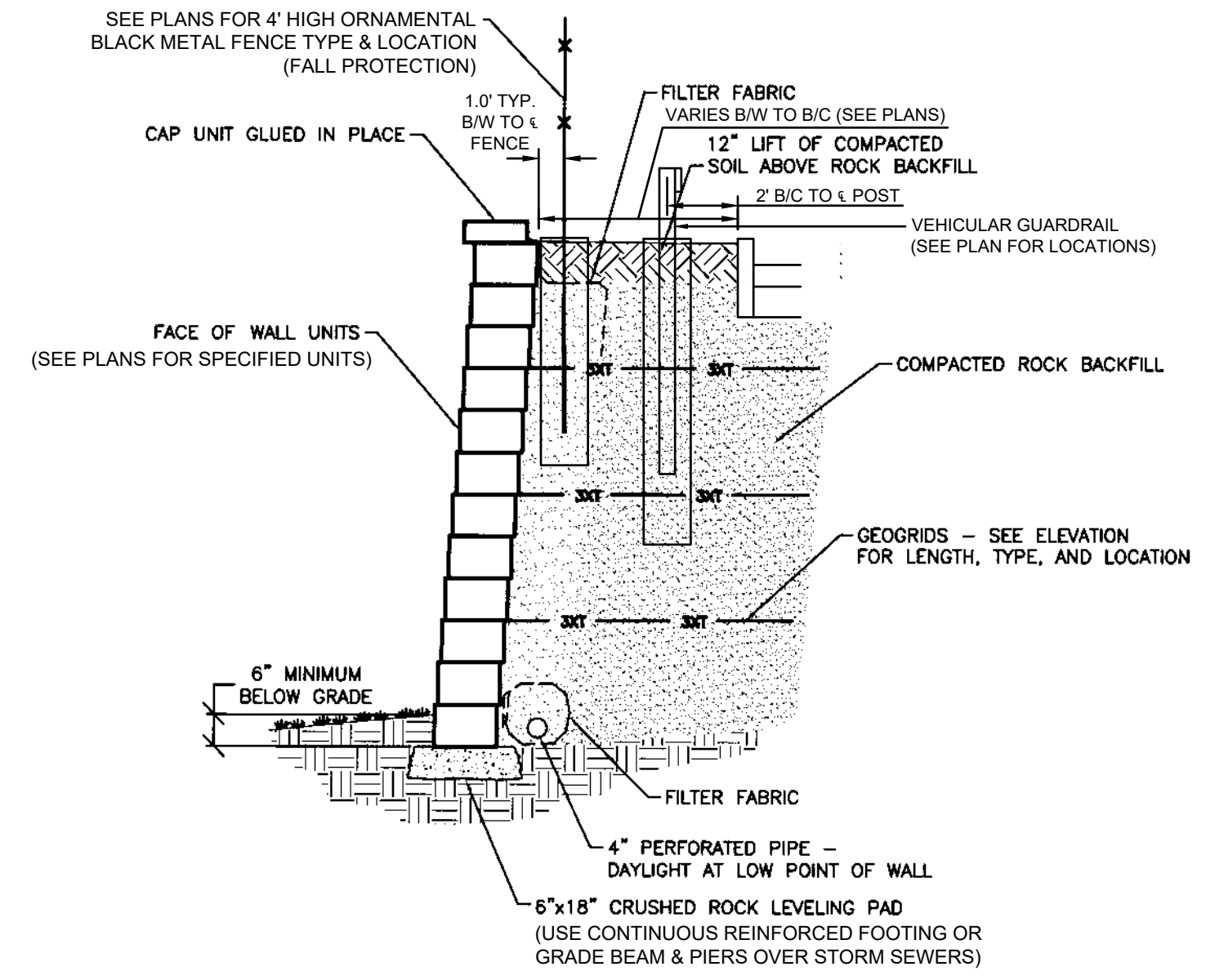

- NOTES:**
- SHOP DRAWINGS ARE TO BE PREPARED BY A PROFESSIONAL ENGINEER. THE WALL DESIGNS SHALL BE SUBMITTED TO THE PROJECT CIVIL ENGINEER FOR REVIEW PRIOR TO WALL CONSTRUCTION.
  - THE WALL DESIGN SHALL MEET THE PROJECT REQUIREMENTS AND THE LOCAL REVIEW AGENCY REQUIREMENTS TO OBTAIN A CONSTRUCTION PERMIT.
  - THE PROJECT GEOTECHNICAL ENGINEER IS TO DETERMINE THE FOUNDATION BEARING CAPACITY AND WILL PROVIDE A GLOBAL STABILITY ANALYSIS IF NECESSARY.
  - THE OWNER'S REPRESENTATIVE WILL PROVIDE FOOTING INSPECTIONS PRIOR TO CONSTRUCTION AND BACKFILL COMPACTION TESTING AS REQUIRED.
  - FENCE AND VEHICULAR GUARDRAIL SHOWN ABOVE FOR APPROXIMATE SPACING RELATIONSHIP ONLY.
  - SHOP DRAWING DETAILS AND/OR STRUCTURAL PLANS SHALL SUPERCEDE THESE PLANS AND SPECIFICATIONS.
  - USE CONTINUOUS REINFORCED FOOTING OR GRADE BEAM & PIERS FOR NEW RETAINING WALLS OVER NEW SANITARY AND STORM SEWER PIPES.
  - SHOP DRAWINGS TO INCORPORATE STRUCTURAL DESIGN AND DETAILS FOR FENCE POST FOOTINGS PER SPECIFIED FENCE SELECTION.
  - THE GENERAL CONTRACTOR IS RESPONSIBLE TO PROPERLY SEQUENCE INSTALLATION OF ITEMS LIKE STORM SEWERS, LIGHT POLES, FENCING, ETC. INTO THE PROPER CONSTRUCTION AND INSTALLATION OF THE WALL. THESE ITEMS SHOULD BE IN PLACE AT THE PROPER TIME TO INSTALL THE GEOGRIDS AROUND THESE ITEMS. CUTTING OF GEOGRIDS TO INSTALL THESE ITEMS POST WALL INSTALLATION IS NOT PERMITTED.
  - AT TOP OF RETAINING WALL, FENCE POSTS AND VEHICULAR GUARDRAIL POSTS SHALL NOT BE INSTALLED IN LINE PERPENDICULAR TO THE BACK OF WALL WHERE POSSIBLE, BUT SHOULD RATHER BE STAGGERED IN RELATION TO ONE ANOTHER. THE CONTRACTOR SHALL SUBMIT SHOP DRAWINGS OF THE FENCE DESIGN AND LAYOUT TO THE ENGINEER AND OWNER FOR REVIEW AND APPROVAL PRIOR TO SUBMITTAL TO THE CITY FOR THE FENCE PERMIT.
  - REFER TO THE GEOTECHNICAL REPORT FOR RECOMMENDATIONS FOR THIS WALL, IF AVAILABLE.

**MODULAR BLOCK RETAINING WALL DETAIL**  
N.T.S.

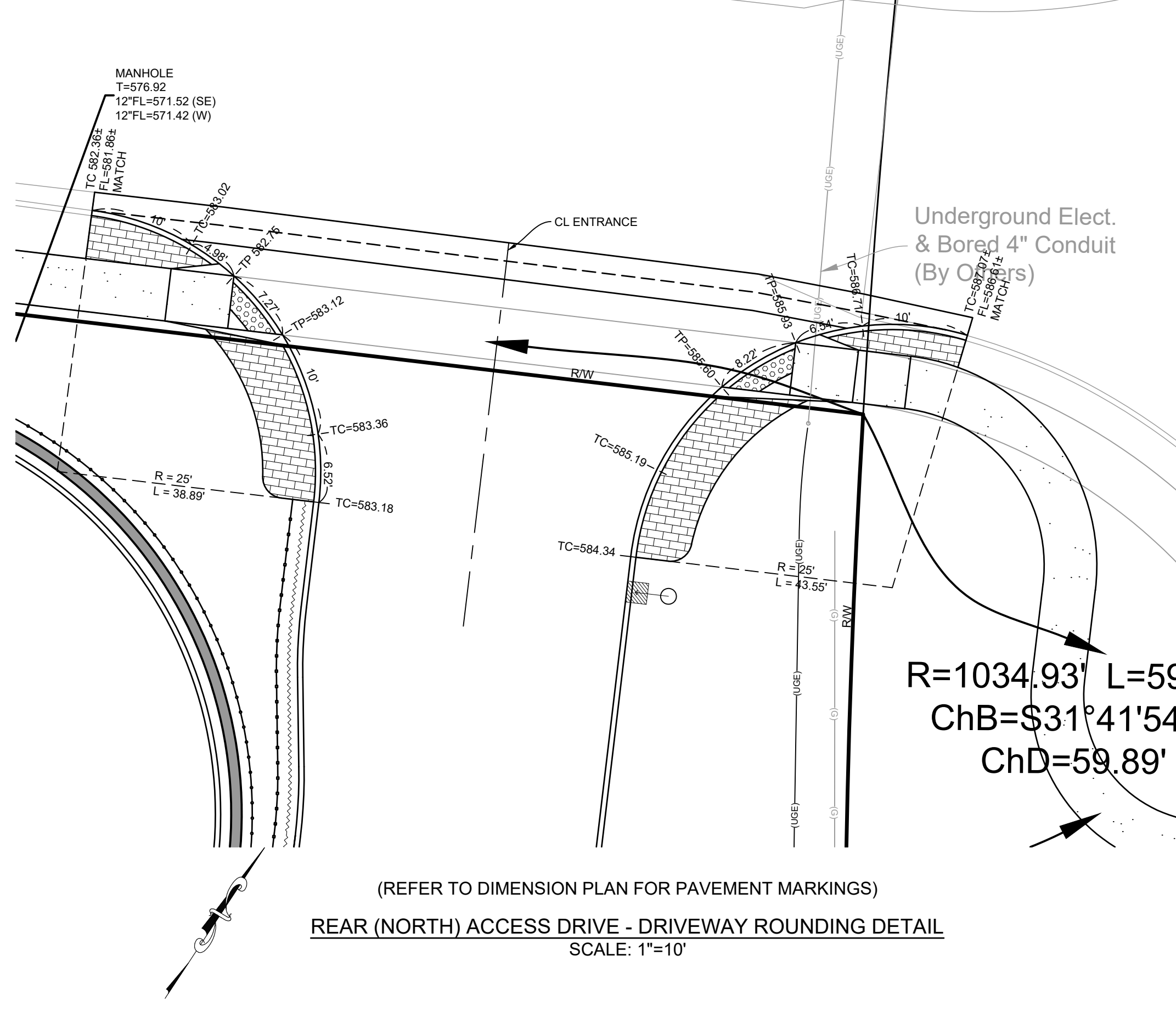

**REAR (NORTH) ACCESS DRIVE - DRIVEWAY ROUNDING DETAIL**  
SCALE: 1"=10'

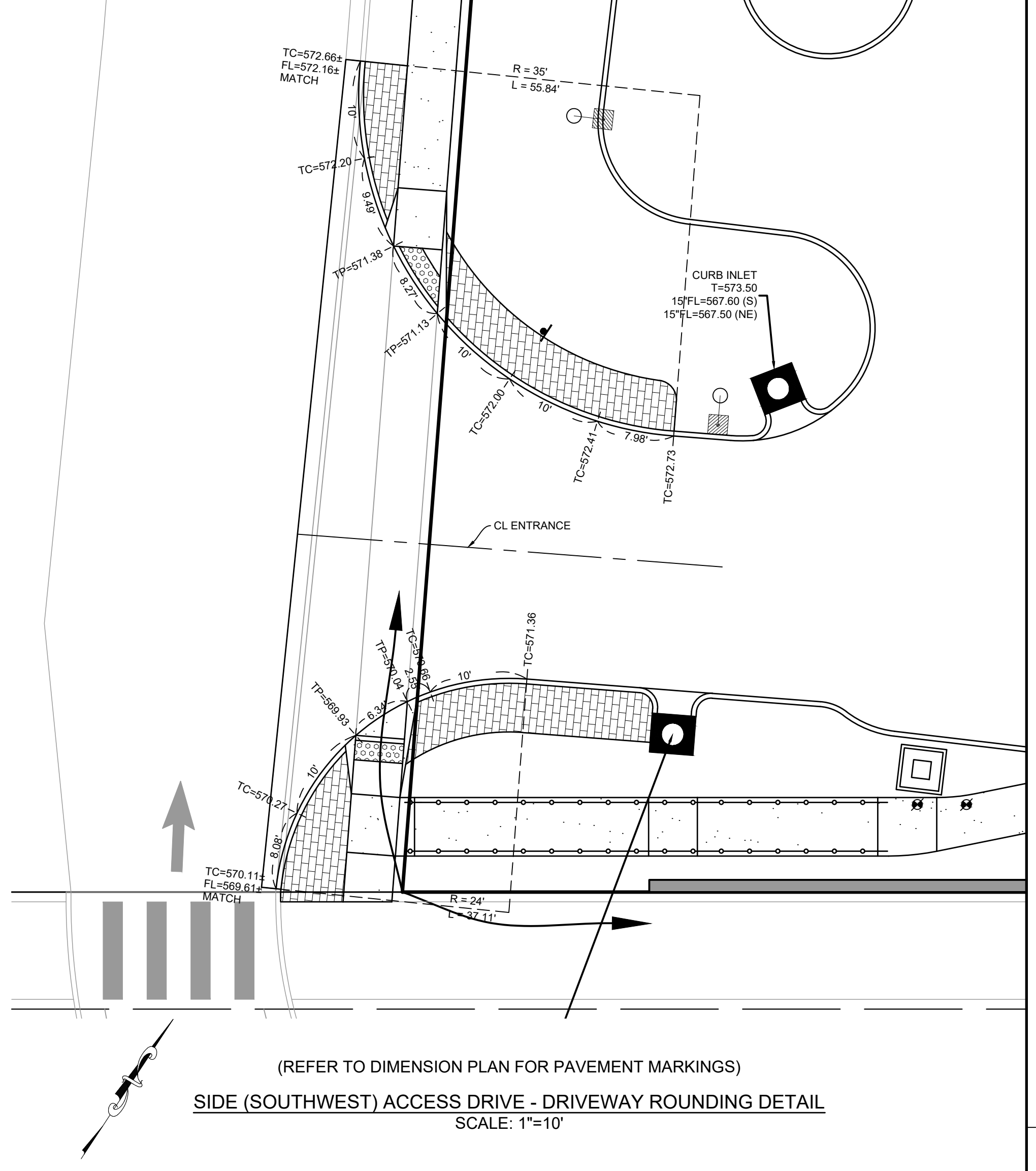

**SIDE (SOUTHWEST) ACCESS DRIVE - DRIVEWAY ROUNDING DETAIL**  
SCALE: 1"=10'

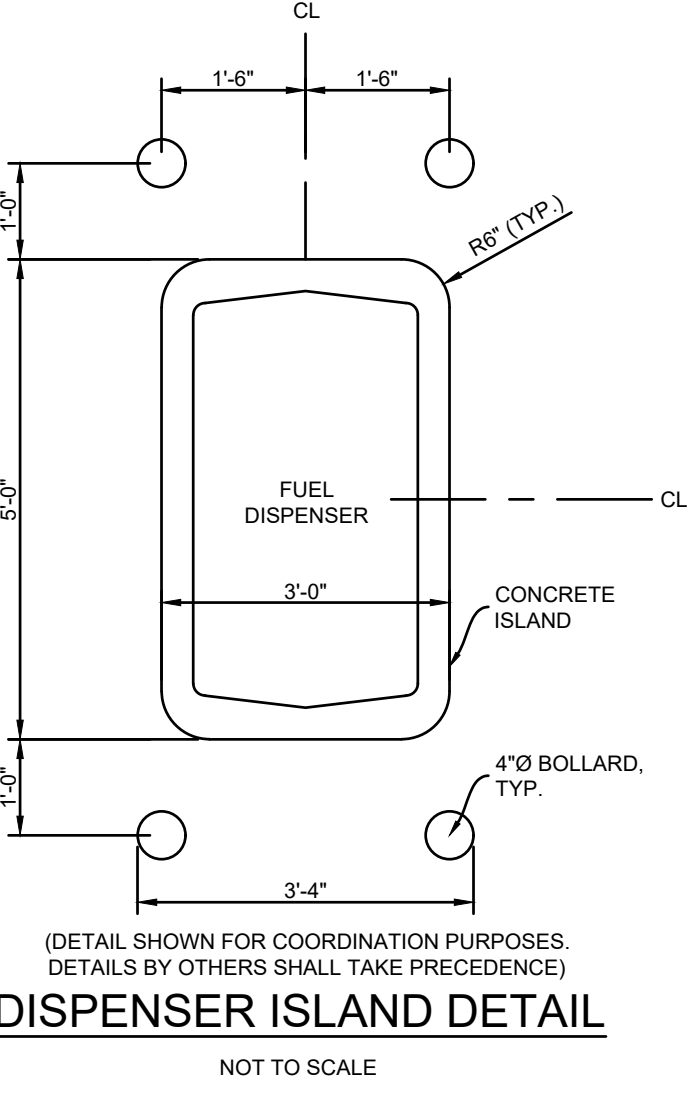

**DISPENSER ISLAND DETAIL**  
NOT TO SCALE

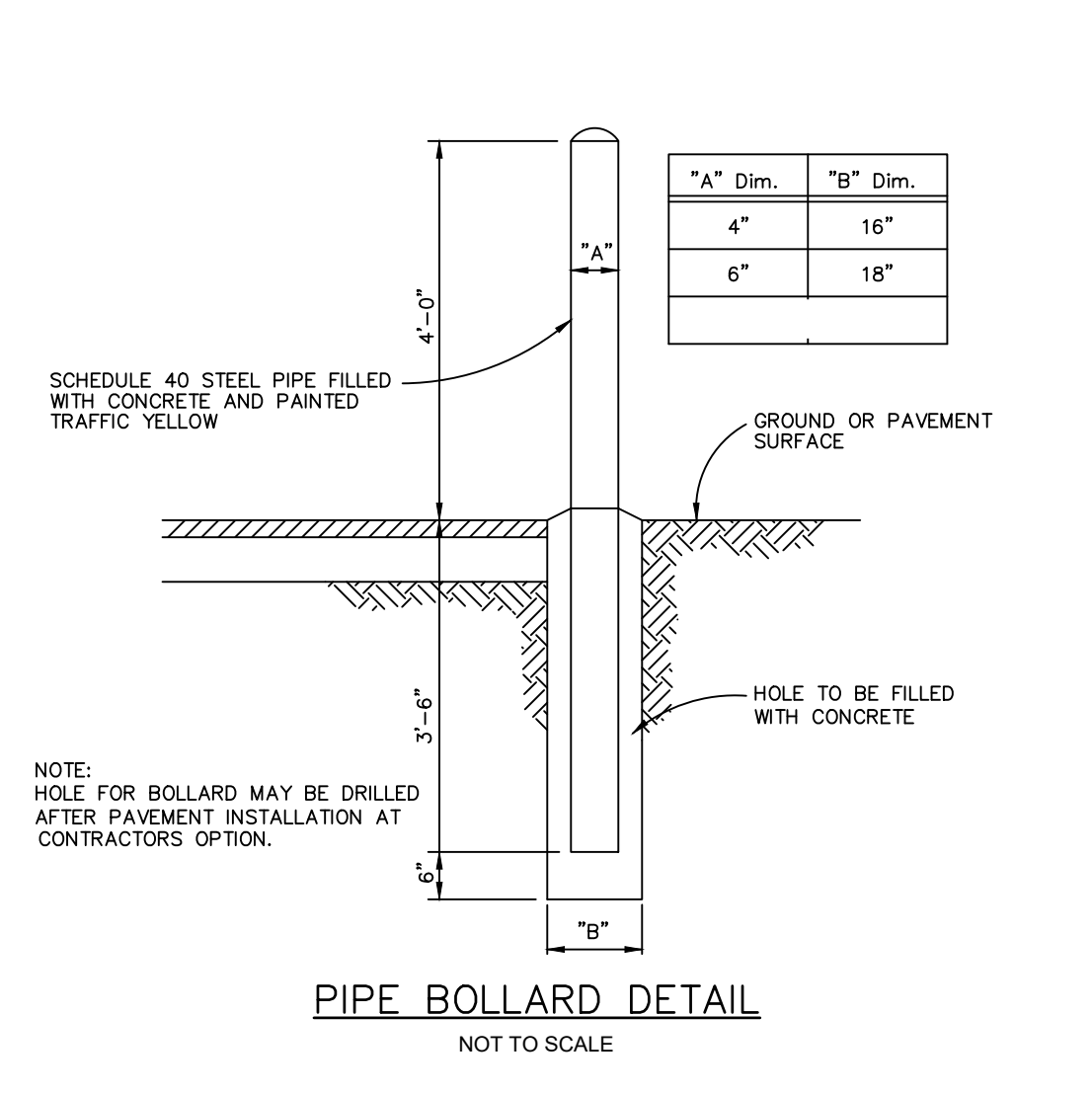

**PIPE BOLLARD DETAIL**  
NOT TO SCALE

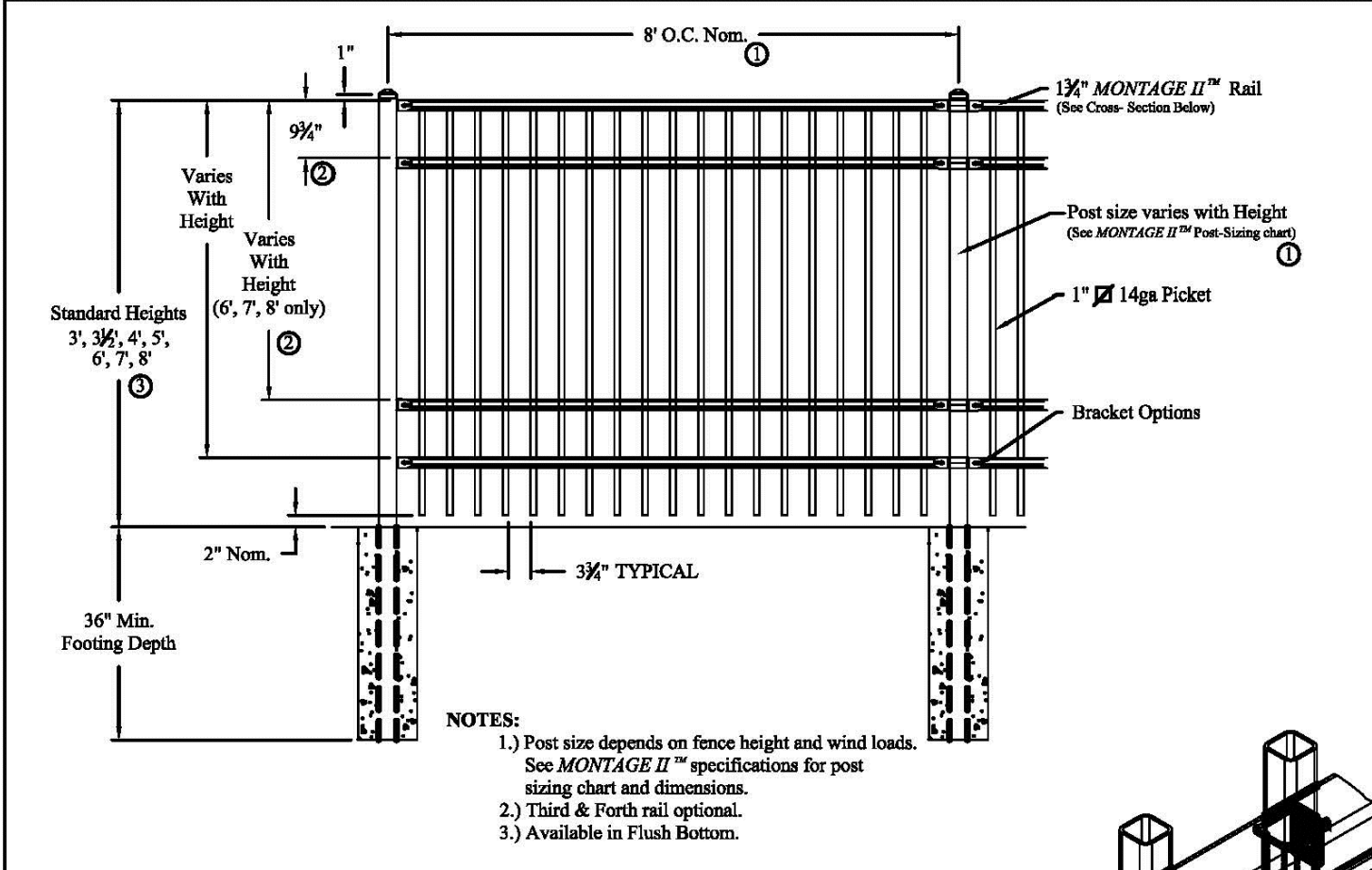

**HEAVY INDUSTRIAL STRENGTH WELDED STEEL PANEL**  
PRE-ASSEMBLED

**MONTAGE II MAJESTIC 2/3/4-RAIL**  
DR: RTM SH: 1 of 1 SCALE: DO NOT SCALE  
CK: ME Date: 6/28/10 REV: b

1555 N. Mingo  
Tulsa, OK 74116  
1-888-333-3422  
www.ameristarfence.com

**AMERISTAR**

ORNAMENTAL BLACK METAL FENCE ON TOP OF RETAINING WALL TO BE 4-FOOT HIGH AMERISTAR MONTAGE II MAJESTIC 3-RAIL

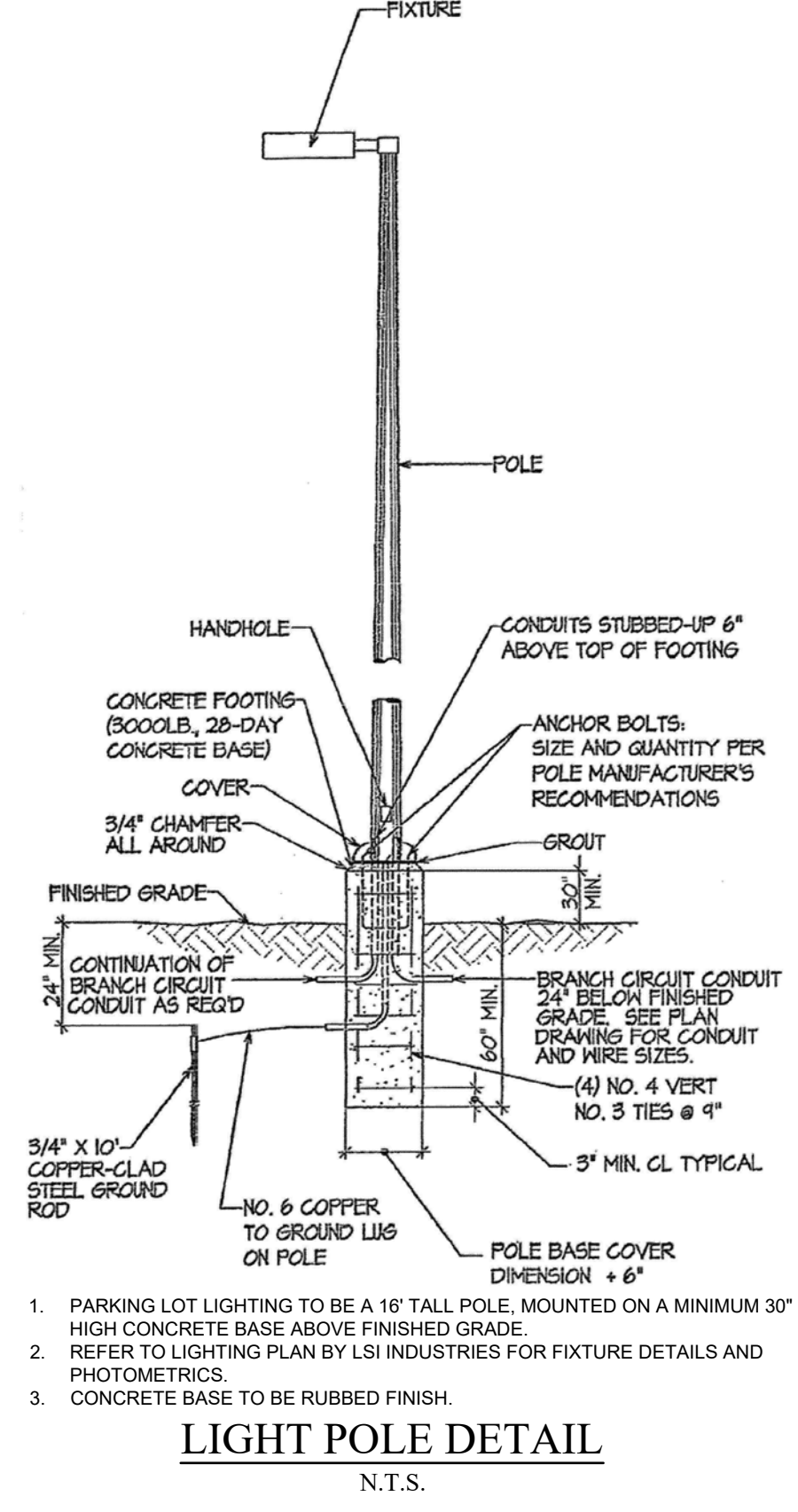

**LIGHT POLE DETAIL**  
N.T.S.

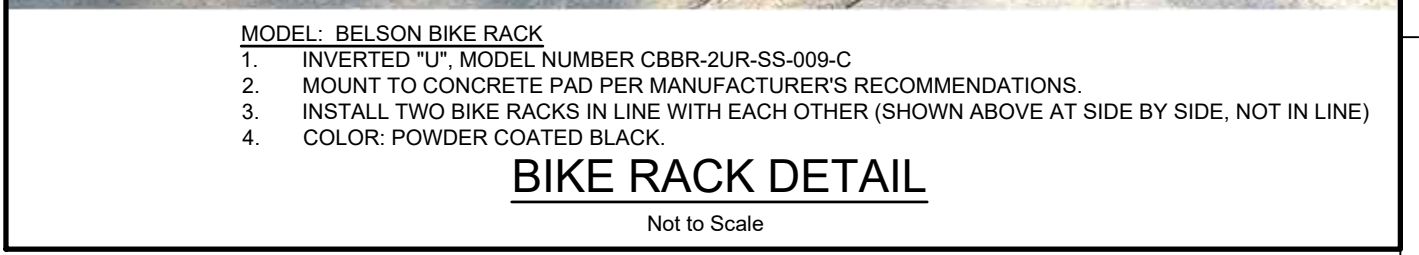

**BIKE RACK DETAIL**  
Not to Scale



Call Before you DIG  
Dial 811 or TOLL FREE  
1-800-344-7483  
m1call.com  
MISSOURI ONE-CALL SYSTEM INC.

The original signed and sealed of this drawing is on file at the office of The Clayton Engineering Company. Any modifications to this drawing shall release said The Clayton Engineering Company, the Engineer and/or Surveyor whose seal appears hereon from any liability resulting from said unauthorized modifications. The signed and sealed original is the official document and shall take precedence over any digital version.

The Contractor shall be responsible for verifying the actual location of all underground facilities, structures, & utilities, either shown or not shown on these plans. The underground facilities, structures, & utilities shall be located in the field prior to any grading, excavation or construction of improvements. These provisions shall in no way absolve any party from complying with the Underground Facility Safety and Damage Prevention Act.