

KING'S CROSSING
P.B. 36, PG. 233,234
ZONED R-1

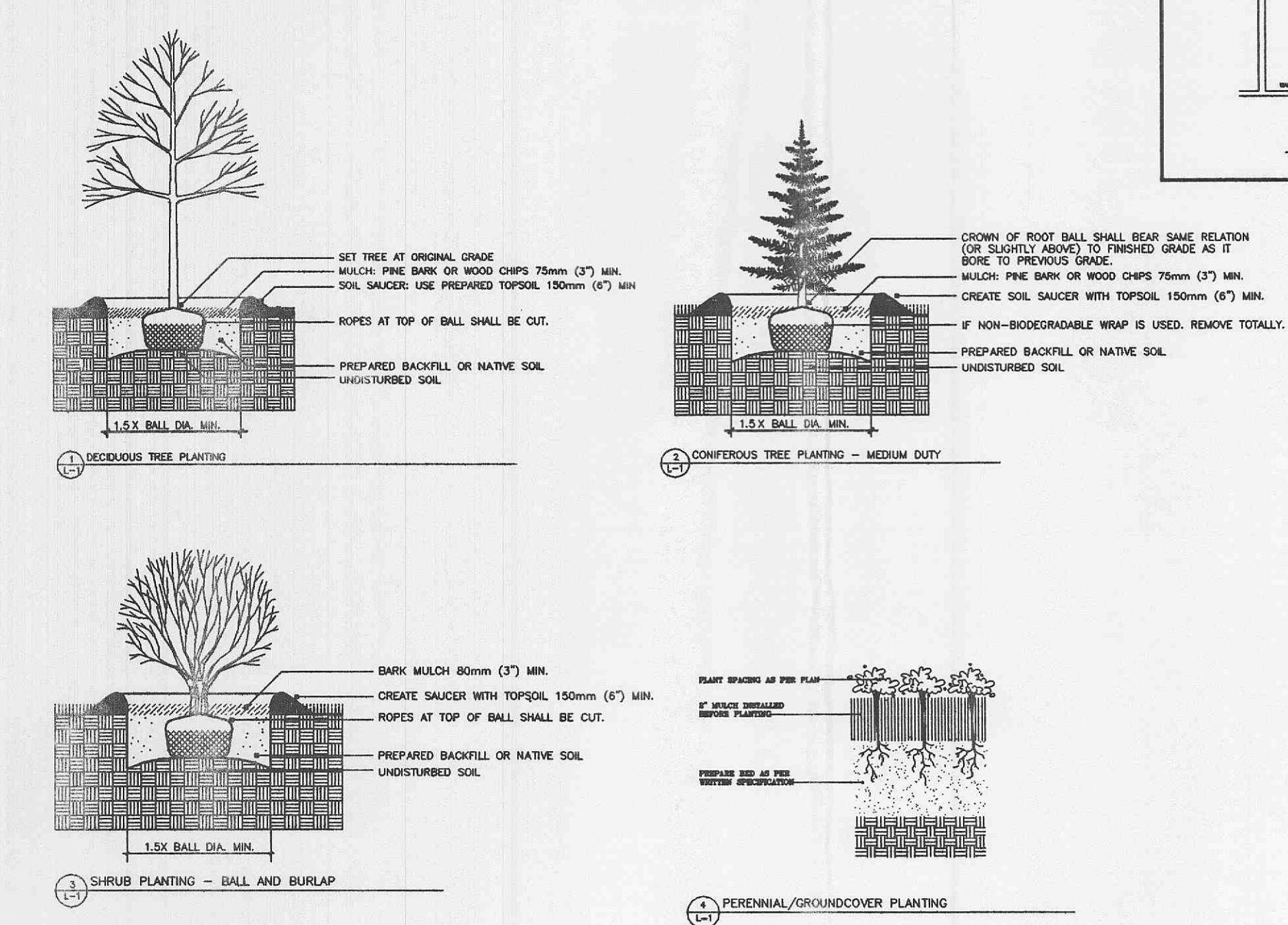
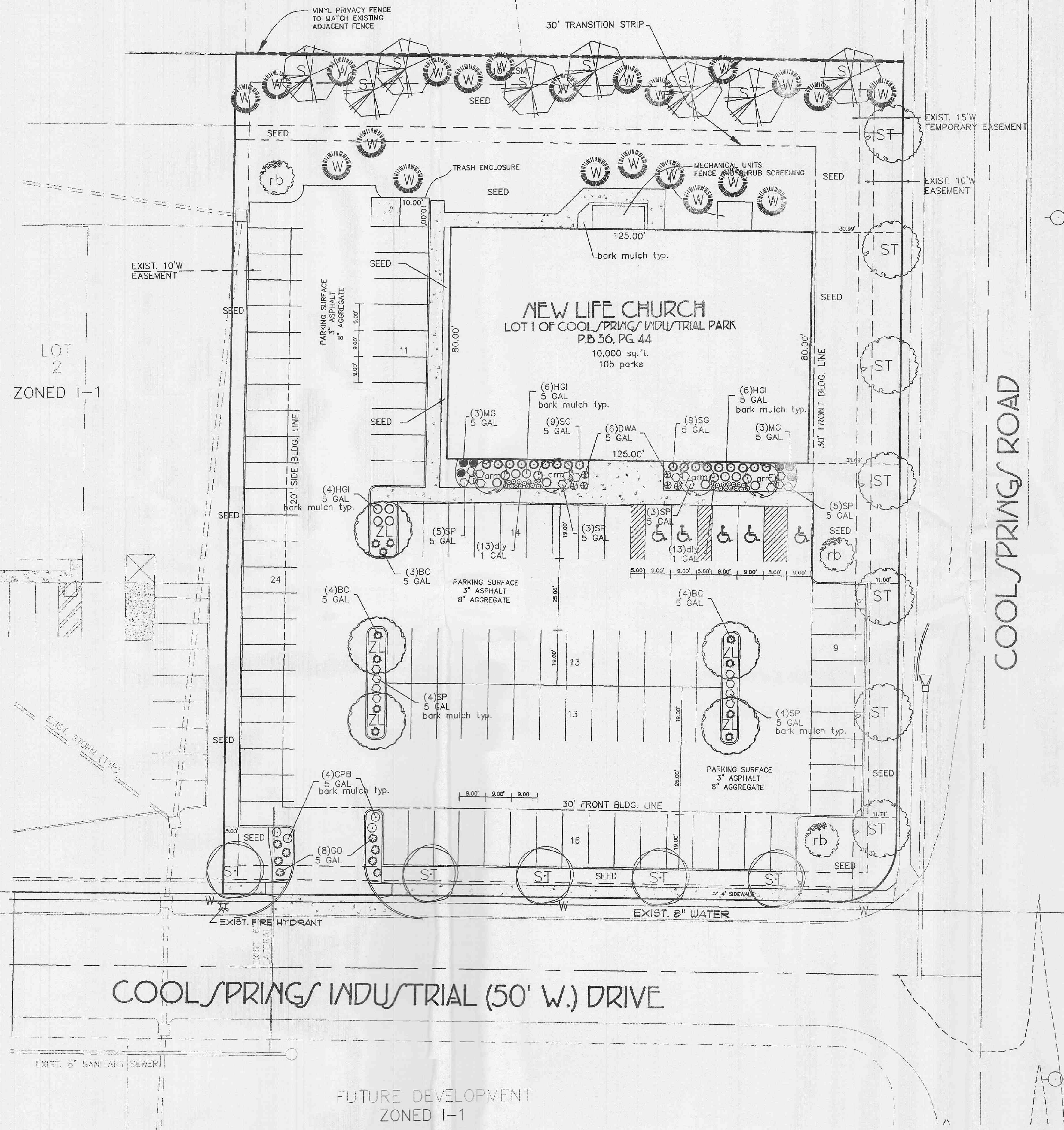

PLANT MATERIAL LIST			
QTY.	SYMB.	COMMON NAME	SIZE
22	W	WHITE PINE	6'
12	ST	STREET TREE (Ash, Oak, Maple)	2.5"
8	S	SHADE TREE (Birch, Oak)	2"
5	ZL	ZELKOVA	2"
4	arm	ARMSTRONG COLUMNAR MAPLE	2"
3	rb	REDBUD	2"
18	SG	SEA GREEN JUNIPER	5 GAL
8	GO	GREY OWL JUNIPER	5 GAL
11	BC	BLUE CHIP JUNIPER	5 GAL
4	CPB	CRIMSON PYGMY BARBERRY	5 GAL
16	HGI	HENRY'S GARNET ITEA	5 GAL
24	SP	MAGIC CARPET SPIREA	5 GAL
6	MG	MAIDEN GRASS	5 GAL
6	DWA	DWARF HAMELN GRASS	5 GAL
26	dly	STELLA D'ORO DAYLILY	1 GAL
17		BARK MULCH	CY
2,676		SEEDED LAWN	SY

NOTE: SEEDED LAWN APPROXIMATE, TO BE REMEASURED ONCE CONSTRUCTION IS COMPLETED.
PLANTING BEDS TO BE SPADE-CUT EDGE W/ SHREDDED HARDWOOD BARK MULCH TYPICAL.

"I-1" LANDSCAPE REQUIREMENTS

STREET TREES:
1 TREE FOR EVERY 40 LN FT OF STREET FRONTAGE
200 LN FT @ COOL SPRINGS INDUSTRIAL DRIVE
290 LN FT @ COOL SPRINGS ROAD
490 LN FT STREET FRONTAGE (PUBLIC & PRIVATE)
490 LN FT / 40 = 12.25 TREES REQUIRED
= 12 TREES PROVIDED

INTERIOR PARKING:
105 PARKING SPACES x 270 = 28,350 SQ. FT.
6% OF 28,350 = 1,701 SQ. FT. REQUIRED LANDSCAPING
SHRUB PLANTINGS = 1,701 SQ. FT. PROVIDED

OPEN SPACE:
1 TREE FOR EVERY 4,000 SQ. FT.
67,330 SQ. FT. PROPOSED SITE = 1.55 ACRES
= 45,261 SQ. FT. PROPOSED BLDGS., & PARKING
22,069 SQ. FT. REMAINING OPEN SPACE
22,069 SQ. FT. / 4,000 SQ. FT. = 5.51 TREES REQUIRED
= 6 TREES PROVIDED

30' BUFFERYARD:
FOR EVERY 100 LN FT OF FRONTAGE WHERE BUFFERYARD IS REQUIRED
3 PLANT UNITS AND A SIGHTPROOF 6' VINYL FENCE SHALL BE PROVIDED
231 LN FT / 100 x 3 = 6.9 PLANT UNITS REQUIRED (208 Pts.)
7.0 PLANT UNITS PROVIDED (210 Pts.)
(13) 6' WHITE PINE (10 pts. ea.) & (8) 2" SHADE TREE (Ash, Oak, Maple) (10 pts. ea.) = 210 PTS.

SCREENING:
9 WHITE PINE DEDICATED TO SCREEN UTILITIES AND DUMPSTER.

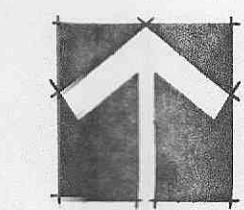

LANDSCAPE PLAN
SCALE: 1" = 20'0"

NOTICE
This drawing is the property of A. Waldbart and Sons Nursery. Each plan formulated by our firm involves original thought and ideas; therefore, we reserve the copyright to any design prepared by our staff. Use of this plan and/or any portion thereof for competitive bids, pricing, or related purposes is illegal without our written permission.

PROJECT

BUILDER

895-4589

A. WALDBART AND SONS
Nursery
Established 1872
Landscape Designers, Landscape Contractors & Nurserymen
1420 Teson Rd., Hazelwood, MO 63042

Revised	REVISION	DATE	DATE
Approved	APPROVED	SCALE	SCALE
Sheet	SHEET		
Revised Date	REVISED DATE		
Drawn By	DRAWN BY		