

c:\char\o'fallon, mo\43-0124e.dwg Tue Jan 18 10:46:34 2000 Michael L. Donoho, Project Manager [R14]

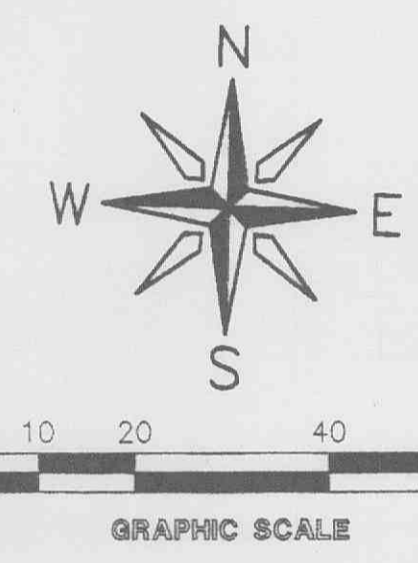
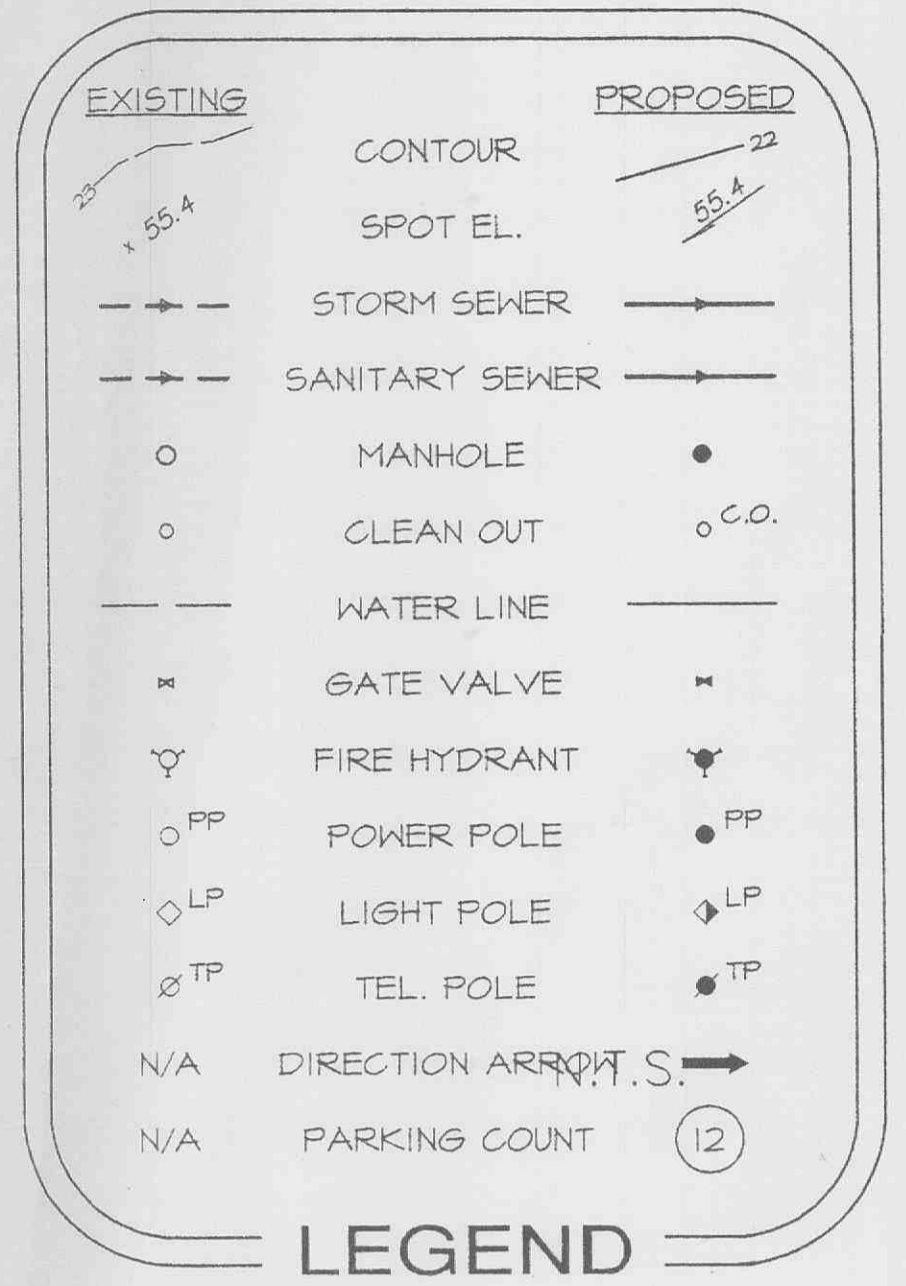
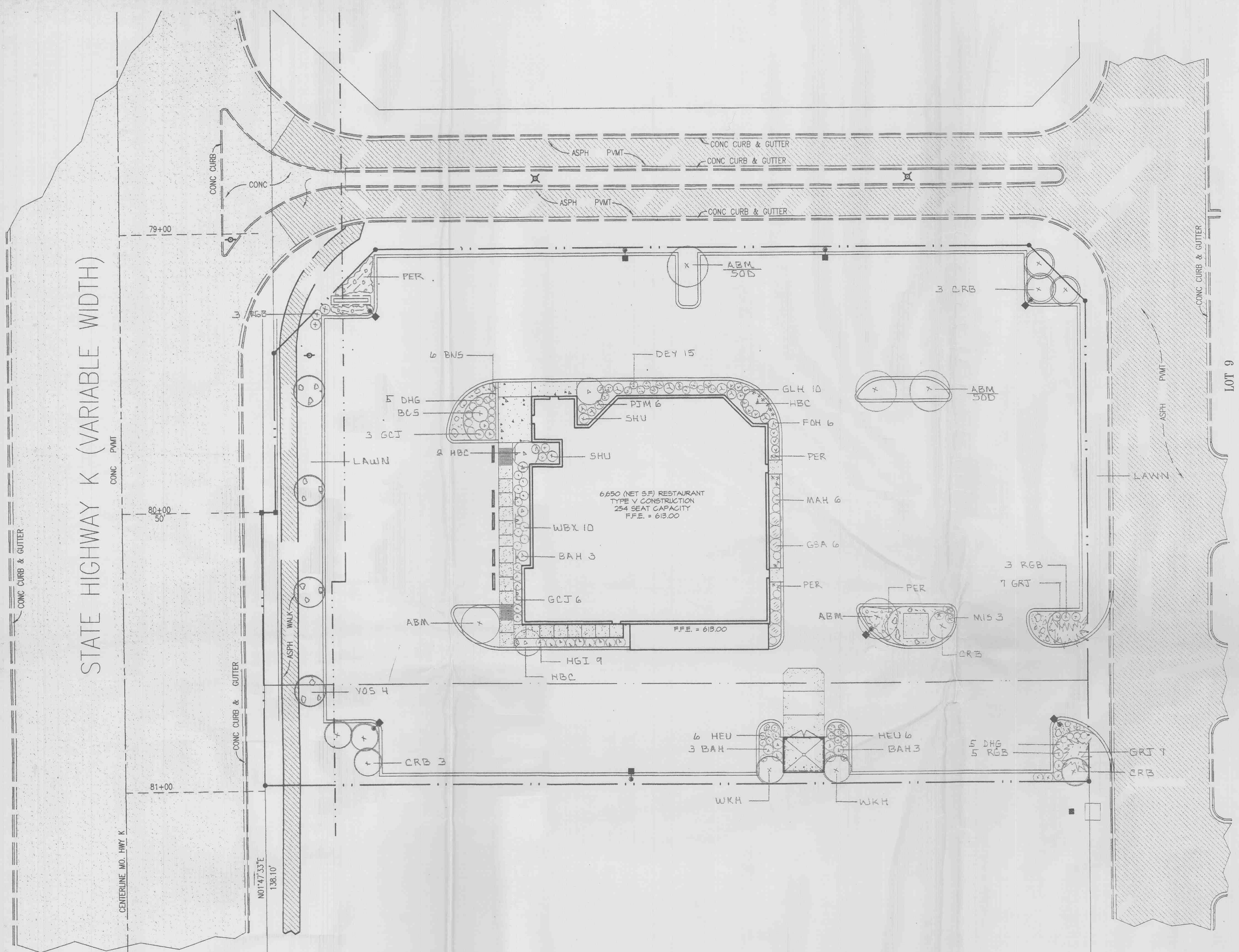

O'Charley's Restaurant
City of O'Fallon, Missouri
Plant and Material Legend

Sym	Common Name	Size	Qty.	Remarks
PER	Perennial	6"	120	Sun / Shade
STL	Stella D'Oro Daylily	12"	27	
HEU	Heschera Purple Palace	6"	12	
OGI	Gold Coast Juniper	15"	9	
RGB	Rose Glow Barberry	24"	11	
GVB	Green Velvet Boxwood	15"	10	
DHG	Dwarf Hamlin Grass	12"	10	
BAH	Blue Angel Holly	36"	9	
HGI	Henry's Garnet Itea	30"	9	
MAH	Mahonia	30"	6	
SHV	Shasta Viburnum	36"	2	
GSA	Gold Spire Arborvitae	48"	6	
DEY	Densifloris Yew	24"	15	
BCS	Bristle Cone Pine	6'-7'	1	
BNS	Bird Nest Spruce	12"	6	
GRJ	Grey Owl Juniper	24"	14	
MIS	Miscanthus Morning Light	50"	9	
NPB	Nano-purple Butterfly	56"	8	
GLH	Green Lustre Holly	18"	10	
FHM	Rhododendron	24"	6	
FOH	Fothergilla Mt. Aury	30"	6	
CRB	Champ Redbud	8'-10'	8	Multi-stem
WKH	Winterking Hawthorn	10'-12'	2	Multi-stem
ABM	Autumn Blaze Maple	2" cal.	5	
YOS	Yoshino Cherry	2" cal.	4	
HBC	Heritage Birch Champ	10'-12'	4	Multi-stem

Landscape Notes
R/R 1" river stone 3" deep and boulders to areas as noted
Install premium blend sod to property lines
Install premium hardwood mulch 3" deep to all planting beds
Toro irrigation system coverage to all landscaped areas



OWNER: O'CHARLEY'S, INC.
5030 SIDCO DRIVE
NASHVILLE, TENNESSEE 37204
(615) 256-8500

ENGINEER: DESIGN AND ENGINEERING, P.C.
515 MARSLAND WAY, SUITE 200
NASHVILLE, TENNESSEE 37027-1500
(615) 370-1774

MFE: KURTZNIKE and ASSOCIATES
NASHVILLE, TENNESSEE 37210
(615) 259-5203

A NEW O'CHARLEY'S RESTAURANT
LOCATION
2204 STATE HIGHWAY K
CITY OF OFALLON, MISSOURI
LANDSCAPE PLAN

DATE ISSUED
JANUARY 24, 2000
REVISIONS

