

SEE SHEET C9 FOR CONTINUATION

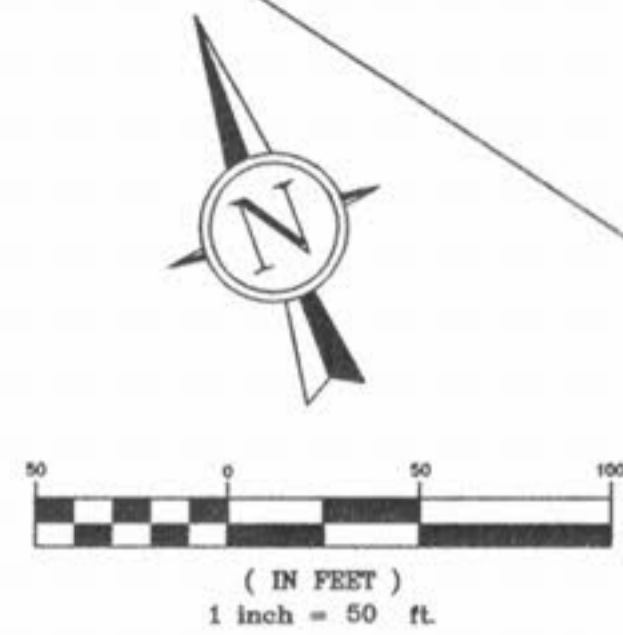

N/F  
DONALD E. STANFILL  
DB. 3739, PG. 1543  
OFFICE/WAREHOUSE

30' W. INGRESS, EGRESS,  
& UTILITY EASEMENT  
DB. 1495, PG. 969

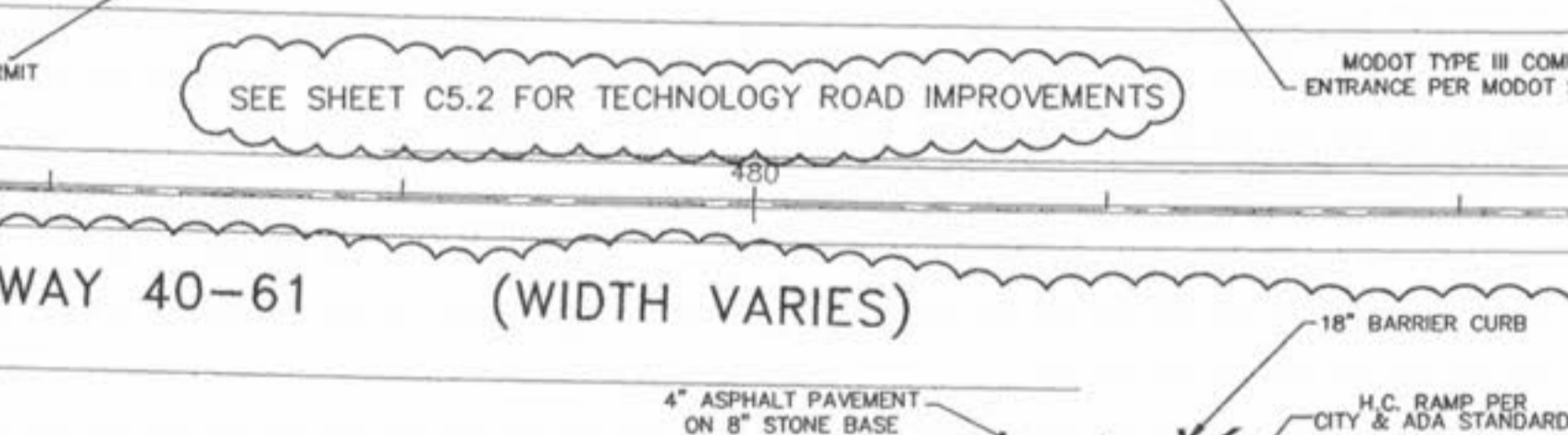
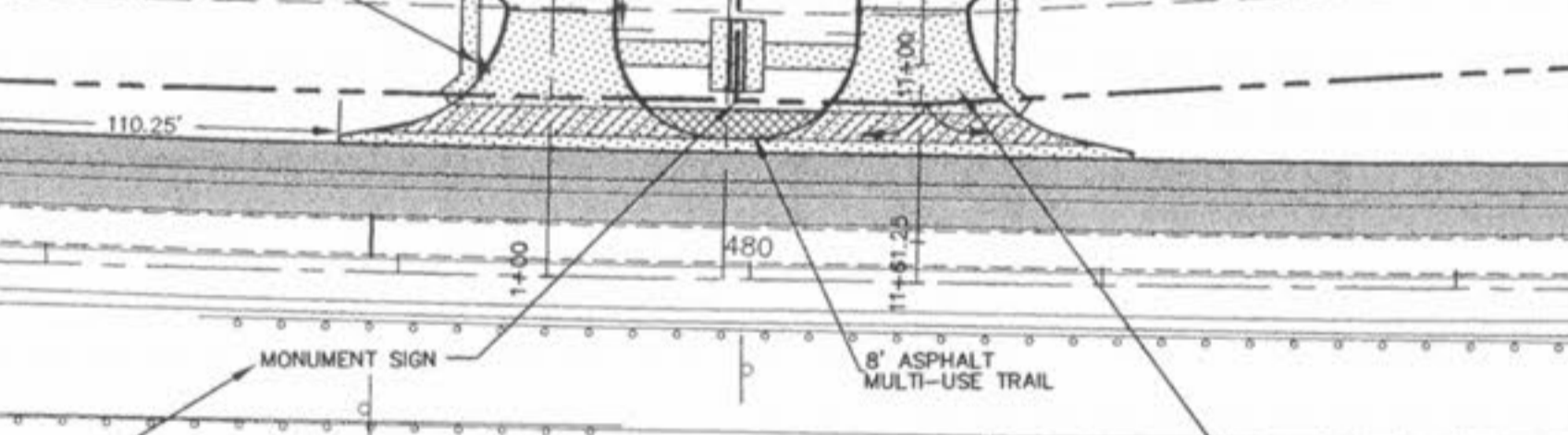
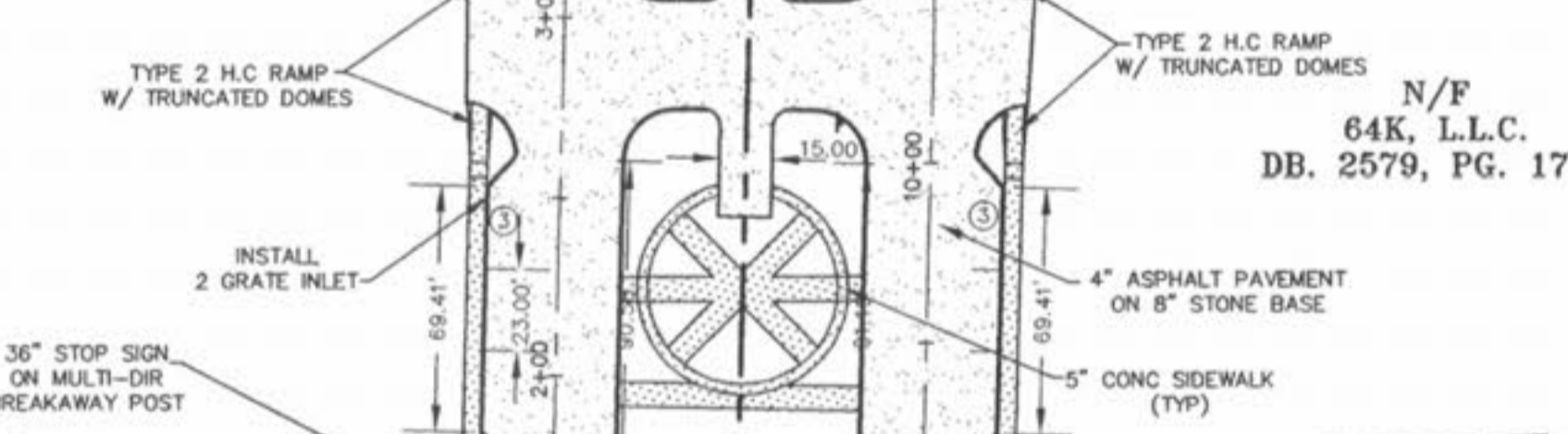
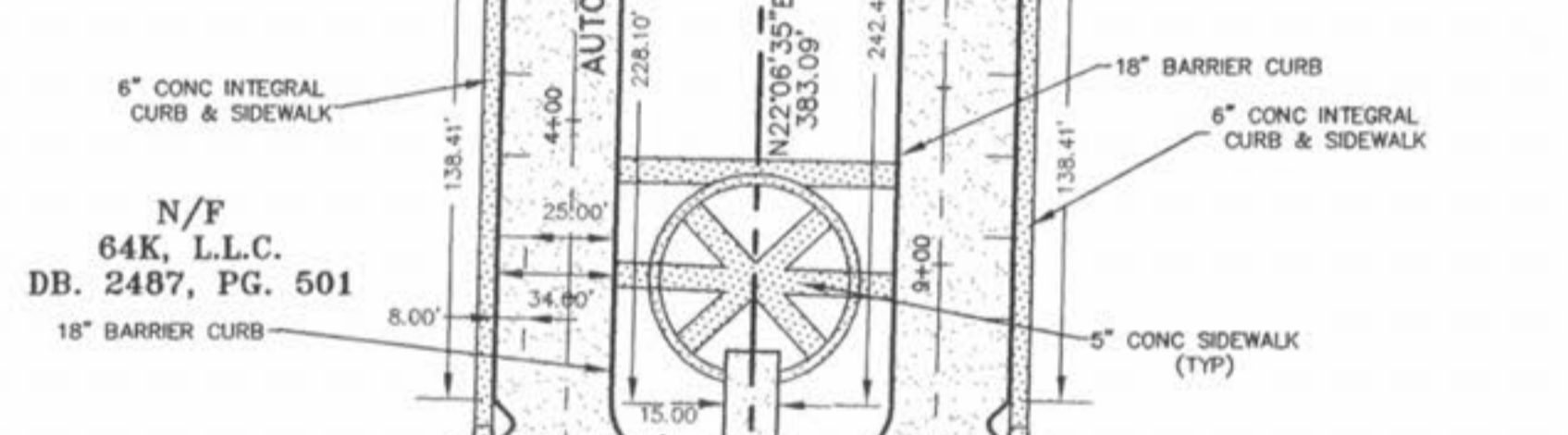
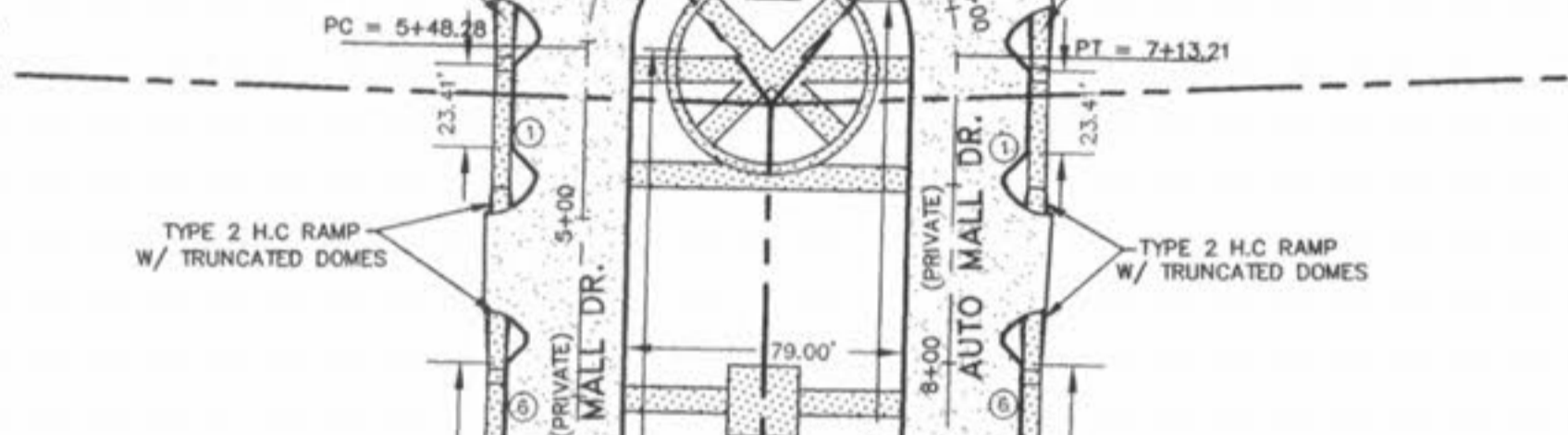
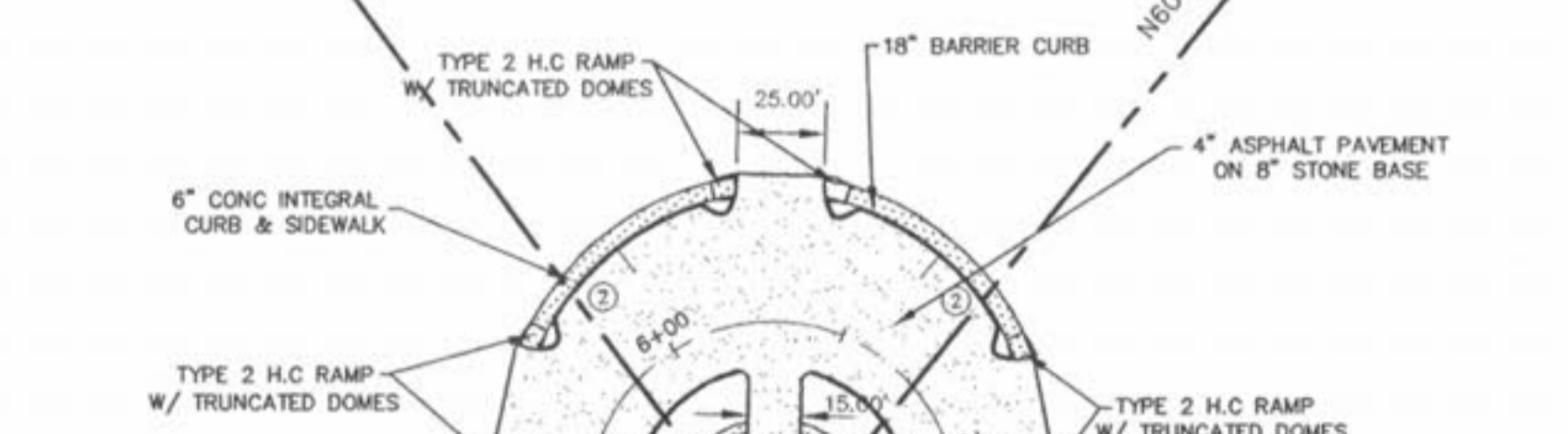

S71°01'04"E 643.67'

L=901.89' R=17138.76' CH=N66°33'47"W 901.79' D=03°00'54"

TECHNOLOGY DRIVE (WIDTH VARIES)

U.S. HIGHWAY 40-61 (WIDTH VARIES)

TECHNOLOGY DRIVE TO REMAIN CLEAN AND FREE OF ALL DIRT, MUD AND DEBRIS AT ALL TIMES

L=78.90' R=878.93' CH=N72°17'38"W 78.87' D=05°08'38"

ALL SIGNS ARE APPROVED THROUGH A SEPARATE PERMIT

SEE SHEET C5.2 FOR TECHNOLOGY ROAD IMPROVEMENTS

MODOT TYPE III COMMERCIAL ENTRANCE PER MODOT STANDARDS

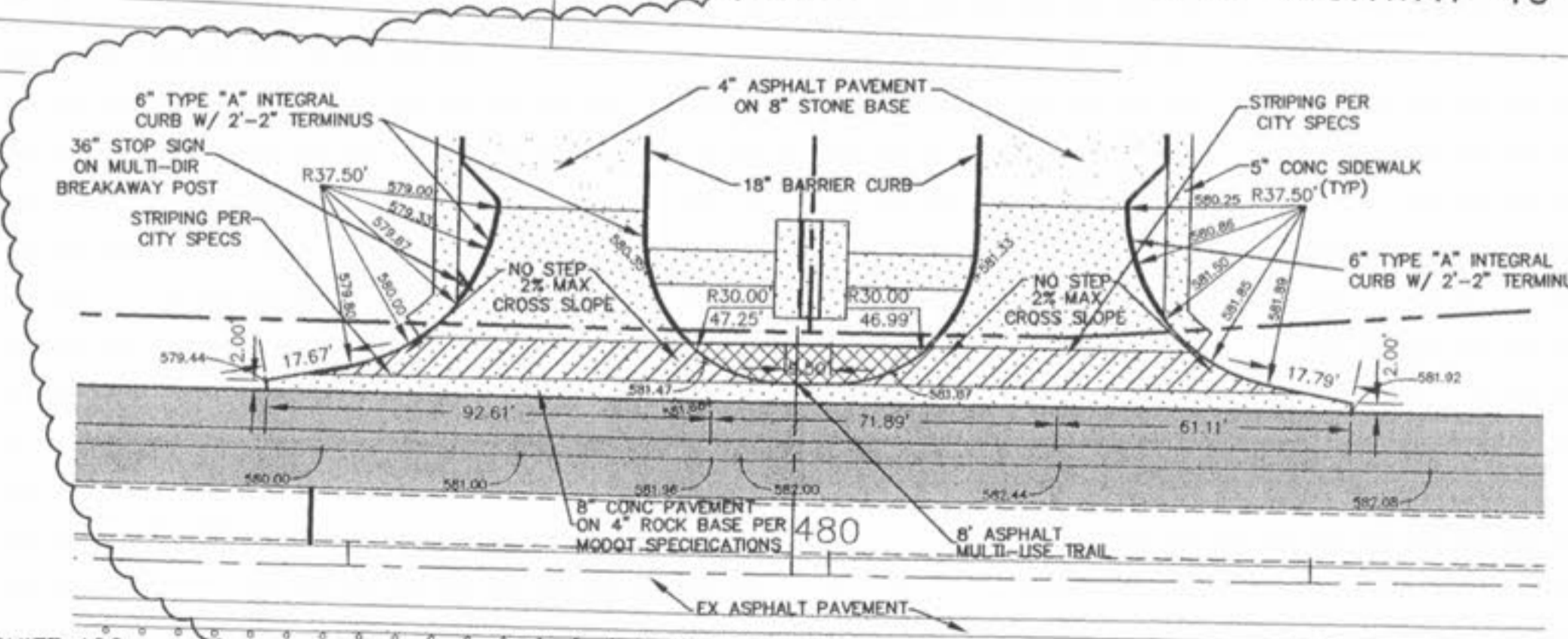

ENTRANCE WARPING DETAIL #1  
SCALE 1"=30'

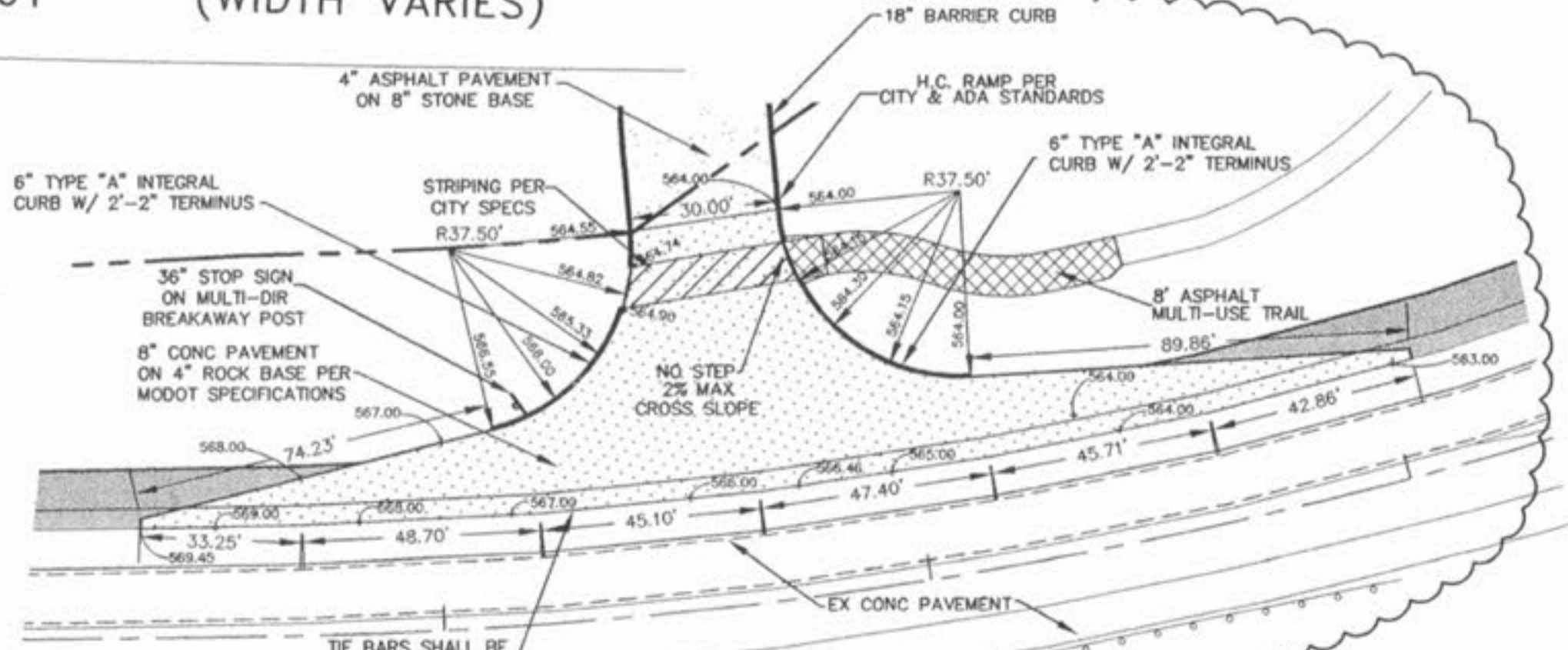

ENTRANCE WARPING DETAIL #2  
SCALE 1"=30'

- ▲ 06/30/05 PER CITY & MODOT COMMENTS
- ▲ 05/23/05 PER CITY, WATER & SANITARY COMMENTS



<b>O'FALLON AUTO MALL</b>	
GEOMETRICS PLAN	
<b>J. R. GRIMES</b>	
<b>CONSULTING ENGINEERS, INC.</b>	
12300 OLD TESSON ROAD SUITE 3000 ST. LOUIS, MO. 63128 PH. (314) 849-6100 FAX (314) 849-6010	
DRAWN BY: JLW DATE: 04/08/05	CHECKED BY: LJM DATE: 04/08/05
JOB NUMBER: 675N	SHEET: C8

PREPARED FOR:  
BRINKMANN CONSTRUCTORS  
CONTACT: KEVIN JACOBSMEYER  
16650 CHESTERFIELD GROVE RD, SUITE 100  
CHESTERFIELD, MO 63005  
PH: (636) 537-9700  
FAX: (636) 537-9880

P&Z FILE # 3101.05.03