

MATCHLINE SEE SHEET C13 FOR CONTINUATION

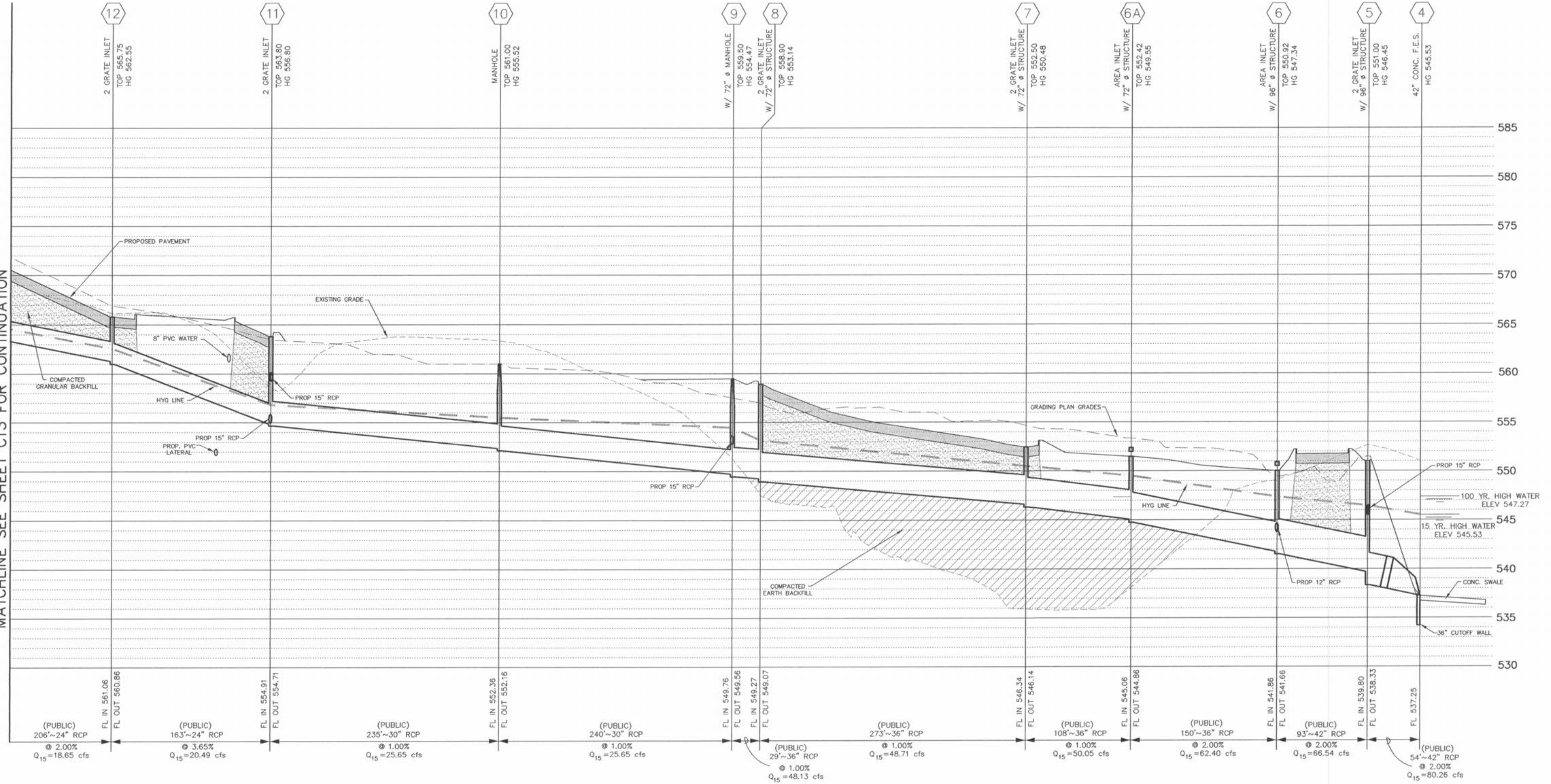

5  
VERT.  
50  
HORIZ.  
SCALE:

PREPARED FOR:  
BRINKMANN CONSTRUCTORS  
CONTACT: KEVIN JACOBSMEYER  
16650 CHESTERFIELD GROVE RD, SUITE 100  
CHESTERFIELD, MO 63005  
PH: (636) 537-9700  
FAX: (636) 537-9880

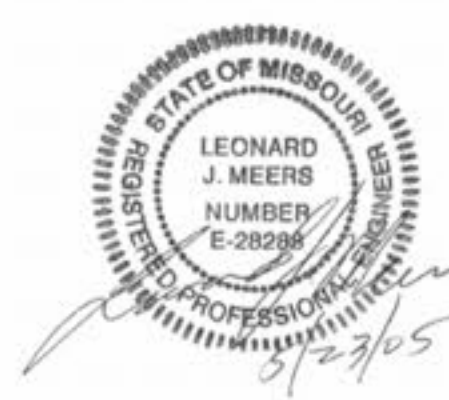

05/23/05 PER CITY, WATER & SANITARY COMMENTS

<b>O'FALLON AUTO MALL</b>	
<b>STORM SEWER PROFILES</b>	
<b>J. R. GRIMES</b>	
<b>CONSULTING ENGINEERS, INC.</b>	
12300 OLD TESSON ROAD SUITE 3000 ST. LOUIS, MO. 63128 PH. (314) 849-6100 FAX (314) 849-6010	
DRAWN BY: JLW	DATE: 04/08/05
CHECKED BY: LJM	DATE: 04/08/05
JOB NUMBER: 675N	SHEET: C12

P&Z FILE # 3101.05.03