

TYPICAL CROSS BLOCK
FOR 12" D.I.P.
NTS

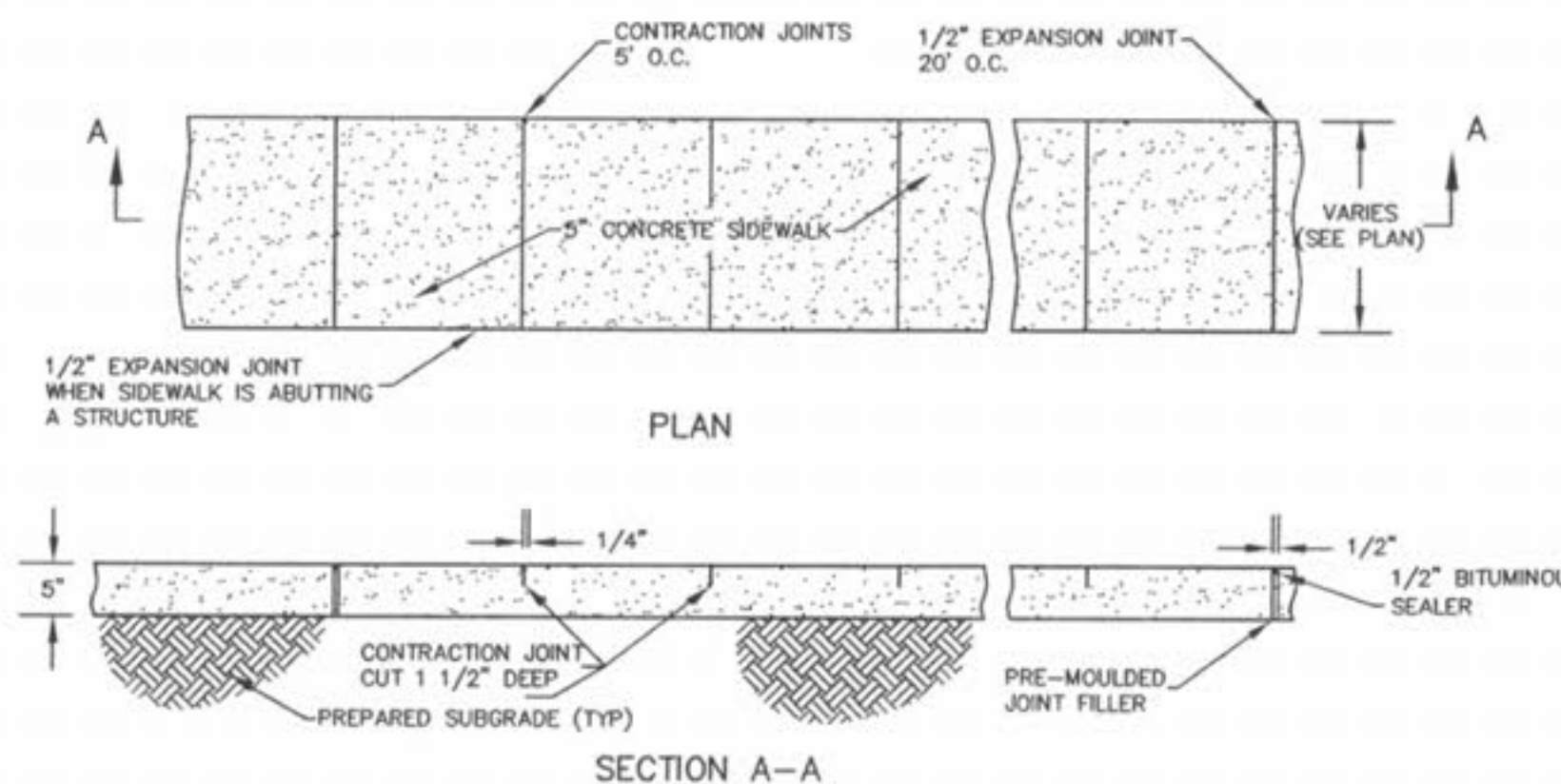

DETAIL OF CONCRETE SIDEWALK

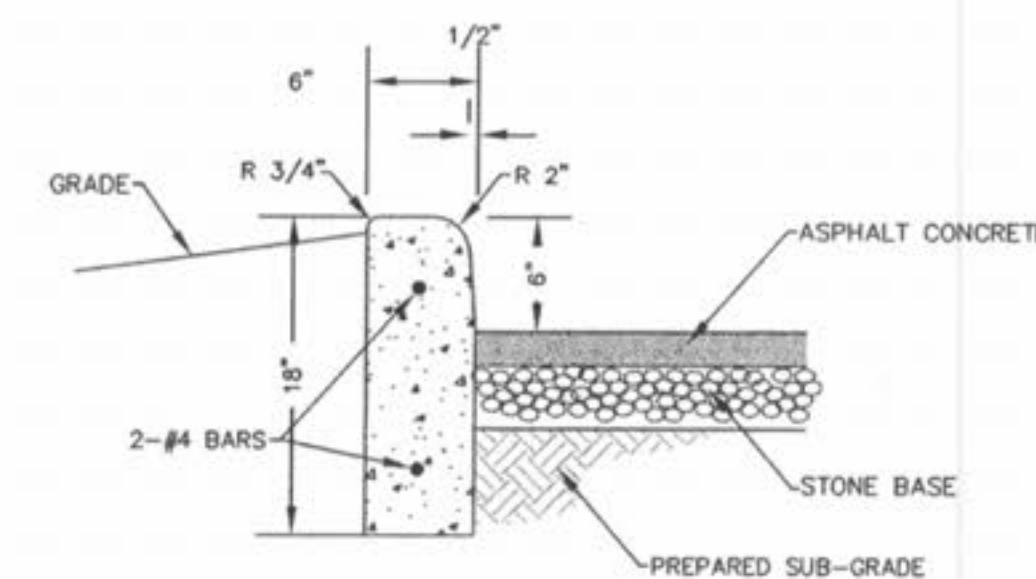

18" BARRIER CURB AND PAVEMENT DETAIL

- NOTES:
1. ALL CONCRETE SHALL BE MIN. FC=3000 P.S.I.
 2. ALL CONSTRUCTION MATERIALS AND METHODS OF CONSTRUCTION SHALL BE IN ACCORDANCE WITH CITY OF EUREKA
 3. ANY UNSUITABLE SOIL (AS DETERMINED BY SOILS ENGINEER) BELOW STRUCTURE SHALL BE REMOVED AND REPLACED WITH SELECT EARTHEN MATERIAL COMPACTED IN PLACE WITH VIBRATORY TAMPER.
 4. PROVIDE 1/2" EXPANSION JOINTS AT 20' CENTERS.

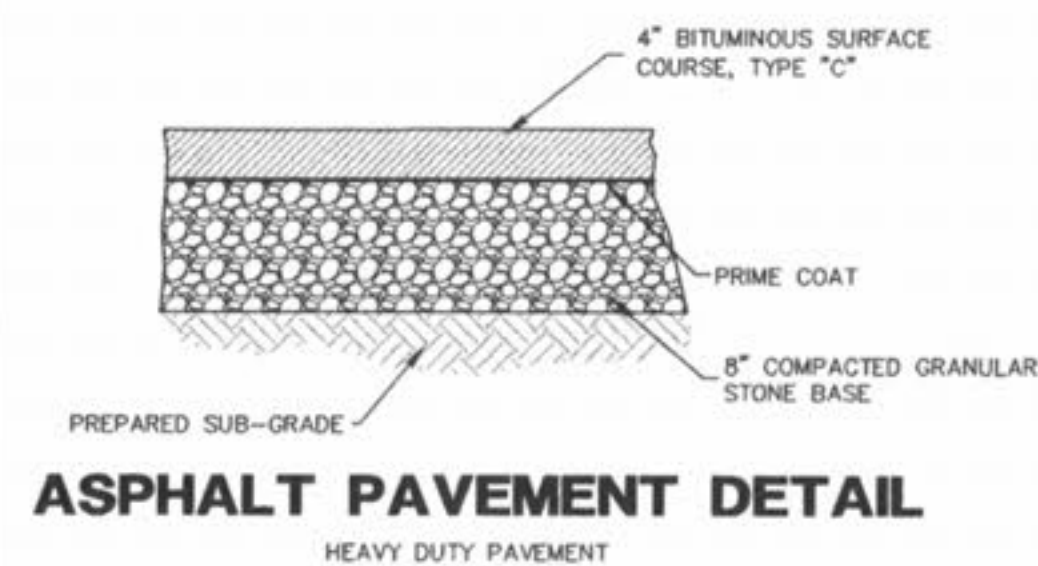
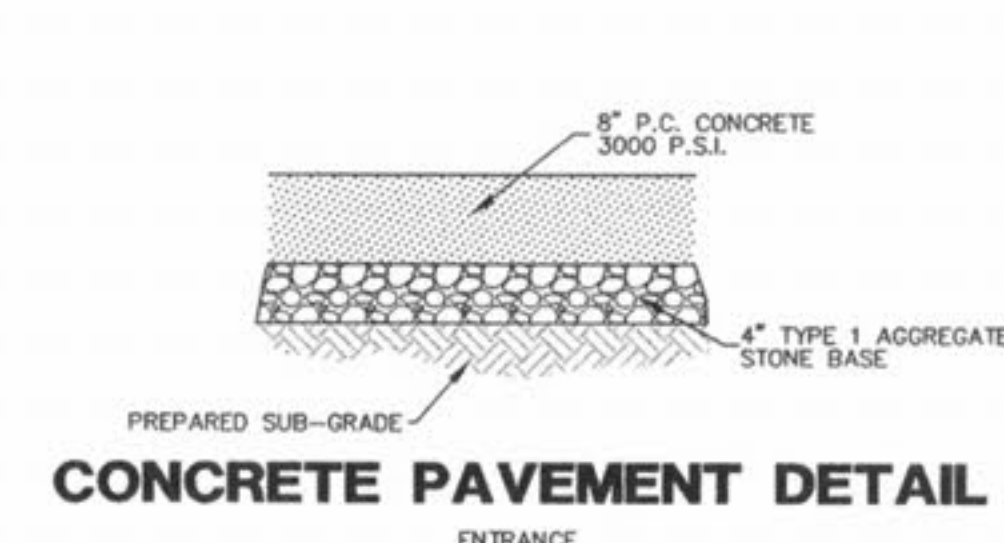
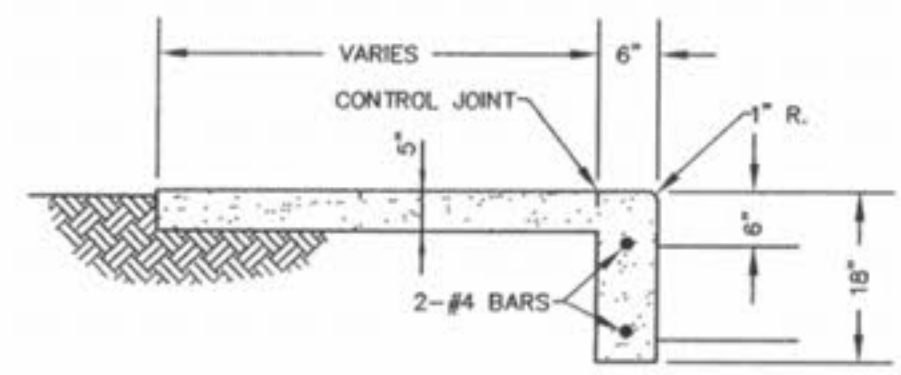

NOTE: EXPANSION JOINT MATERIAL SHALL BE INSTALLED IN THE WALK FOR ITS FULL WIDTH AND DEPTH AT INTERVALS OF APPROX. 50'. CONTROL JOINTS AT INTERVALS OF 1.5 TIMES ITS WIDTH.

INTEGRAL SIDEWALK & CURB

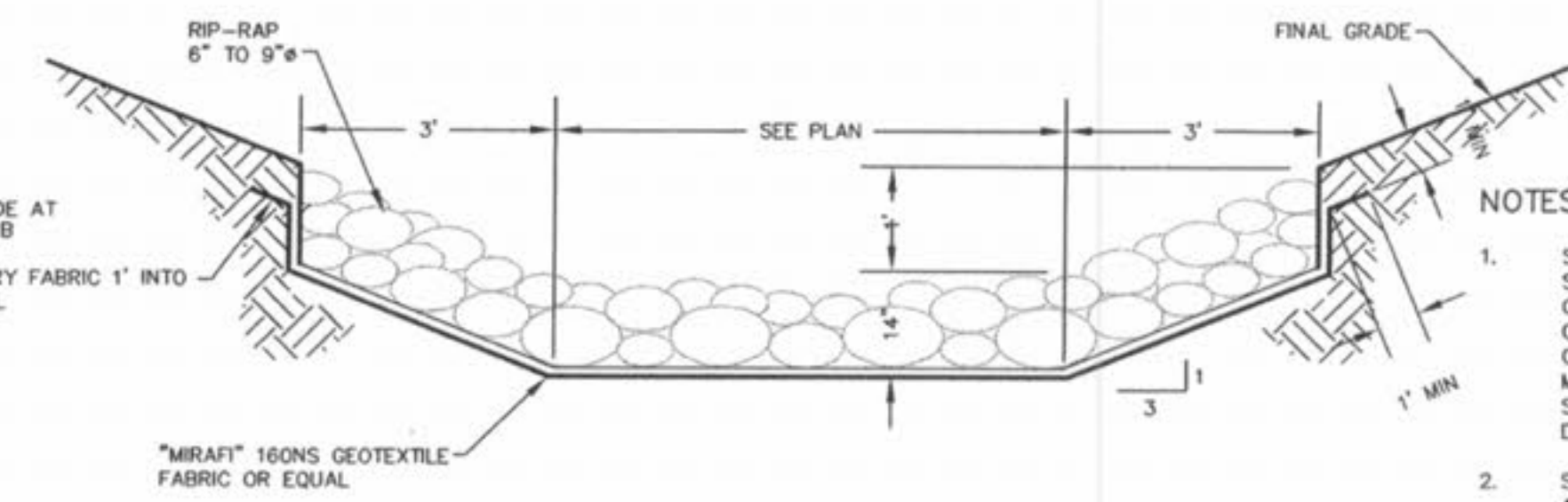
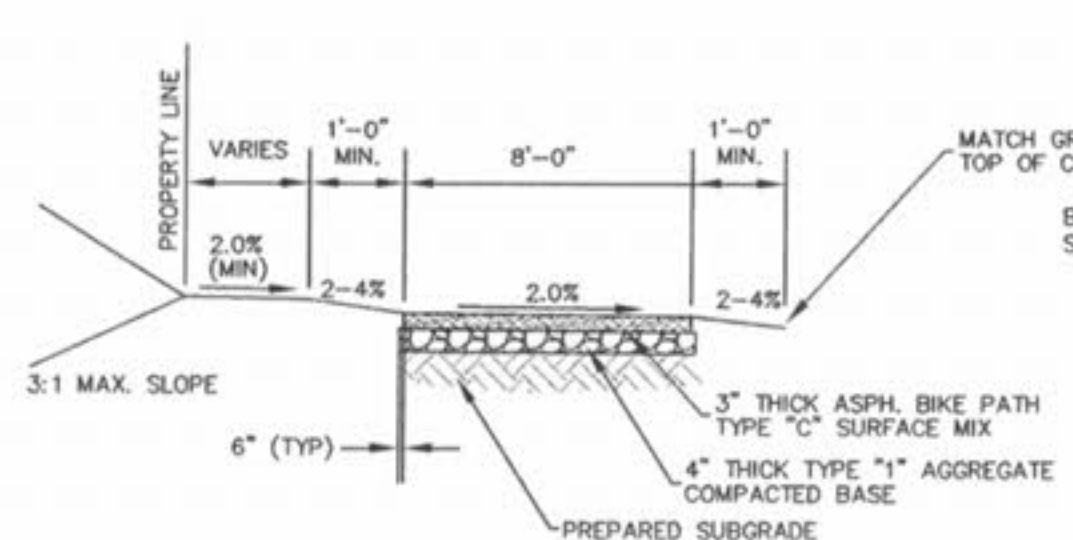

HEAVY/LIGHT STONE REVETMENT DETAIL

- NOTES:
1. STONE FOR HEAVY STONE REVETMENT SHALL BE SOUND, DURABLE, AND FREE FROM CRACKS AND OTHER STRUCTURAL DEFECTS THAT WOULD CAUSE IT TO DETERIORATE. IT SHALL NOT CONTAIN ANY SANDSTONE, SHALE, OR OTHER MATERIAL EASILY DISINTEGRATED. THE STONE SHALL BE AT LEAST 12 INCH TO 18 INCH DIAMETER @ 15 INCH.
 2. STONE FOR LIGHT STONE REVETMENT SHALL BE AT LEAST 6 INCH TO 8 INCH DIAMETER.

NOTES:

PROVIDE CONCRETE HANDICAP RAMP WHERE TRAIL INTERSECTS ACCESS DRIVES OR STREETS OR WHERE TRAIL INTERSECTS WITH CURBING (SEE PLAN).

PROVIDE STRIPING OR A COLORED TEXTURED PAVEMENT THROUGH THE ACCESS DRIVES OR STREETS INTO THE DEVELOPMENT.

MAXIMUM SLOPE OF THE PATH SHALL NOT EXCEED 8% AND 2% CROSS SLOPE PER CITY OF O'FALLON SPECIFICATIONS.

THE TRAIL SHALL BE CONSTRUCTED WITH A CONSISTENT SLOPE WITH VERTICAL CURVES A MINIMUM OF 50' IN LENGTH. AFTER FINAL COMPRESSION, THE SURFACE SHALL BE SMOOTH AND TRUE TO THE ESTABLISHED CROWN AND GRADE. ANY LOW OR DEFECTIVE PLACES SHALL IMMEDIATELY BE REMEDIED BY CUTTING OUT THE COURSE AT SUCH SPOTS AND REPLACING IT WITH FRESH HOT MIXTURE, WHICH SHALL BE IMMEDIATELY COMPACTED TO CONFORM WITH THE SURROUNDING AREA AND SHALL BE THOROUGHLY BONDED TO IT. THE FINISHED PAVEMENT SHALL BE SET FREE FROM DEPRESSIONS EXCEEDING ONE-EIGHTH INCH AS MEASURED WITH A TEN-FOOT STRAIGHT EDGE PARALLEL TO THE CENTERLINE OF THE TRAIL.

MULTI-USE PATH DETAIL
NTS

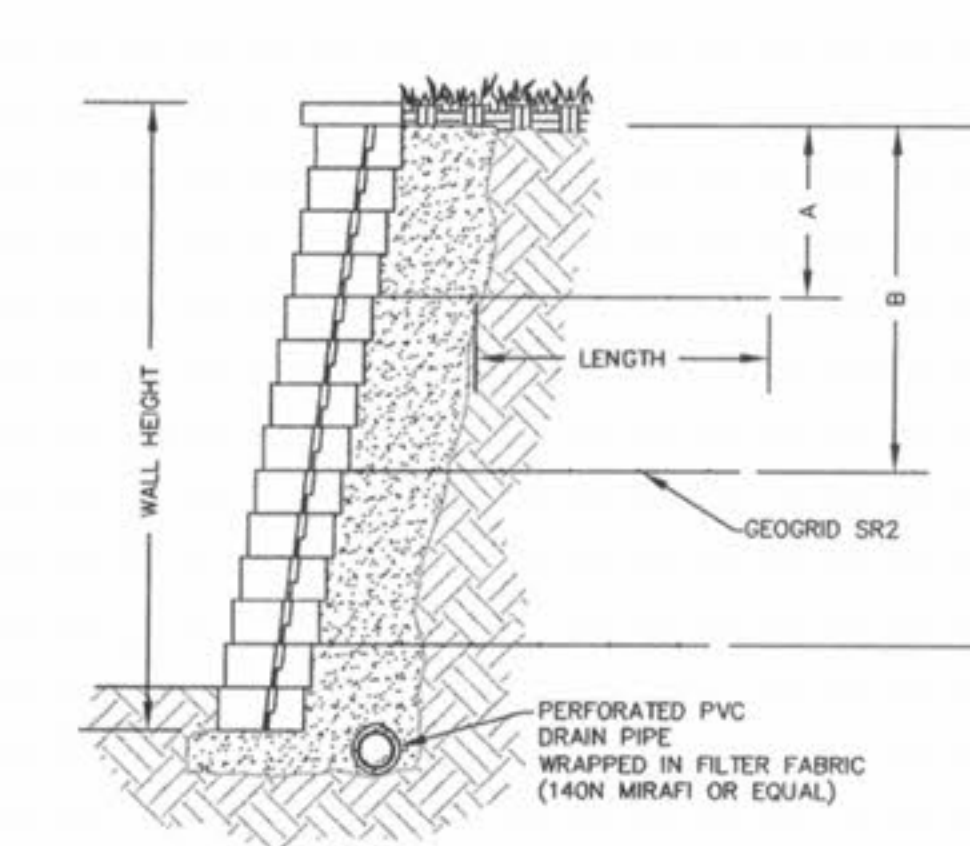

VERSA-LOK RETAINING WALL
OR APPROVED EQUAL
(SEE RETAINING WALL PLANS BY OTHERS)

NOTE: CONTRACTOR TO PROVIDE FINAL WALL SEALED SHOP DRAWINGS, DETAILS, AND CALCULATIONS APPROVAL.

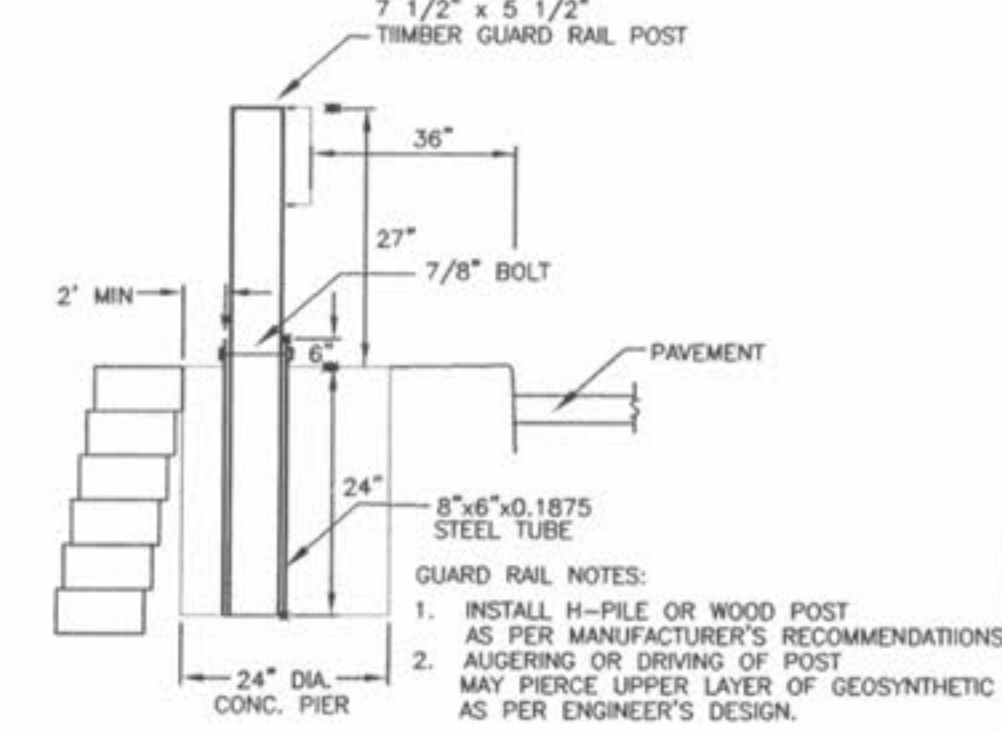

GUARD RAIL DETAIL
TYPICAL GUARD RAIL
SCALE: NONE



DRIVEWAY TYPICAL SECTION

SECTION THRU 4" ASPHALT CURB

SECTION THRU CONCRETE CURB AND GUTTER

DRIVEWAY TYPE III DIST 6

DATE: 05/07/05 203.63A

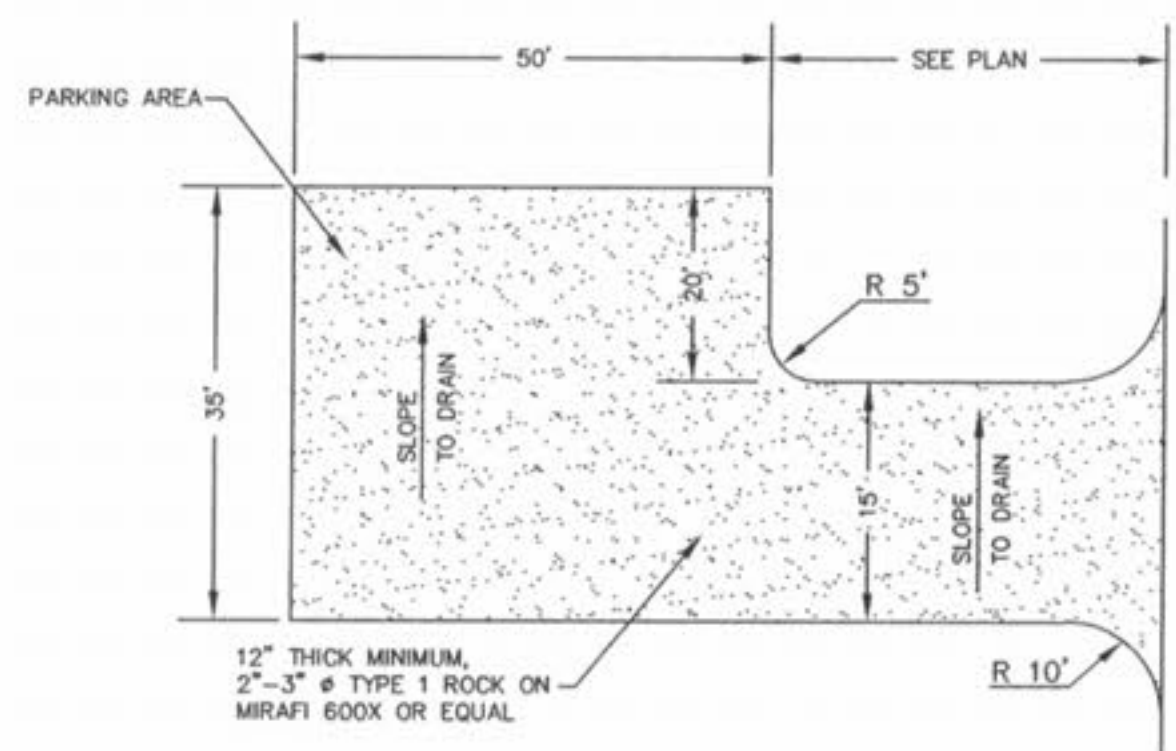

TEMPORARY CONSTRUCTION ENTRANCE

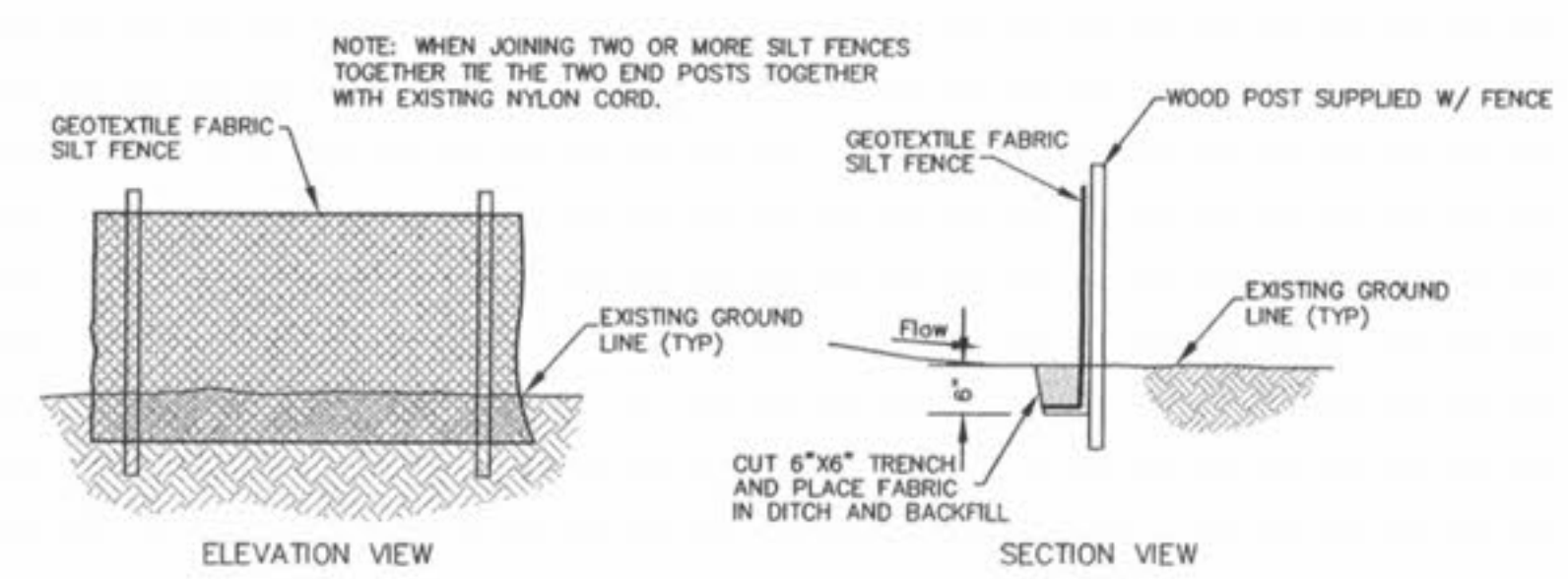

SILTATION CONTROL SILTFENCE DETAIL

PREPARED FOR:
BRINKMANN CONSTRUCTORS
CONTACT: KEVIN JACOBSMEYER
16650 CHESTERFIELD GROVE RD, SUITE 100
CHESTERFIELD, MO 63005
PH: (636) 537-9700
FAX: (636) 537-9880

- 6/13/05 PER WATER DISTRICT COMMENTS
- 05/23/05 PER CITY, WATER & SANITARY COMMENTS
- 04/11/05 PER FIRE MARSHALL COMMENTS

O'FALLON AUTO MALL
SITE DETAILS

J. R. GRIMES
CONSULTING ENGINEERS, INC.

12300 OLD TESSON ROAD
SUITE 3000
ST. LOUIS, MO. 63128
PH: (314) 849-6100
FAX (314) 849-6010

DRAWN BY: JLW DATE: 04/08/05 CHECKED BY: LJM DATE: 04/08/05 JOB NUMBER: 675N SHEET: C17