

INTEGRAL CONCRETE SIDEWALK / CURB

Notes:

- All vertical form expansion and construction joints must fall in groove.
- Joint spacing 4'-0" center to center or width of sidewalk.
- Install 3/4" expansion joint where walk abuts junction of existing walk, concrete curb, driveways, and similar structures, and 250' centers maximum.
- Key all construction joints.

INTEGRAL CONCRETE SIDEWALK DETAILS

Not to Scale

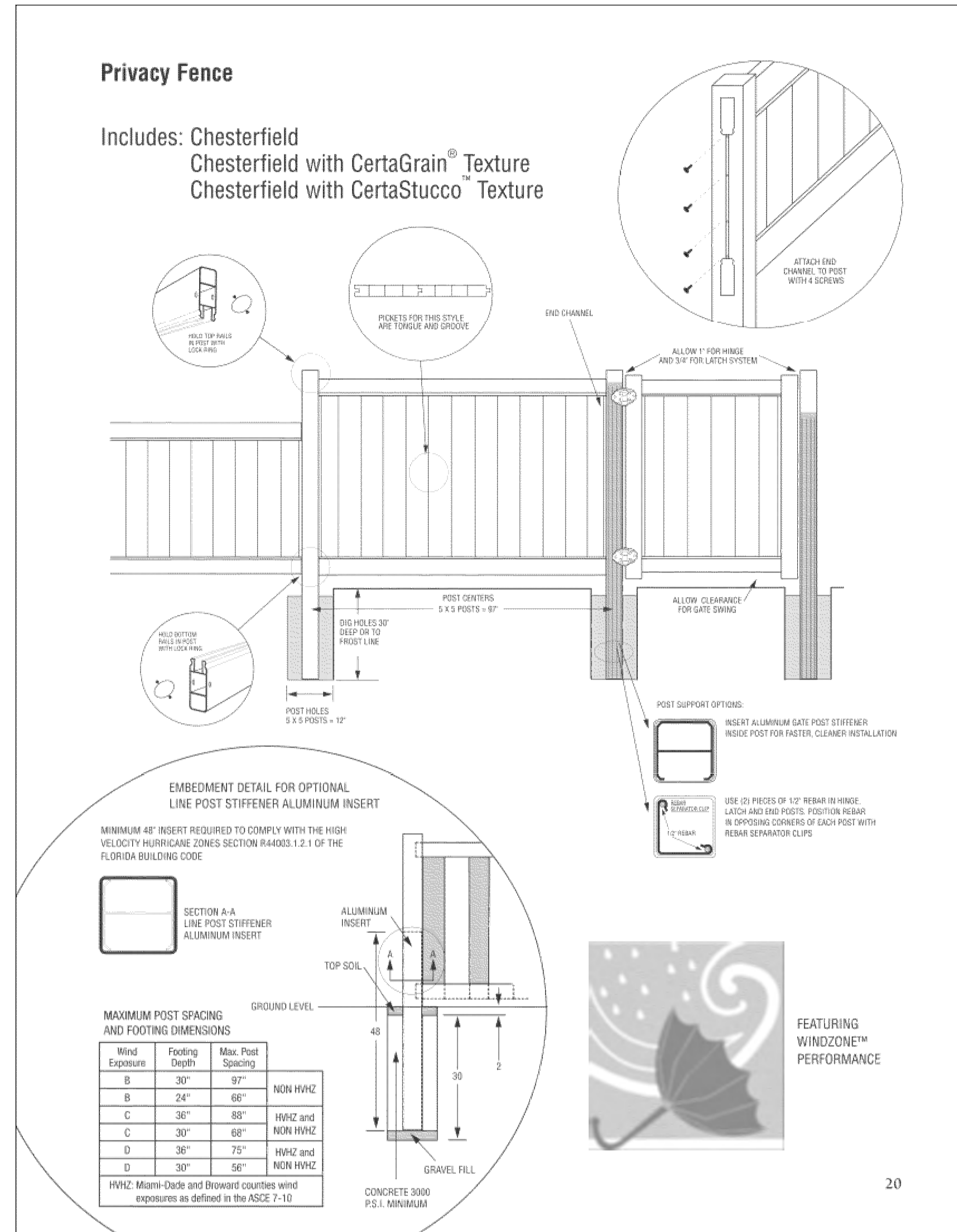

Privacy Fence

Includes: Chesterfield
Chesterfield with CertaGrain® Texture
Chesterfield with CertaStucco® Texture

EMBEDMENT DETAIL FOR OPTIONAL LINE POST STIFFENER ALUMINUM INSERT

MAXIMUM POST SPACING AND FOOTING DIMENSIONS

Wind Exposure	Footing Depth	Max. Post Spacing	Notes
B	30"	80"	NO WIND
B	24"	60"	NO WIND
C	30"	60"	NO WIND
C	30"	60"	NO WIND
D	30"	75"	NO WIND
D	30"	50"	NO WIND

NOTE: Maximum Spacing of 100' for 10' High Posts as defined in the ASCE 7-10

FEATURING WINDZONE™ PERFORMANCE

20

Notes:

- Accessible Sign (R7-B) shall be mounted on a pole or other structure 5'-6" above the parking surface, at the head of the parking space, and shall be at least 12"x18" in area.
- Supplemental Accessible Sign (R7-8a) shall be used on all required Van Accessible Spaces.
- Signs shall be blue with white lettering.
- Provide Fine Legend of \$50-\$300 on sign.

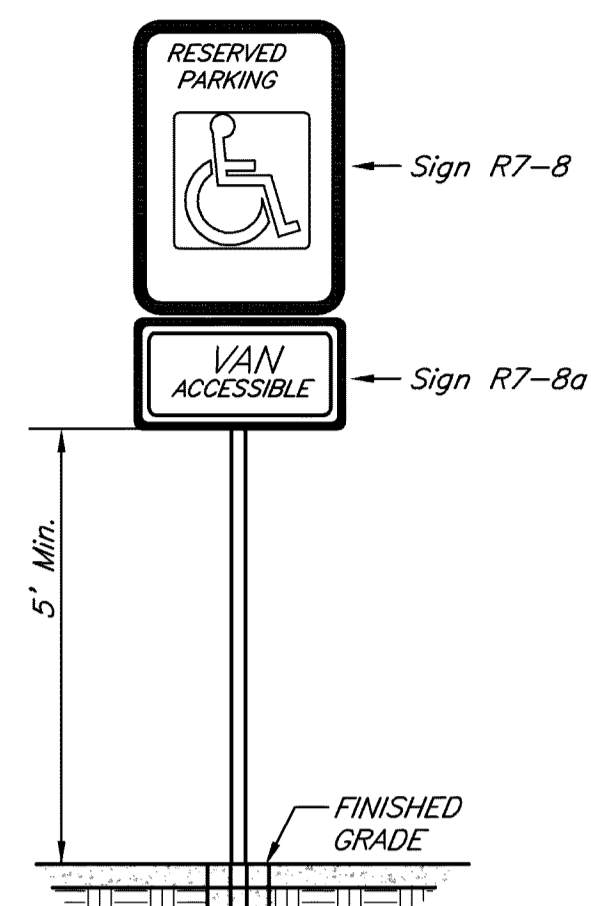

TYPICAL ACCESSIBLE SIGNAGE

Not to Scale

Pavement Notes:

- Refer to geotechnical report "O'Fallon Justice Center O'Fallon Missouri" dated September 2015 by SCI Engineering INC for all paving, excavation and compaction recommendations.
- All Woven Wire Fabric (W.W.F.) Reinforcement shall be WWF mats, not rolled, and placed on chairs to ensure placement in center of concrete.
- Contractor shall submit mix design to the Engineer prior to any concrete flatwork placement.

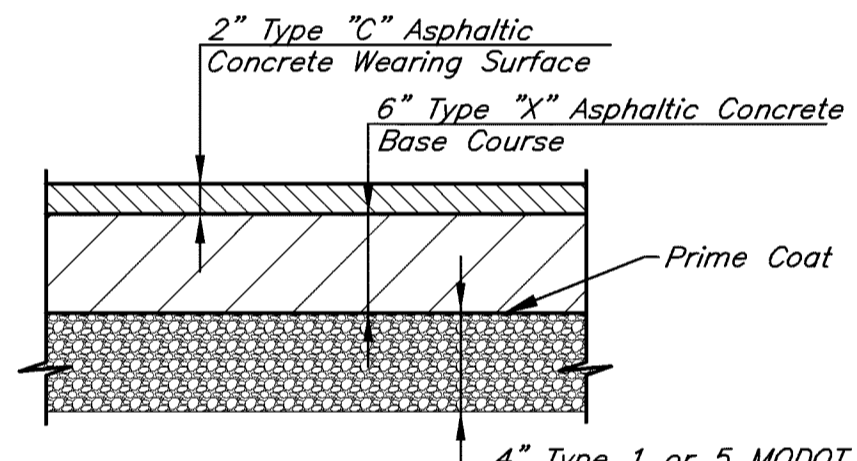

ASPHALT PAVEMENT

NOT TO SCALE

TYPICAL PAVEMENT SECTIONS

HEAVY DUTY CONCRETE PAVEMENT

NOT TO SCALE

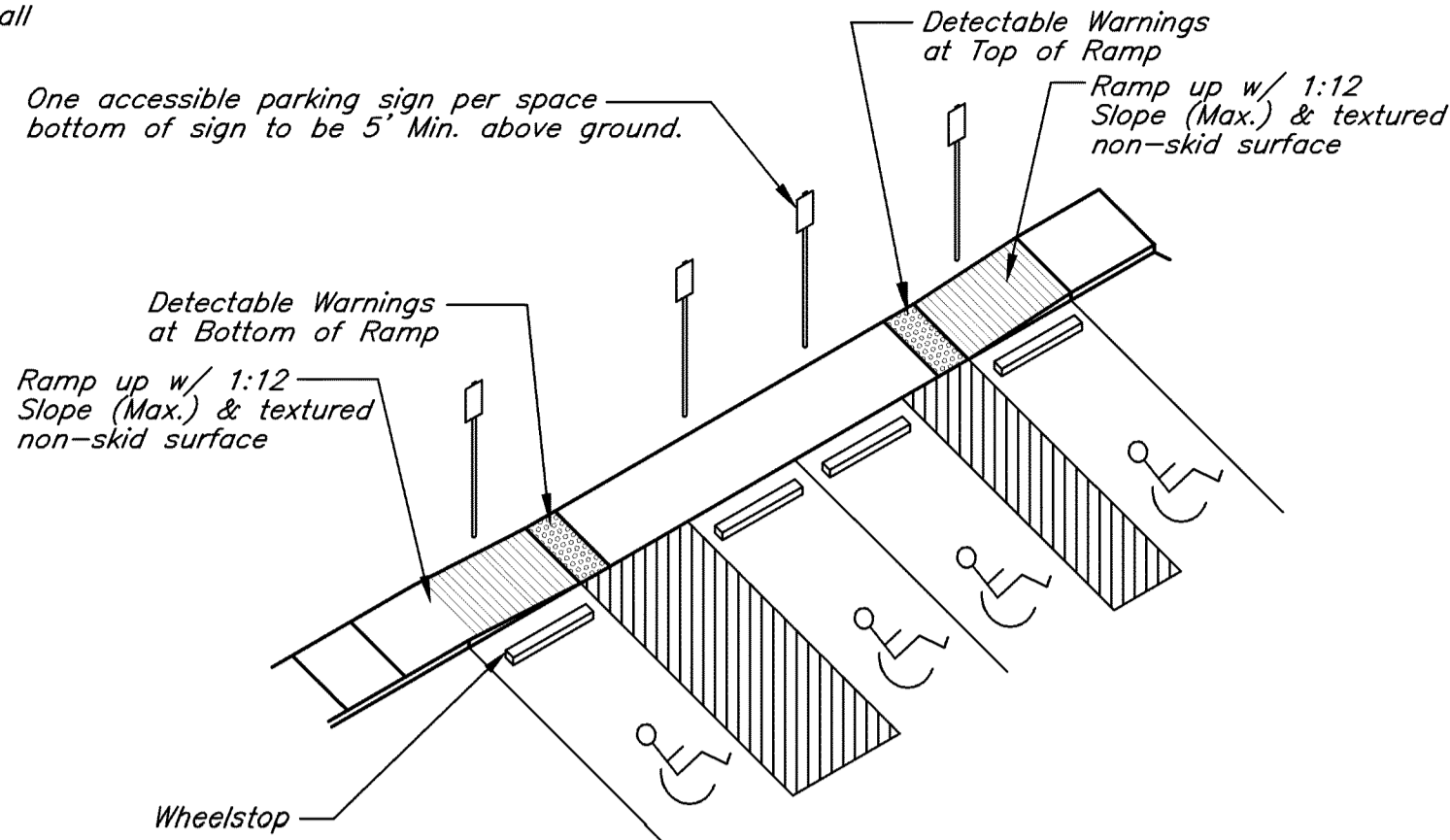

HANDICAP PARKING RAMP DETAIL

Not to Scale

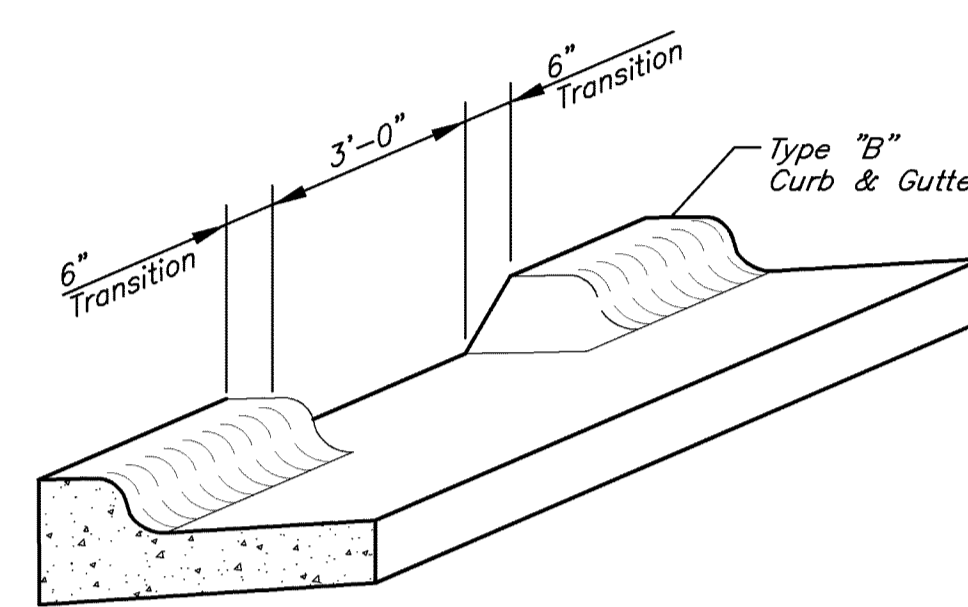

TYPICAL CURB CUT DETAIL

Not to Scale

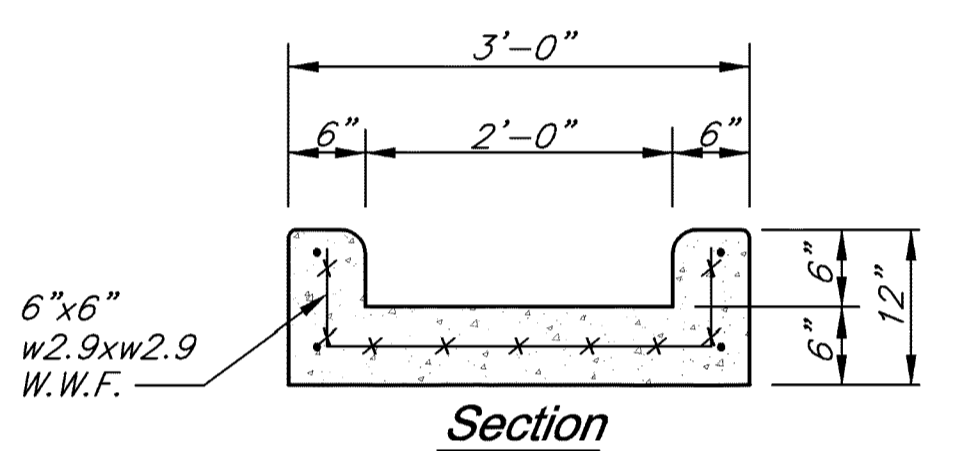

CONCRETE FLUME

Not to Scale

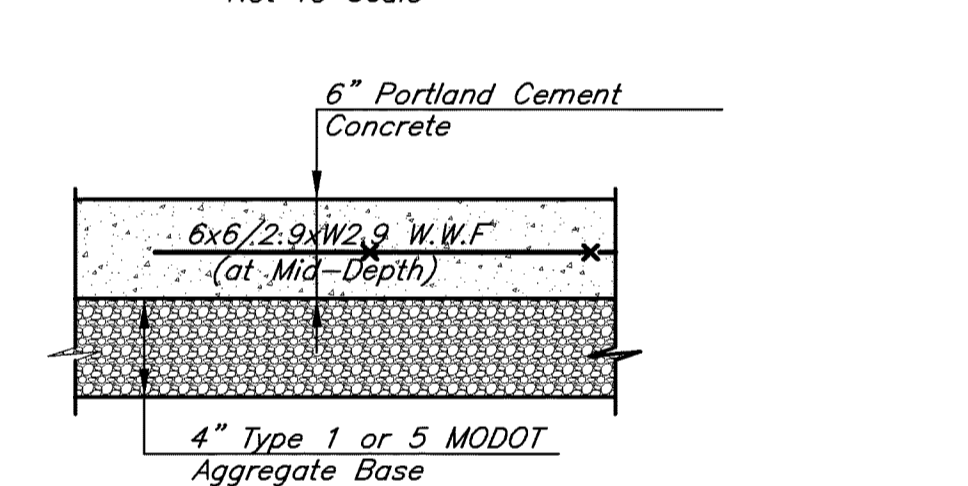

ASPHALT PAVEMENT

NOT TO SCALE

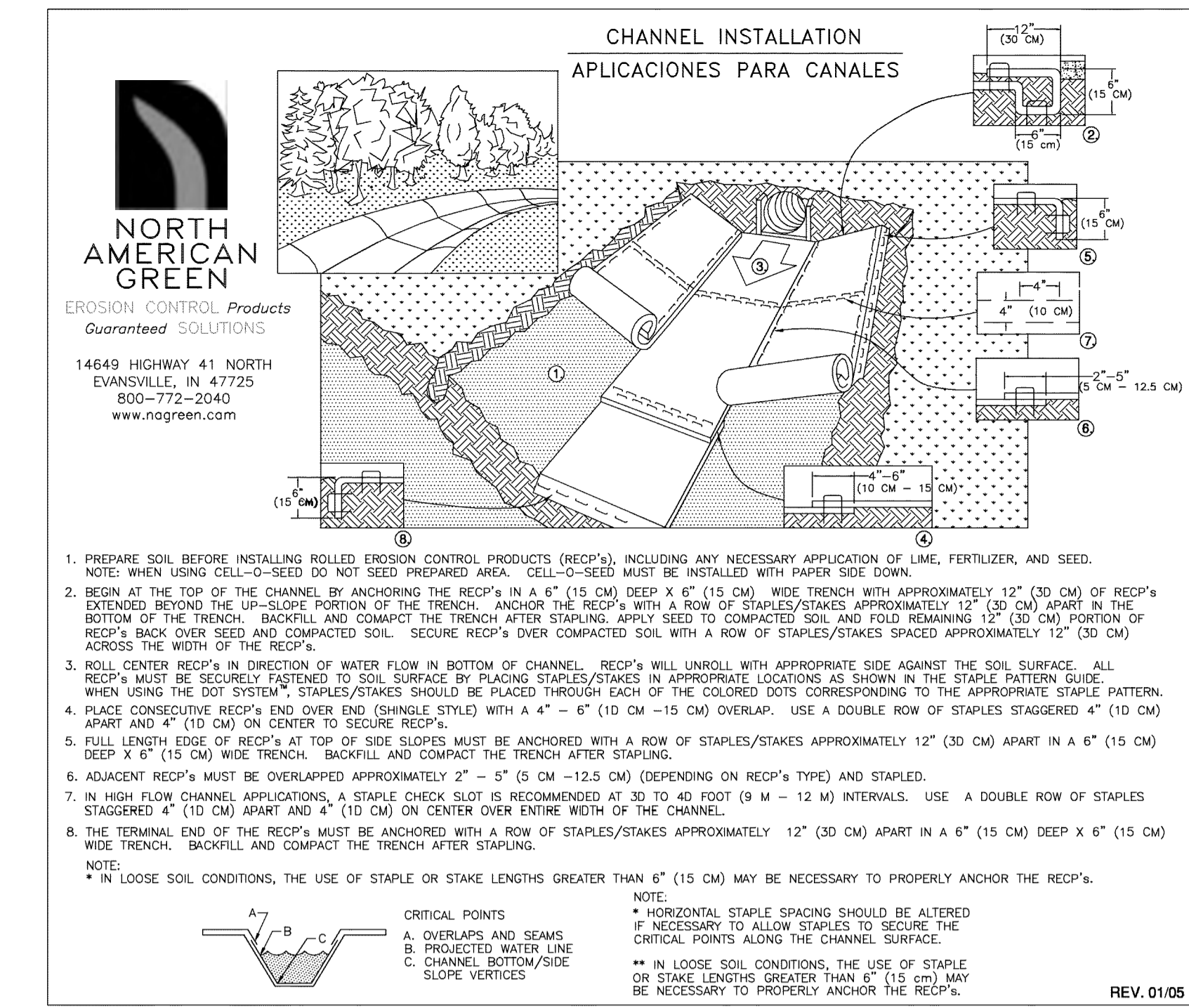

EROSION CONTROL BLANKETS AND TURF REINFORCEMENT MATTRESS CHANNEL INSTALLATION

Not to Scale

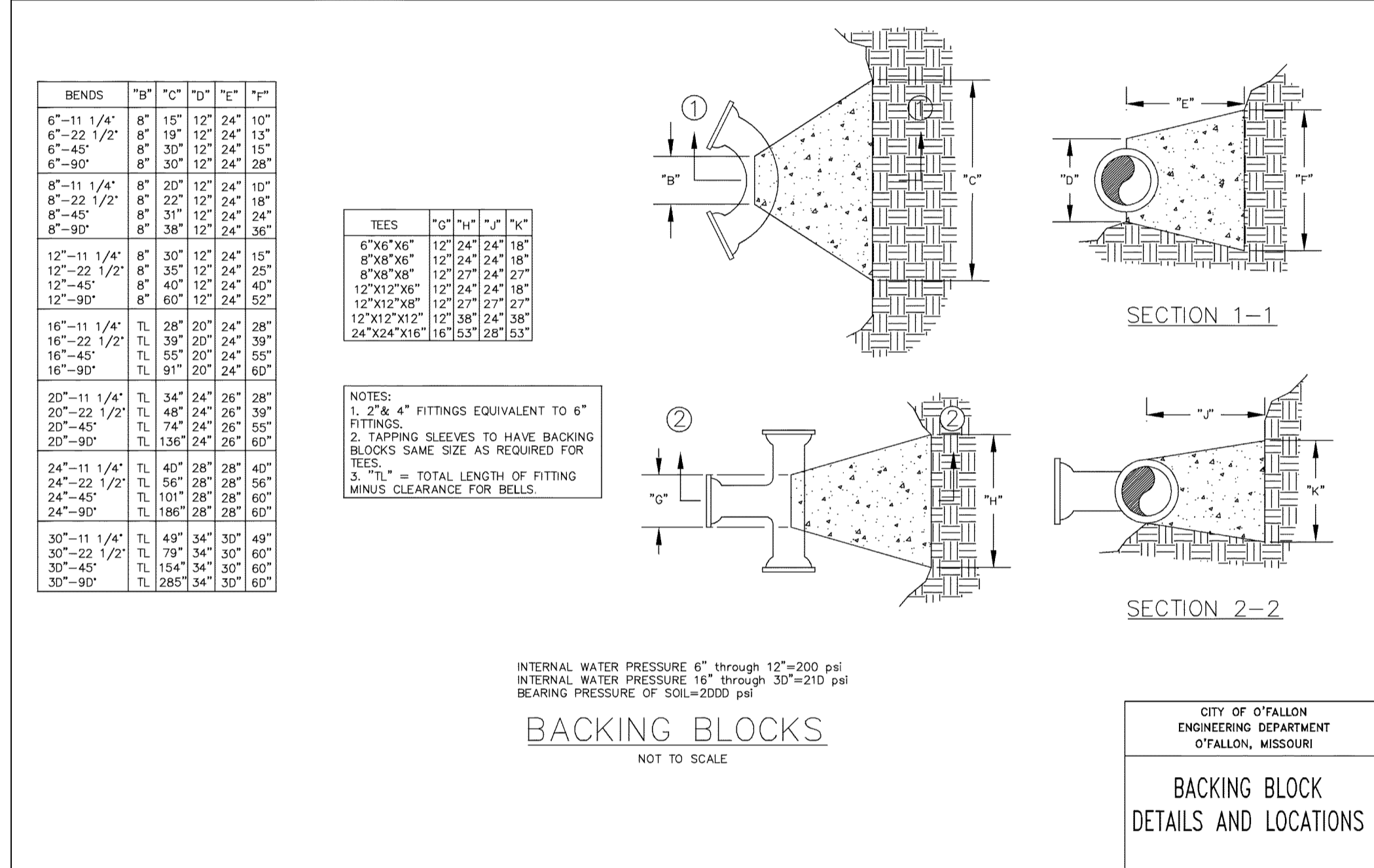

TYPICAL WATER AND SEWER SEPARATION

NOT TO SCALE



PassPort II® Industrial Ornamental Roll Gate

Ornamental Pickets: 1" Square
Top Rail(s), Uprights and Diagonals: Braces: 2" Square x 11 Ga.
Bottom Rail: 2" x 4" x 11 Ga. (Notched & Plated for V-track Wheels)
Roll Gate Hardware: Kit #PGK0D
Available in Profiles of 2-Rail, 3-Rail & 3-Rail w/Rings

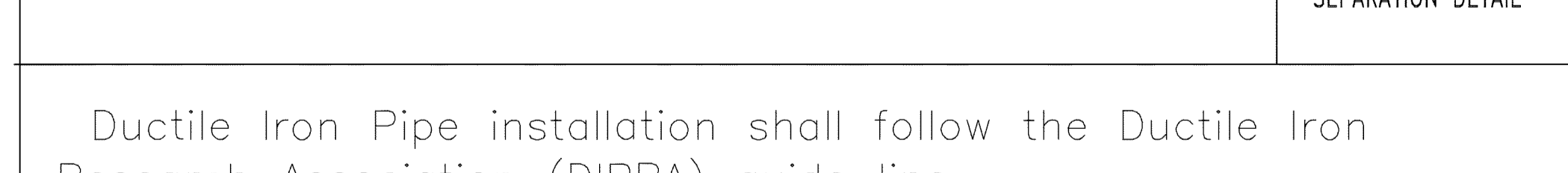

NOTE:

- Sign shall be 6095 GRADE ALUMINUM COVERED WITH 3/4" RED ENGINEERING GRADE RED DIAMOND REFLECTIVE SHEETING OR EQUIVALENT.
- POST SHALL BE 1 3/4" SQUARE 14 GAUGE BREAKAWAY POST.
- POSTS SHALL BE SPACED EVENLY AT A MAXIMUM OF 6' APART AND CENTERED PERPENDICULAR TO THE ROADWAY.
- HARDWARE SHALL BE ZINC PLATED COMMON GRADE HEX BOLT 5/8" x 2 1/2" 2" PLAT WASHERS, LOCK WASHERS, AND NUTS TO BE COMPATIBLE WITH THE HEX BOL.
- ALL LETTER NUMBER AND SYMBOL SIZES, SPACING, COLORS, AND THE SIGN COLORS SHALL CONFORM TO THE CURRENT "MANUAL ON UNIFORM TRAFFIC CONTROL DEVICES"



COMMERCIAL STRENGTH WELDED STEEL PANEL
PRE-ASSEMBLED

MONTAGE COMMERCIAL MAJESTIC 3/4-RAIL

DR: NIB SH: 1of1 SCALE: DO NOT SCALE
CK: BS Date: 09/21/11 REV: d

1555 N. Mingo
Tulsa, OK 74116
1-888-333-3422
www.ameristar.com

REV	DATE	DESCRIPTION
Δ	3/25/2016	City Comments

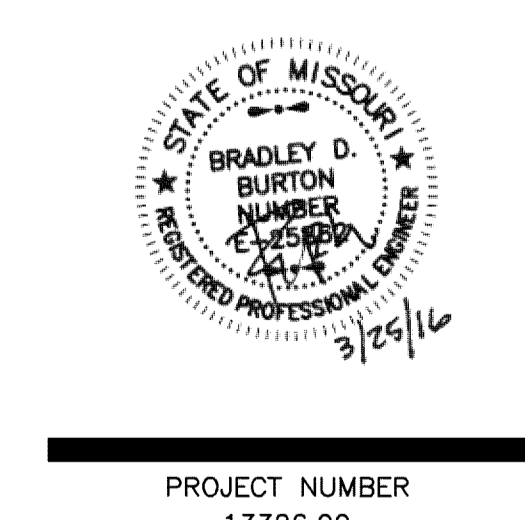

PROJECT NUMBER
13326.00

DATE
03/25/16

CONSTRUCTION DOCUMENTS

DRAWN: HTR/JWM/JRH
DESIGNED: HTR/JWM/JRH
REVIEWED: HTR/BDB
SHEET TITLE

Construction Details

SHEET NUMBER
C10.1