

PROPOSED O'FALLON POINTE

MEXICO ROAD & STATE HIGHWAY K O'FALLON, ST. CHARLES COUNTY, MISSOURI

UTILITY CONTACT LIST:

GAS:	ST. CHARLES GAS CO. 1 WEST BURY SQUARE BUILDING D ST. CHARLES, MO. 63301 CONTACT: MR. RICH NELKE PHONE: (314) 946-2422	TELEPHONE:	GTE TELEPHONE OPERATIONS 680 PARR ROAD, BUILDING AA WENTZVILLE, MO. 63385 CONTACT: MR. JOE RUNKLES PHONE: (314) 332-7623
ELECTRIC:	UNION ELECTRIC 200 CALLAHAN ROAD WENTZVILLE, MO. 63385 CONTACT: MR. RALPH CRANK PHONE: (314) 639-8210	DOT:	STATE OF MISSOURI DEPARTMENT OF TRANSPORTATION 1590 WOODLAKE DRIVE CHESTERFIELD, MO. 63017-5712 CONTACT: MR. BILL ANGEL PHONE: (314) 540-1140
WATER & SANITARY SEWER:	ALLIANCE WATER RESOURCES 205 EAST ELM STREET O'FALLON, MO. 63366 CONTACT: MR. GARY JOHNSON PHONE: (314) 281-2858		
24 HR. CONTACT:	MR. IAN SILBERMAN THF REALTY 955 EXECUTIVE PARKWAY SUITE 210 ST. LOUIS, MO. 63141 PHONE: (314) 878-4044		

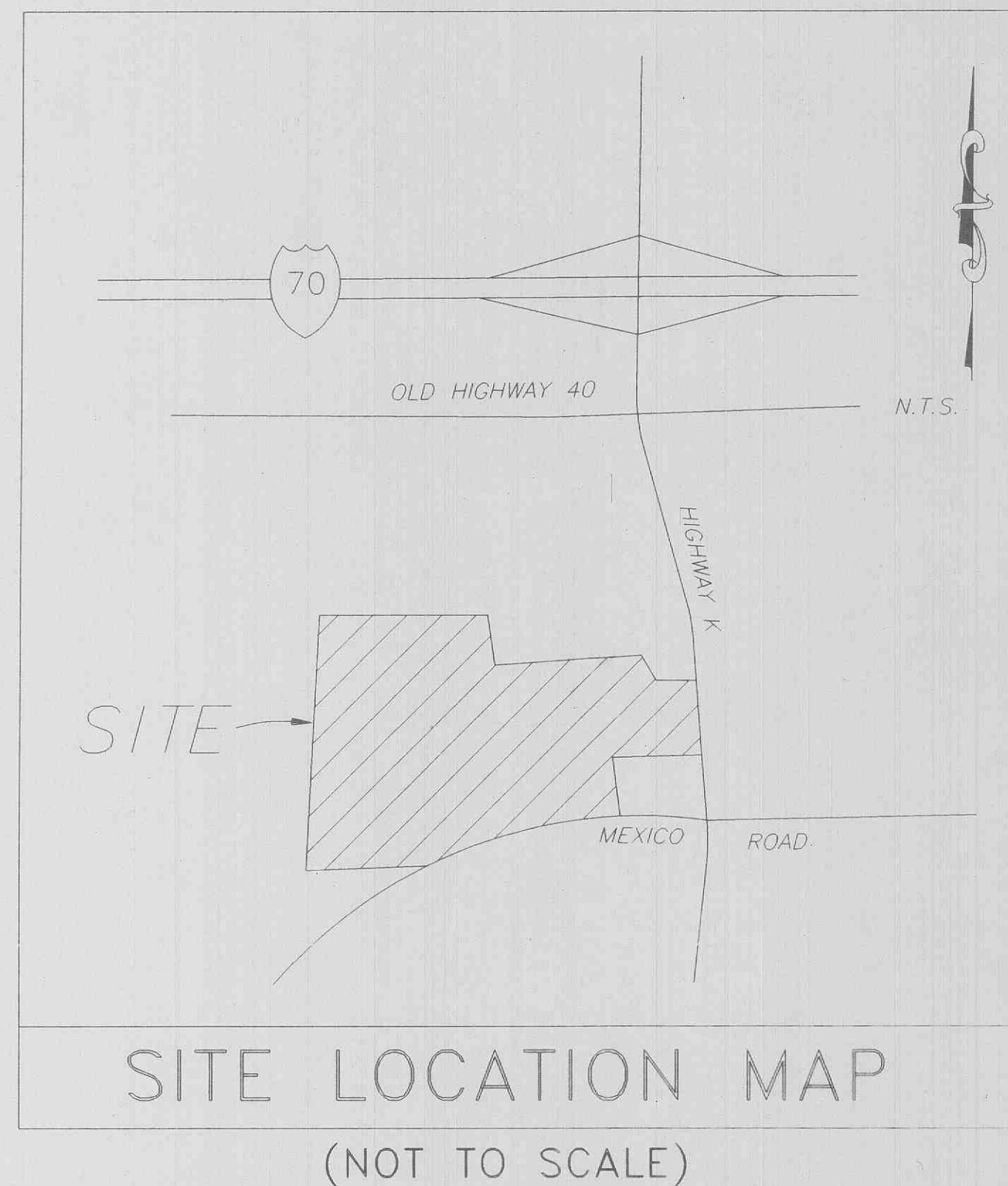

SHEET INDEX

1.	COVER SHEET
2.	BOUNDARY SURVEY
3.	C-1 SITE PLAN
4.	C-2 GRADING PLAN
5.	C-3 UTILITY PLAN
6.	C-4 EROSION CONTROL PLAN
7.	C-5 STORM SEWER PROFILES
8.	C-6 STORM SEWER PROFILES
9.	C-7 SANITARY SEWER PROFILES
10.	C-8 SANITARY SEWER PROFILES
11.	C-9 STANDARD DETAILS
12.	C-10 STANDARD DETAILS
13.	C-11 STANDARD DETAILS
14.	C-12 STANDARD DETAILS
15.	L-1 LANDSCAPE PLAN
16.	L-2 LANDSCAPE DETAILS

APPROVED

- Contingent upon the following:
- ① Providing a copy of the executed off-site grading easements
 - ② Providing the traffic study and traffic signal plans for the intersection of Woodlawn and Mexico Rd.
 - ③ Approval of the construction plans for the entire Woodlawn extension, and
 - ④ Providing the traffic signal and entrance plans for the West C entrance.

5/20/97 *Colleen R. Rame*

ENGINEER-

WOLVERTON AND ASSOC., INC.
5600 OAKBROOK PARKWAY
SUITE 100
NORCROSS, GA 30093
PHONE: (770) 447-8999
FAX: (770) 447-9070

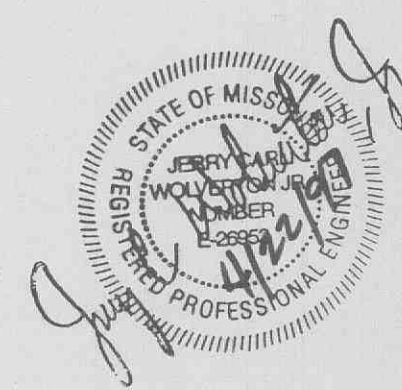

NOTES:

1. THE SITework WITHIN THE WAL-MART DEMISE AREA SHALL MEET OR EXCEED THE "WAL-MART STANDARD SITework SPECIFICATIONS."
2. ALL NECESSARY INSPECTIONS AND/OR CERTIFICATIONS REQUIRED BY CODES AND/OR UTILITY SERVICE COMPANIES SHALL BE PERFORMED PRIOR TO ANNOUNCED BUILDING POSSESSION AND THE FINAL CONNECTION OF SERVICES.

DEVELOPER-

THF REALTY
955 EXECUTIVE PARKWAY
SUITE 210
ST. LOUIS, MISSOURI 63141
CONTACT: MR. IAN SILBERMAN
PHONE: (314) 878-4044

Wal-Mart