

MO. STATE HWY. K
(VARIABLE WIDTH)

LEGEND

	UTILITY POLE
	GUY WIRE
	FIRE HYDRANT
	WATER METER
	WATER VALVE
	WATER LINE
	GAS LINE
	GAS VALVE
	UNDERGROUND TELEPHONE
	AREA INLET
	MANHOLE
	SIGN
	CONCRETE

Copyright 1997 by Pickett, Ray & Silver Inc.
 CONFIDENTIAL PROPRIETARY MATERIAL
 The use, reproduction and sales rights of this drawing are reserved by Pickett, Ray & Silver Inc.
PICKETT RAY & SILVER
 Civil Engineers 333 Mid Rivers Mall Dr.
 Planners St. Peters, MO 63376
 Land Surveyors 397-1211 FAX 397-1044

A TRACT OF LAND BEING PART OF
 FRAC. SEC. 33 AND U.S. SURVEY 55
 TOWNSHIP 47 NORTH, RANGE 3 EAST
 ST. CHARLES COUNTY, MISSOURI

DRAWN	J.R.C.	DATE	1-15-97
CHECKED		DATE	
FIELD BOOK	450C	PROJECT #	89-0638
		JOB ORDER #	35931

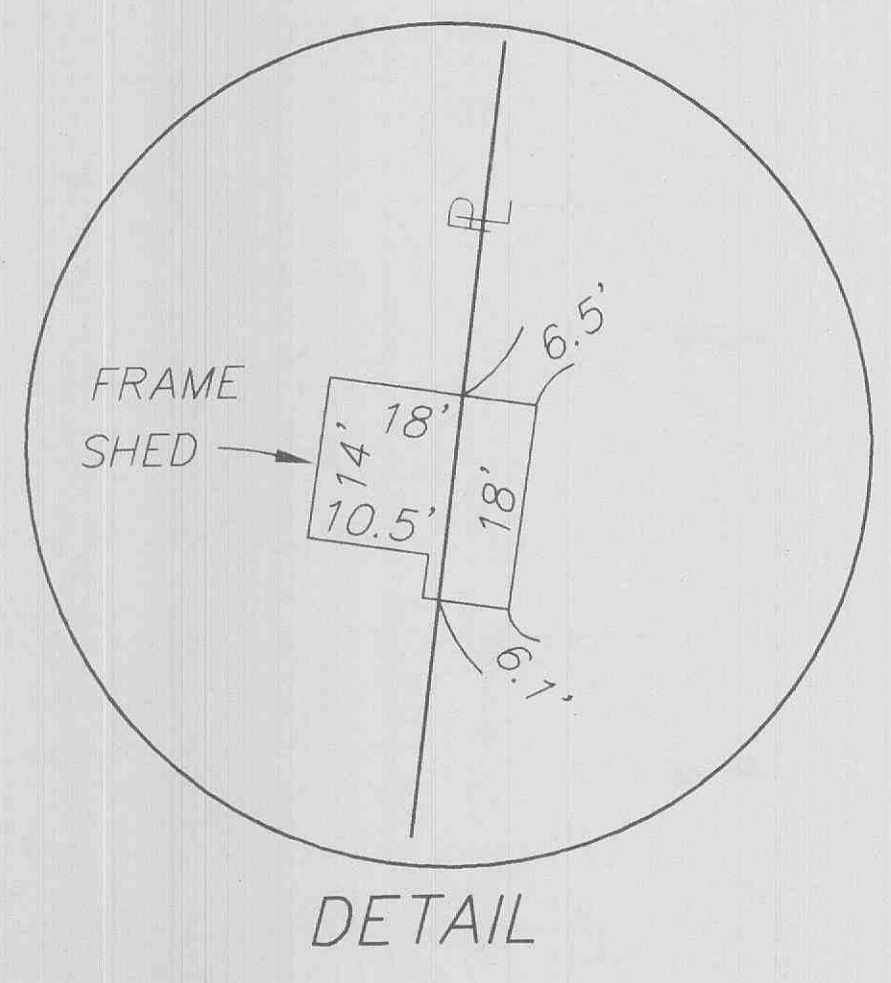

UTILITY NOTE:
 UNDERGROUND FACILITY STRUCTURES AND UTILITIES HAVE BEEN PLOTTED FROM AVAILABLE SURVEYS AND RECORDED INFORMATION AND, THEREFORE, THEIR LOCATIONS MUST BE CONSIDERED APPROXIMATE ONLY. VERIFICATION OF LOCATION OF ALL UNDERGROUND STRUCTURES AND FACILITIES EITHER SHOWN OR NOT SHOWN ON THESE PLANS, SHALL BE THE RESPONSIBILITY OF THE CONTRACTOR.

8506385V, 1-20-97, 2-10-97