

GENERAL NOTES

- UNDERGROUND UTILITIES SHOWN HEREON WERE PLOTTED FROM AVAILABLE INFORMATION AND DO NOT NECESSARILY REFLECT THE ACTUAL EXISTENCE, NONEXISTENCE, SIZE, TYPE, NUMBER OR LOCATION OF THESE OR OTHER UTILITIES. THE GENERAL CONTRACTOR SHALL BE RESPONSIBLE FOR VERIFYING THE ACTUAL LOCATION OF ALL UNDERGROUND UTILITIES, SHOWN OR NOT SHOWN, AND SAID UTILITIES SHALL BE LOCATED IN THE FIELD PRIOR TO ANY GRADING, EXCAVATION OR CONSTRUCTION OF IMPROVEMENTS. THESE PROVISIONS SHALL IN NO WAY ABSOLVE ANY PARTY FROM COMPLYING WITH THE UNDERGROUND FACILITY SAFETY AND DAMAGE PREVENTION ACT, CHAPTER 319, RSMO.
- CONTRACTOR SHALL NOT INSTALL POWER CONDUIT OR CABLES UNTIL MEETING WITH POWER COMPANY TO DETERMINE FINAL LOCATION.
- SEE CIVIL PLANS FOR ALL PROPOSED SIDEWALKS, ACCESSIBLE RAMPS, AND CURB LOCATIONS.
- SEE STRIPING PLANS FOR PROPOSED STRIPING.

LEGEND

- | | | | |
|---|------------------------------|---|--------------------|
| — | STOP LINE | — | STREET SIGN |
| ● | TYPE B BASE | — | PRIORITY LINE |
| ○ | TYPE C BASE | — | RECURRING |
| ⊖ | FLASHER CONTROLLER ENCLOSURE | — | TO BE REMOVED |
| ⊕ | PULL BOX TYPE 1, PREFORMED | — | USE IN PLACED |
| ⊖ | FLYING CONTROLLER | — | CONTINUING |
| ⊕ | POWER POLE | — | OVER HEAD ELECTRIC |
| ⊖ | TYPE A POWER SUPPLY | — | WATER LINE |
| ⊕ | EXISTING PULL BOX | — | TELEPHONE LINE |
| ⊖ | POWER POLE | — | GAS WALK |
| ⊕ | CONDUIT IN TRENCH | — | WATER VALVE |
| ○ | POST NUMBER | — | FIRE HYDRANT |
| ⊖ | PULL BOX NUMBER | — | PULL BOX |

GENERAL NOTES

- ADVANCED WARNING BEACONS SHALL BE PROGRAMMED TO OPERATE FOR 45 MINUTES BEFORE THE START OF SCHOOL TO 15 MINUTES AFTER THE START OF SCHOOL, AND IN THE AFTERNOON THEY SHOULD FLASH FROM 15 MINUTES PRIOR TO SCHOOL, DISMISSAL, AND 45 MINUTES AFTER SCHOOL DISMISSAL.
- SEE DETAIL FOR WIRING DIAGRAM FOR ADVANCED FLASHERS (TIME CLOCK ACTIVATION).
- PROPOSED SIGNING IS INDICATED ON THIS PLAN FOR CONTRACTORS USE ONLY. ALL SIGN QUANTITIES AND LAYOUT LOCATION ARE SHOWN ON THE STRIPING AND SIGNING PLANS.

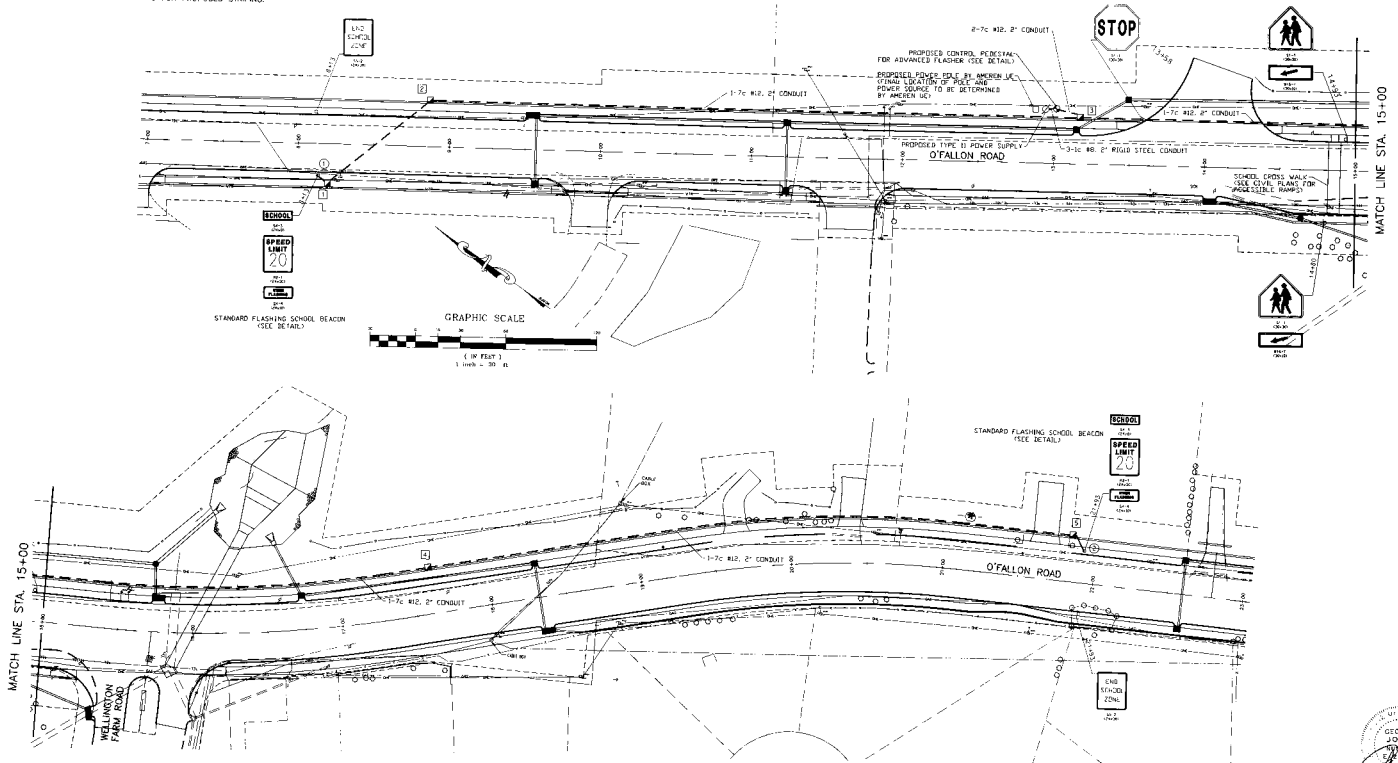

PLAN

DATE	BY
NOV 19 1988	...
PROJECT	...
NO. 1000	...

PROFILE

DATE	BY
NOV 19 1988	...
PROJECT	...
NO. 1000	...

PLAT DATA

DATE	BY
NOV 19 1988	...
PROJECT	...
NO. 1000	...

ST. CHARLES COUNTY ENGINEER
 GEORGE JOHN
 63775
 12-2-03