

GENERAL NOTES

- Do not scale drawing. Follow dimensions.
- Curb and joint dimensions shown in Pavement Construction Details for Joints and Curbs, Std. Dwg. C502.03.
- All preformed expansion joints shall extend from subgrade to 1/2" below top of finished surface of concrete. Joint sealant to conform to Section 1057.13.2 of the Saint Charles County Standard Specifications for Highway Construction.
- Plan is symmetrical about construction centerline.

COMMERCIAL ENTRANCE WITH ROLLED CURB
(For Actual Radius-SEE PLANS)

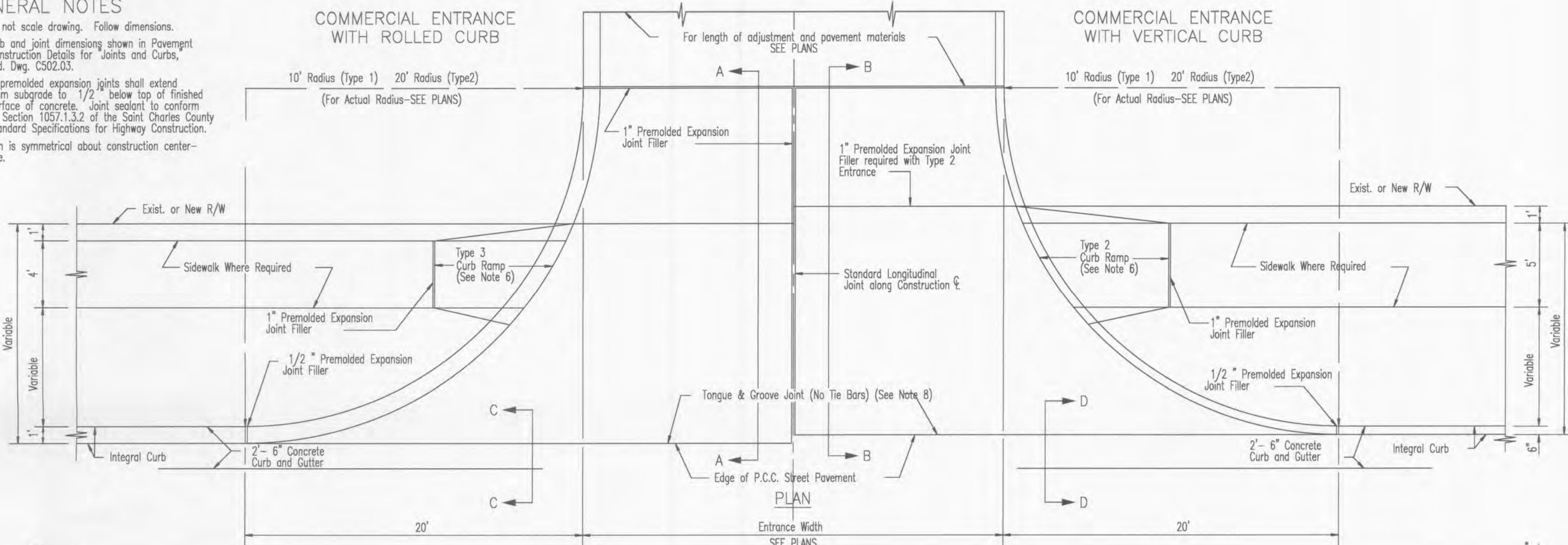

COMMERCIAL ENTRANCE WITH VERTICAL CURB
(For Actual Radius-SEE PLANS)

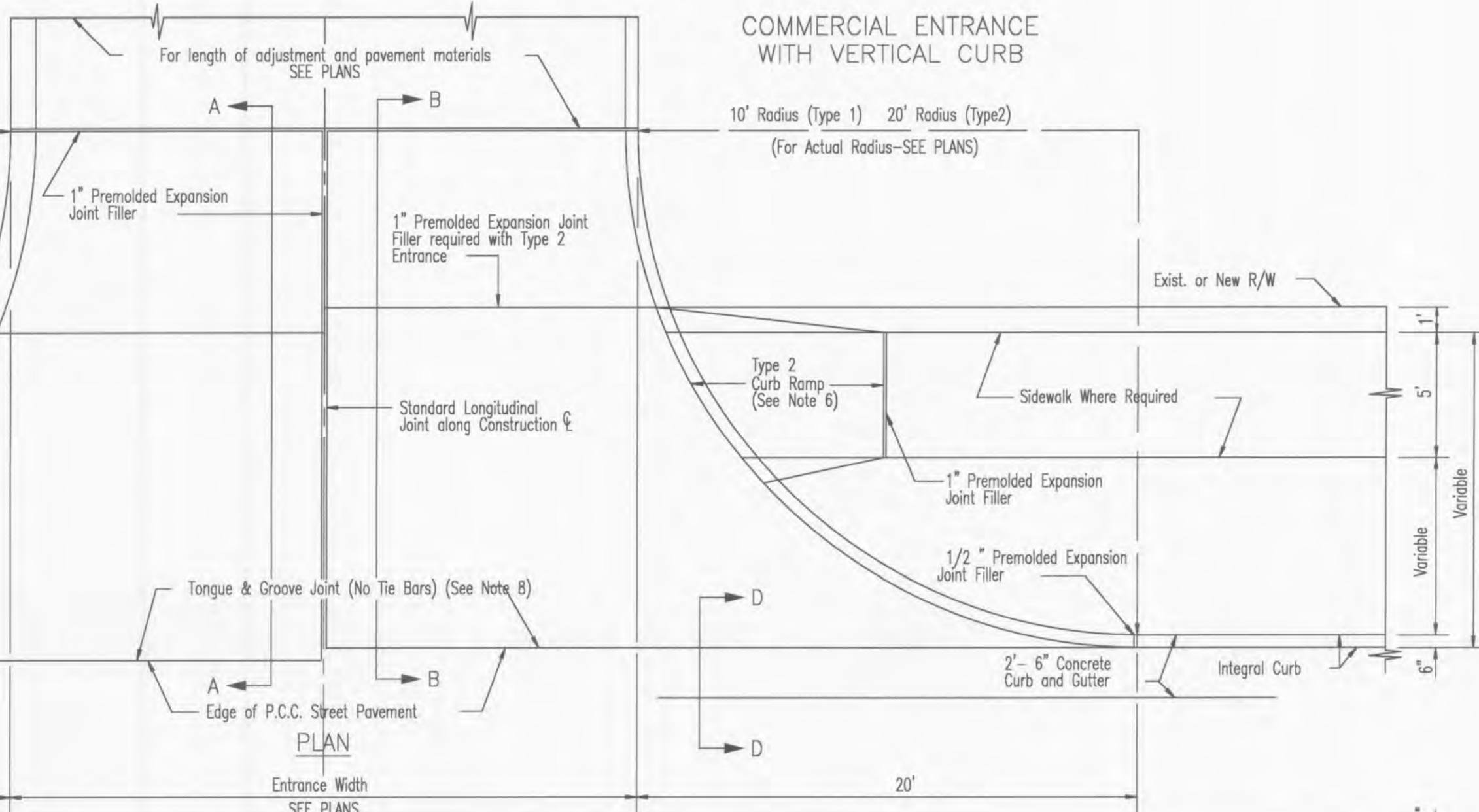

HALF DETAIL SHOWING ROLLED INTEGRAL CURB OR CURB AND GUTTER

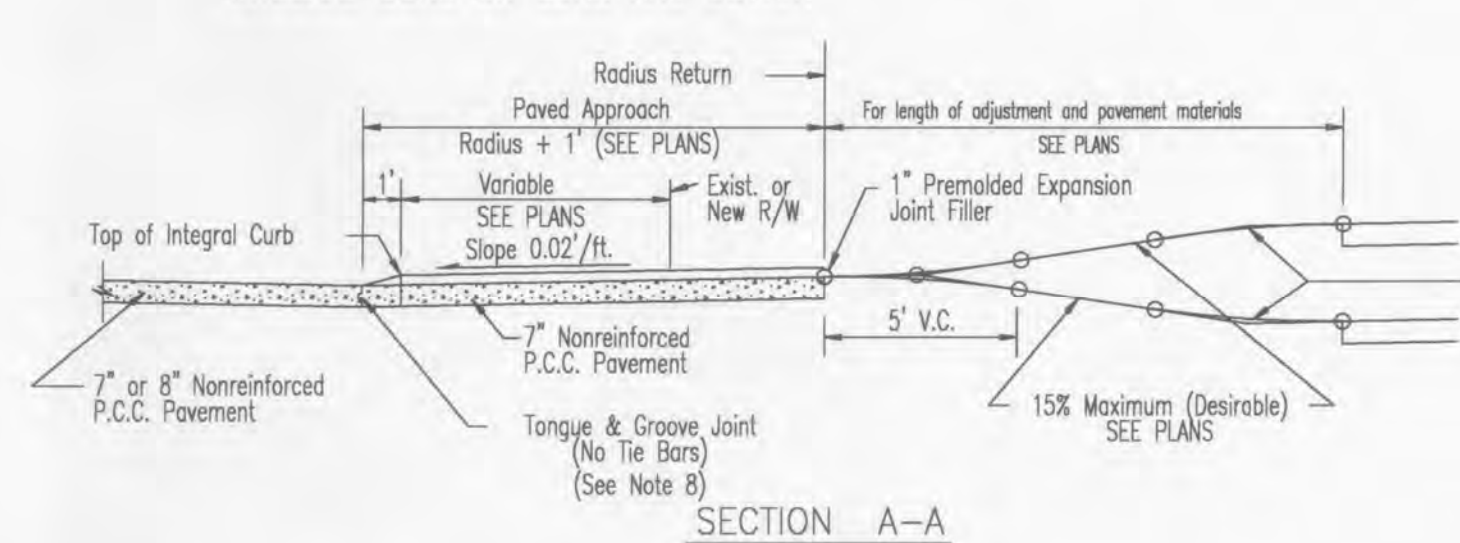

HALF DETAIL SHOWING VERTICAL INTEGRAL CURB OR CURB AND GUTTER

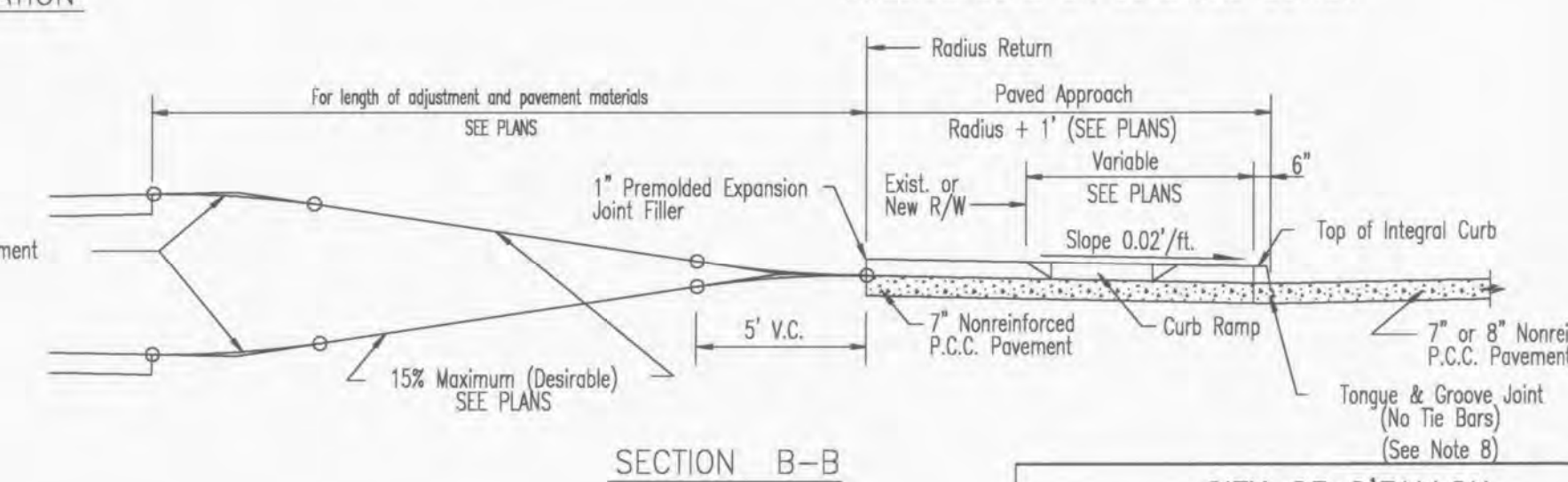

SECTION A-A

SECTION B-B

- or curb ramp on each side of the entrance shall be increased to match the driveway pavement thickness (7').
- Curb ramps are required with sidewalk and curb.

- Preformed Expansion Joint Filler material shall consist of a solid polymer foam or sponge rubber product that exhibits at least 50% recovery when tested in accordance to ASTM D-5249.
- For new concrete entrance of existing pavement and curbs, sawcut at 1 foot and install tie bars, 5/8" diameter, 18" long, at 12" centers along all saw cut edges. New tie bars shall be placed in drilled holes with Non-Shrink Grout. Tie bars, where existing, shall be cleaned and strengthened for incorporation in the new concrete.

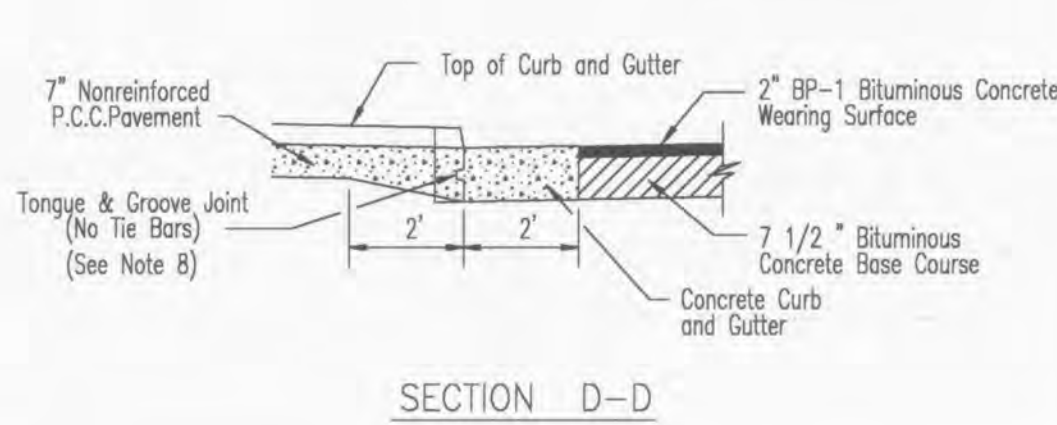
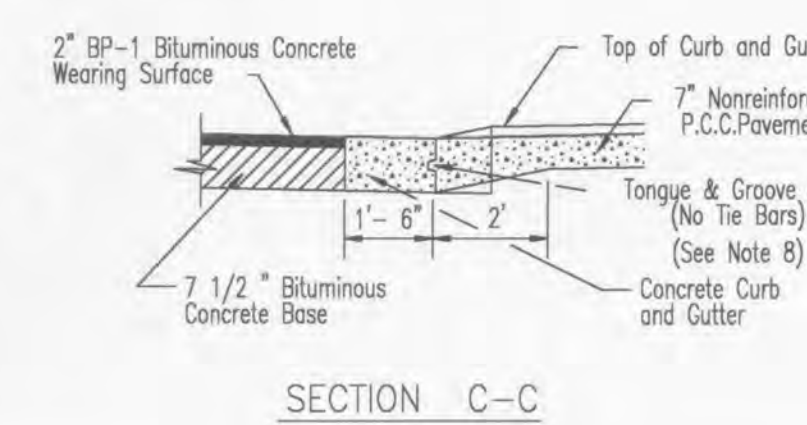

SECTION C-C

SECTION D-D

CITY OF O'FALLON
ENGINEERING DEPARTMENT
O'FALLON, MISSOURI

**ENTRANCE CONSTRUCTION DETAILS
TYPE 1 & 2 SPECIAL
CONCRETE ENTRANCES**

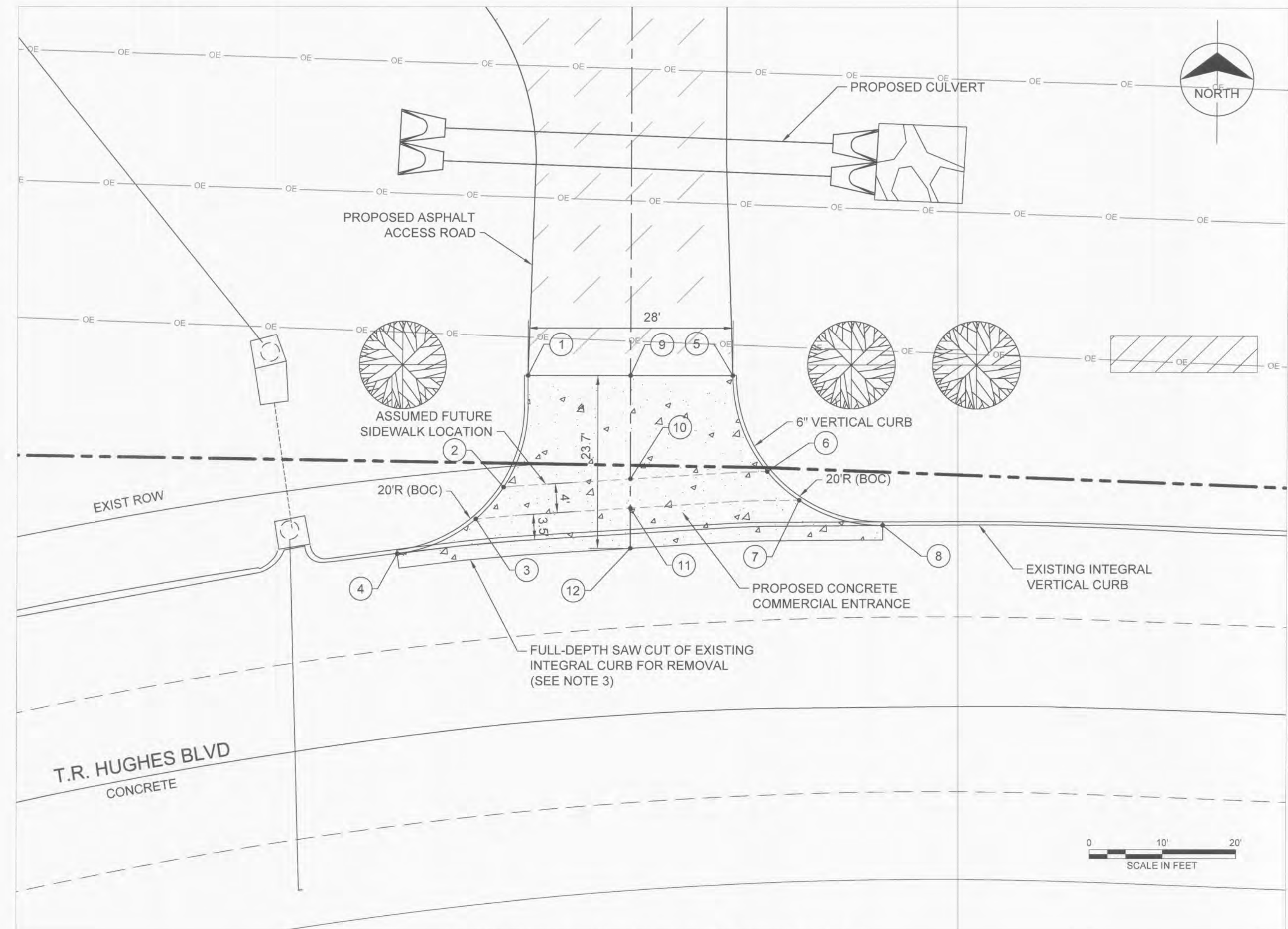

COMMERCIAL ENTRANCE PAVEMENT PLAN

ENTRANCE COORDINATE TABLE & WARPING ELEVATIONS				
POINT	NORTHING	EASTING	ELEVATION	REMARK
1	1089217.24	769884.60	501.69	GUTTER LINE / CURB FACE
2	1089201.94	769881.26	501.23	GUTTER LINE / CURB FACE
3	1089197.59	769877.43	501.24	GUTTER LINE / CURB FACE
4	1089192.82	769866.60	APPROX 501.41	GUTTER LINE - MATCH EXIST
5	1089217.24	769912.60	501.13	GUTTER LINE / CURB FACE
6	1089204.13	769917.35	500.40	GUTTER LINE / CURB FACE
7	1089200.16	769921.76	500.21	GUTTER LINE / CURB FACE
8	1089196.74	769933.25	APPROX 499.85	GUTTER LINE - MATCH EXIST
9	1089217.24	769898.60	501.41	CENTER LINE
10	1089203.09	769898.60	500.88	CENTER LINE
11	1089199.08	769898.60	500.80	CENTER LINE
12	1089193.57	769898.60	APPROX 500.77	CENTER LINE - MATCH EXIST

NOTES:

- THE PAVEMENT DETAILS SHOWN ON THIS SHEET ARE CITY OF O'FALLON TYPICAL DETAILS AS PROVIDED BY THE CITY OF O'FALLON ENGINEERING DEPARTMENT.
- TYPE 2 COMMERCIAL ENTRANCE SHALL BE CONSTRUCTED IN ACCORDANCE WITH THE "COMMERCIAL CONCRETE ENTRANCE DETAILS" AS SHOWN ON THIS SHEET.
- FULL DEPTH SAW CUT PAVEMENT REMOVAL SHALL BE TO THE NEAREST TRANSVERSE JOINT ALONG T.R. HUGHES BLVD.
- VERTICAL CURB AND GUTTER (2'-6" WIDE) SHALL BE CONSTRUCTED AS SHOWN IN THE "TYPICAL JOINT AND CURB DETAILS" ON THIS SHEET. DOWELS SHALL BE USED TO TIE THE NEW CONCRETE PAVEMENT INTO EXISTING CONCRETE PAVEMENT.
- TEMPORARY CONSTRUCTION ENTRANCE SHALL BE 12" OF TYPE 5 AGGREGATE ON TOP OF MIRAFI GEOTEXTILE FABRIC.

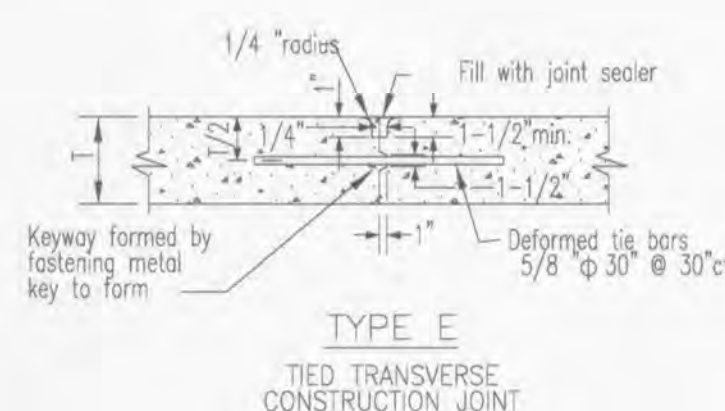

**TYPE E
TIED TRANSVERSE
CONSTRUCTION JOINT**
(To be used at joint not on 16' or 20' spacing)

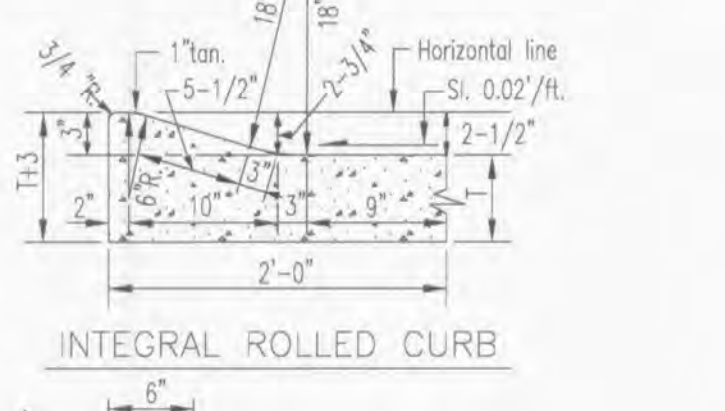

**TYPE F
SAWED OR PREFORMED STRIP
LONGITUDINAL CONSTRUCTION JOINT**
(See Note 5)

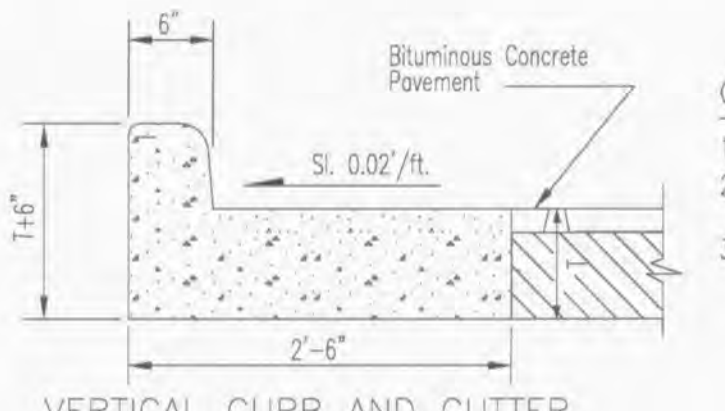

**TYPE G
SAWED OR PREFORMED STRIP
TRANSVERSE CONSTRUCTION JOINT**
(See Note 4)

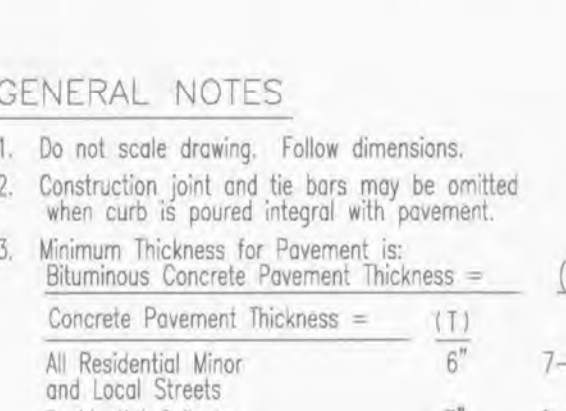

**TYPE H
SAWED OR PREFORMED STRIP
TRANSVERSE CONSTRUCTION JOINT**
(See Note 4)

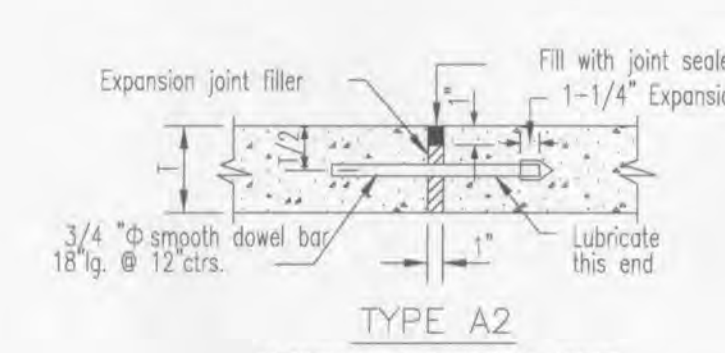

**TYPE A2
ALTERNATE EXPANSION JOINT**

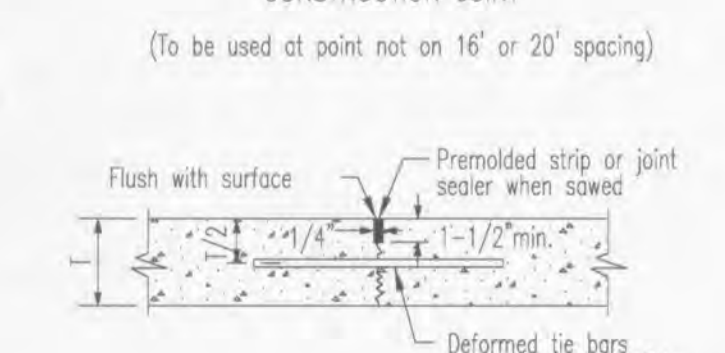

**TYPE B
LONGITUDINAL
CONSTRUCTION JOINT**
(See Note 5)

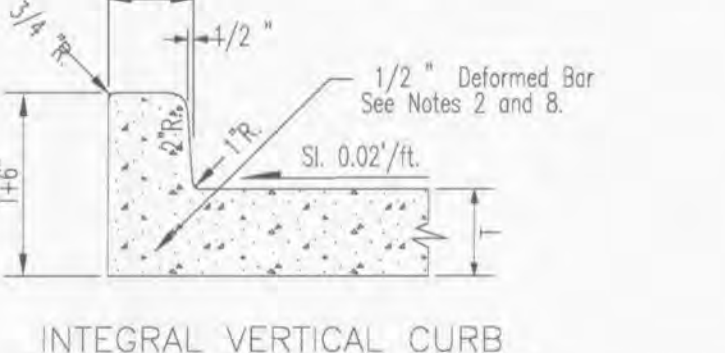

**TYPE C
SAWED OR PREFORMED STRIP
TRANSVERSE CONSTRUCTION JOINT**
(See Note 4)

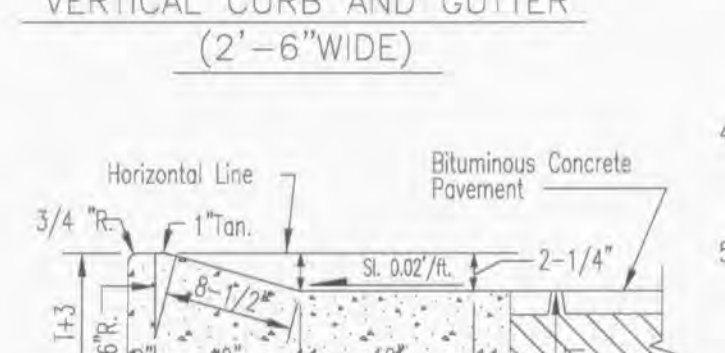

**TYPE D
TRANSVERSE CONSTRUCTION JOINT**

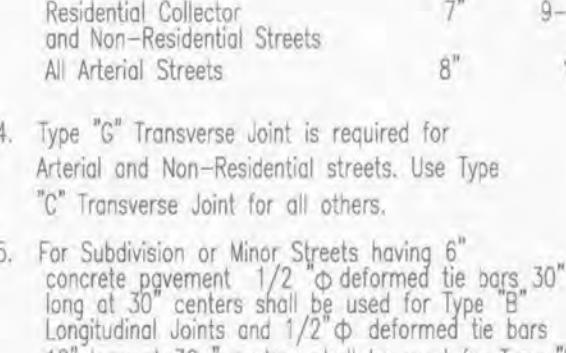

**TYPE E
VERTICAL CURB AND GUTTER**
(2'-6" WIDE)

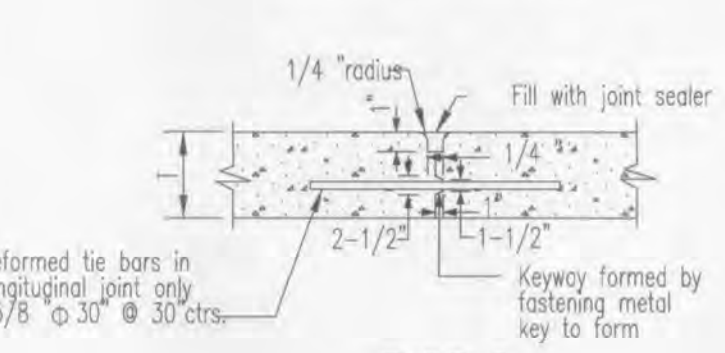

**TYPE F
SAWED OR PREFORMED STRIP
TRANSVERSE CONSTRUCTION JOINT**
(See Note 4)

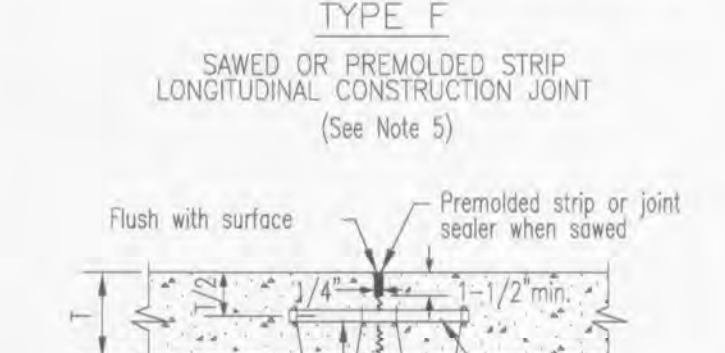

**TYPE G
ROLLED CURB AND GUTTER**
(2'-6" WIDE)

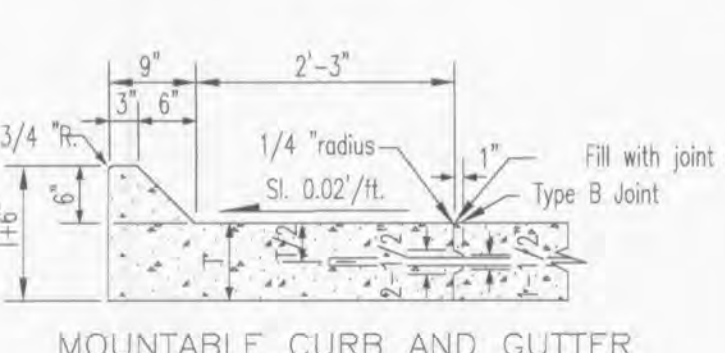

**TYPE H
MOUNTABLE CURB AND GUTTER**
(2'-6" WIDE)

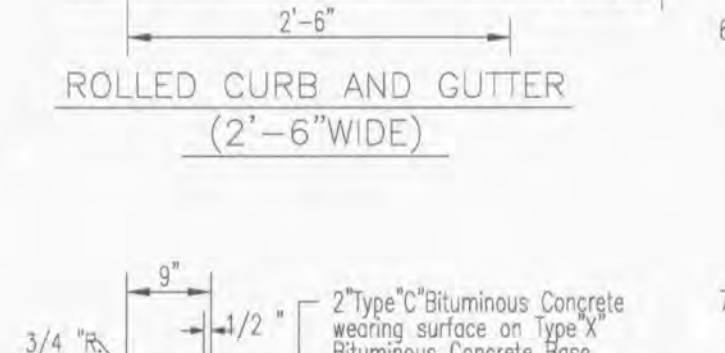

**TYPE I
TYPE S CONCRETE CURB**

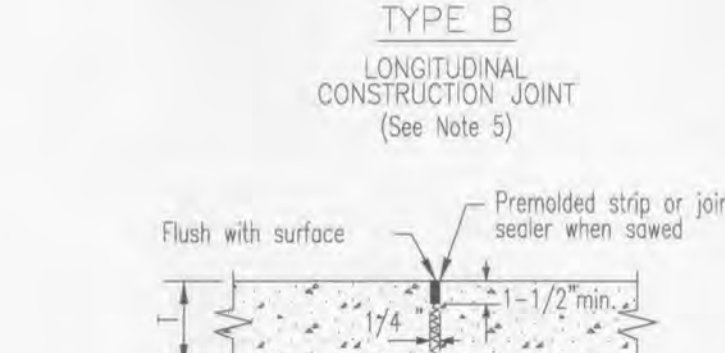

**TYPE J
SAWED OR PREFORMED STRIP
TRANSVERSE CONSTRUCTION JOINT**
(See Note 4)

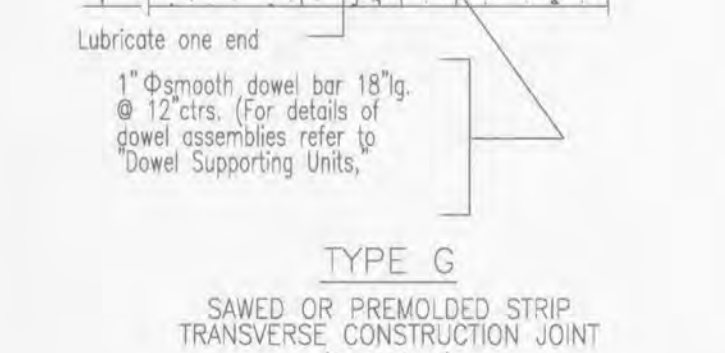

**TYPE K
SAWED JOINT WITH TIE BARS**

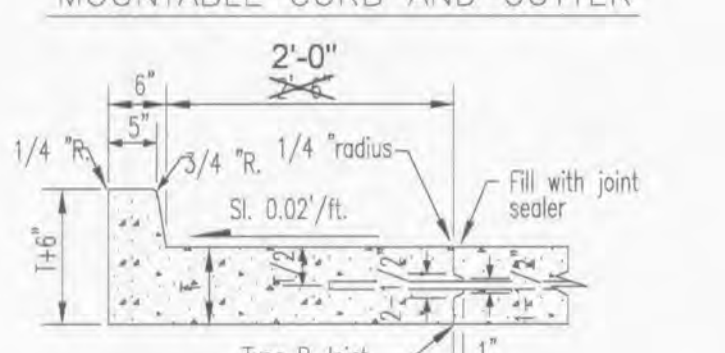

**TYPE L
MOUNTABLE CURB AND GUTTER**
(2'-6" WIDE)

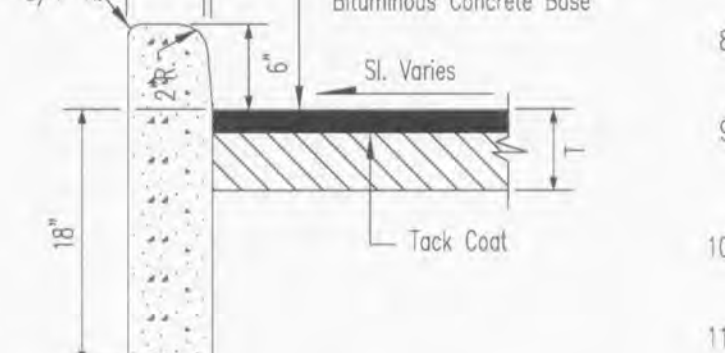

**TYPE M
TYPE S CONCRETE CURB**

GENERAL NOTES

- Do not scale drawing. Follow dimensions.
- Construction joint and tie bars may be omitted when curb is poured integral with pavement.
- Minimum Thickness for Pavement is:
Bituminous Concrete Pavement Thickness = (1)
Concrete Pavement Thickness = (1)
All Residential Minor and Local Streets
Residential Collector and Non-Residential Streets
All Arterial Streets
- Type "E" Transverse Joint is required for Arterial and Non-Residential streets. Use Type "G" Transverse Joint for all others.
- For Subdivision or Minor Streets having 6" concrete pavement, 1/2" deformed tie bars, 30" long at 30" centers shall be used for Type "E" longitudinal joints and 1/2" deformed tie bars, 18" long at 30" centers shall be used for Type "E" longitudinal joints.
- Refer to Pavement Construction Details for Integral Vertical Curb and Concrete Pavement Typical Sections and Details, and Integral Rolled Curb and Concrete Pavement Typical Sections and Details.
- All deformed bars for joints and curbs shall be steel bars conforming to A.S.T.M. A615-75, Grade 40.
- Length of the tie bars shall equal the thickness of pavement plus the height of curb less 3". Tie bars shall be placed at 24 centers.
- Transverse or longitudinal construction joints in all formed pavements may be made with a groover or tool, if such device has been approved in advance by the Department.
- The free end of the dowel bar for a length of at least 11 inches shall be coated with an approved graphite grease.
- All dowel bars 1 1/2" x 12" cts. shall be epoxy coated.
- Expansion joint A-2 from St. Louis County pavement construction details, shall be allowed in addition to Type A and AA expansion joints.

CITY OF O'FALLON
ENGINEERING DEPARTMENT
O'FALLON, MISSOURI

**PAVEMENT CONSTRUCTION DETAILS
JOINTS AND CURBS**

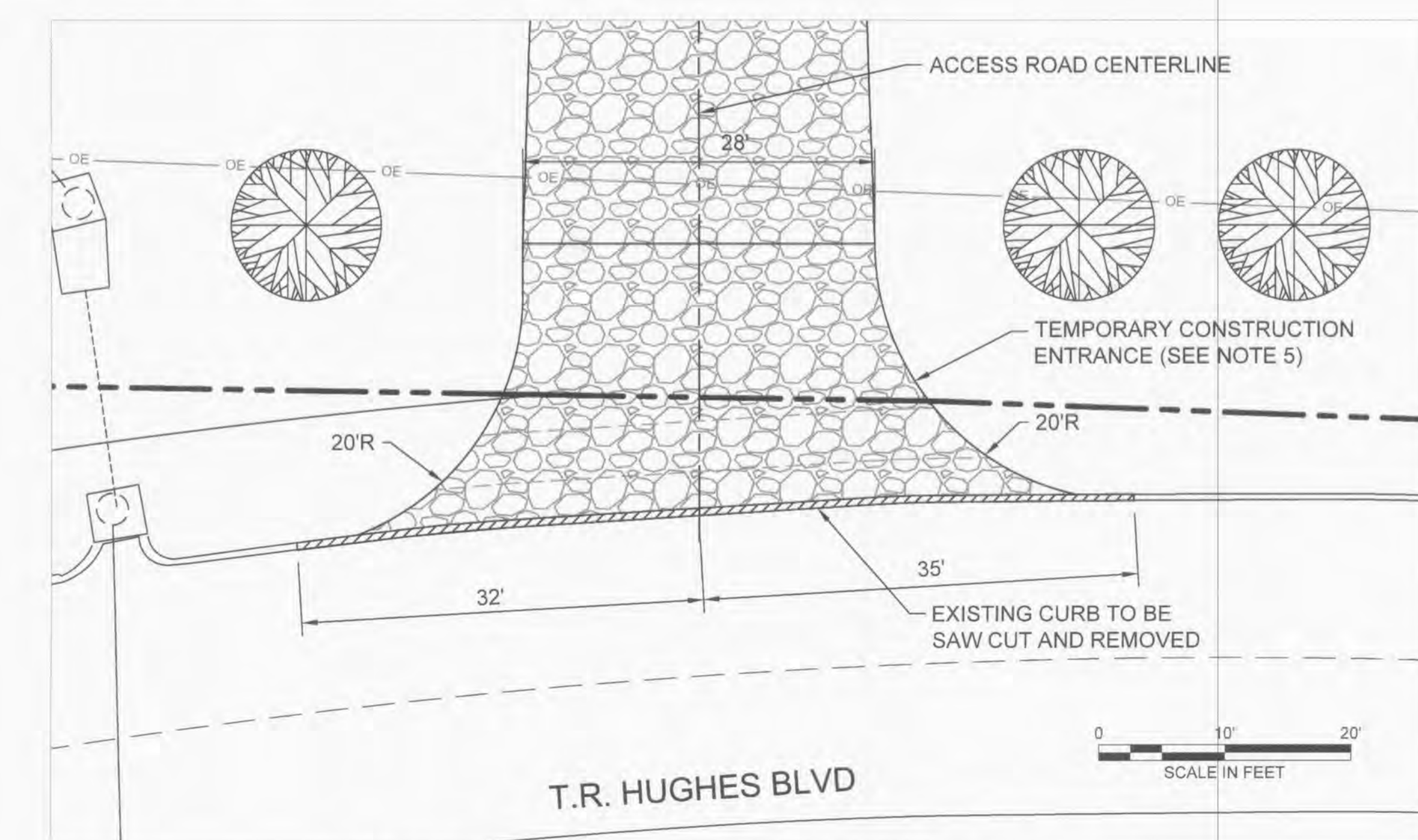

TEMPORARY CONSTRUCTION ENTRANCE PLAN

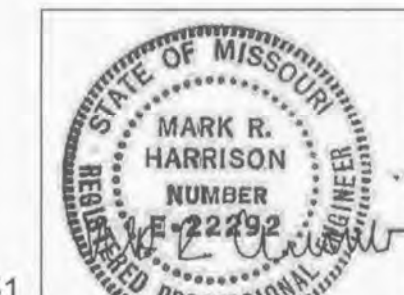

BMCD# 77051
425 S. Veterans, 4th Fl.
Chesterfield, MO 63017
(314) 882-1000

Date: 06/27/2014
Mark R. Harrison
Professional Engineer
#E-22292

REV	PROJ ID	DATE	DRWN	RVW	APPR

O'FALLON RENEWABLE ENERGY CENTER

COMMERCIAL ENTRANCE DETAILS

CP16

0