

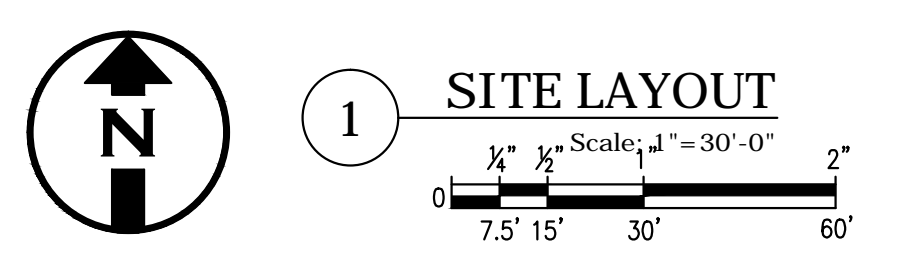

NOTES:
 THE PURPOSE OF THIS PAGE IS TO SHOW THE SITE LAYOUT OF THE SKATEPARK ONLY. REFER TO PLANS BY BAX ENGINEERING FOR GRADING, PARKING LOT, AND OTHER ITEMS FOUND ON SITE.

This sheet produced by another firm & included for information only.



INFORMATION PROVIDED BY:



Bax Engineering Company
 Serving Saint Charles County,
 Saint Louis County and beyond since 1981

REV	DESCRIPTION	DATE
1	ISSUE FOR CONSTRUCTION	02/14/12
2		
3		
4		

FARDCORE
 SECRETIVE SKATEPARKS INC.
 SKATEPARK OWNED/OPERATED SINCE 2001

SITE LAYOUT
WESTHOFF PARK SKATEPARK
O'FALLON, MISSOURI

Drawn By: **J. HETHMON**
 Approved By: **N. BEMO**
 Scale: **AS NOTED**
 Project No: **11-115**
 Drawing No: **SP-1B**