

TRAFFIC CONTROL DETAIL FOR INTERSECTION  
 OF WOODLAWN DR. AND WEST ELM ST.  
 SCALE: 1:30

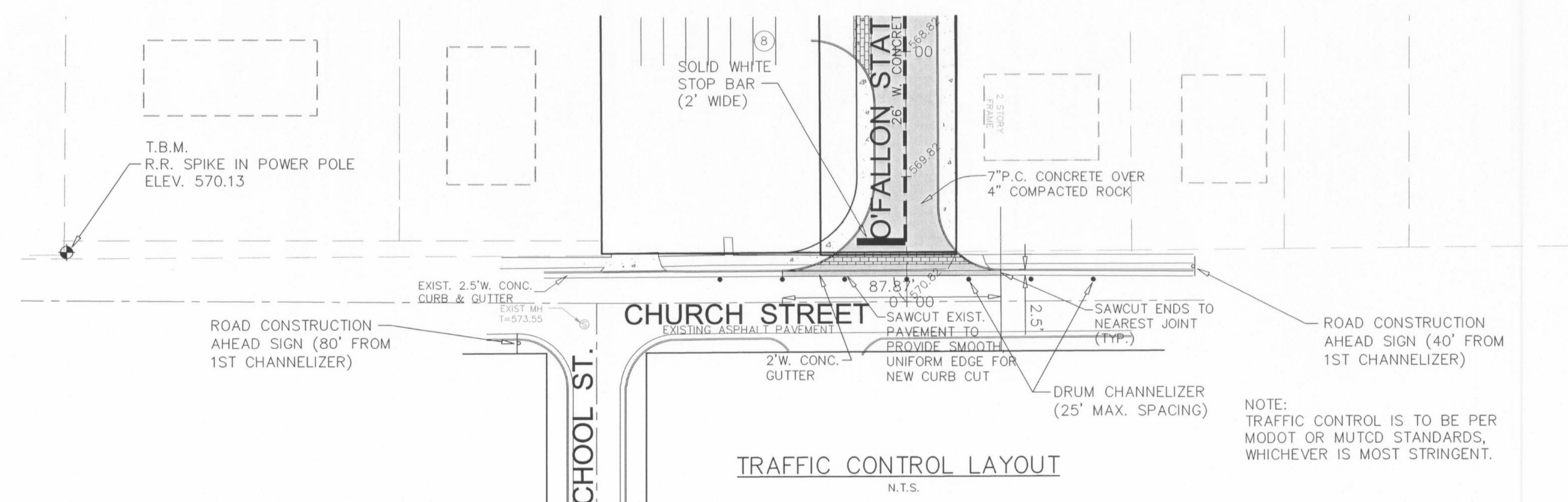

TRAFFIC CONTROL LAYOUT  
 N.T.S.  
 TRAFFIC CONTROL DETAIL FOR INTERSECTION  
 OF CHURCH ST. AND O'FALLON STATION DR.  
 SCALE: 1:30

NOTE:  
 TRAFFIC CONTROL IS TO BE PER  
 MODOT OR MUTCD STANDARDS,  
 WHICHEVER IS MOST STRINGENT.

TRAFFIC CONTROL  
 DETAILS  
 PLANNING & ZONING FILE NO. 2204.03

**ENGINEERS' CERTIFICATION:**  
 The following applies to ALL sheets and documents involved in the preparation of the plans and documents for this project. The responsibility for Professional Engineering liability on this project is limited to the set of plans displaying the signature and an original stamped seal of the Engineer on each sheet. ALL responsibility is Disclaimed: until ALL review agency approvals are granted; for all other plan sheets issued prior to this issue date; for this set when another set is issued after this date; if the sheets are used individually instead of a set. This applies for ALL sheets and documents involved in this project whether this certification appears on it or not. Copyright. All Rights Reserved.  
 ZAVRADINOS & ASSOCIATES, INC. DBA  
 ZAVRADINOS ENGINEERING & SURVEYING

STEVEN W. POLK  
 REGISTERED PROFESSIONAL ENGINEER  
 NUMBER E-18668  
 DATE 17/19

P:\Road\Projects\O'Fallon\Station\04126\04126.dwg, TRAFFIC CONTROL DETAIL 17, 8/10/2006 12:52:46 PM, 04