

REV. 5/10/06

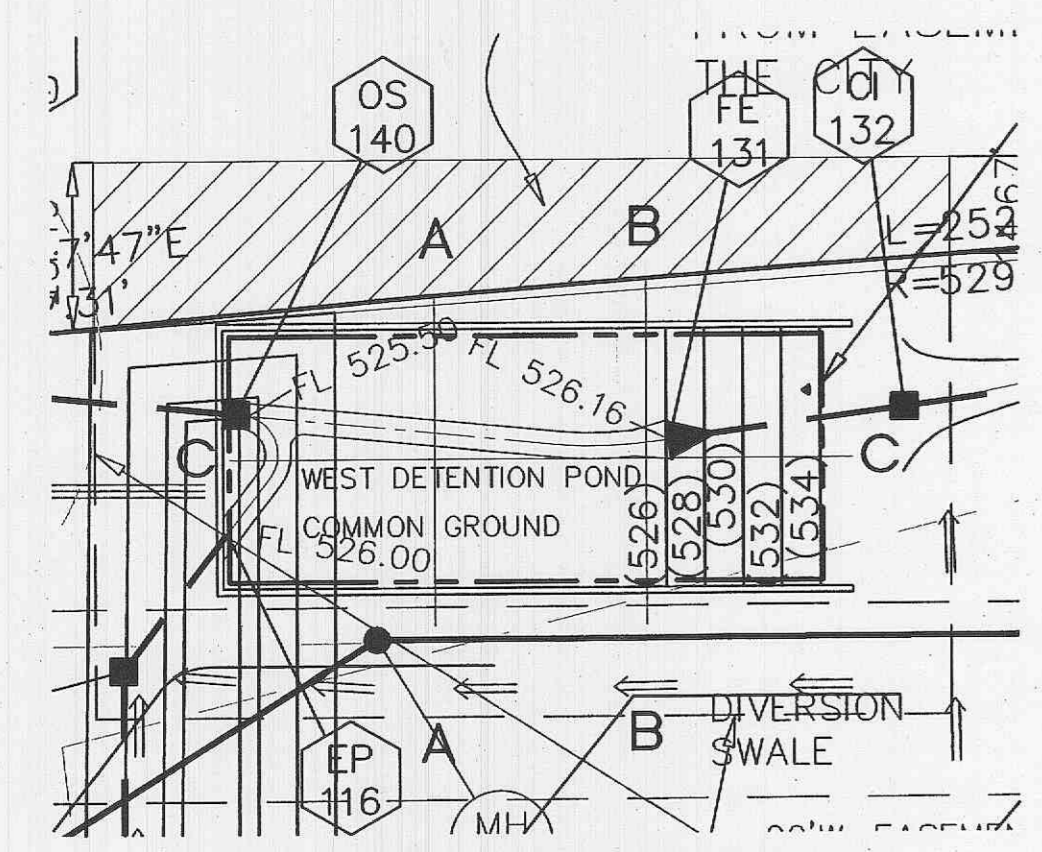

WEST DETENTION BASIN  
SCALE: 1:30

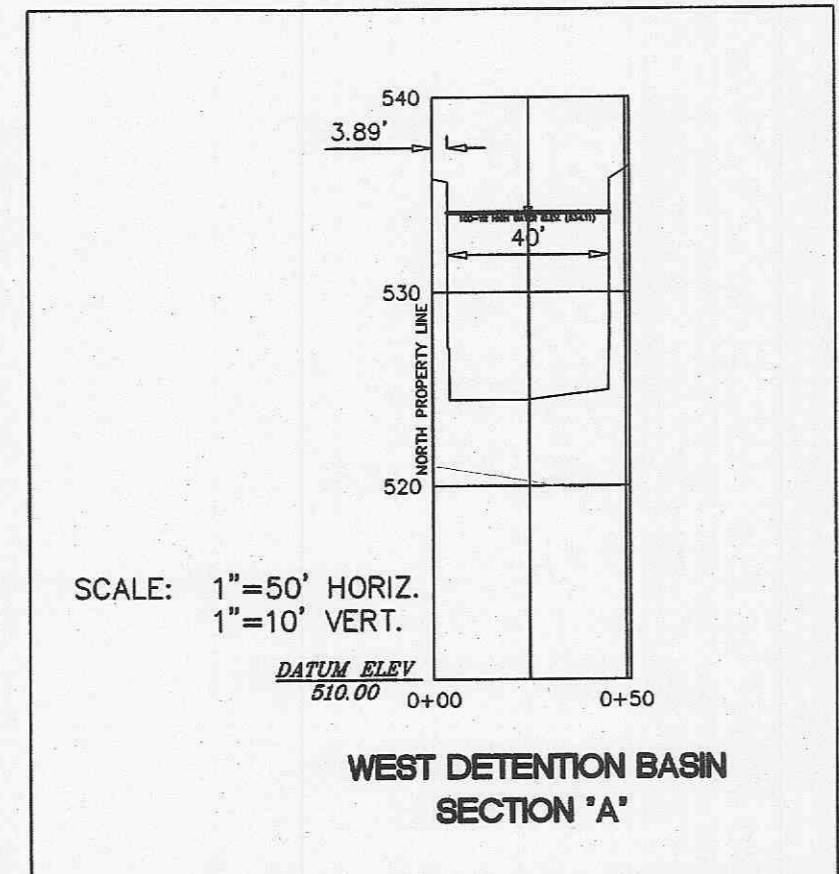

SCALE: 1"=50' HORIZ.  
1"=10' VERT.

WEST DETENTION BASIN  
SECTION 'A'

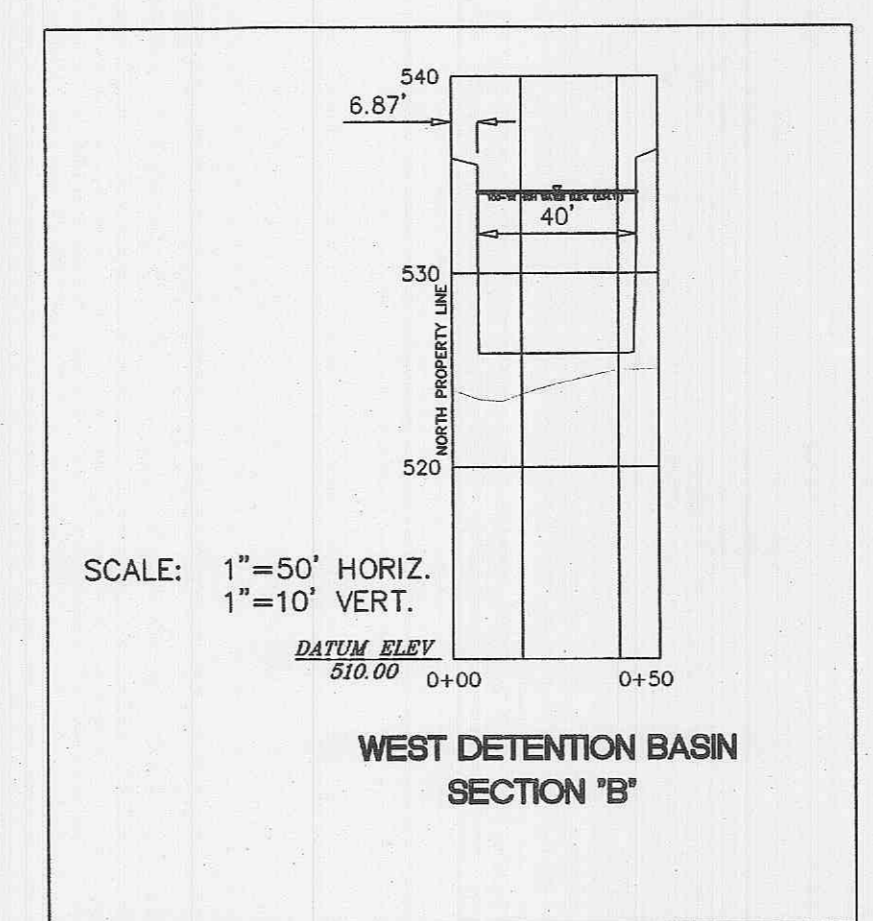

SCALE: 1"=50' HORIZ.  
1"=10' VERT.

WEST DETENTION BASIN  
SECTION 'B'

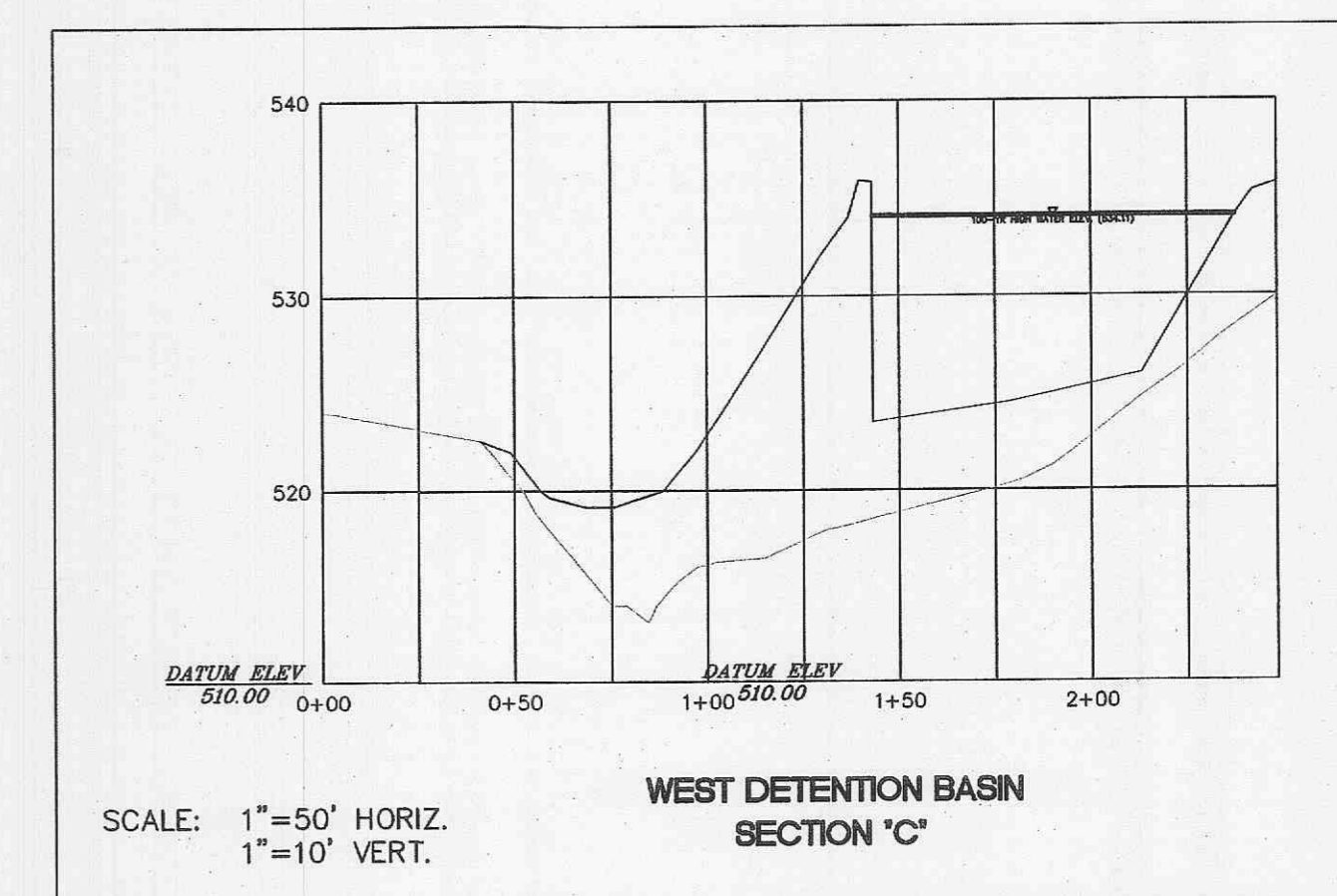

SCALE: 1"=50' HORIZ.  
1"=10' VERT.

WEST DETENTION BASIN  
SECTION 'C'

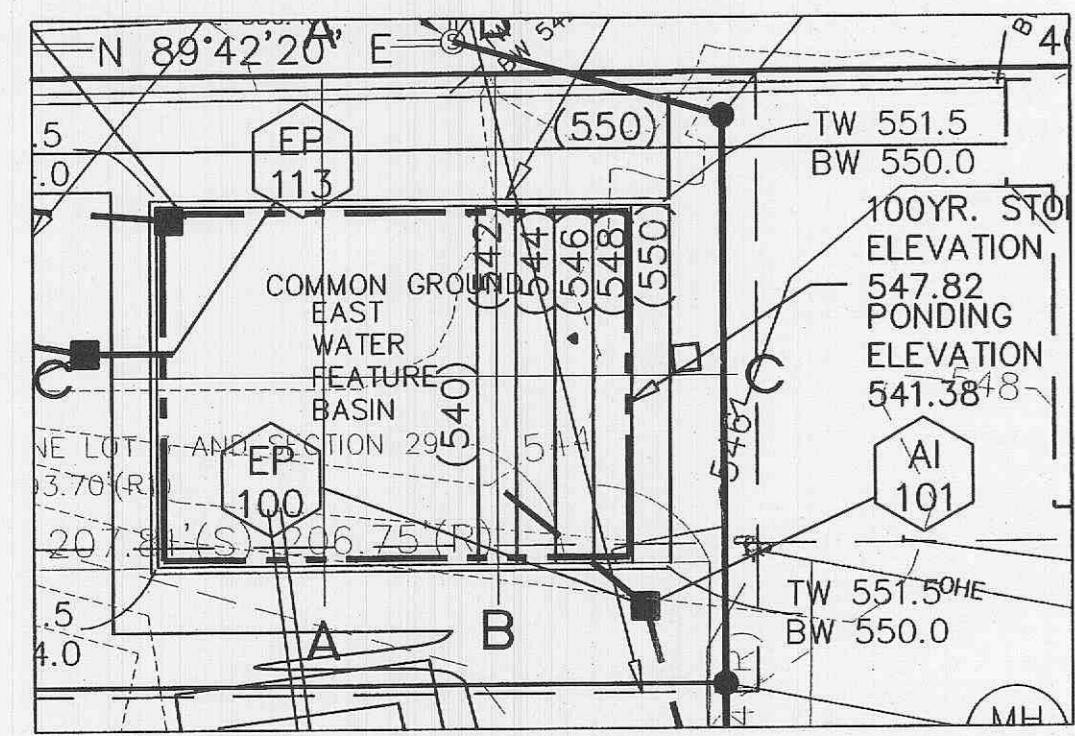

EAST DETENTION BASIN  
SCALE: 1:30

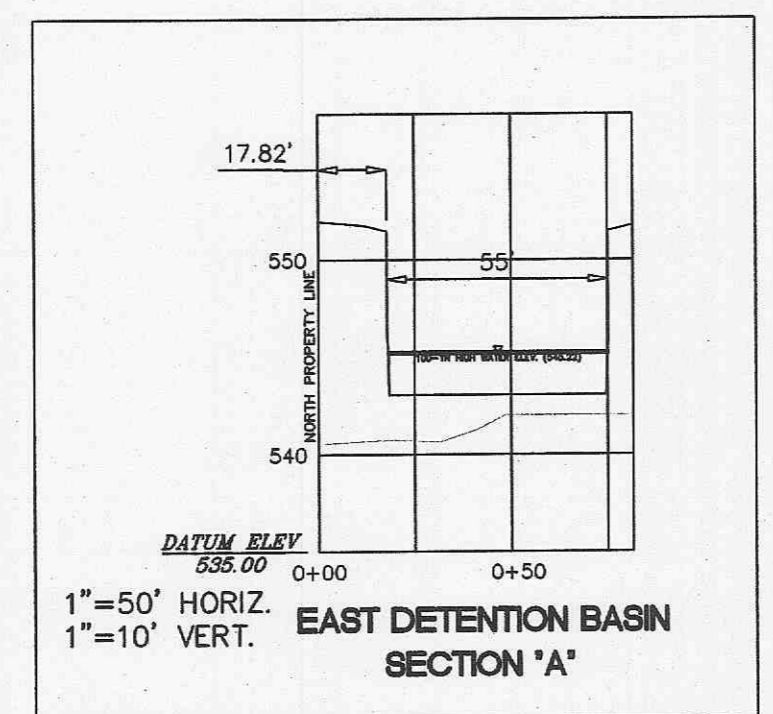

SCALE: 1"=50' HORIZ.  
1"=10' VERT.

EAST DETENTION BASIN  
SECTION 'A'

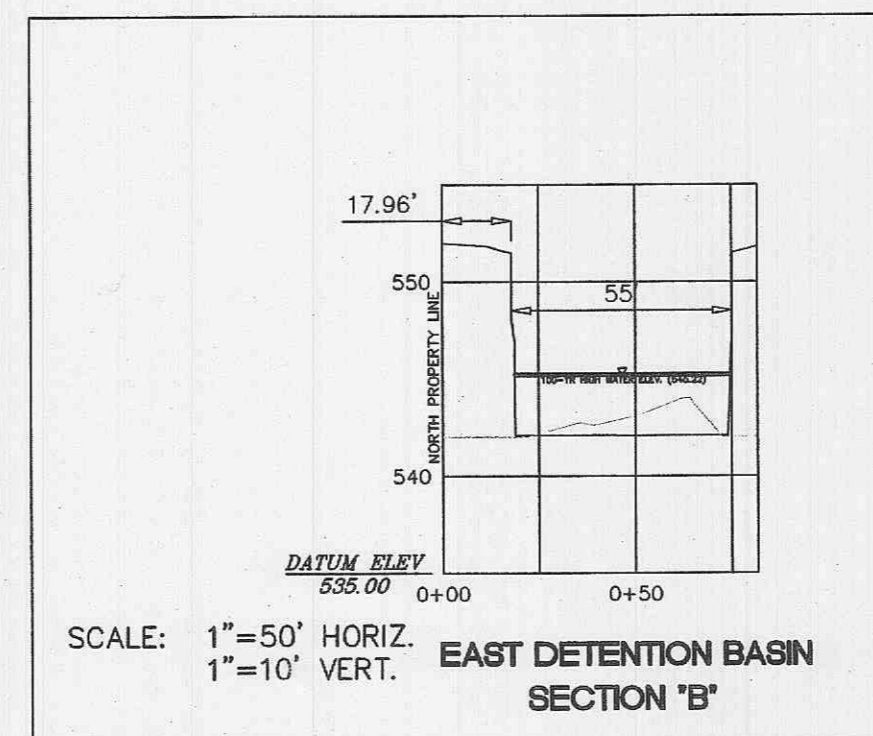

SCALE: 1"=50' HORIZ.  
1"=10' VERT.

EAST DETENTION BASIN  
SECTION 'B'

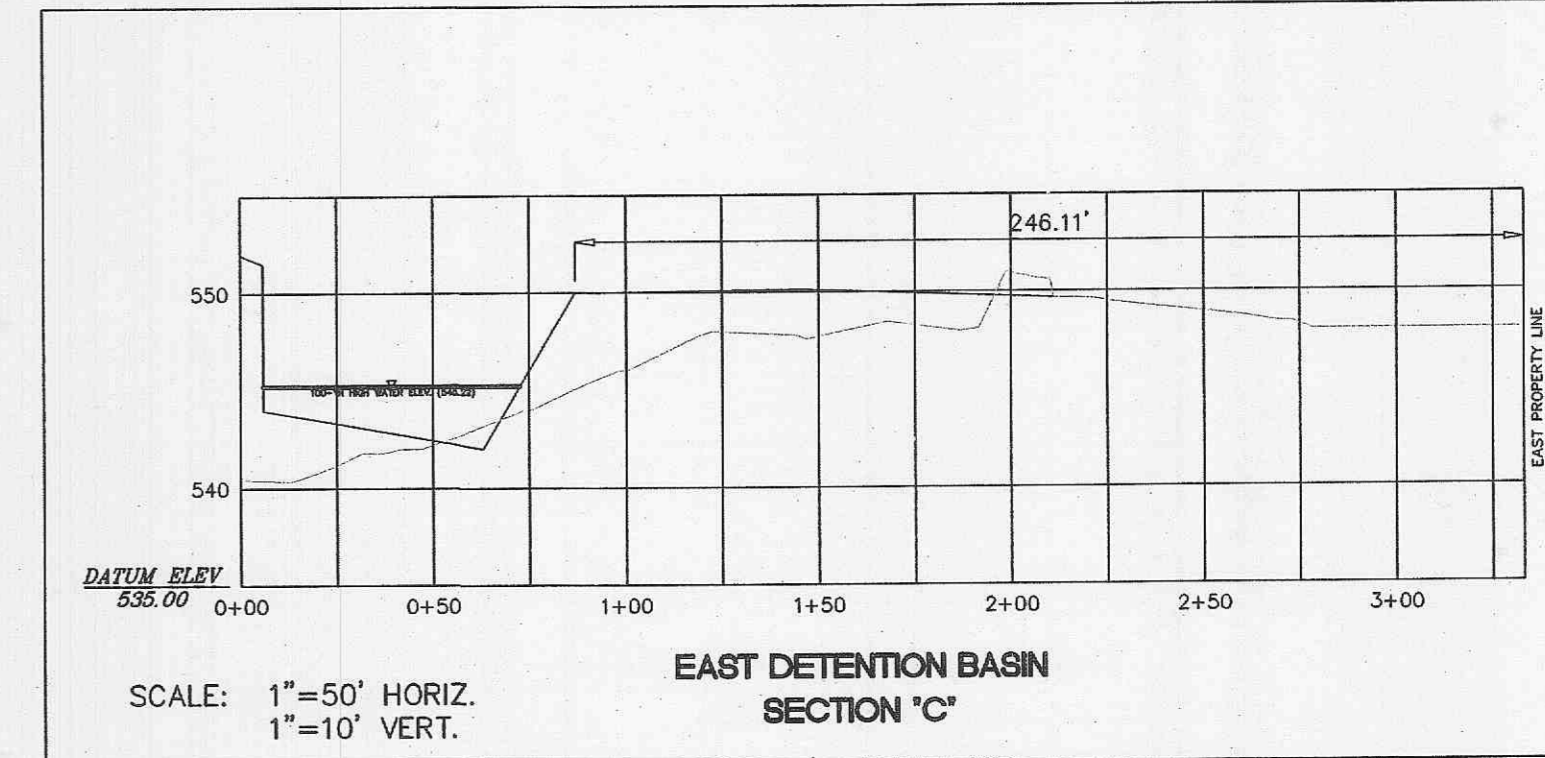

SCALE: 1"=50' HORIZ.  
1"=10' VERT.

EAST DETENTION BASIN  
SECTION 'C'

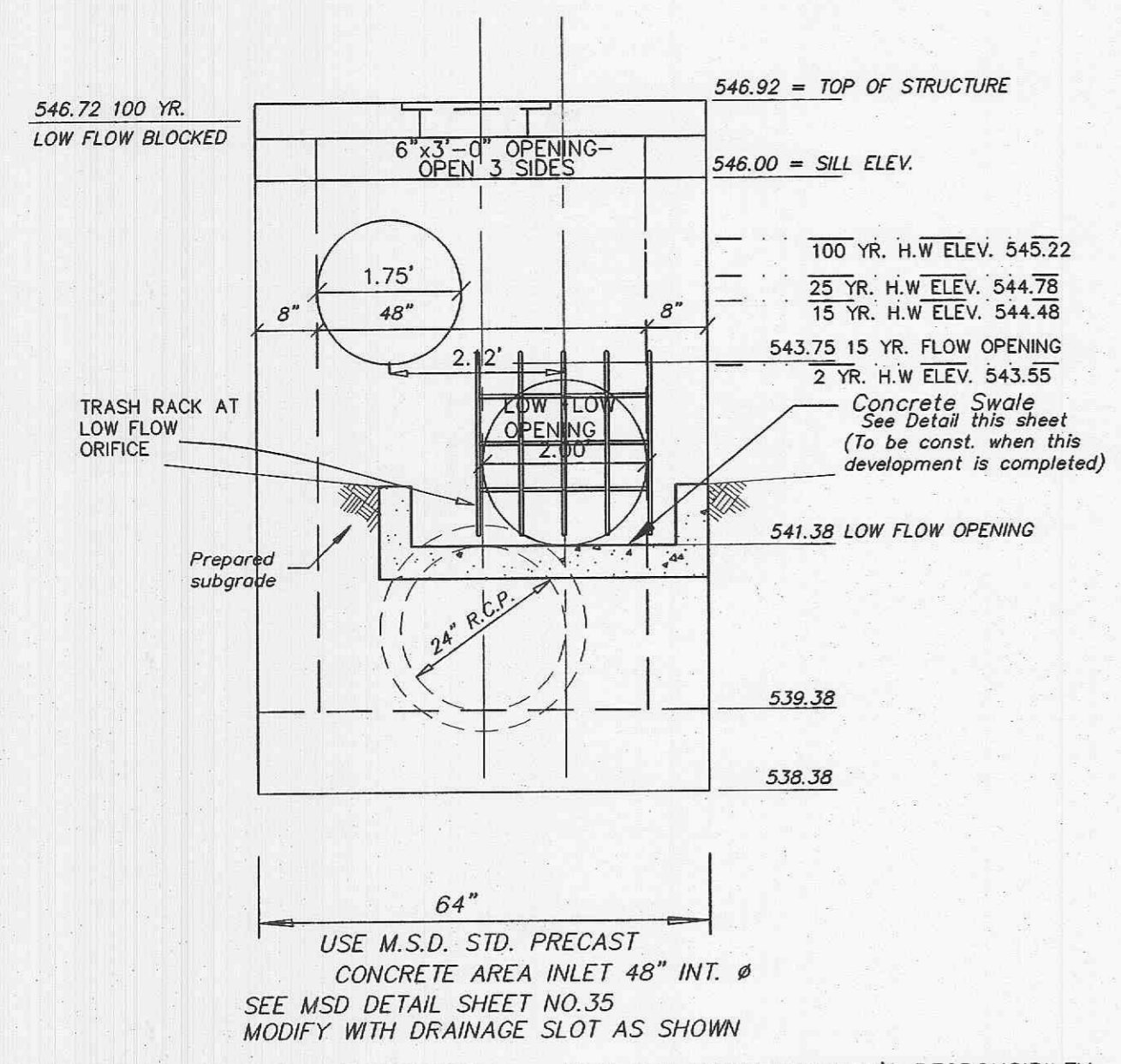

ADJUSTMENT TO OUTFALL STRUCTURE WITH BRICK WILL NOT BE ALLOWED. IT IS THE MANUFACTURER'S RESPONSIBILITY TO SUPPLY MSD WITH SHOP DRAWINGS SHOWING THE REQUIRED STEEL IN THIS STRUCTURE.

OVERFLOW STRUCTURE "99"  
EAST BASIN

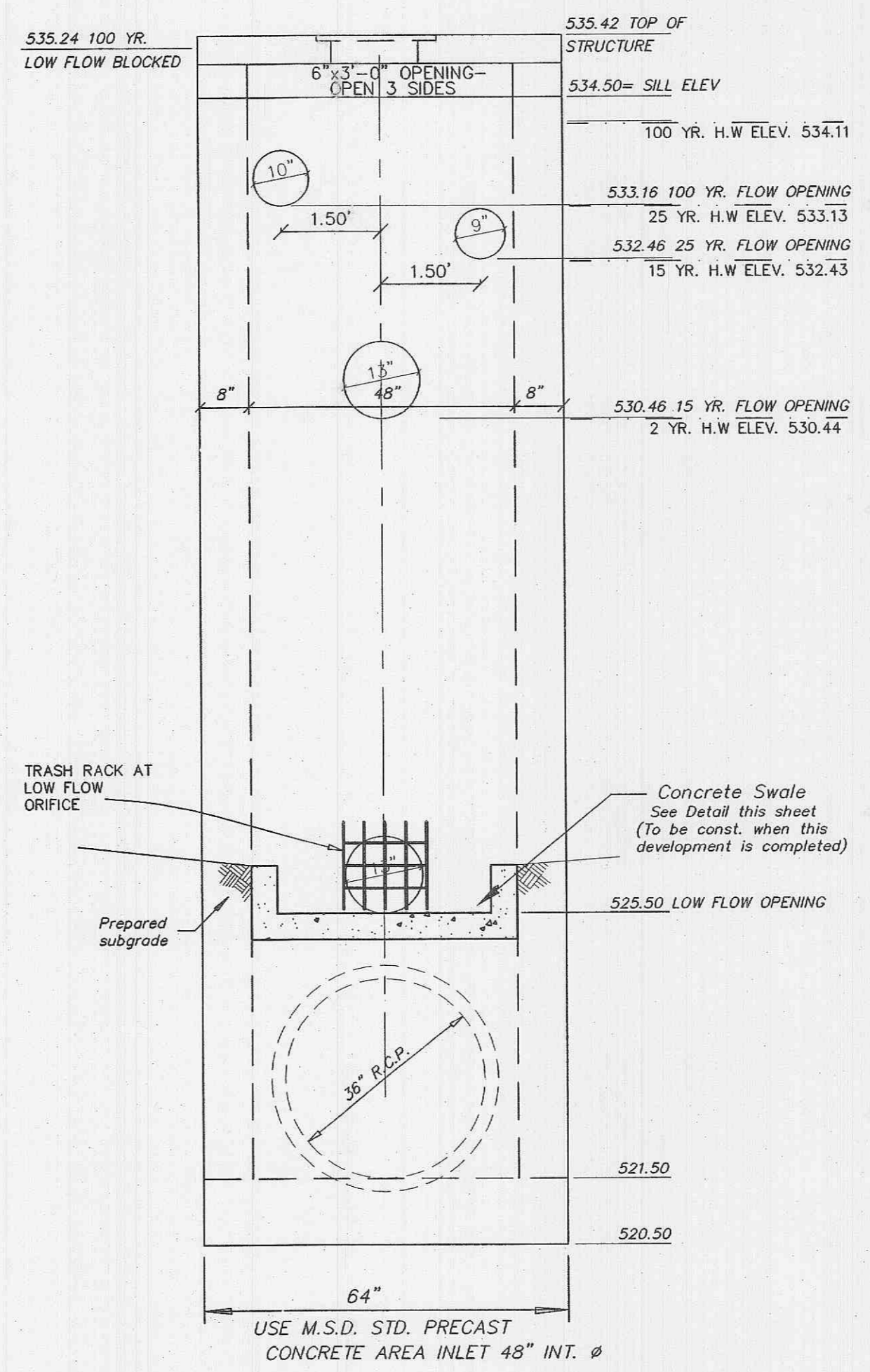

SEE MSD DETAIL SHEET NO.35 MODIFY WITH DRAINAGE SLOT AS SHOWN. ADJUSTMENT TO OUTFALL STRUCTURE WITH BRICK WILL NOT BE ALLOWED. IT IS THE MANUFACTURER'S RESPONSIBILITY TO SUPPLY MSD WITH SHOP DRAWINGS SHOWING THE REQUIRED STEEL IN THIS STRUCTURE.

OVERFLOW STRUCTURE "140"  
WEST DETENTION BASIN

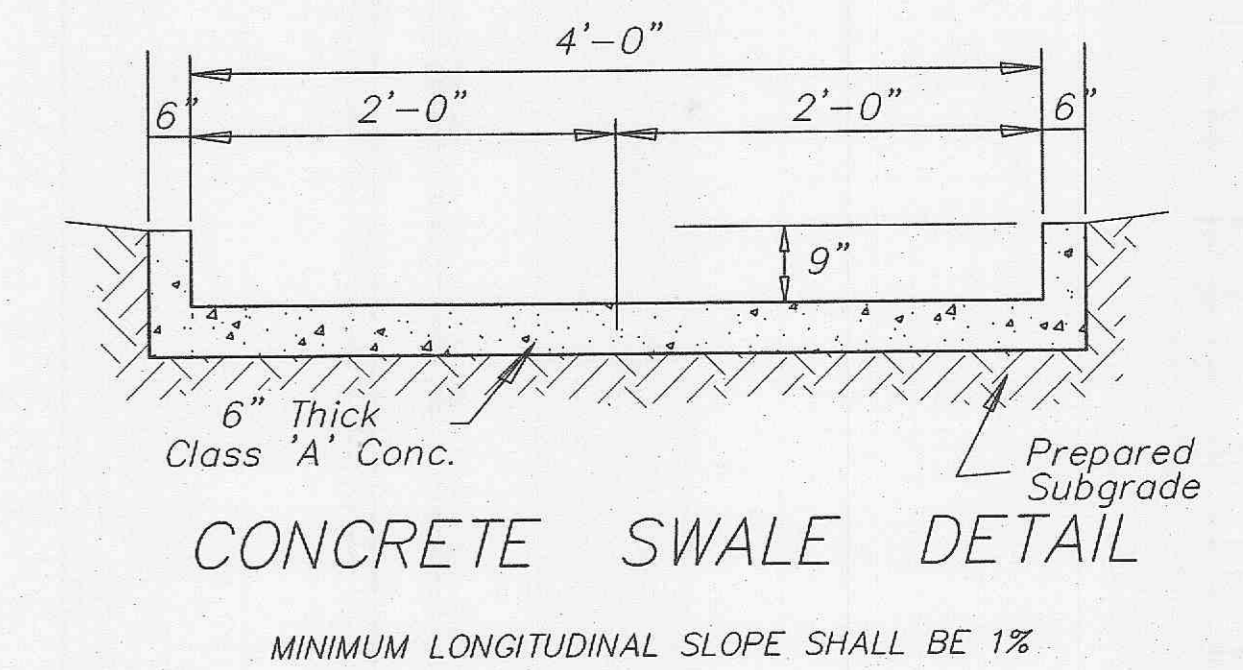

CONCRETE SWALE DETAIL

MINIMUM LONGITUDINAL SLOPE SHALL BE 1%

ENGINEERS' CERTIFICATION:  
The following applies to ALL sheets and documents involved in the preparation of the plans and documents for this project. The responsibility for Professional Engineering liability on this project is limited to the set of plans displaying the signature and an original stamped seal of the Engineer on each sheet. ALL responsibility is Disclaimed, until ALL review agency approvals are granted, for all other plan sheets issued prior to this issue date, for this set when another set is issued after this date, if the sheets are used individually instead of a set. This applies for ALL sheets and documents involved in this project whether this certification appears on it or not. Copyright. All Rights Reserved.  
ZAVRADINOS & ASSOCIATES, INC. DBA ZAVRADINOS ENGINEERING & SURVEYING

STEVEN W. POLK  
NUMBER E-18668  
DATE 5/11/06

DETENTION BASIN  
DETAILS  
PLANNING & ZONING FILE NO. 2204.03