

GRADING AND SITE PLAN

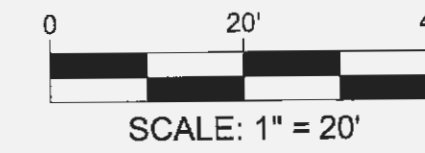

GENERAL NOTES:

- The Contractor is specifically cautioned that the location and/or elevation of existing utilities as shown on these plans is based on records of the various utility companies and, where possible, measurements taken in the field. The information is not to be relied on as being exact or complete. The Contractor must call the appropriate utility company to request exact field location of utilities. It shall be the responsibility of the Contractor to relocate all existing utilities which conflict with the proposed improvements shown on plans.
- All trenches under paved areas shall be backfilled with granular material and compacted to meet compaction requirements for the parking lot. Granular material shall be placed and compacted to a level equal to the trench depth at the time of the utility installations.
- The Contractor is responsible for keeping stormwater run-off and sediment under control during construction. All Contractors shall refer to the Erosion and Sediment Control Plan throughout construction.
- The Contractor shall maintain the site in a well-drained manner in order to assure the shortest possible drying time after each rainfall.
- All survey monuments disturbed during construction shall be replaced by a surveyor licensed in the state, in which this project is located, at the Contractor's expense.
- The Contractor shall verify and/or perform all necessary inspections and/or certifications required by codes.
- Scarify all areas disturbed by excavation for subgrade preparation to a minimum depth of 8" and recompact as specified below. Subsequent fill for subgrade shall be placed in lifts not exceeding 6" and compacted to at least 95% of maximum dry density as determined by ASTM D 698 (standard proctor). Moisture content shall range from -2 to +4 percent of its optimum moisture content. Prior to placement of the base rock, the entire area shall be proof rolled with a loaded tandem axle dump truck, having no more than 3 axles and weighing a minimum of 40,000 pounds.
- The Contractor shall grade all areas to drain in order to prevent ponding water. The minimum allowable slope on all paved surfaces shall be 1 percent.
- Contractor to contact telephone, electric, gas, and water companies to have underground utilities located on this site and adjacent to this site prior to doing any excavating.
- All dimensions and radii are to the back of curb, unless otherwise noted.
- Landscape trees and shrubs are schematically shown, and are not part of this package, exact location to be determined by the owner.
- All signs shall be contractor furnished.
- Yield "Shark Teeth" shall be performed marking tape.
- "ONLY" shall be performed marking tape.
- Right Arrow shall be performed marking tape.
- Photometric plan will be provided for construction plan review.
- All existing pavement and striping will be inspected. Deteriorated areas will be repaired and a maintenance schedule will be planned.
- Dead or previously removed landscaping will be replaced.
- A landscaping plan will be provided for construction plan review.
- This site is designated as Zone "X" - Area determined to be outside of 500-year Floodplain, as per Federal Emergency Management Agency National Flood Insurance Rate Map, Community Panel Map No. 29183C0239E, dated August 2, 1995.

MoDOT NOTES:

- All materials & procedures must conform to current MoDOT Standards.
- Applicant and/or Contractor must possess a copy of this permit and permit approved plans on the job site at all times.
- Keep roadway and shoulders clear of dirt, mud, debris, equipment and materials at all times.
- Roadway ditches, culverts and other such devices used to carry surface run-off will be kept open, free and clear at all times.
- Dress all disturbed earth areas; seed and mulch with straw and/or sod.
- Backfill behind all curbs and tapers flush to top of back of curb and/or taper.
- No slopes on MoDOT right of way to be greater than 3:1.
- EDGE TREATMENT: A wedge of material (with a 3:1 or flatter slope) must be placed along the pavement edge during non-working hours when there is over a 2-inch drop off.
- UTILITY LOCATES - CONTACT MO ONE-CALL 1-800-344-7483 FOR LOCATION OF UNDERGROUND FACILITIES.
- ALL LANE CLOSURES MUST BE APPROVED BY MoDOT. A lane closure request form will need to be submitted to MoDOT via fax (573-522-6491) or email (ST_PermitWorkzones@modot.mo.gov) 2 business days prior to any lane closures.
- NO SIGNS or display material of an advertising nature is to be placed on or extending over onto the MoDOT right of way.
- The MoDOT right of way is to be used for ingress and egress ONLY and the adjacent property should be so developed as to not force the use of this right of way for parking or to facilitate any other activities.
- All MoDOT property of facilities (including roadway and shoulder pavement) disturbed or damaged during the scope of work must be restored. Any repairs or replacement must meet or exceed the original existing condition as directed by MoDOT.

SPOT GRADE LEGEND

TOP OF CURB	000.0000
PAVEMENT ELEVATION	000.000
INTERIOR PAVEMENT/ GROUND ELEVATIONS	000.00
GUTTER ELEVATION	000.000
FACE OF CURB	000.000

Three working days prior to the start of any excavation on this site the Contractor shall contact 1-800-344-7483 for utility location information.

The contractor shall verify and implement all the required Federal Occupational Safety and Health Administration (OSHA) and/or OSHA approved state-plan regulations established for the type of construction required by these plans.

REVISIONS

No.	By:	App:
1		
2		
3		
4		

PAVEMENT LEGEND

ASPHALT PAVEMENT	
CONCRETE PAVEMENT	

LEGEND

DESCRIPTION	PROPOSED	EXISTING
AERIAL ELECTRIC	—AE—	—AE—
UNDERGROUND ELECTRIC	—UE—	—UE—
UNDERGROUND TELEPHONE	—UT—	—UT—
GAS LINE	—G—	—G—
WATER LINE	—W—	—W—
SANITARY SEWER	—SS—	—SS—
STORM SEWER	=====	=====
EASEMENT	=====	=====
PROPERTY LINE	=====	=====
CONTOURS	(100)	100
UTILITY POLE	•	•
SANITARY MANHOLE	•	•
WATER VALVE	•	•
FIRE HYDRANT	•	•
CATCH BASIN	■	■
JUNCTION BOX	•	•
FLARED END SECTION	D	D
CLEANOUT	•	•
GRATED INLET	■	■

SOIL PREPARATION AND COMPACTION

Existing foundations, slabs, pavements and below grade structures will be removed from the building and pavement areas. Remove surface vegetation, topsoil, root systems, organic material containing more than 4% organics, existing fill and soft or otherwise unsuitable material from the site. Proof roll exposed subgrade with heavy rubber-tired construction equipment. Remove and replace unsuitable areas with suitable material as indicated by the owner's representative. In cut areas the exposed subgrade shall be scarified to a depth of (8) inches, adjusted in moisture content and recompact to the required density. Fill material shall be placed in loose lifts not to exceed (6) inches in thickness. The lifts shall be free of organic and other deleterious material and shall contain no chemicals that may result in the material being classified as "contaminated". The top 12 inches of compacted fill should have a maximum 3 inch particle diameter and all underlying compacted fill a maximum 8 inch particle diameter. All fill material will be approved by the owner's representative. Soils that become unstable due to moisture or disturbance are to be dried and recompact or undercut to a suitable bearing subgrade and replaced with a structural fill, or mechanically stabilized with a course crushed aggregate and compacted as outlined above into the subgrade. All material used to support the site will be approved by the owner's representative.

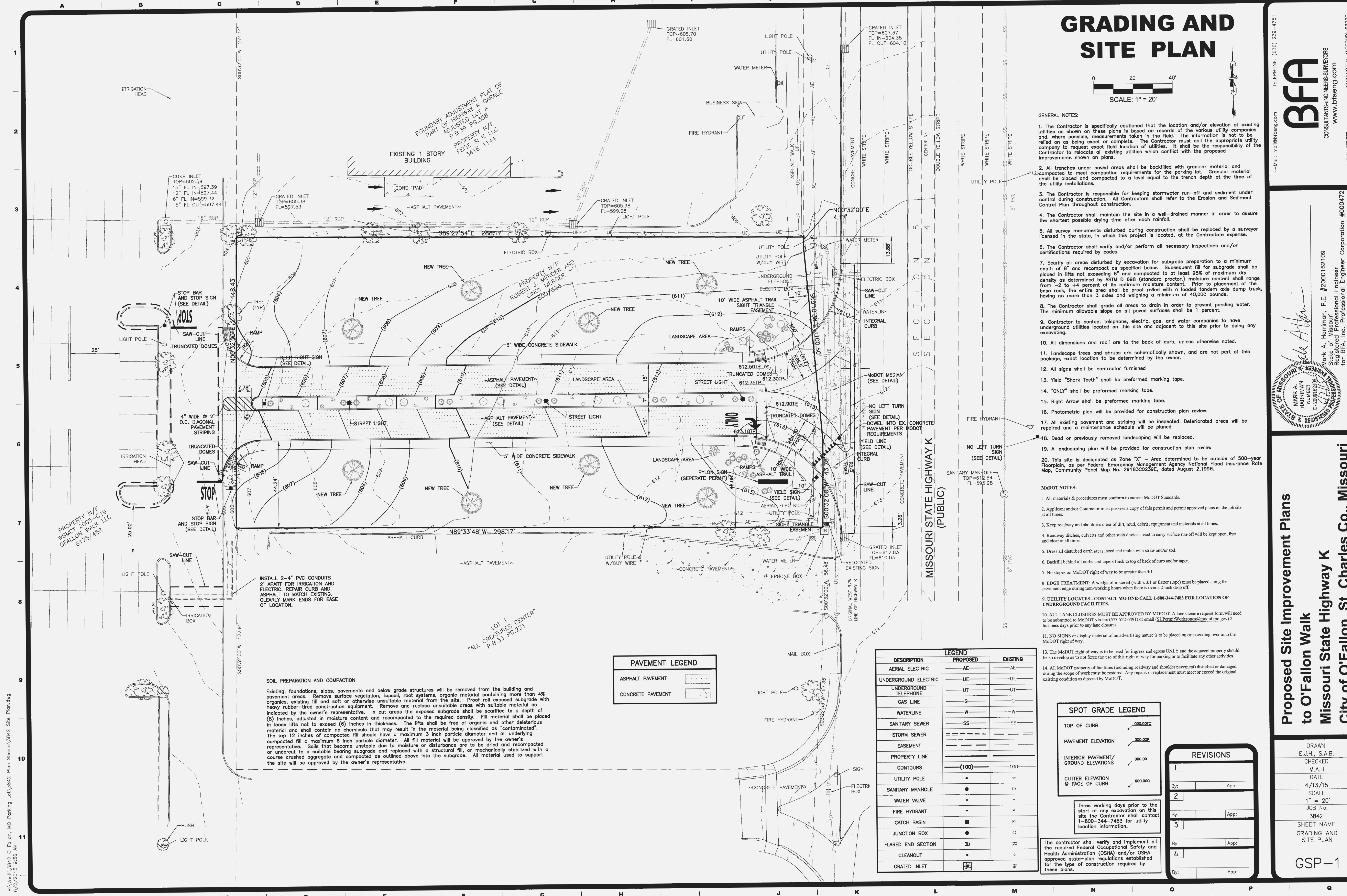

BFA
CONSULTANTS-ENGINEERS-SURVEYORS
www.bfaeng.com
WASHINGTON, MISSOURI 63090

Mark A. Harriman, P.E. #2000162109
Registered Professional Engineer
for BFA, Inc., Professional Engineer Corporation #000472

103 ELM STREET

**Proposed Site Improvement Plans
to O'Fallon Walk
Missouri State Highway K
City of O'Fallon, St. Charles Co., Missouri**

DRAWN
E.J.H., S.A.B.
CHECKED
M.A.H.
DATE
4/13/15
SCALE
1" = 20"
JOB No.
3842
SHEET NAME
GRADING AND
SITE PLAN
GSP-1