

**Luminaire Schedule**

Symbol	Qty	Label	Arrangement	LMF	Lum. Lumens	Lum. Watts	Part Number
	2	A4-2	D180°	1.000	16959	130	OSQ-A-NM-4ME-K-40K-_-_- w/OSQ-B-AA_-_-
	1	A4-1B	SINGLE	1.000	13032	130	OSQ-A-NM-4ME-K-40K-_-_- w/OSQ-B-AA_-_- OSQ-BLSMF
	1	A4-2BR	TWIN	1.000	13032	130	OSQ-A-NM-4ME-K-40K-_-_- w/OSQ-B-AA_-_- OSQ-BLSMF
	3	B4	SINGLE	1.000	2490	19	XSPW-B-WM-4ME-2L-40K-_-_-

**Calculation Summary (Footcandles calculated using predicted lumen values @ 50K hrs of operation)**

Label	Units	Avg	Max	Min	Avg/Min	Max/Min
CalcPts	Fc	2.38	8.0	0.1	23.80	80.00
Property Line	Fc	0.17	0.5	0.0	N.A.	N.A.

**Pole Schedule**

(4) PS4S20CT\_\_ (20' X 4" X .125" STEEL SQUARE POLE)  
Proposed poles meet 130 MPH sustained winds.

**Additional Equipment:**

- (7) OSQ-B-AA\_\_ (Adjustable Arm Mount)
- (3) OSQ-BLSMF (Backlight Shield)
- (1) PB-1A4\_\_ (Single Head Tenon)
- (3) PB-2A4\_\_ (Twin Head Tenon)

\*\*\* CUSTOMER TO VERIFY ORDERING INFORMATION AND CATALOGUE NUMBER PRIOR TO PLACING ORDER \*\*\*

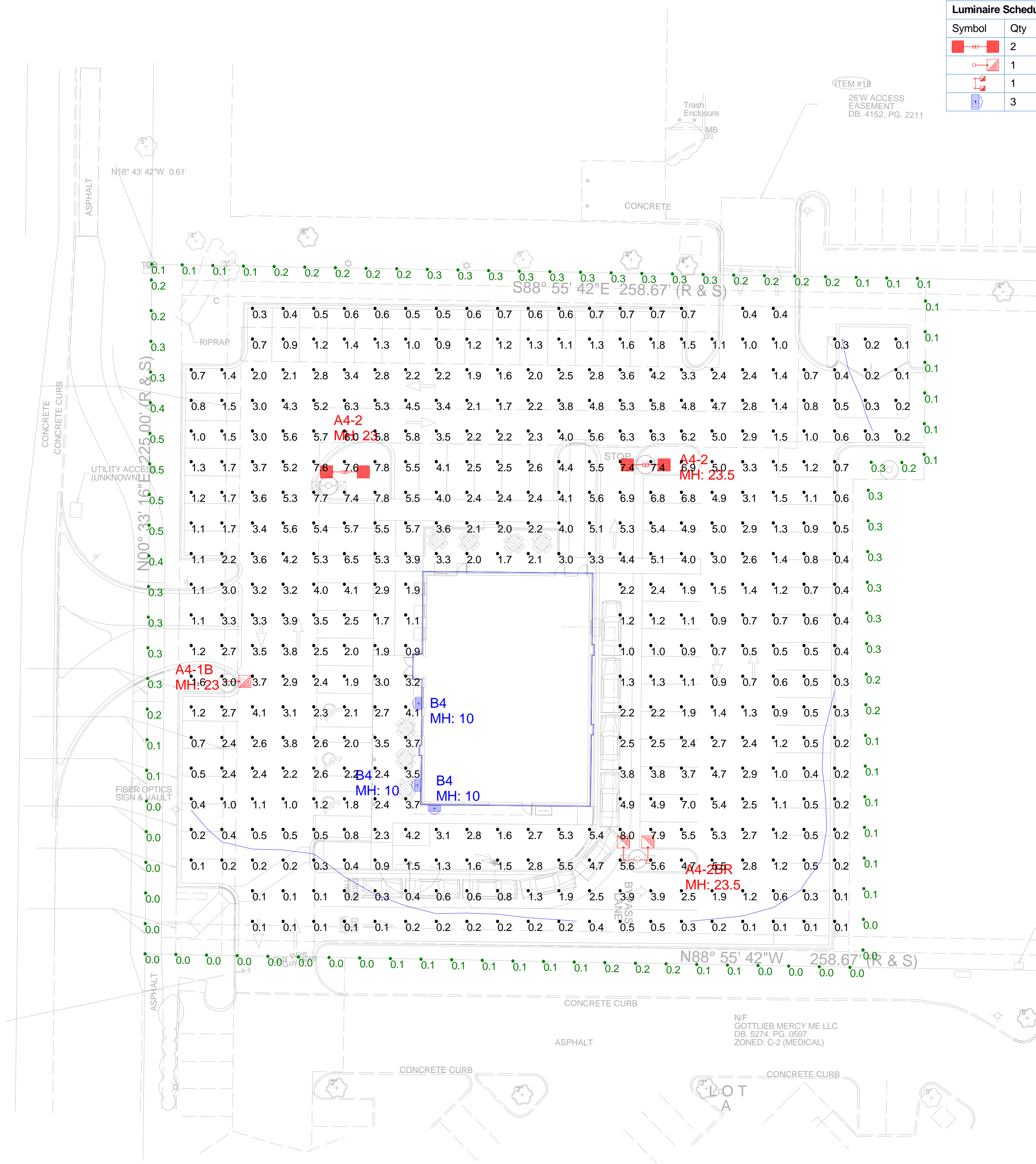

A COMPANY OF IDEAL INDUSTRIES, INC.  
9201 Washington Ave, Racine, WI 53406 https://creelighting.com - (800) 236-6800

Illumination results shown on this lighting design are based on project parameters provided to Cree Lighting used in conjunction with luminaire test procedures conducted under laboratory conditions. Actual project conditions differing from these design parameters may affect field results. The customer is responsible for verifying dimensional accuracy along with compliance with any applicable electrical, lighting, or energy code.

**Project Name: Oberweiss Restaurant - 1816 Highway K, O'Fallon, MO 63366**

SR-35694

Footcandles calculated at grade

Filename: 190221OFMO1CISR1.AGI

Layout By:  
Chris Schlitz

Date: 6/4/2019

Scale 1" = 20'

