

FINAL SURVEY PLOTTED BY: DATE: NO. OF SHEETS: AREA COVERED: SURVEYED: CHECKED: DATE: PLOTTED: DATE: NOTE BOOK NO. AREA COVERED:

ORIGINAL SURVEY PLOTTED BY: DATE: NO. OF SHEETS: AREA COVERED: SURVEYED: CHECKED: DATE: PLOTTED: DATE: NOTE BOOK NO. AREA COVERED:

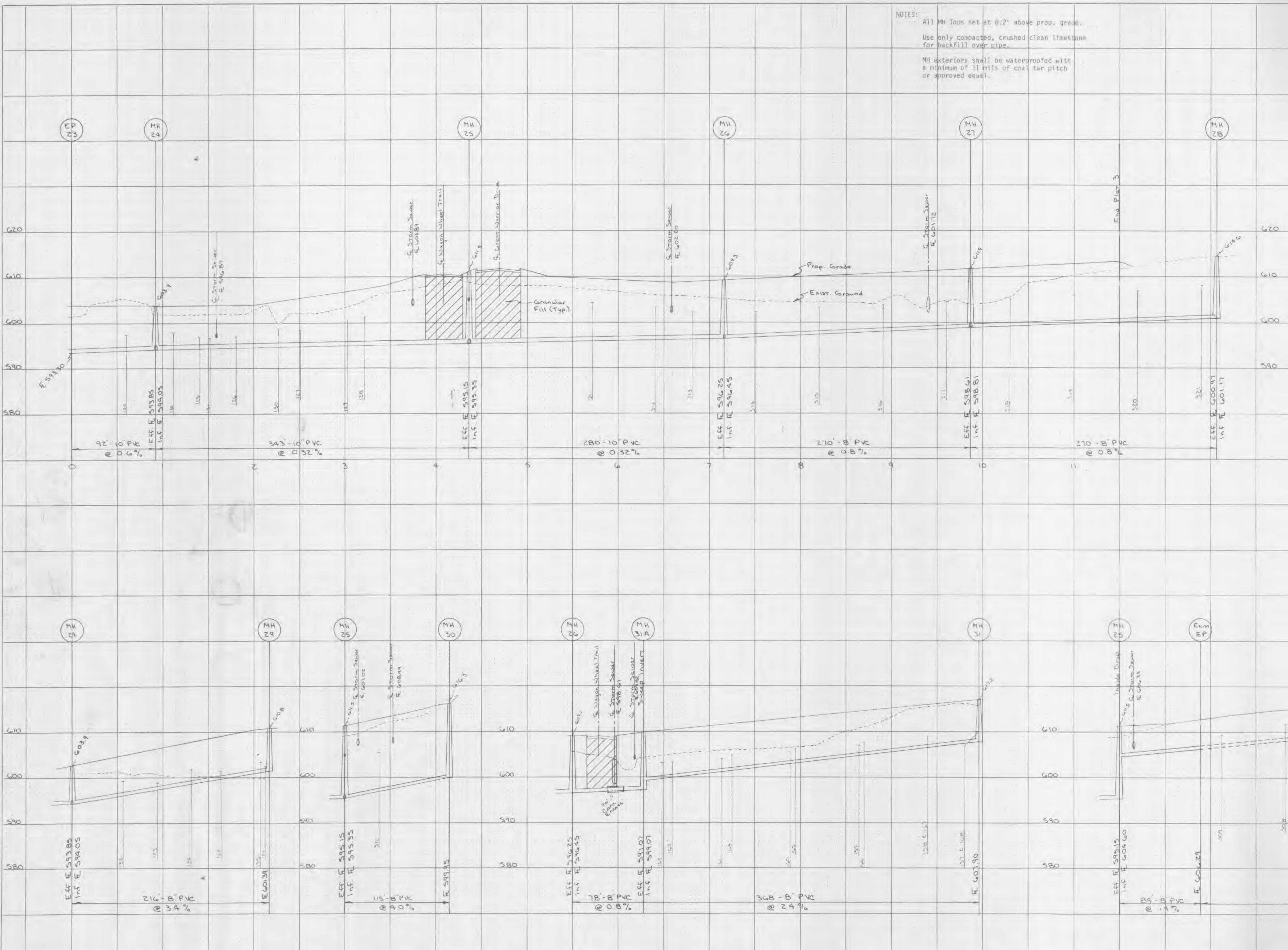

NOTES:  
 All MH Tops set at 0.2' above prop. grade.  
 Use only compacted, crushed clean limestone for backfill over pipe.  
 MH exteriors shall be waterproofed with a minimum of 31 lbs of coal tar pitch or approved equal.

Osage Meadows Plat 3  
 Sanitary Profiles  
 82-120 December 1984  
 Scale: Horiz 1" = 50', Vert 1" = 10'