

SIGHT DISTANCE TO THE RIGHT  
● PHOENIX DRIVE AND PHOENIX PARKWAY

SIGHT DISTANCE TO THE LEFT  
● PHOENIX WAY AND RED HAWK PLACE

SIGHT DISTANCE TO THE RIGHT  
● PHOENIX DRIVE AND RED HAWK PLACE

SIGHT DISTANCE TO THE LEFT  
● PHOENIX DRIVE AND PHOENIX PARKWAY

N/F  
VILLAGE COMMONS, LLC  
DB 4302, PG 1570  
PARCEL ID#4-0698-8837-00

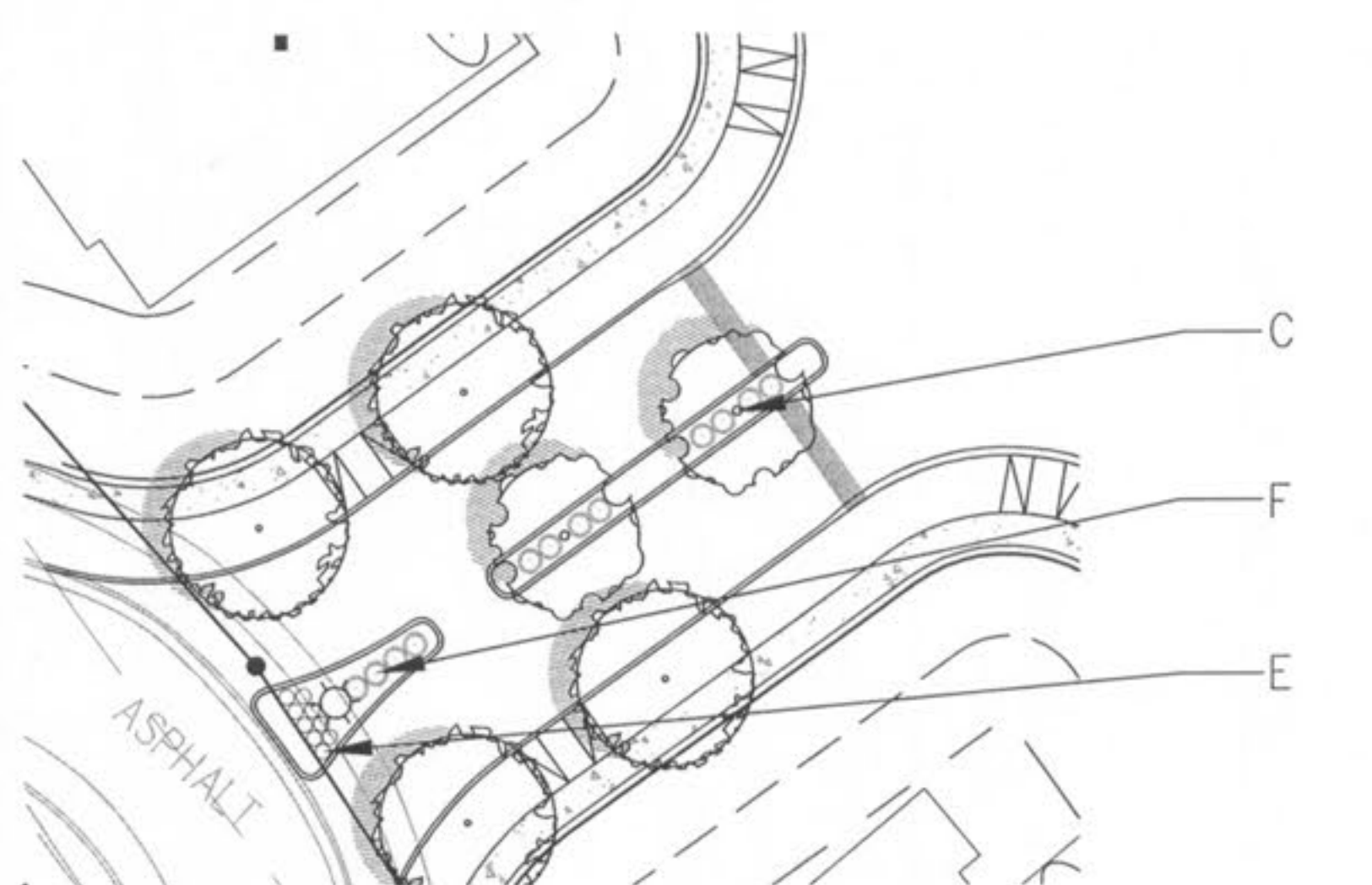

**A1 Entry Median Detail**  
SCALE 1" = 20'



CODE	QTY	GENUS	SPECIES	COMMON NAME	SIZE	COND.	COMMENT
A	43	QUERCUS	RUBRA	RED OAK	2" MIN.	B&B	
B	6	FRAXINUS	PENNSYLVANICA	GREEN ASH	2" MIN.	B&B	
C	10	CERCIS	CANADENSIS	EASTERN REDBUD	4" MIN.	B&B	
D	17	PICEA	OMORIKA	SERBIAN SPRUCE	4" MIN.	B&B	
E	9	CORNUS	SERICEA	REDSIER DOGWOOD	18" - 24"	B&B	
F	12	BUXUS	MICROPHYLLA	LITTLELEAF BOXWOOD	24" - 36"	B&B	

PLANNING AND DEVELOPMENT DEPARTMENT FILE #9831.57 (AREA PLAN-APPROVED MAY 24TH, ORDINANCE #5178) - 9831.57.01 (FINAL PLAN)

DESIGNED BY: RTH  
DRAWN BY: RTH  
CHECKED BY: JDR  
DATE: 11/6/07

Job Number: 07-075  
Sheet Number: C12.0

REVISIONS

DATE	BY	DESCRIPTION
07/17/2008	...	...
07/17/2008	...	...
07/17/2008	...	...
07/17/2008	...	...

DEVELOPER/OWNER: THE VILLAGE AT PARK PLACE, LLC, 1001 BOARDWALK SPRINGS PL, OFALLON, MO 63366, PHONE: (636) 561-9323

STATE OF MISSOURI LANDSCAPE ARCHITECTURE SEAL: [Seal]

LANDSCAPE ARCHITECT: Gole and Associates Incorporated, 10777 sunset office drive, suite 100, missouri city, mo 63127, p: 314.984.9887 f: 314.984.0587