

1 TYPICAL PIPE PENETRATION
A2.2 SCALE: 1 1/2"=1'-0"

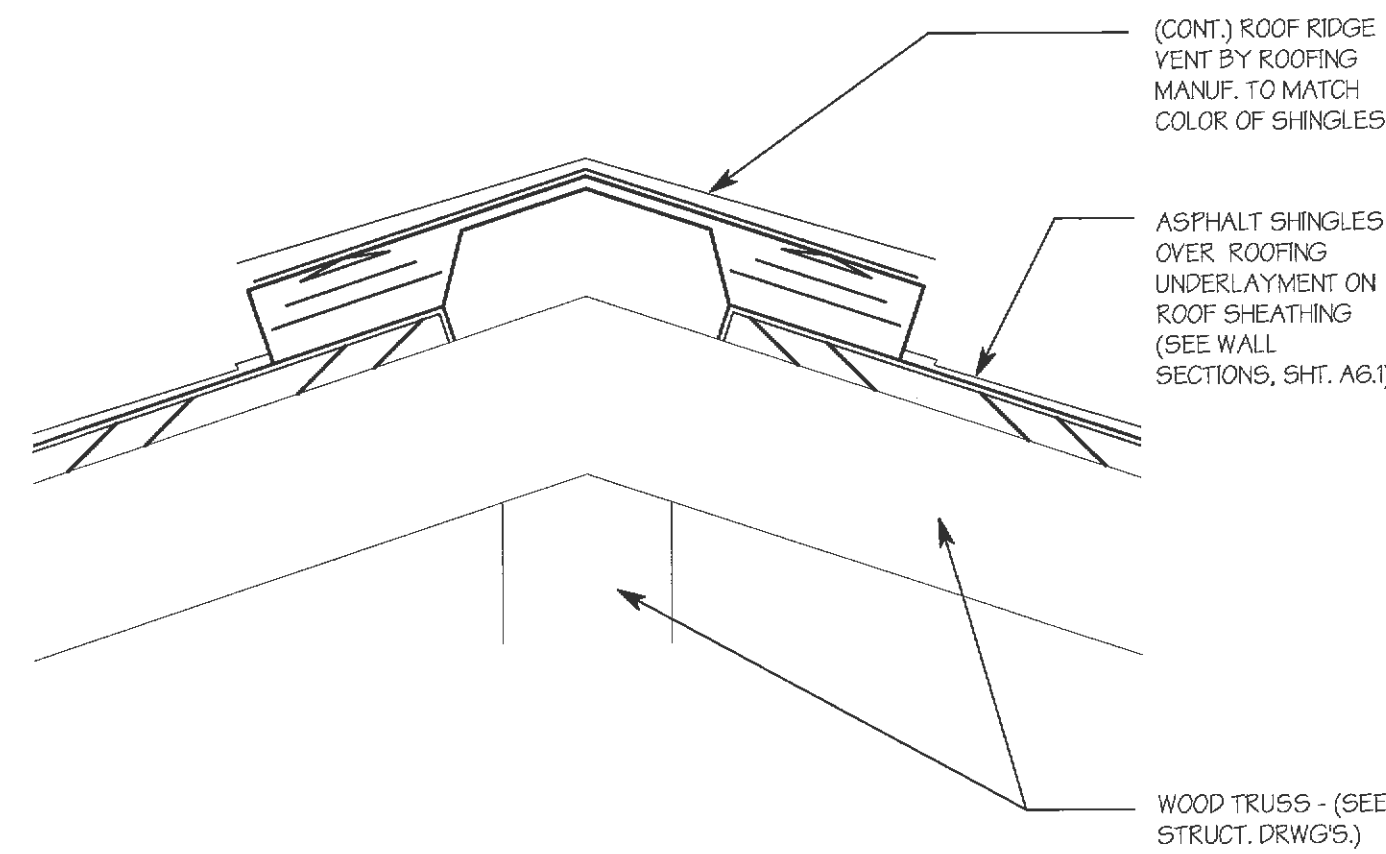

3 ROOF RIDGE VENT
A2.2 SCALE: 1 1/2"=1'-0"

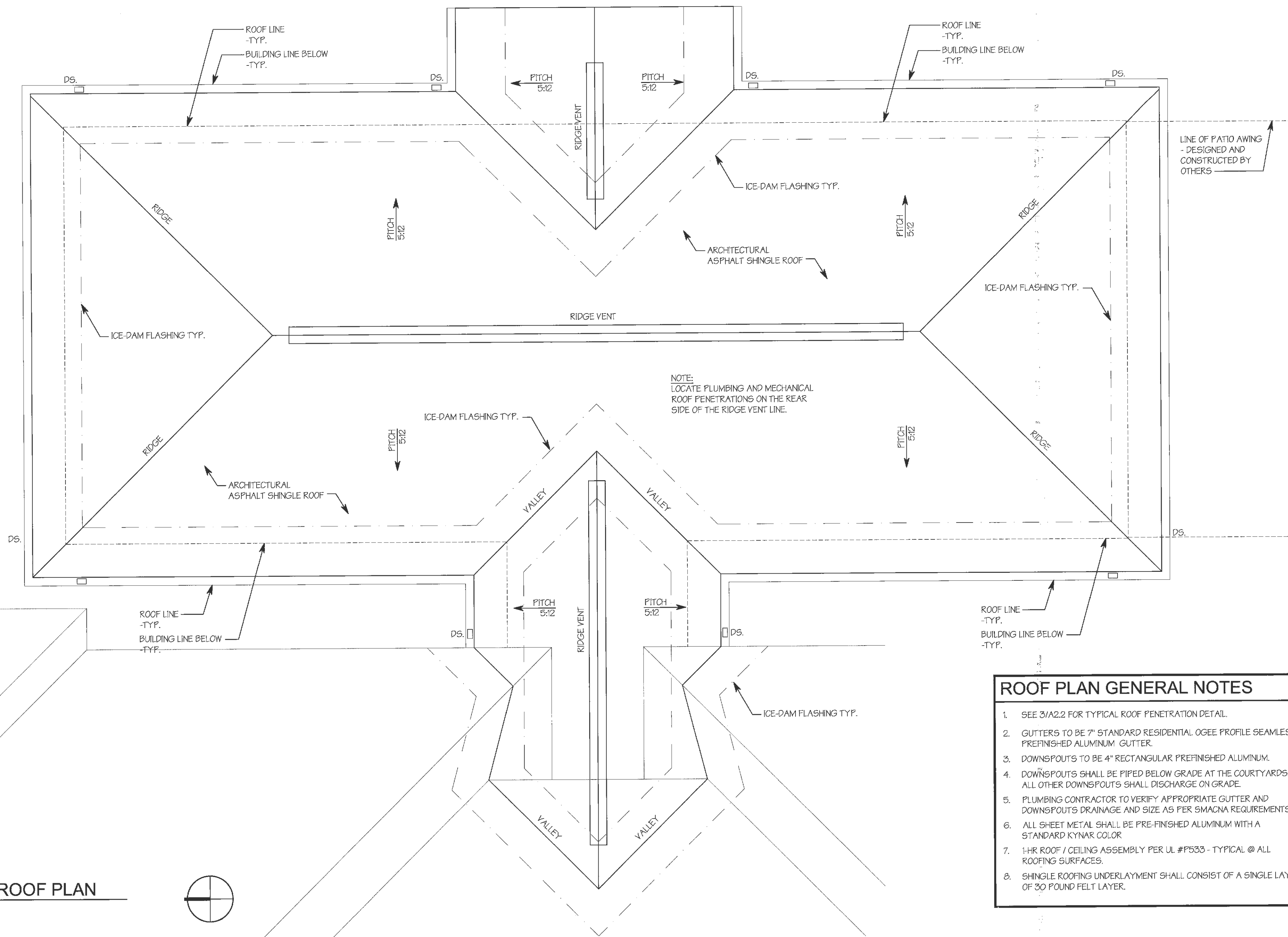

2 OVERALL ROOF PLAN
A2.2 SCALE: 1/4" = 1'-0"

- ROOF PLAN GENERAL NOTES**
- SEE 3/A2.2 FOR TYPICAL ROOF PENETRATION DETAIL.
 - GUTTERS TO BE 7" STANDARD RESIDENTIAL OGEE PROFILE SEAMLESS PREFINISHED ALUMINUM GUTTER.
 - DOWNSPOUTS TO BE 4" RECTANGULAR PREFINISHED ALUMINUM.
 - DOWNSPOUTS SHALL BE PIPED BELOW GRADE AT THE COURTYARDS. ALL OTHER DOWNSPOUTS SHALL DISCHARGE ON GRADE.
 - PLUMBING CONTRACTOR TO VERIFY APPROPRIATE GUTTER AND DOWNSPOUTS DRAINAGE AND SIZE AS PER SMACNA REQUIREMENTS.
 - ALL SHEET METAL SHALL BE PRE-FINISHED ALUMINUM WITH A STANDARD KYNAR COLOR.
 - 1-HR ROOF / CEILING ASSEMBLY PER UL #P533 - TYPICAL @ ALL ROOFING SURFACES.
 - SHINGLE ROOFING UNDERLAYMENT SHALL CONSIST OF A SINGLE LAYER OF 30 POUND FELT LAYER.

ELECTRICAL: TBD
FIRE PROTECTION: TBD
CONSULTING ENGINEERS
MECHANICAL: TBD
PLUMBING: TBD
STRUCTURAL: TBD
1830 DES PERES RD, SUITE 100
ST. LOUIS, MO 63131
TEL: 314.855.0264
FAX: 314.855.0264

CONTRACTOR
ARCO
CONSTRUCTION
THE DESIGN/BUILD PEOPLE
1830 DES PERES RD, SUITE 100
ST. LOUIS, MISSOURI 63131
(P) 630.559.5100 (F) 630.569.9101

ARCHITECT
GWA
ARCHITECTS, P.C.
1830 DES PERES RD, SUITE 100
ST. LOUIS, MISSOURI 63131
(P) 314.422.5191 (F) 314.468.0714

A BUILDING ADDITION FOR:
Park Place
Senior Living at WindHaven

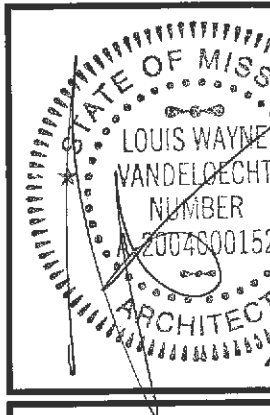

JOB NO : SJ1408
PA : RJR
PERMIT SET : 07-21-11

REVISIONS	DATE

SHEET NUMBER
A2.2
ROOF PLAN