

**PARKSIDE VILLAS  
SANITARY PROFILES**  
96-257R2 4/10/98

rev. LINE per City of Dallas

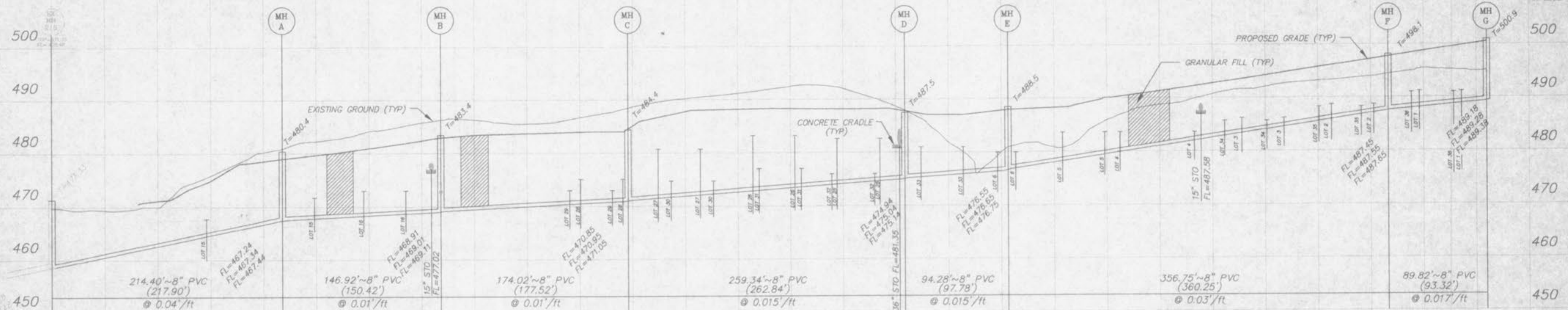

NOTE:  
SANITARY SEWER LATERALS HAVE BEEN DESIGNED FOR AN 8' (EIGHT FOOT) BASEMENT ONLY.  
IF A 9' (NINE FOOT) BASEMENT IS TO BE CONSTRUCTED THE TOP OF FOUNDATION WILL NEED TO BE RAISED 1' (ONE FOOT).

NOTE:  
IF THE STORM AND SANITARY SEWES ARE PARALLEL AND IN THE SAME TRENCH OR OVERLAP, THE UPPER PIPE SHALL BE PLACED ON A SHELF AND THE LOWER PIPE SHALL BE BEDDED IN COMPACTED GRANULAR FILL TO THE FLOW LINE OF THE UPPER PIPE.

The underground utilities shown herein were plotted from available information and do not necessarily reflect the actual existence, nonexistence, size, type, number, or location of these or other utilities. The general contractor shall be responsible for verifying the actual location of all underground utilities, shown or not shown, and said utilities shall be located in the field prior to any grading, excavation, or construction of improvements. These provisions shall in no way absolve any party from complying with the Underground Facility Safety and Damage Prevention Act, Chapter 319, RSMo.

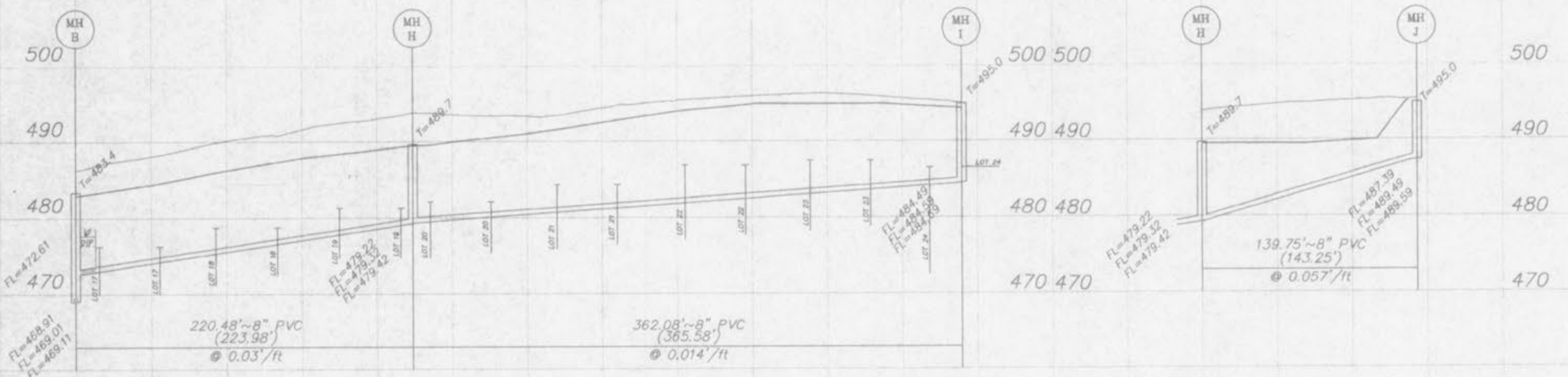

DATE: \_\_\_\_\_  
BY: \_\_\_\_\_  
SURVEY: \_\_\_\_\_  
CONTROL: \_\_\_\_\_  
NOTEBOOK: \_\_\_\_\_  
NO. \_\_\_\_\_  
APPROVED: \_\_\_\_\_  
DATE: \_\_\_\_\_

DATE: \_\_\_\_\_  
BY: \_\_\_\_\_  
SURVEY: \_\_\_\_\_  
CONTROL: \_\_\_\_\_  
NOTEBOOK: \_\_\_\_\_  
NO. \_\_\_\_\_  
APPROVED: \_\_\_\_\_  
DATE: \_\_\_\_\_