

STORM SEWER PROFILES
PARKVIEW PLACE II
 JULY, 1986
 #94-1473

REVISED BY: [Signature]
 DATE: [Date]

FINAL SURVEY DATE: _____
 SURVEYED BY: _____
 CHECKED BY: _____
 NOTE BOOK NO. _____
 TEMPLATE NO. _____
 AREAS CHECKED: _____

ORIGINAL SURVEY DATE: _____
 SURVEYED BY: _____
 CHECKED BY: _____
 NOTE BOOK NO. _____
 TEMPLATE NO. _____
 AREAS CHECKED: _____

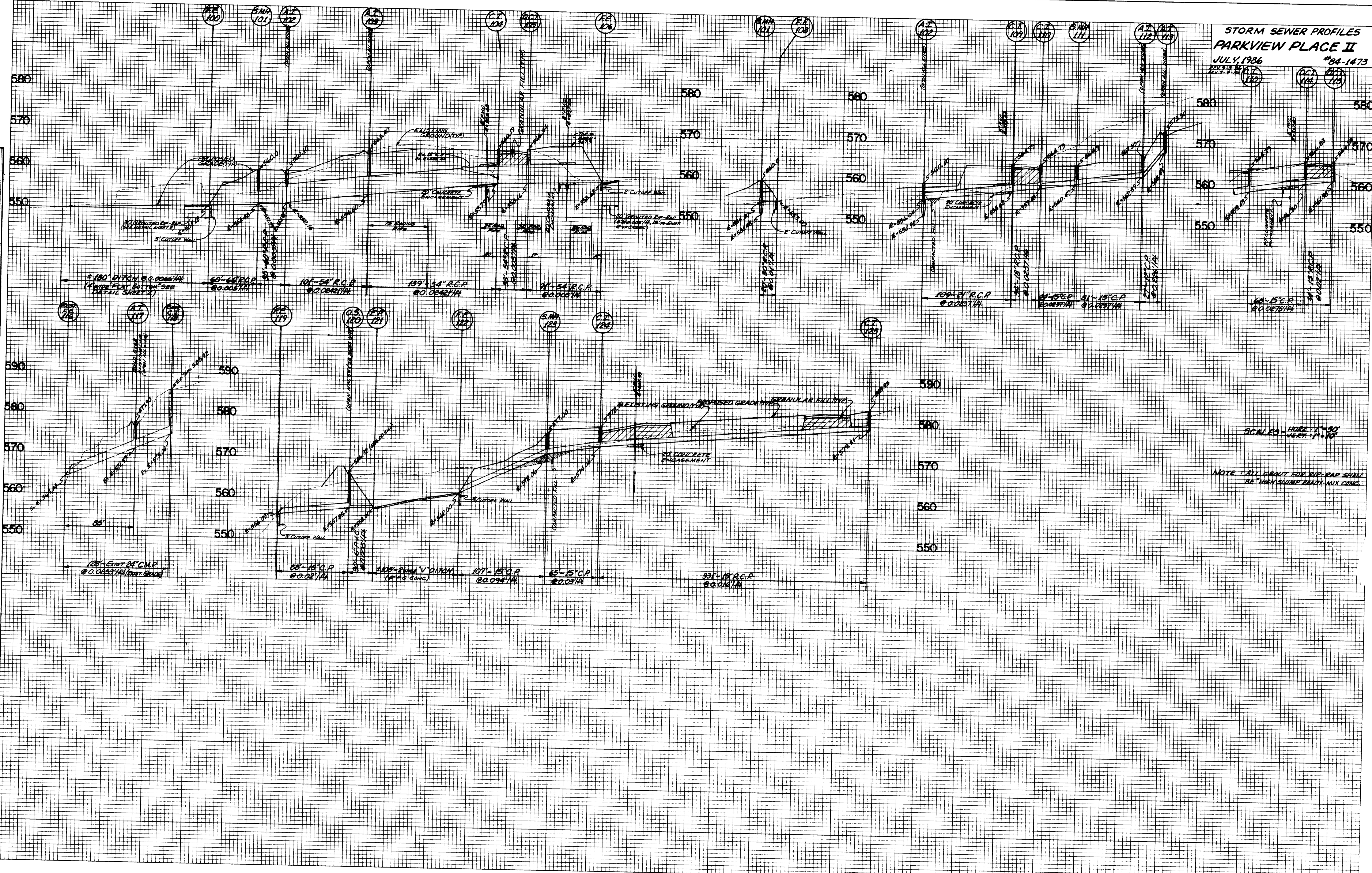

SCALES - HORIZ. 1" = 50'
 VERT. 1" = 10'

NOTE: ALL GRADY FOR RIP-RAP SHALL BE HIGH-SUMMIT READY-MIX CONC.