

# WASHINGTON'S CROSSING DRIVE

## PATRIOT'S LANDING STREET PROFILES

April, 1994 Job No. 87-155

FINAL SURVEY	DATE
PLOTTED	
NOTE BOOK	
NO.	
AREAS CHECKED	

ORIGINAL SURVEY	DATE
PLOTTED	
NOTE BOOK	
NO.	
AREAS CHECKED	

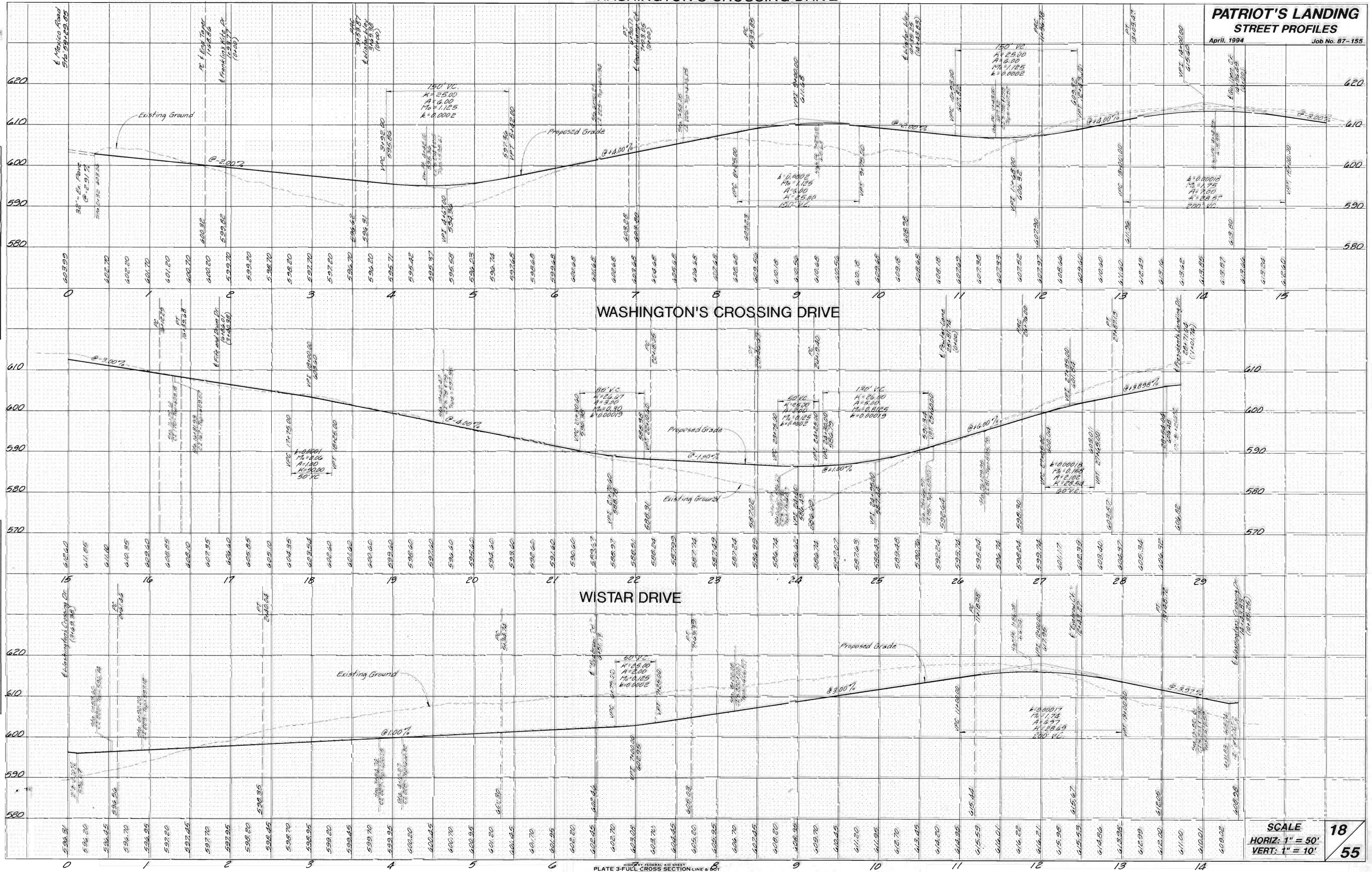

NATIONAL PRIORITARY  
PRINTED IN U.S.A.

**SCALE**  
HORIZ: 1" = 50'  
VERT: 1" = 10'

**18**  
**55**