

VERT. 1"=10'  
 HORIZ. 1"=60'  
 SCALE:

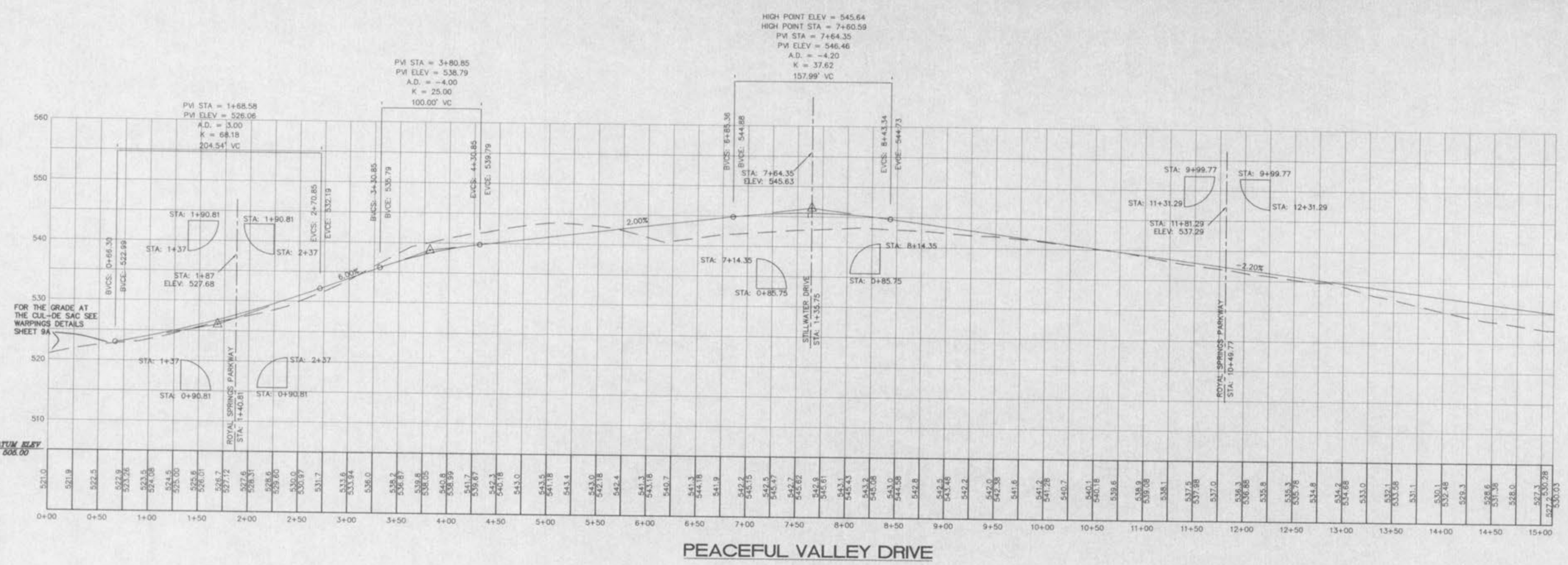

PEACEFUL VALLEY DRIVE

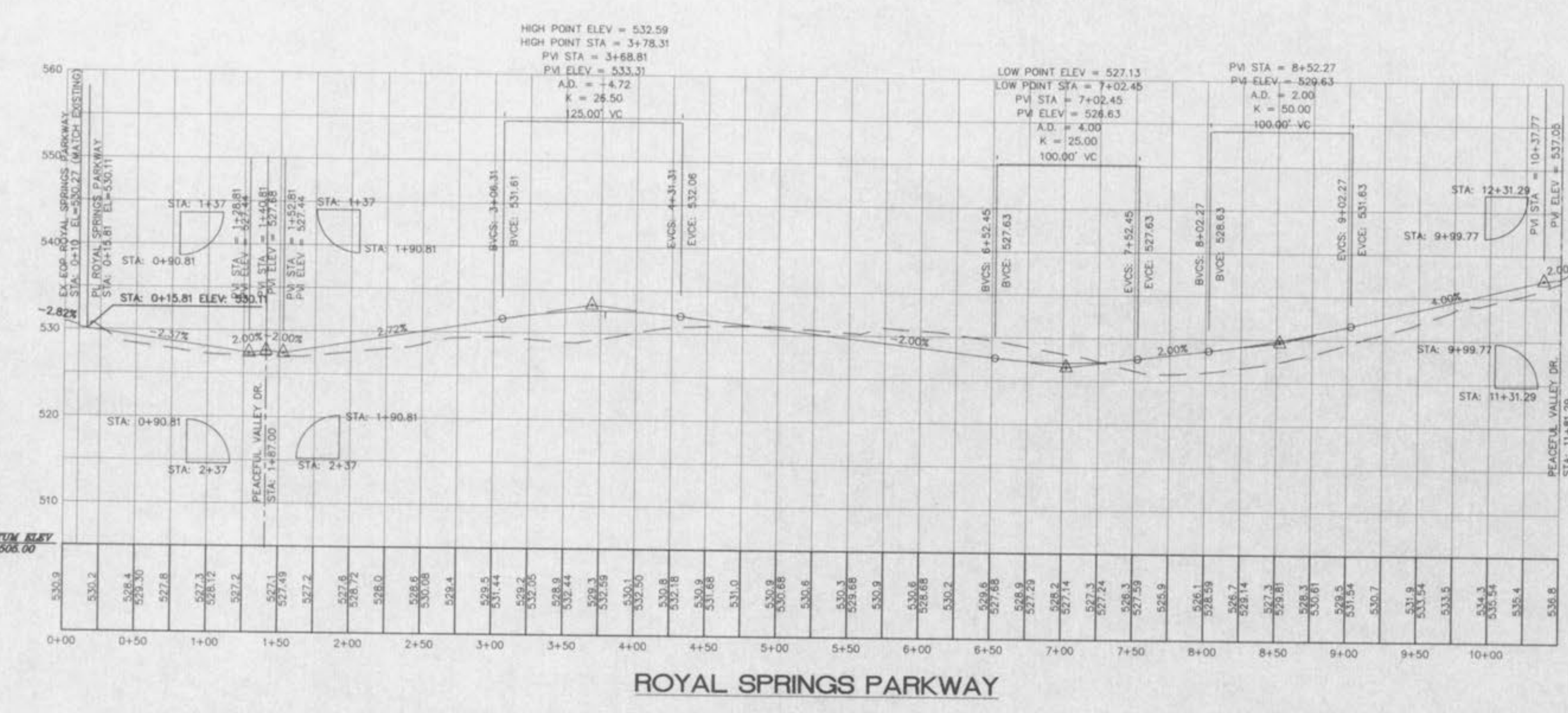

ROYAL SPRINGS PARKWAY

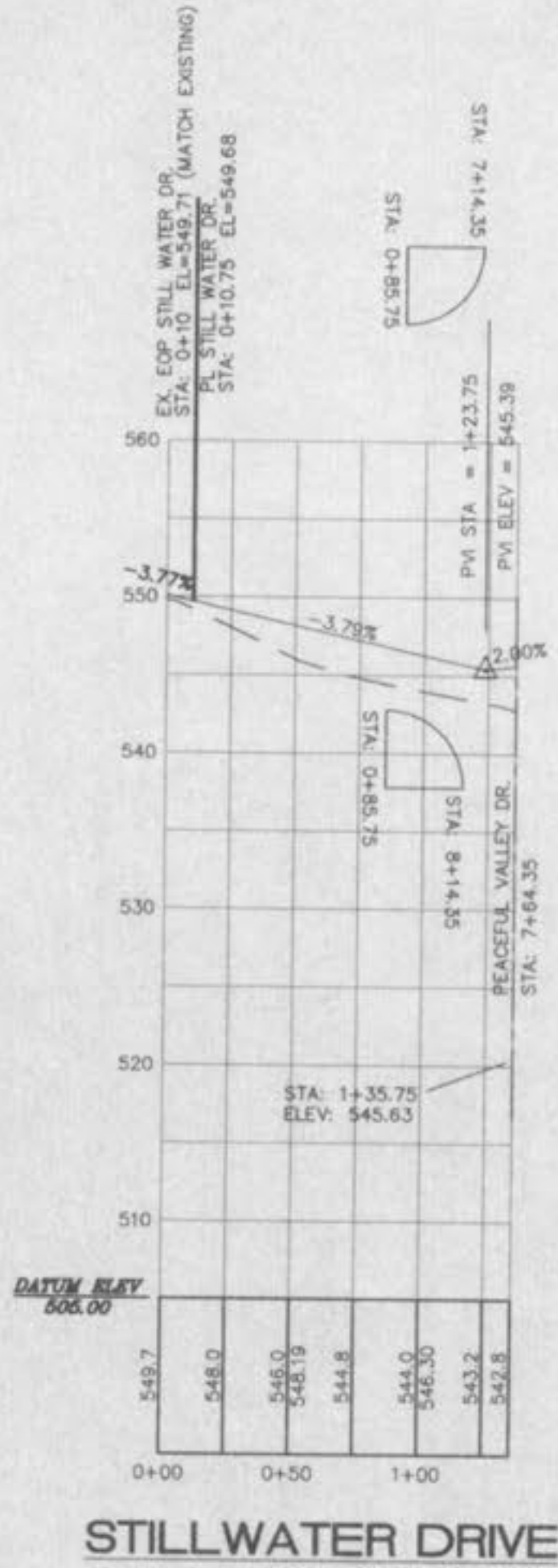

STILLWATER DRIVE

REVISION PER CITY OF DARDENNE PARKWAY AND ST. CHARLES COUNTY COMMENTS

IMPROVEMENT PLANS  
 PEACEFUL VALLEY  
 STREET PROFILES

ST. CHARLES ENGINEERING & SURVEYING, INC.  
 801 S. FIFTH STREET, SUITE 202  
 ST. CHARLES, MO 63301  
 TEL: (636) 947-0607 FAX: (636) 947-2448

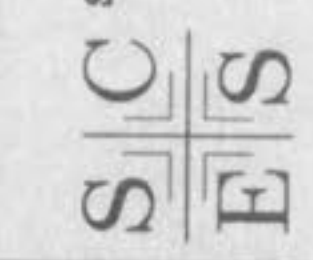

ORDER NO. 02-0890  
 DATE 07/25/08