

ISSUE	REMARKS/DATE
1	7/2/2018 INITIAL SUBMITTAL
2	8/9/2018 REVISED PER CITY COMMENTS
3	8/30/2018 REVISED PER CITY COMMENTS

PROJECT TITLE

PEARL VISTA
OF FALLON, MISSOURI

THE STERLING CO.
ENGINEERS & SURVEYORS
5055 New Baumgartner Road
St. Louis, Missouri 63129
Ph 314-487-8944
www.sterlingeng.com
Corporate Certificate of Authority #01348

Date: 8/30/2018
Michael G. Boerding
License No. MO E-28643
Professional Engineer

ELITE PEARL VISTA, LLC
5091 BAUMGARTNER ROAD
ST. LOUIS, MO 63129
Ph. 314-487-6717

ENTRANCE / WARPING DETAILS

P+Z No. 18-000083
City No.
Date: Aug. 30, 2018
Job No. 17-08-193
Page No.

10.2

IMP

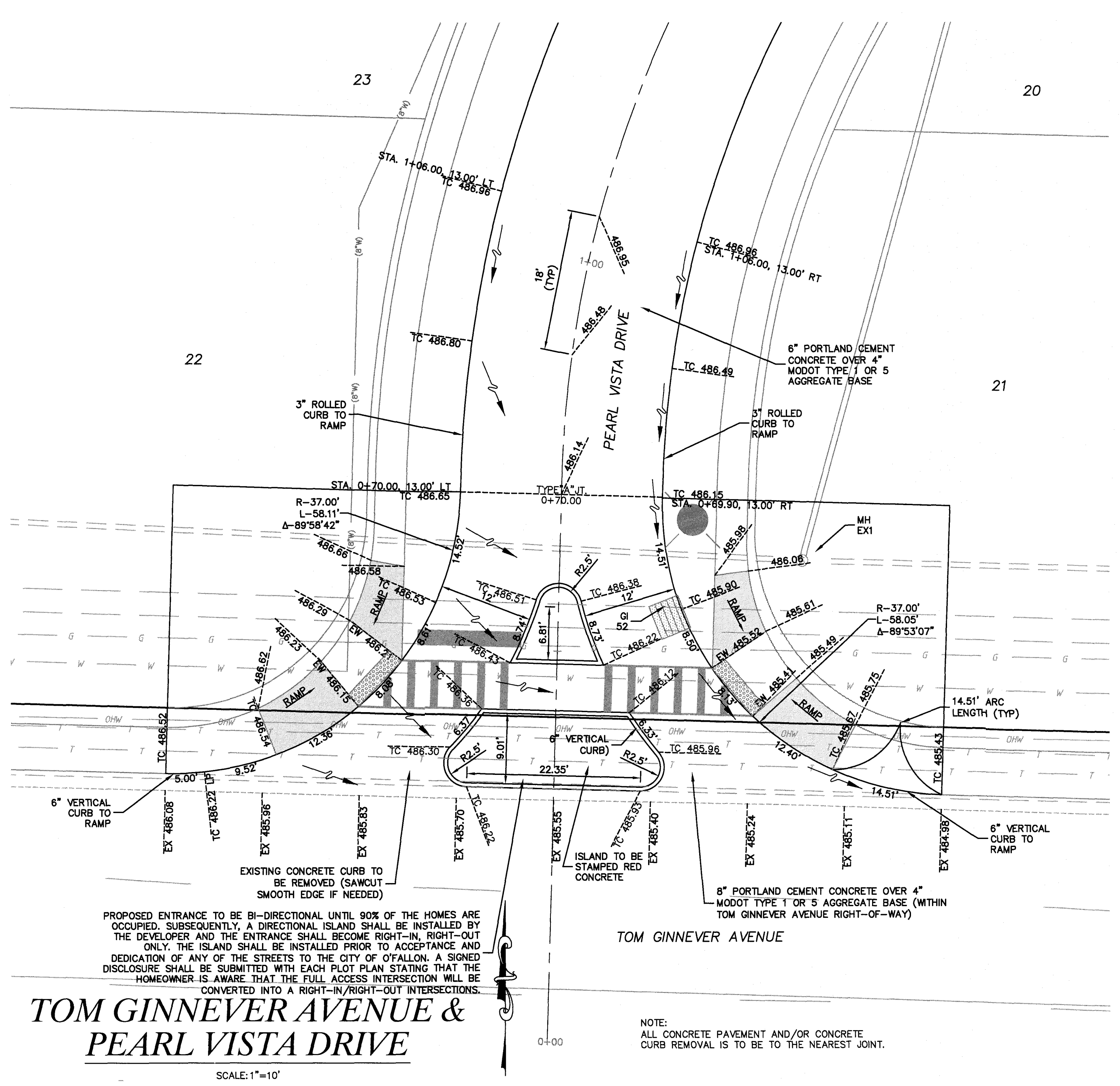

TOM GINNEVER AVENUE & PEARL VISTA DRIVE
SCALE: 1"=10'

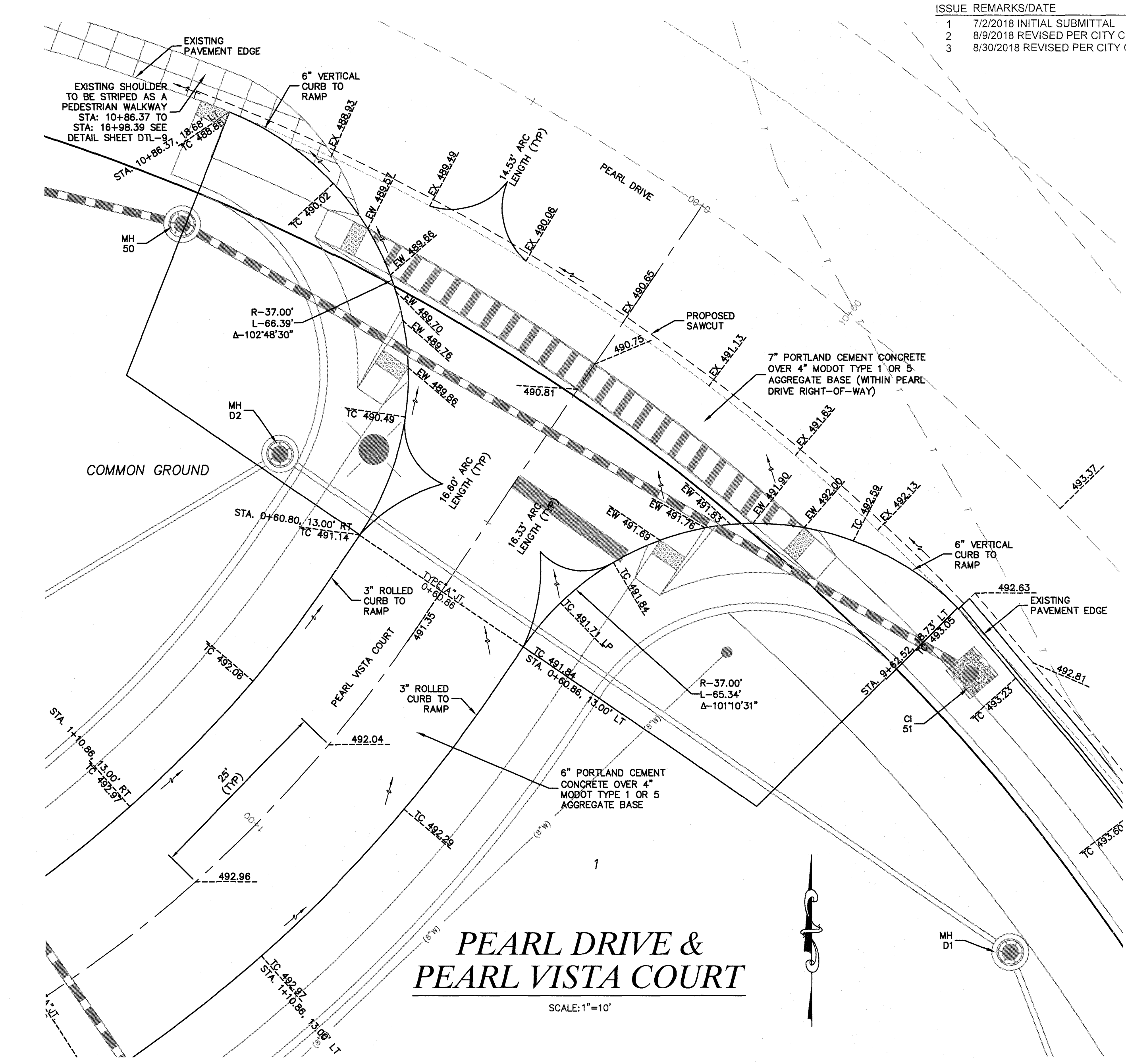

PEARL DRIVE & PEARL VISTA COURT
SCALE: 1"=10'

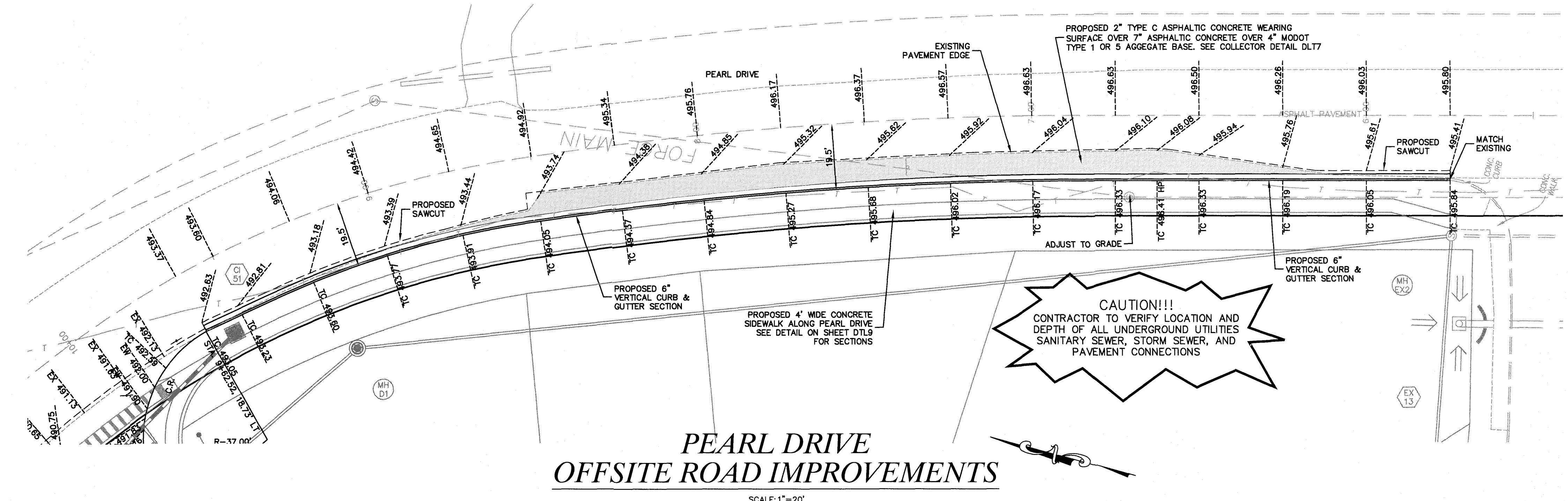

PEARL DRIVE OFFSITE ROAD IMPROVEMENTS
SCALE: 1"=20'

Drawing name: V:\1708193 Pearl Drive\Drawings\Engineering\Improvements\18193 IMP.dwg Plotted on: Aug 30, 2018 - 8:28am Plotted by: mlmiller