

GBA GEORGE BUTLER ASSOCIATES, INC. Engineers / Architects / Landscape Architects / Planners		DATE: 8/23/93
Main St. & Tom Ginner Modifications for Pedestrian Signal O'Fallon, Missouri		DESIGN BY: JLG
		DRAWN BY: BFH
		PROJECT NO.: 6721
		SHEET NO.: 12
		TOTAL SHEETS: 17
REVISIONS		BY DATE

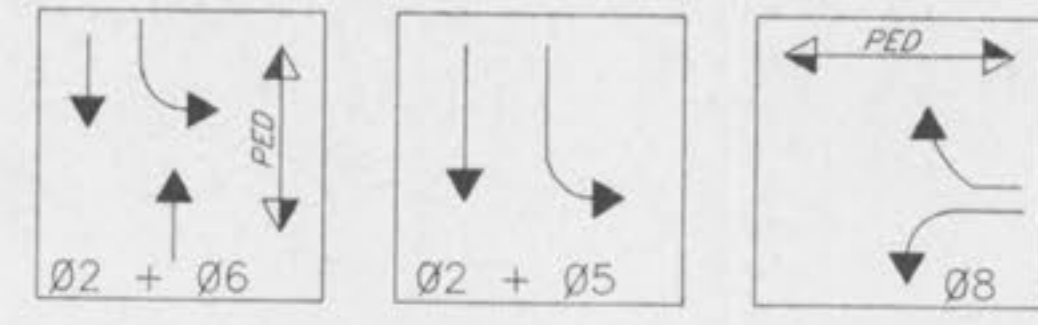
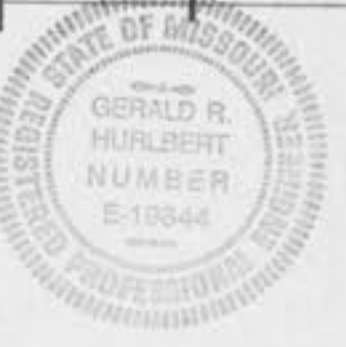

SIGNAL PHASING

NOTE:
Existing underground (U/G), overhead (O.H) utilities and drainage structures have been plotted from available information and therefore their locations must be considered approximate only. It is the responsibility of the individual contractors to notify the utility companies before actual construction.

LEGEND

- Existing Signal, Use in Place
 - New Signal
 - New Pedestrian Signal
 - Lane Use Arrow
 - Existing Pavement Markings To Be Removed
 - Future Sidewalk Location
 - Existing Sidewalk
 - Proposed Island Expansion
- SIGN #14**
TO CROSS STREET →
PUSH BUTTON
WAIT FOR WALK SIGNAL
- R10-4a
9"x12"
- Use right or left arrow as appropriate.

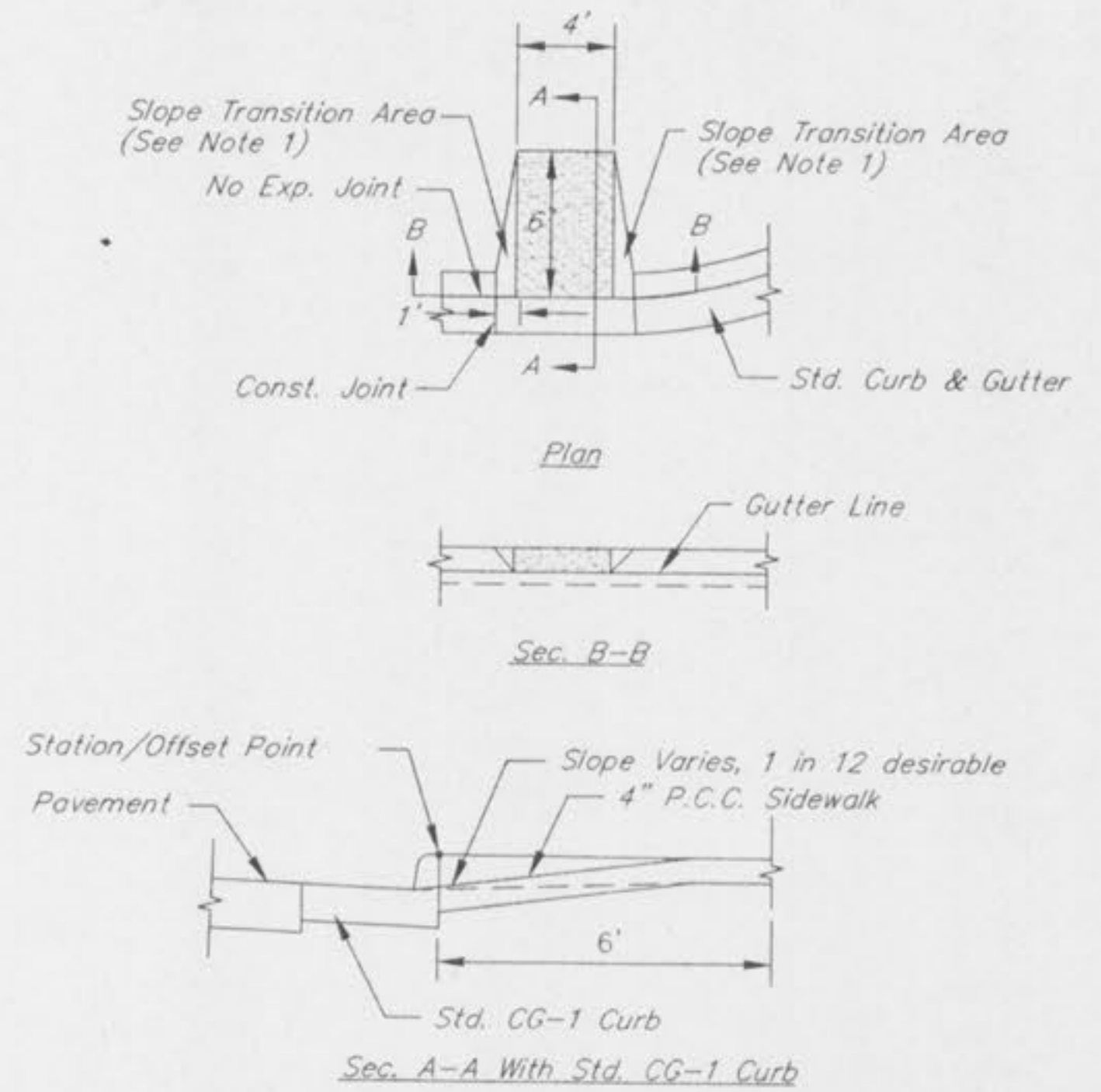
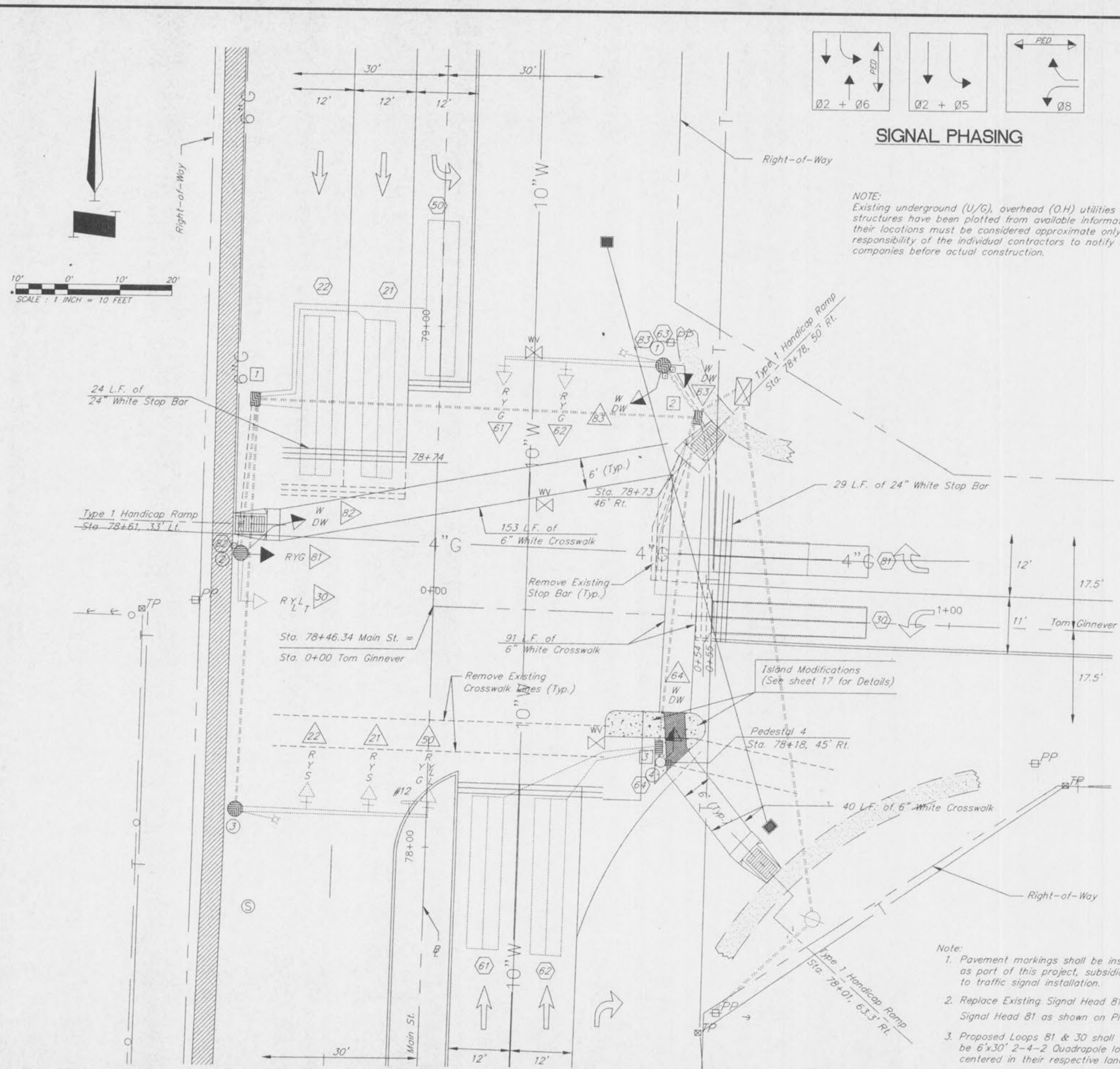
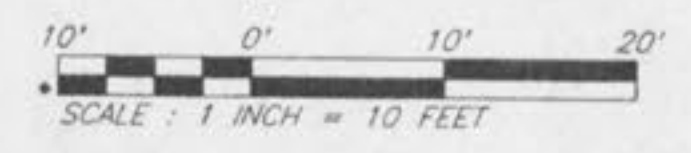

- Note:**
- Pavement markings shall be installed as part of this project, subsidiary to traffic signal installation.
 - Replace Existing Signal Head 81 with new Signal Head 81 as shown on Plan.
 - Proposed Loops 81 & 30 shall be 6'x30' 2-4-2 Quadrapole loops centered in their respective lanes.
 - Loops shall be placed as stationed on plan.

- Notes:**
- The surface of all sloped areas shall receive a distinct finish that will be perceptible to persons relying on the sense of touch.
 - Location of ramp may vary.
 - Slope transition areas in radius must be Portland Cement Concrete.

Type 1 Handicap Ramp Detail
No Scale