

**STREET DETAILS
PENNIAL PARK
PHASE 3**

AUGUST, 2002 96-8791
JULY 17, 2003 - OTALON COMMENTS

Maximum Discharge (Q) = 4.00 cfs
Maximum Velocity (V) = 4.00 ft/sec
S = 0.002 (1%)
Minimum side slopes = 3 (horizontal) : 1 (vertical)

Depth (ft)	Discharge (cfs)	Velocity (ft/sec)
1.0	1.00	1.00
2.0	2.00	2.00
3.0	3.00	3.00
4.0	4.00	4.00
5.0	5.00	5.00
6.0	6.00	6.00
7.0	7.00	7.00
8.0	8.00	8.00
9.0	9.00	9.00
10.0	10.00	10.00



GENERAL NOTES

- Do not scale drawing. Follow dimensions.
- Sections show as specified detail construction.
- For longitudinal and transverse joints, steel and tie bar requirements and dimensions refer to the "Integral Curb Pavement" Typical Section and Details.
- All necessary pavement details shall be as required by Saint Charles County.
- Sections show as typical details.
- Swales shown may not apply to all situations.
- Expansion joints shall be installed in accordance with the "Integral Curb Pavement" Typical Section and Details.
- See "Integral Curb Detail" for all driveway and pavement expansion joint requirements.

**SAINT CHARLES COUNTY
HIGHWAY DEPARTMENT
ST. CHARLES, MISSOURI**

CONCRETE SIDEWALK

DATE: October, 2002 DRAWING: C508.14



GENERAL NOTES

- Do not scale drawing. Follow dimensions.
- Sections show as specified detail construction.
- For longitudinal and transverse joints, steel and tie bar requirements and dimensions refer to the "Integral Curb Pavement" Typical Section and Details.
- All necessary pavement details shall be as required by Saint Charles County.
- Sections show as typical details.
- Swales shown may not apply to all situations.
- Expansion joints shall be installed in accordance with the "Integral Curb Pavement" Typical Section and Details.
- See "Integral Curb Detail" for all driveway and pavement expansion joint requirements.

**SAINT CHARLES COUNTY
HIGHWAY DEPARTMENT
ST. CHARLES, MISSOURI**

**STANDARD TYPICAL SECTION
RESIDENTIAL
50' R/W 26' PAVT.**

DATE: July, 2002 DRAWING: C508.08

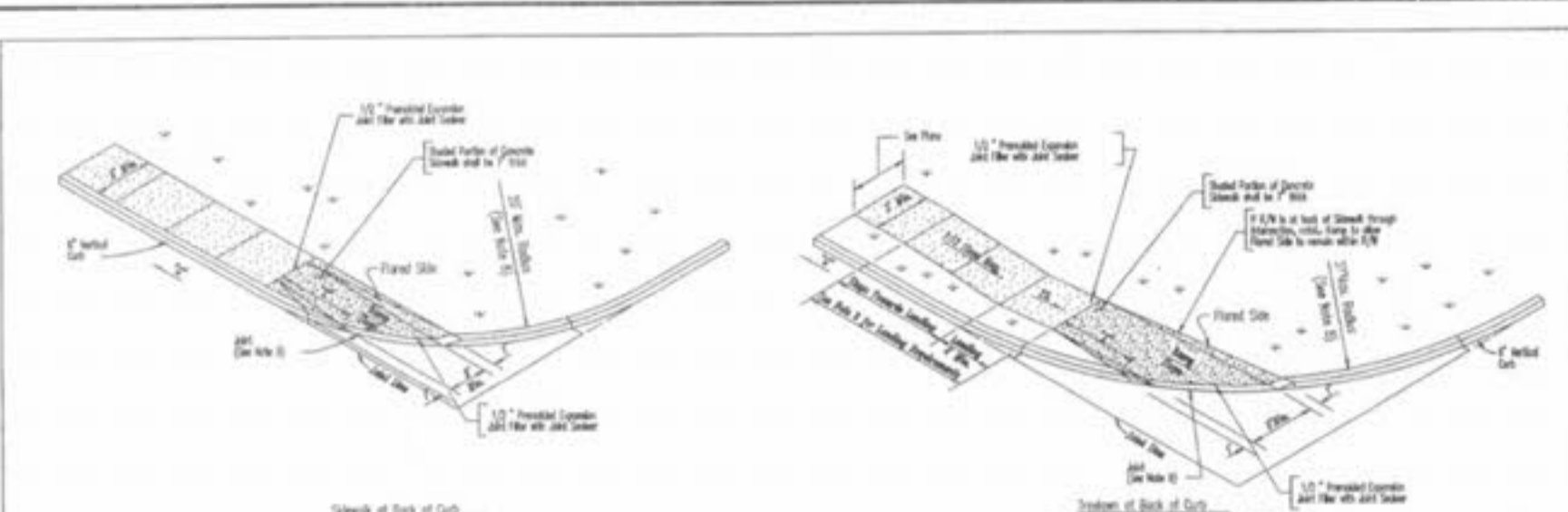

GENERAL NOTES

- Do not scale drawing. Follow dimensions.
- Sections show as specified detail construction.
- For longitudinal and transverse joints, steel and tie bar requirements and dimensions refer to the "Integral Curb Pavement" Typical Section and Details.
- All necessary pavement details shall be as required by Saint Charles County.
- Sections show as typical details.
- Swales shown may not apply to all situations.
- Expansion joints shall be installed in accordance with the "Integral Curb Pavement" Typical Section and Details.
- See "Integral Curb Detail" for all driveway and pavement expansion joint requirements.

TYPE 1 AND TYPE 2 CURB RAMP

NEGATIVE (-) VALUES	MINIMUM LENGTH OF FLARED SIDE WALK (ft)
0 to +1	5
+1.01 to +2	7
+2.01 to +3	9
+3.01 to +4	11
+4.01 to +5	13
+5.01 to +6	15
GREATER THAN +6	15

TYPE 3 CURB RAMP

NEGATIVE (-) VALUES	MINIMUM LENGTH OF FLARED SIDE WALK (ft)
0 to +2	5
+2.01 to +3	7
+3.01 to +4	9
+4.01 to +5	11
+5.01 to +6	13
GREATER THAN +6	15

**SAINT CHARLES COUNTY
HIGHWAY DEPARTMENT
ST. CHARLES, MISSOURI**

**PAYMENT CONSTRUCTION DETAILS
CONCRETE SIDEWALK
AND CURB RAMP**

DATE: Aug, 2002 DRAWING: C508.10

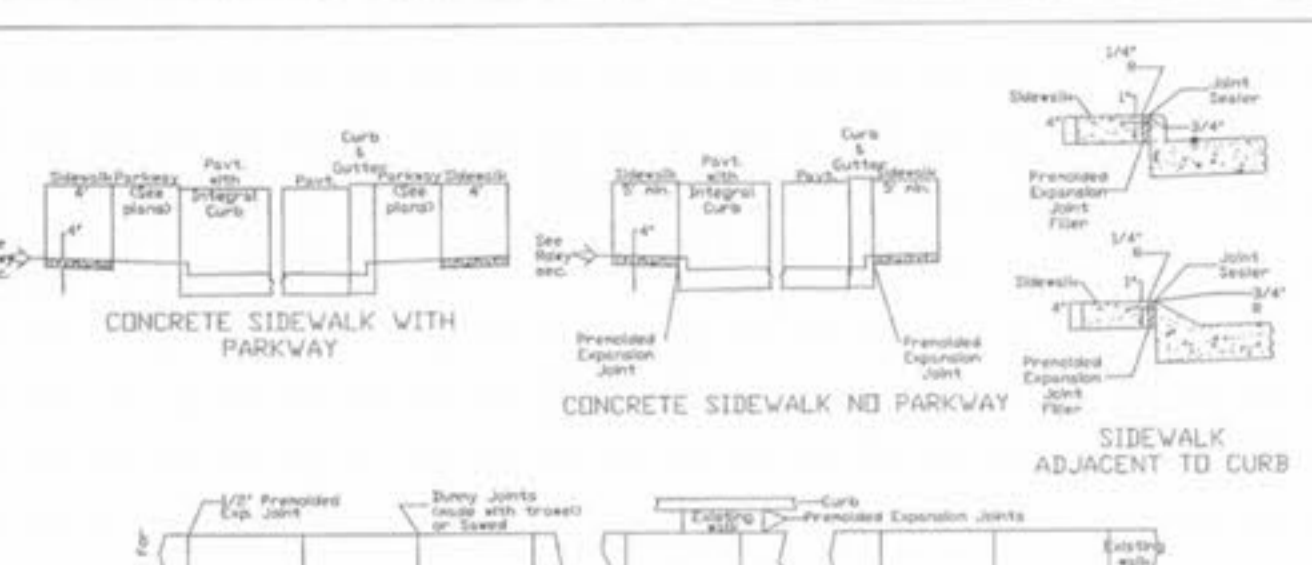

GENERAL NOTES

- Do not scale drawing. Follow dimensions.
- Sections show as specified detail construction.
- For longitudinal and transverse joints, steel and tie bar requirements and dimensions refer to the "Integral Curb Pavement" Typical Section and Details.
- All necessary pavement details shall be as required by Saint Charles County.
- Sections show as typical details.
- Swales shown may not apply to all situations.
- Expansion joints shall be installed in accordance with the "Integral Curb Pavement" Typical Section and Details.
- See "Integral Curb Detail" for all driveway and pavement expansion joint requirements.

**SAINT CHARLES COUNTY
HIGHWAY DEPARTMENT
ST. CHARLES, MISSOURI**

CONCRETE SIDEWALK

DATE: October, 2002 DRAWING: C508.14

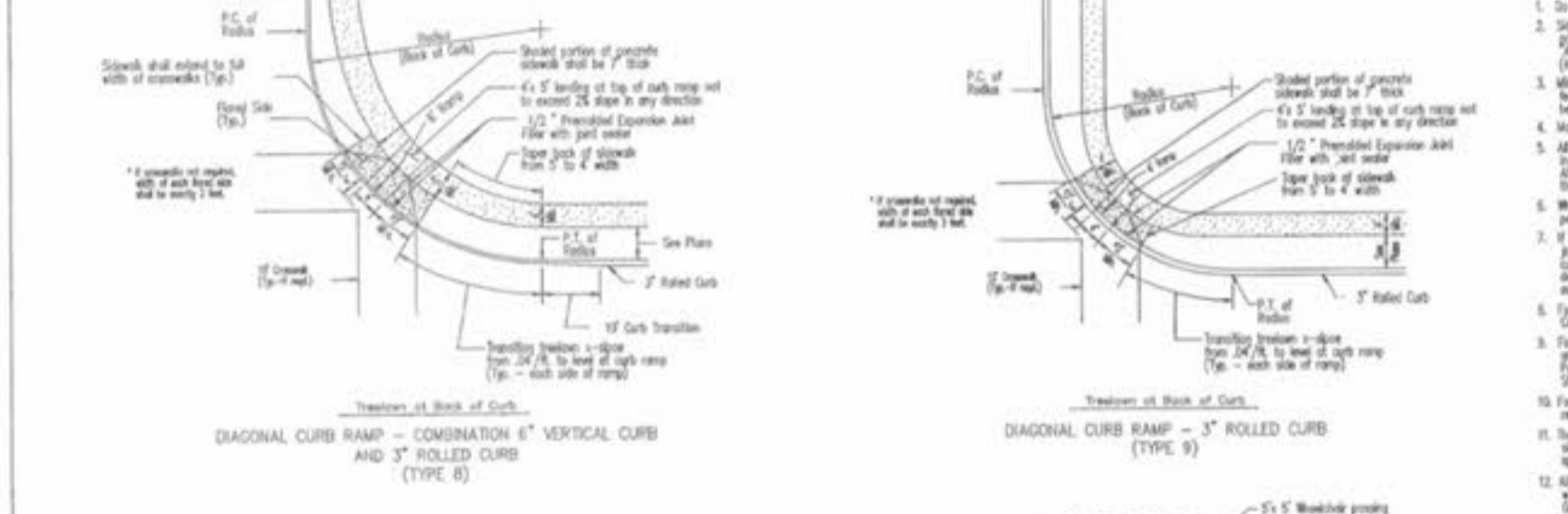

GENERAL NOTES

- Do not scale drawing. Follow dimensions.
- Sections show as specified detail construction.
- For longitudinal and transverse joints, steel and tie bar requirements and dimensions refer to the "Integral Curb Pavement" Typical Section and Details.
- All necessary pavement details shall be as required by Saint Charles County.
- Sections show as typical details.
- Swales shown may not apply to all situations.
- Expansion joints shall be installed in accordance with the "Integral Curb Pavement" Typical Section and Details.
- See "Integral Curb Detail" for all driveway and pavement expansion joint requirements.

WHEELCHAIR PASSING SPACE - 4" SIDEWALK WITH 3" ROLLED CURB

TYPE 10 CURB RAMP

GRADE ALONG CURB	LENGTH OF FLARED SIDE WALK (ft)
0 to +1	5
+1.01 to +2	7
+2.01 to +3	9
+3.01 to +4	11
+4.01 to +5	13
+5.01 to +6	15
GREATER THAN +6	15

**SAINT CHARLES COUNTY
HIGHWAY DEPARTMENT
ST. CHARLES, MISSOURI**

**PAYMENT CONSTRUCTION DETAILS
CONCRETE SIDEWALK
AND CURB RAMP**

DATE: Aug, 2002 DRAWING: C508.12

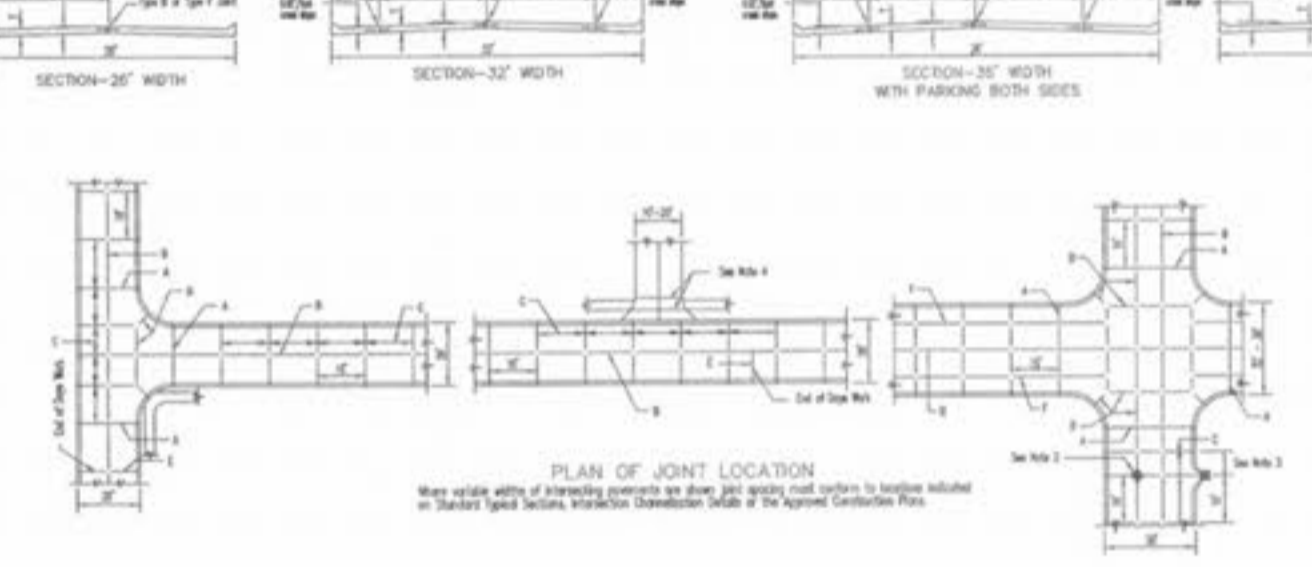

GENERAL NOTES

- Do not scale drawing. Follow dimensions.
- Sections show as specified detail construction.
- For longitudinal and transverse joints, steel and tie bar requirements and dimensions refer to the "Integral Curb Pavement" Typical Section and Details.
- All necessary pavement details shall be as required by Saint Charles County.
- Sections show as typical details.
- Swales shown may not apply to all situations.
- Expansion joints shall be installed in accordance with the "Integral Curb Pavement" Typical Section and Details.
- See "Integral Curb Detail" for all driveway and pavement expansion joint requirements.

**SAINT CHARLES COUNTY
HIGHWAY DEPARTMENT
ST. CHARLES, MISSOURI**

**PAYMENT CONSTRUCTION DETAILS
CONCRETE SIDEWALK
AND CURB RAMP**

DATE: Aug, 2002 DRAWING: C508.12

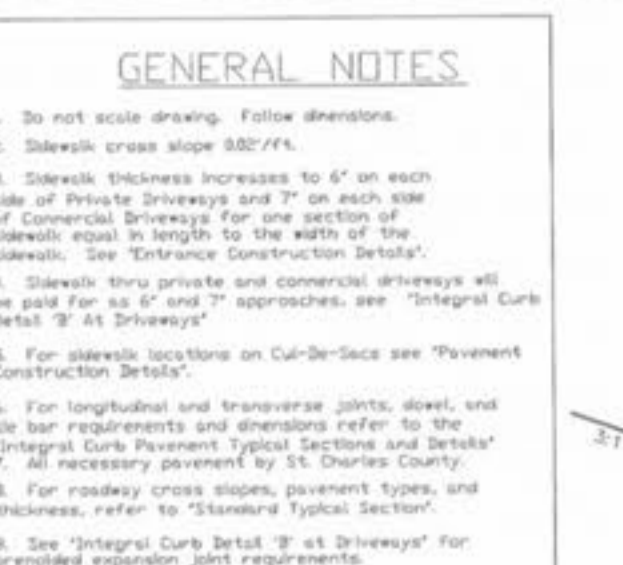

GENERAL NOTES

- Do not scale drawing. Follow dimensions.
- Sections show as specified detail construction.
- For longitudinal and transverse joints, steel and tie bar requirements and dimensions refer to the "Integral Curb Pavement" Typical Section and Details.
- All necessary pavement details shall be as required by Saint Charles County.
- Sections show as typical details.
- Swales shown may not apply to all situations.
- Expansion joints shall be installed in accordance with the "Integral Curb Pavement" Typical Section and Details.
- See "Integral Curb Detail" for all driveway and pavement expansion joint requirements.

**SAINT CHARLES COUNTY
HIGHWAY DEPARTMENT
ST. CHARLES, MISSOURI**

CONCRETE SIDEWALK

DATE: October, 2002 DRAWING: C508.14



GENERAL NOTES

- Do not scale drawing. Follow dimensions.
- Sections show as specified detail construction.
- For longitudinal and transverse joints, steel and tie bar requirements and dimensions refer to the "Integral Curb Pavement" Typical Section and Details.
- All necessary pavement details shall be as required by Saint Charles County.
- Sections show as typical details.
- Swales shown may not apply to all situations.
- Expansion joints shall be installed in accordance with the "Integral Curb Pavement" Typical Section and Details.
- See "Integral Curb Detail" for all driveway and pavement expansion joint requirements.

**SAINT CHARLES COUNTY
HIGHWAY DEPARTMENT
ST. CHARLES, MISSOURI**

**PAYMENT CONSTRUCTION DETAILS
CONCRETE SIDEWALK
AND CURB RAMP**

DATE: Aug, 2002 DRAWING: C508.12

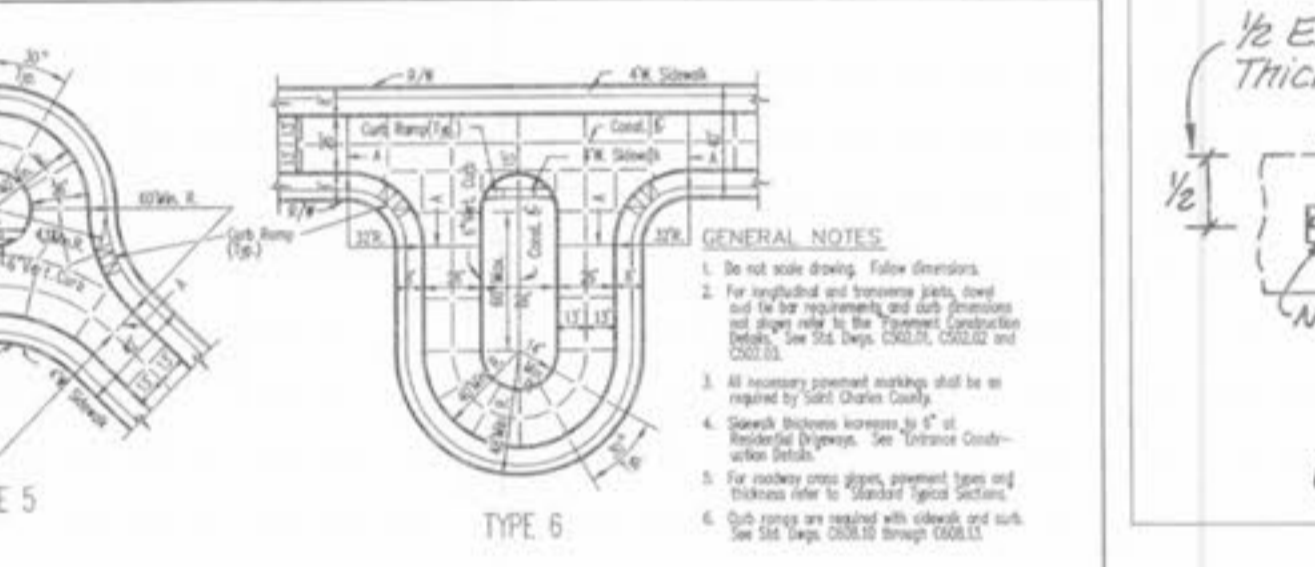

GENERAL NOTES

- Do not scale drawing. Follow dimensions.
- Sections show as specified detail construction.
- For longitudinal and transverse joints, steel and tie bar requirements and dimensions refer to the "Integral Curb Pavement" Typical Section and Details.
- All necessary pavement details shall be as required by Saint Charles County.
- Sections show as typical details.
- Swales shown may not apply to all situations.
- Expansion joints shall be installed in accordance with the "Integral Curb Pavement" Typical Section and Details.
- See "Integral Curb Detail" for all driveway and pavement expansion joint requirements.

**SAINT CHARLES COUNTY
HIGHWAY DEPARTMENT
ST. CHARLES, MISSOURI**

**PAYMENT CONSTRUCTION DETAILS
CONCRETE SIDEWALK
AND CURB RAMP**

DATE: Aug, 2002 DRAWING: C508.12

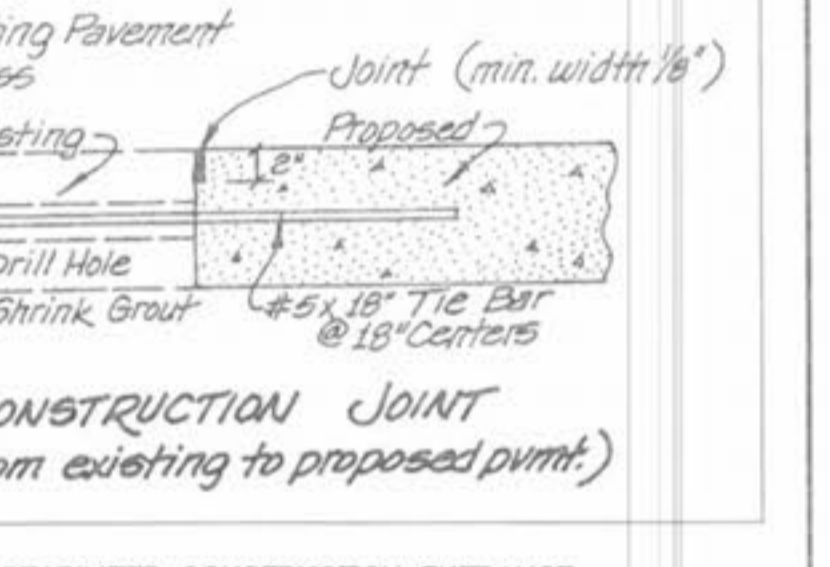

CONSTRUCTION SPECIFICATIONS

- Stone Size - Use 2" stone, or maximum of recycled concrete equivalent.
- Length - As required, but not less than 50 feet (except on a single residence lot where a 30 foot minimum length would apply).
- Thickness - Not less than six (6) inches.
- Width - Twenty six (26) feet minimum, but not less than the full width at points where higher or greater loading.
- Filter Cloth - Will be placed over the entire area prior to placing of stone. Filter will not be required on a single family residence lot.
- Surface Water - All surface water flowing or diverted toward construction entrances shall be piped across the entrance. If piping is impractical, a portable berm with 3:1 slopes will be provided.
- Maintenance - The entrance shall be maintained in a condition which will prevent tracking of flowing or sediment onto public rights-of-way. This may require periodic mowing with mulch or other maintenance methods and repair and/or cleaning of any measures used to trap sediment. All sediment applied, dropped, washed or tracked onto public rights-of-way must be removed immediately.
- Reinforcing - Reinforcing shall be obtained to remove sediment prior to entrance onto public rights-of-way when washing is required. It shall be done on an area stabilized with stone and which drains into an approved sediment trapping device.
- Periodic inspection and needed maintenance shall be provided after each run.

**SAINT CHARLES COUNTY
HIGHWAY DEPARTMENT
ST. CHARLES, MISSOURI**

**PAYMENT CONSTRUCTION DETAILS
CONCRETE SIDEWALK
AND CURB RAMP**

DATE: Aug, 2002 DRAWING: C508.12

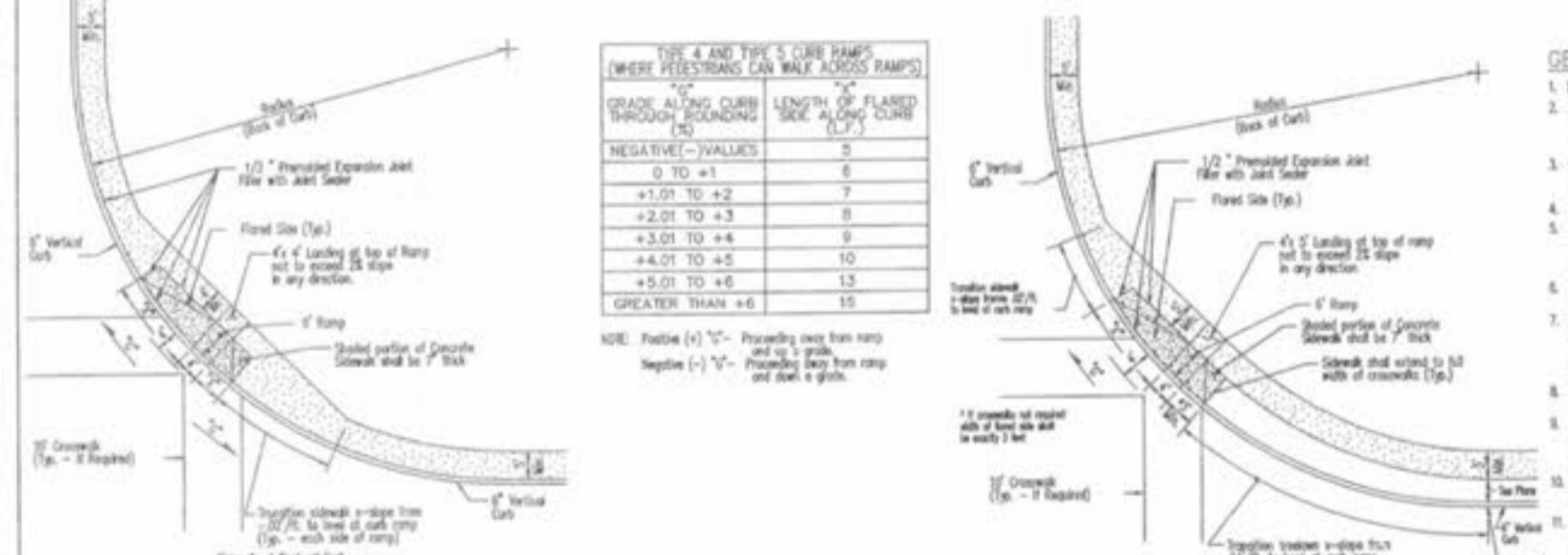

GENERAL NOTES

- Do not scale drawing. Follow dimensions.
- Sections show as specified detail construction.
- For longitudinal and transverse joints, steel and tie bar requirements and dimensions refer to the "Integral Curb Pavement" Typical Section and Details.
- All necessary pavement details shall be as required by Saint Charles County.
- Sections show as typical details.
- Swales shown may not apply to all situations.
- Expansion joints shall be installed in accordance with the "Integral Curb Pavement" Typical Section and Details.
- See "Integral Curb Detail" for all driveway and pavement expansion joint requirements.

**SAINT CHARLES COUNTY
HIGHWAY DEPARTMENT
ST. CHARLES, MISSOURI**

**PAYMENT CONSTRUCTION DETAILS
CONCRETE SIDEWALK
AND CURB RAMP**

DATE: Aug, 2002 DRAWING: C508.11

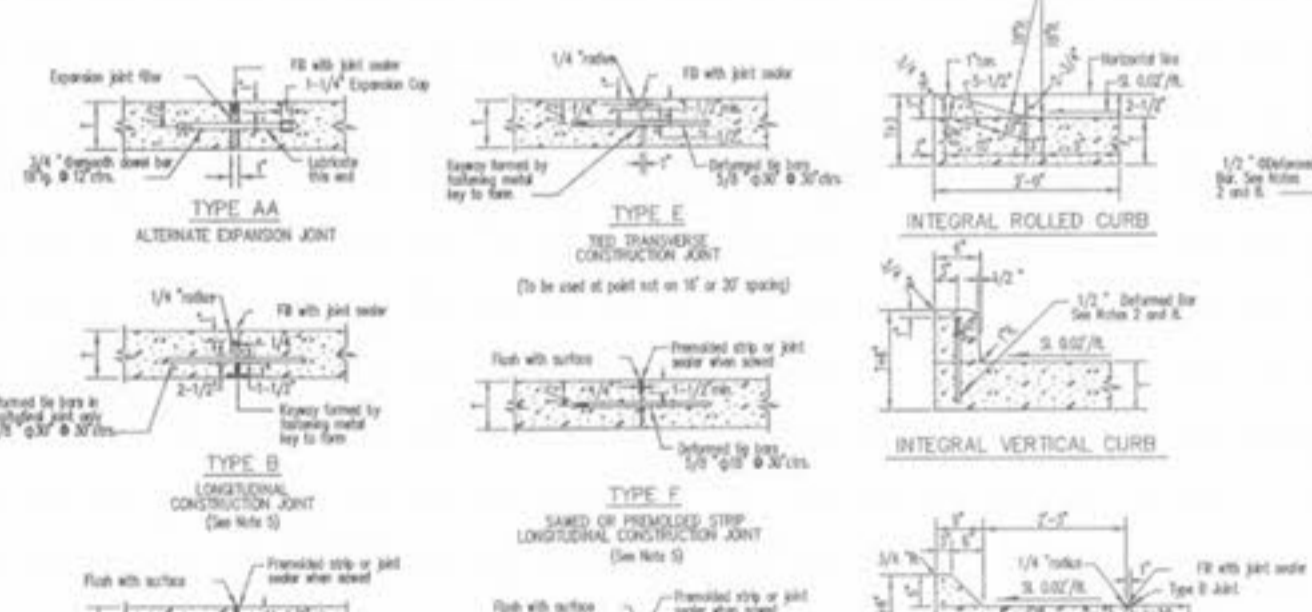

GENERAL NOTES

- Do not scale drawing. Follow dimensions.
- Sections show as specified detail construction.
- For longitudinal and transverse joints, steel and tie bar requirements and dimensions refer to the "Integral Curb Pavement" Typical Section and Details.
- All necessary pavement details shall be as required by Saint Charles County.
- Sections show as typical details.
- Swales shown may not apply to all situations.
- Expansion joints shall be installed in accordance with the "Integral Curb Pavement" Typical Section and Details.
- See "Integral Curb Detail" for all driveway and pavement expansion joint requirements.

**SAINT CHARLES COUNTY
HIGHWAY DEPARTMENT
ST. CHARLES, MISSOURI**

**PAYMENT CONSTRUCTION DETAILS
CONCRETE SIDEWALK
AND CURB RAMP**

DATE: Aug, 2002 DRAWING: C508.11

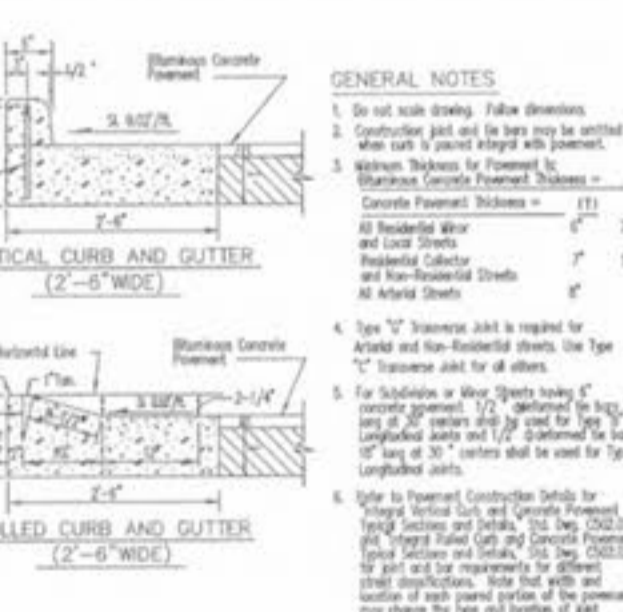

GENERAL NOTES

- Do not scale drawing. Follow dimensions.
- Sections show as specified detail construction.
- For longitudinal and transverse joints, steel and tie bar requirements and dimensions refer to the "Integral Curb Pavement" Typical Section and Details.
- All necessary pavement details shall be as required by Saint Charles County.
- Sections show as typical details.
- Swales shown may not apply to all situations.
- Expansion joints shall be installed in accordance with the "Integral Curb Pavement" Typical Section and Details.
- See "Integral Curb Detail" for all driveway and pavement expansion joint requirements.

**SAINT CHARLES COUNTY
HIGHWAY DEPARTMENT
ST. CHARLES, MISSOURI**

**PAYMENT CONSTRUCTION DETAILS
CONCRETE SIDEWALK
AND CURB RAMP**

DATE: Aug, 2002 DRAWING: C508.11



GENERAL NOTES

- Do not scale drawing. Follow dimensions.
- Sections show as specified detail construction.
- For longitudinal and transverse joints, steel and tie bar requirements and dimensions refer to the "Integral Curb Pavement" Typical Section and Details.
- All necessary pavement details shall be as required by Saint Charles County.
- Sections show as typical details.
- Swales shown may not apply to all situations.
- Expansion joints shall be installed in accordance with the "Integral Curb Pavement" Typical Section and Details.
- See "Integral Curb Detail" for all driveway and pavement expansion joint requirements.

**SAINT CHARLES COUNTY
HIGHWAY DEPARTMENT
ST. CHARLES, MISSOURI**

**PAYMENT CONSTRUCTION DETAILS
CONCRETE SIDEWALK
AND CURB RAMP**

DATE: Aug, 2002 DRAWING: C508.11



GENERAL NOTES

- THE NUMBER OF BACKER RODS REQUIRED WILL VARY WITH THE PAVEMENT THICKNESS, BACKER RODS AND FLEXIBLE FOAM FILLER MUST EXTEND THROUGH THE FULL DEPTH OF THE PAVEMENT.
- JOINT FILLER SHALL BE A FLEXIBLE, NON-ABSORBENT, NON-GASSING, NON-STAINING, NON-CHEMICAL MATERIALS EXTRACTED FROM A CLOSED-CELL POLYURETHANE FOAM WITH A DENSITY OF 45-50 LB/FT³.
- JOINT FILLER COMPOSED OF CELLULAR FIBERS, ASTM D-1751, MAY BE USED AT DRIVEWAY, SIDEWALK, AND SEWER INLET AND MANHOLE LOCATIONS.
- SEE "INTEGRAL CURB DETAIL "B" AT DRIVEWAYS" FOR EXPANSION JOINT REQUIREMENTS AT DRIVEWAY CONNECTIONS TO THE STREET AND THE GARAGE.

**SAINT CHARLES COUNTY
HIGHWAY DEPARTMENT
ST. CHARLES, MISSOURI**

**PAYMENT CONSTRUCTION DETAILS
CONCRETE SIDEWALK
AND CURB RAMP**

DATE: Aug, 2002 DRAWING: C508.11

