

STRIPING & TRAFFIC CONTROL PLAN

NOTE: THE CONTRACTOR MUST CONTACT MoDOT CUSTOMER SERVICE CENTER AT (314) 340-4100 TO INFORM OF LANE CLOSURES 48 HOURS PRIOR TO THE CLOSURES.

NOTE: WORKING HOUR RESTRICTION PER MoDOT REQUIREMENTS - 9:00 A.M. TO 3:30 P.M.

ENGINEERS
ARCHITECTS
SURVEYORS
SCIENTISTS

Farnsworth GROUP

20 ALLEN AVENUE, SUITE 200
ST LOUIS, MISSOURI 63119
(314) 962-7900 / (314) 962-1253 Fax

www.f-w.com

ISSUE:

#	Date:	Description:
1	2/13/04	City of O'Fallon Comments
2	2/13/04	Duckett Creek Sanitary District Comments
3	2/13/04	Cottleville Fire Protection District Comments
4	2/13/04	MoDot Comments
5	2/13/04	Corps of Engineers Comments



MISSOURI ONE CALL SYSTEM, INC.
* FIBER OPTIC PRESENT *
MoDOT (314) 340-4100

PROJECT:
PERSIMMON POINTE
HOTEL DEVELOPMENT



#4130 HIGHWAY 40-61
O'FALLON, MO

Date: 12-30-03
Design/Drawn: DB
Approved: JTB
Book No.:

SHEET TITLE:
STRIPING / TRAFFIC CONTROL PLAN

SHEET NUMBER:
RWP-2
SHEET 35 OF 36

Project No.: 299163.12
Planning & Zoning File: #3103.03

CHAPTER VII
TRAFFIC CONTROL DEVICES

Sign Spacing, Device Spacing and Channelizing Taper Lengths
Figure B-04.1
Sheet 7 of 8

SPEED 15 MPH	TAPER LENGTHS AND SPACING OF CHANNELIZING DEVICES	
	USUAL	MINIMUM CHANNELIZING SPACING
20	75	25
25	100	30
30	150	35
35	200	40
40	250	45
45	300	50
50	350	55
55	400	60
60	450	65
65	500	70
70	550	75

MINIMUM SPACING OF CHANNELIZING DEVICES AT CURVES

CURVE CHARACTERISTICS	SPACING IN FEET	
	ON CURVE	BEYOND CURVE
1/2" TO 2"	1500 TO 2000	75
2" TO 4"	2000 TO 2500	80
4" TO 8"	2500 TO 3000	85
8" TO 16"	3000 TO 3500	90
16" TO 24"	3500 TO 4000	95

TAPER LENGTHS AND END TREATMENTS FOR CONCRETE BARRIER

SPEED 15 MPH	MINIMUM TAPER LENGTHS (M)		END TREATMENT (S)
	FOR LANE WIDTHS (M)	FOR LANE WIDTHS (M)	
20	150	100	CONCRETE BARRIER
25	200	150	CONCRETE BARRIER
30	250	200	CONCRETE BARRIER
35	300	250	CONCRETE BARRIER
40	350	300	CONCRETE BARRIER
45	400	350	CONCRETE BARRIER
50	450	400	CONCRETE BARRIER
55	500	450	CONCRETE BARRIER
60	550	500	CONCRETE BARRIER
65	600	550	CONCRETE BARRIER
70	650	600	CONCRETE BARRIER

NOTES:
DIMENSIONS IN FEET UNLESS OTHERWISE NOTED.
(1) POSTED SPEED LIMIT PRIOR TO ROAD WORK.
(2) SPACING BETWEEN SIGNS BETWEEN LAST SIGN AND FLAGGING BEGINNING OF TAPER OR SLOPED CONDITION.
(3) SPACINGS MAY BE ADJUSTED AS NECESSARY TO MEET FIELD CONDITIONS. A MINIMUM SPACING OF 200' MAY BE USED ON NON-DIVIDED HIGHWAYS. CHANNELIZING DEVICES OR SIGNS TO ADVISE APPROACHING TRUCKS SHALL BE LOCATED AT THE BEGINNING OF THE TAPER OR SLOPE.
(4) TAPER LENGTHS SHOWN INCLUDE LENGTH PROVIDED FOR LANE AND 10 FT SHOULDER.
(5) CONCRETE BARRIER SHALL BE INSTALLED AT THE BEGINNING OF THE TAPER OR SLOPE. THE END OF THE TAPER SHALL BE AT THE END OF THE TAPER OR SLOPE.

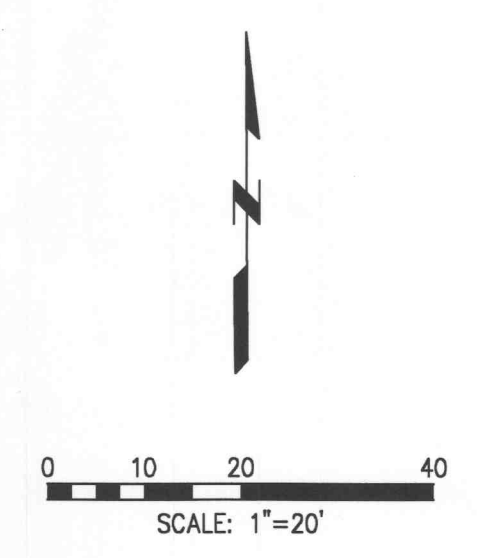
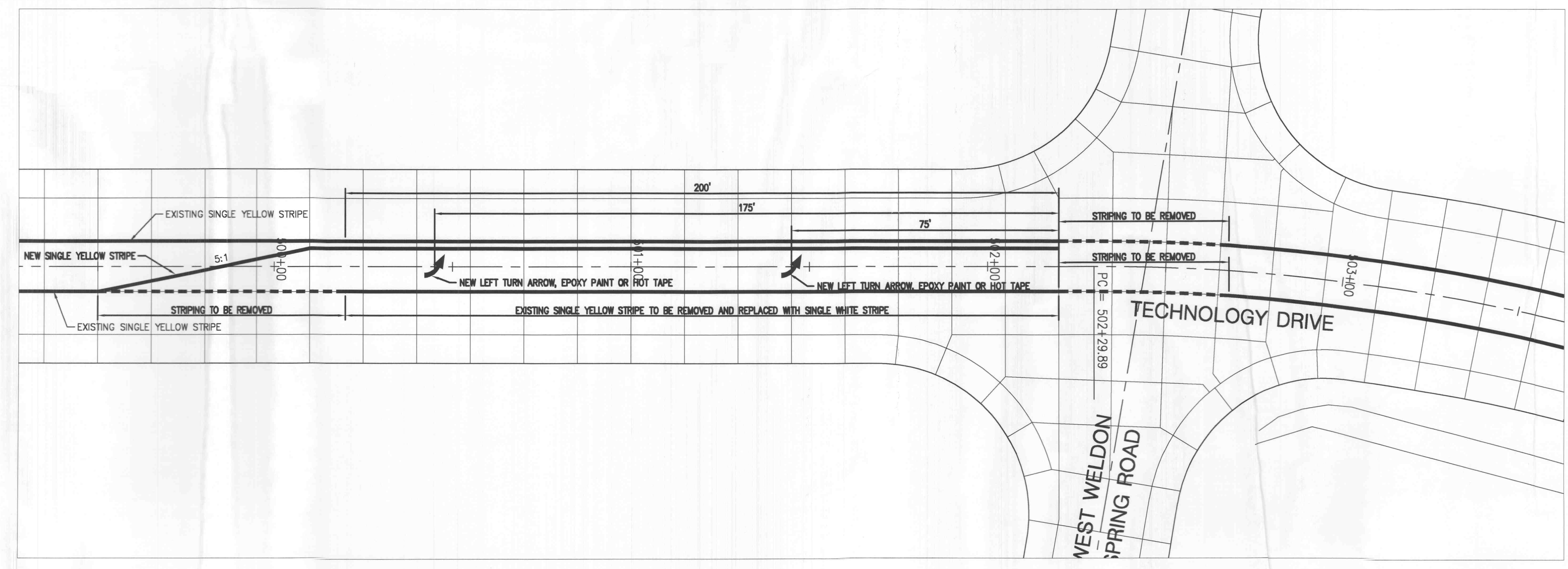
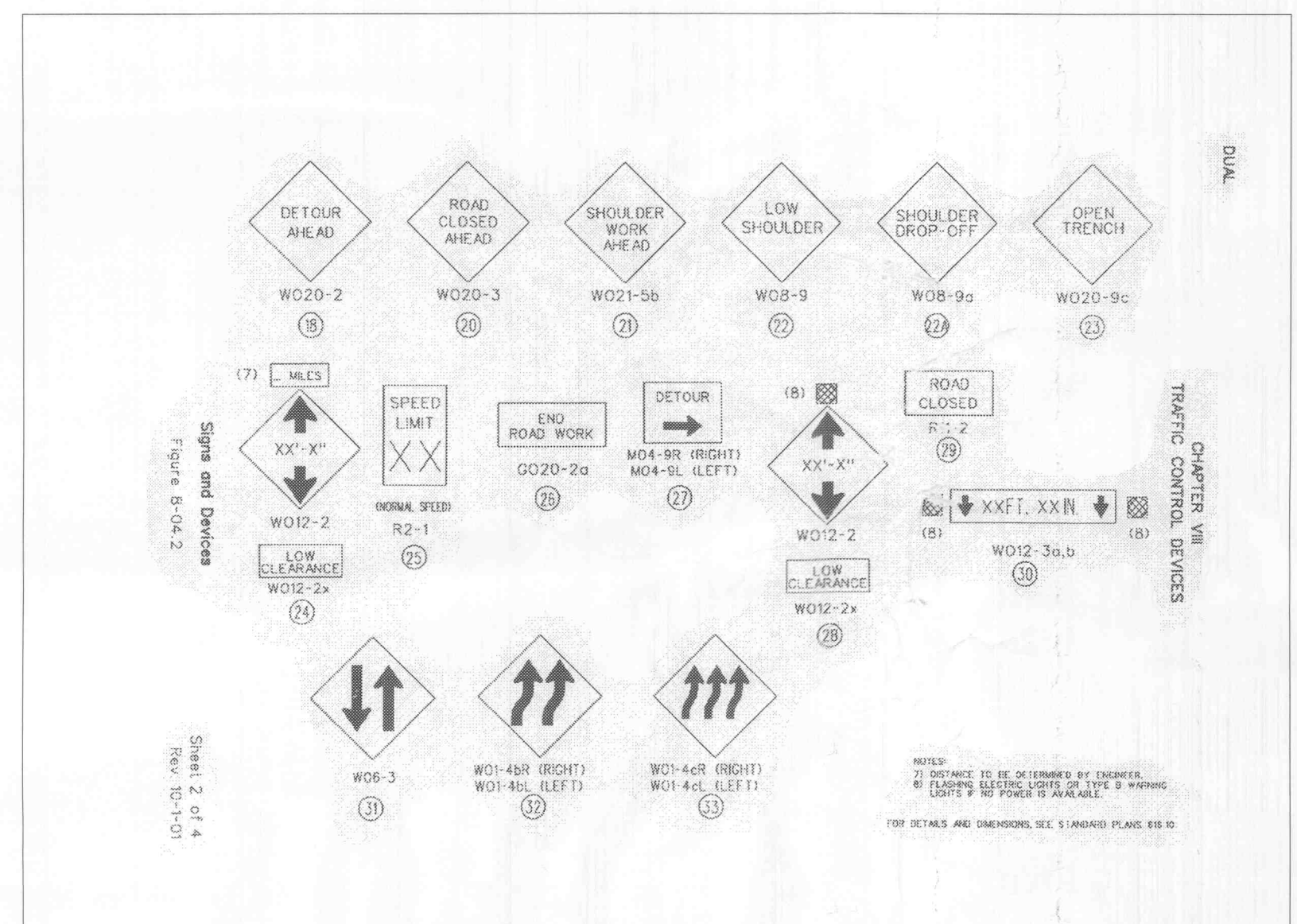
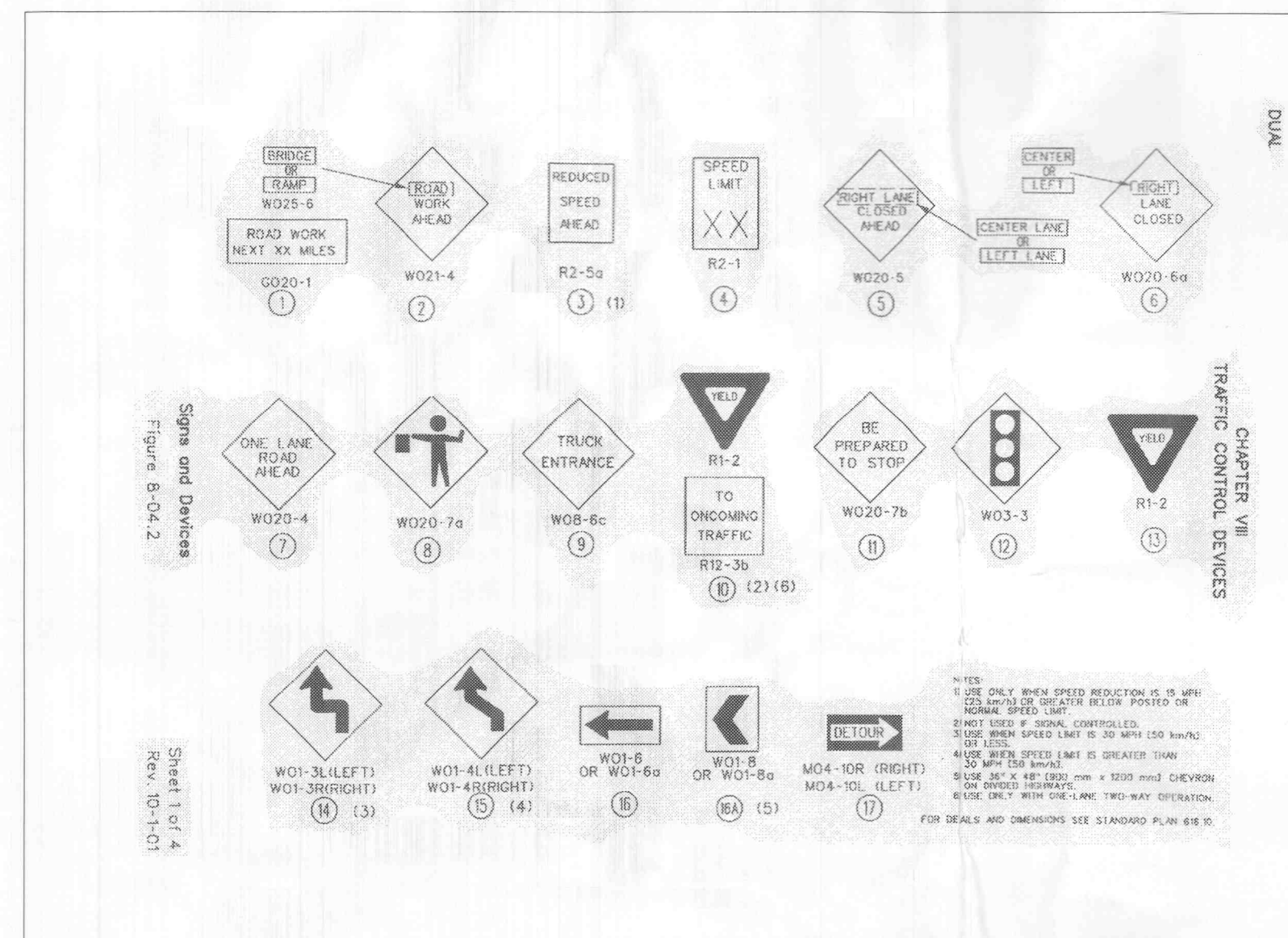
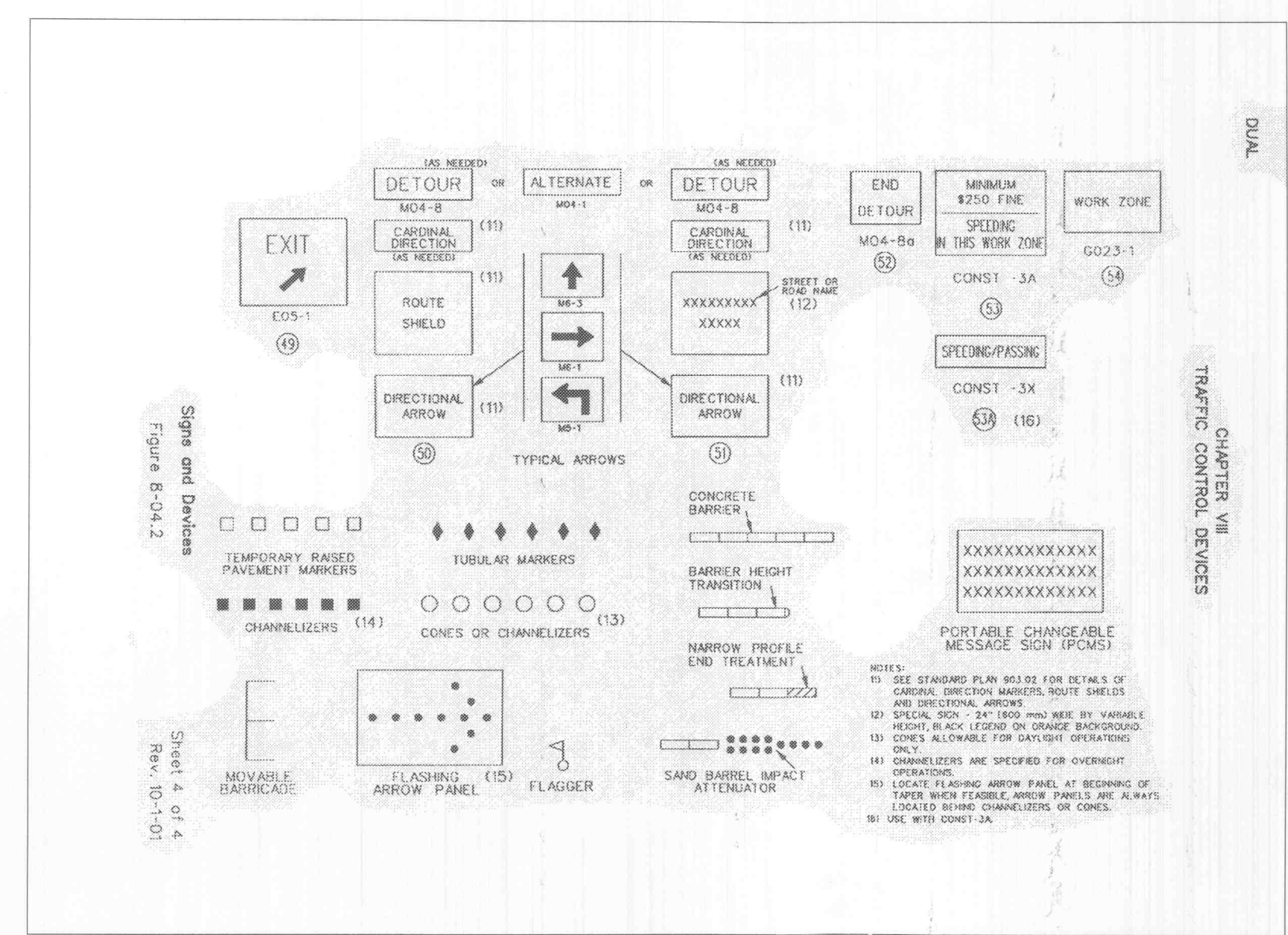

I:\dwork\p\1999\299163.12-hwy_40.dwg - rtk - RTEXT - MSTR-DWG | DATE: 12/03/2003 | Time: 12:04 |