

00-11282L 4-7-05  
REVISIONS:  
4-13-05 Client Revisions  
5-10-05 City Comments & Downspout Revisions  
6-15-05 City & Client Comments  
6-21-05 Client Revisions  
7-29-05 Client Revisions  
8-9-05 Sanitary Lateral Found, Omit main in lot

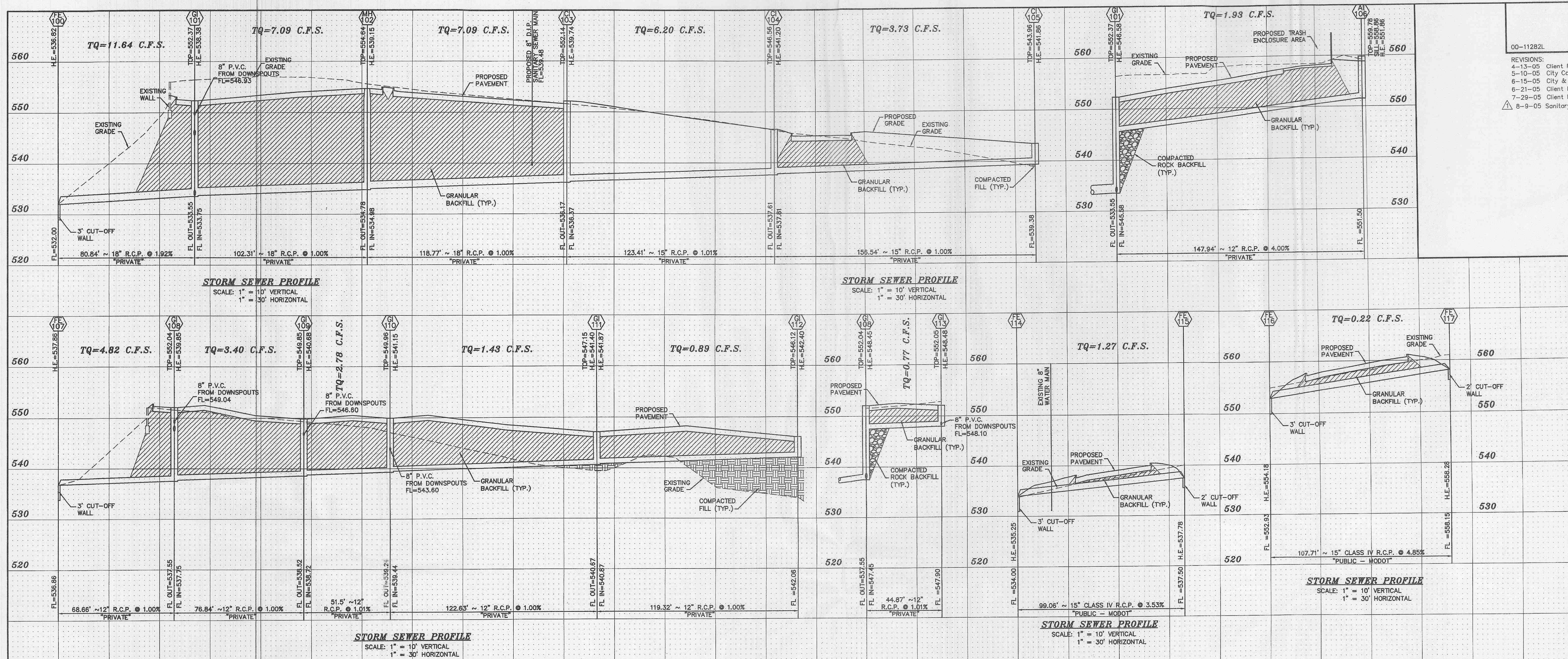

OMIT SANITARY MAIN  
DUE TO LATERAL FIND  
ALONG EXISTING MAIN  
LOCATED AT EASTERN  
PROPERTY LINE

BAX PROJECT NAME : PERUQUE CROSSING RETAIL  
BAX PROJECT NO. : 00-11282L  
DESIGN DATE : 5-15-05  
DESIGNED BY : ALJ  
15 YEAR DESIGN STORM

FILENAME: 11282L-4

UPP STR	LOW STR	L	DIA	UPPER FL LN	LOWER FL LN	PS	UPPER ST EL	DRPTH HY GR	UPPER HY EL	LOWER HY EL	HYDR GRADE	FR HEAD	VEL	VEL HEAD	JUNC LOSS	TURN LOSS	CURVE LOSS	STR GRADE	INL CAP	DR AREA	PI	Q	TQ	PIPE CAP	REMARKS	
FE 117	FE 116	108	15	558.15	552.93	4.85	559.40	1.13	558.28*	554.18	.00000	0.00	0.18	0.00	0.00	0.00	0.00	0.00	0.00	0.00	0.00	0.00	0.22	14.22	1	HW=554.18
FE 115	FE 114	99	15	537.50	534.00	3.53	538.75	0.97	537.78*	535.25	.00040	0.04	1.03	0.02	0.02	0.00	0.00	0.00	0.00	0.00	0.00	0.00	1.27	12.14	2	HW=535.25
GI 113	GI 108	45	12	547.90	547.45	1.00	551.90	3.42	548.48	548.45	.00050	0.02	0.98	0.01	0.01	0.00	0.00	0.00	0.00	0.00	0.00	0.00	0.77	3.57	3	
GI 112	GI 111	119	12	542.06	540.87	1.00	546.12	3.72	542.40*	541.87	.00060	0.07	1.13	0.02	0.02	0.00	0.00	0.00	0.00	0.00	0.00	0.00	0.89	3.56	4	
GI 111	GI 110	123	12	540.67	539.44	1.00	547.15	5.75	541.40	541.15	.00160	0.20	1.82	0.05	0.04	0.01	0.00	0.00	0.00	0.00	0.00	0.00	1.43	3.57	5	
GI 110	GI 109	52	12	539.24	538.72	1.01	549.96	8.81	541.15	540.68	.00610	0.31	3.54	0.19	0.16	0.00	0.00	0.00	0.00	0.00	0.00	0.00	3.40	3.57	7	
GI 109	GI 108	77	12	538.52	537.75	1.00	549.85	9.17	540.68	537.86	.01830	1.26	6.14	0.58	0.52	0.21	0.00	0.00	0.00	0.00	0.00	0.00	4.82	3.57	8	HW=537.86
GI 108	FE 107	69	12	537.55	536.86	1.00	552.04	12.19	539.85																	
AI 106	GI 101	148	12	551.50	545.58	4.00	559.78	7.92	551.86*	546.58	.00290	0.43	2.46	0.09	0.09	0.00	0.00	0.00	0.00	0.00	0.00	0.00	1.93	7.13	9	
CI 105	CI 104	157	15	539.38	537.81	1.00	543.96	2.10	541.86	541.20	.00330	0.52	3.04	0.14	0.14	0.00	0.00	0.00	0.00	0.00	0.00	0.00	3.73	6.47	10	
CI 104	CI 103	123	15	537.61	536.37	1.00	546.56	5.36	541.20	539.74	.00920	1.14	5.05	0.40	0.32	0.00	0.00	0.00	0.00	0.00	0.00	0.00	6.20	6.48	11	
CI 103	MH 102	119	18	536.17	534.98	1.00	552.14	12.40	539.74	539.15	.00460	0.54	4.01	0.25	0.00	0.05	0.00	0.00	0.00	0.00	0.00	0.00	7.09	10.51	12	
MH 102	GI 101	102	18	534.78	533.75	1.01	554.64	15.49	539.15	538.38	.00460	0.47	4.01	0.25	0.15	0.15	0.00	0.00	0.00	0.00	0.00	0.00	7.09	10.54	13	
GI 101	FE 100	81	18	533.55	532.00	1.92	552.37	13.99	538.38	536.82	.01230	0.99	6.59	0.67	0.51	0.06	0.00	0.00	0.00	0.00	0.00	0.00	11.64	14.55	14	HW=536.82

\* INDICATES CRITICAL DEPTH

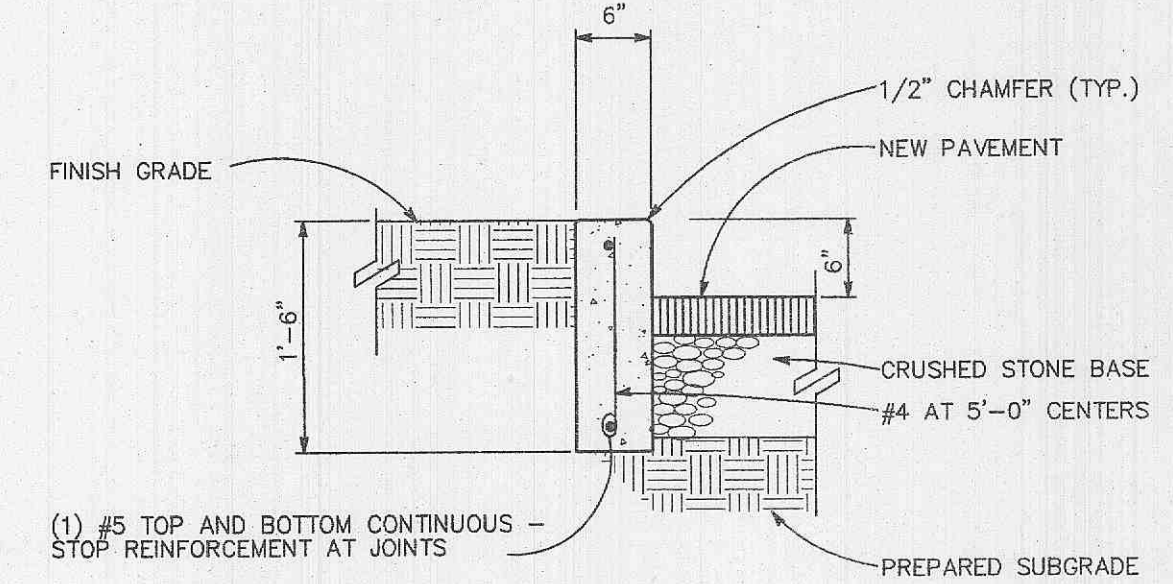

CONCRETE CURB DETAIL  
NOT TO SCALE

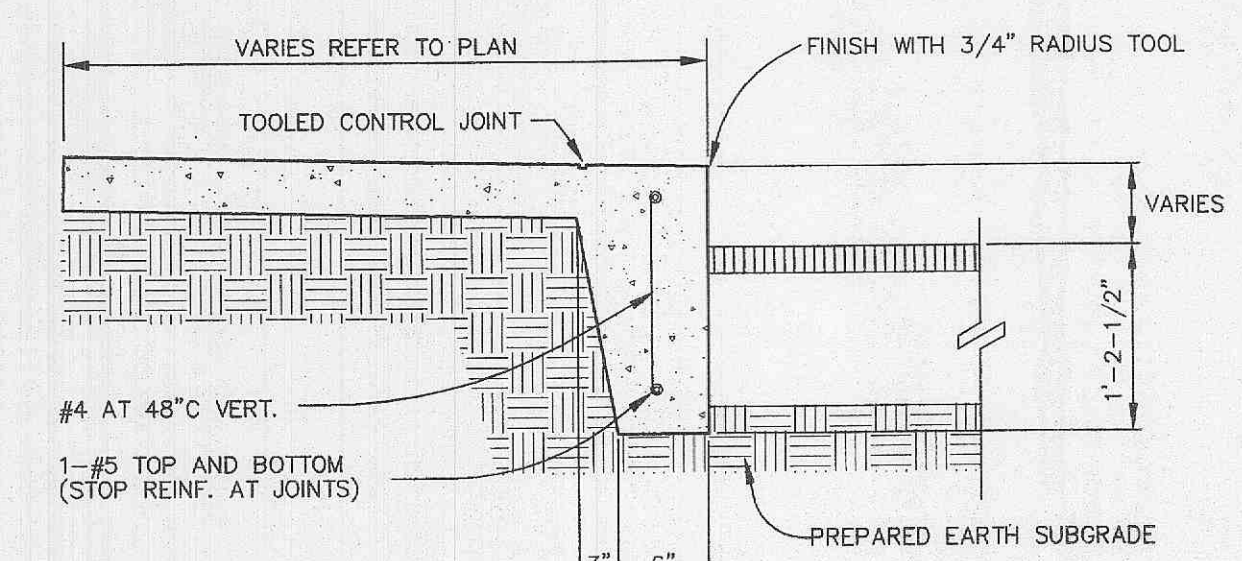

TURNED DOWN CONCRETE WALK  
NOT TO SCALE

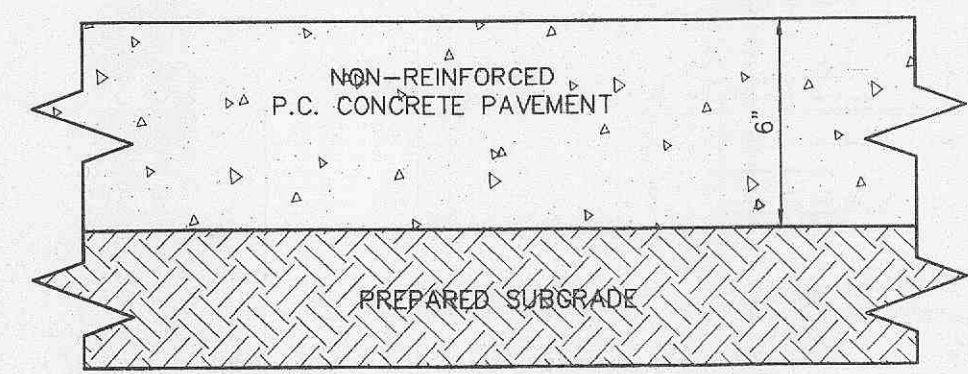

TRASH PAVEMENT DETAIL  
NOT TO SCALE

E:\DWG\11000PLUS\11282L-RETAIL CENTER CONSTRUCTION\11282LCON.dwg, Profiles (6), 8/23/2005 10:49:31 AM, 1:1, Sta 36 SWR