

STREET PROFILE
 SCALES:
 HORIZ. 1"=40'
 VERT. 1"=10'

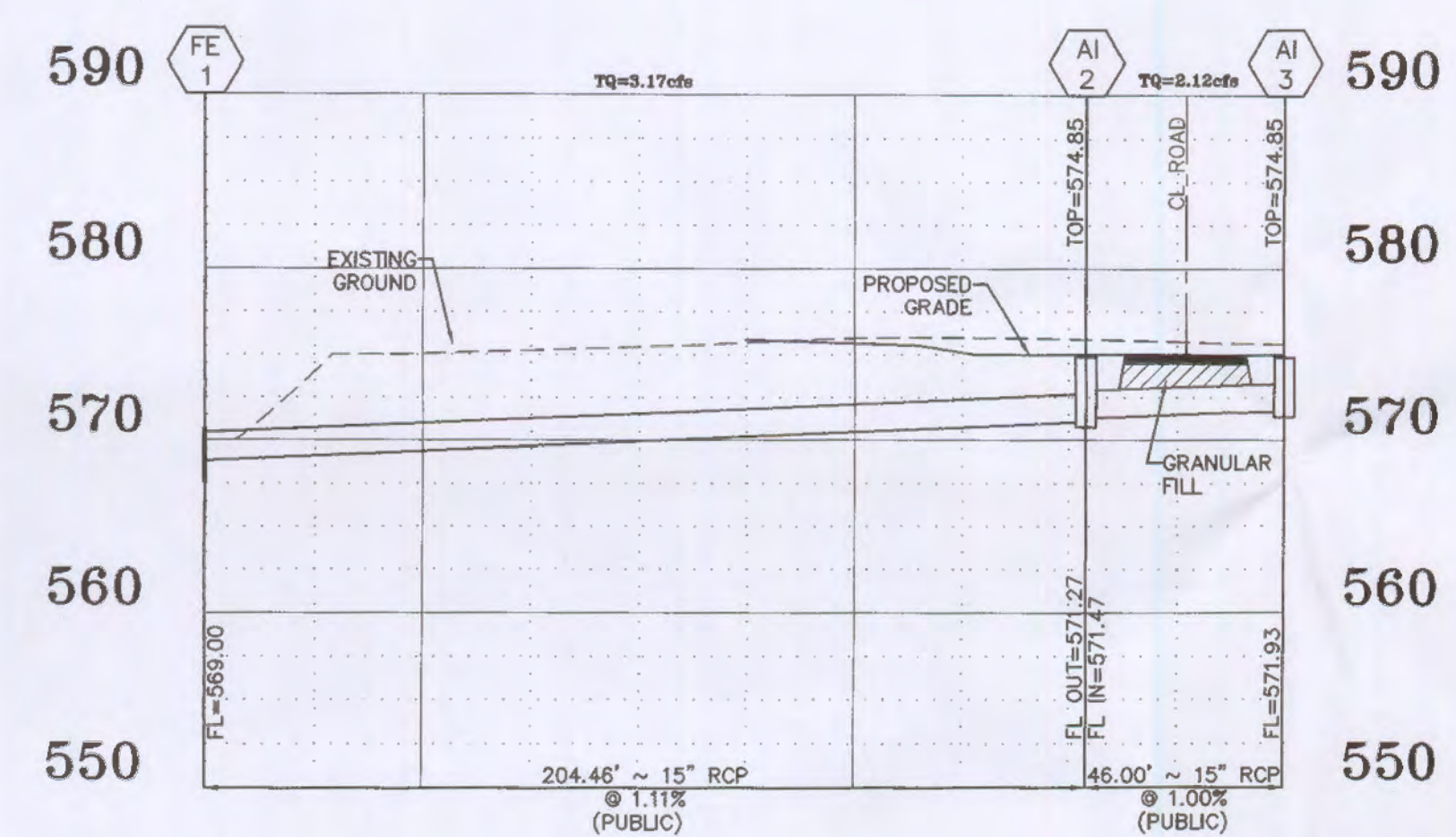

STORM SEWER PROFILE
 SCALES:
 HORIZ. 1"=40'
 VERT. 1"=10'

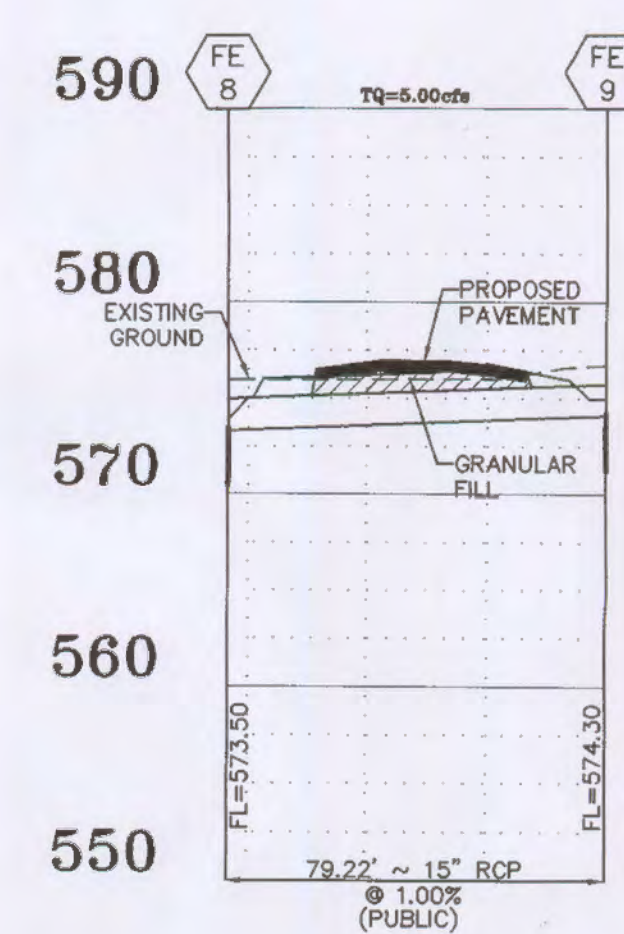

STORM SEWER PROFILE
 SCALES:
 HORIZ. 1"=40'
 VERT. 1"=10'

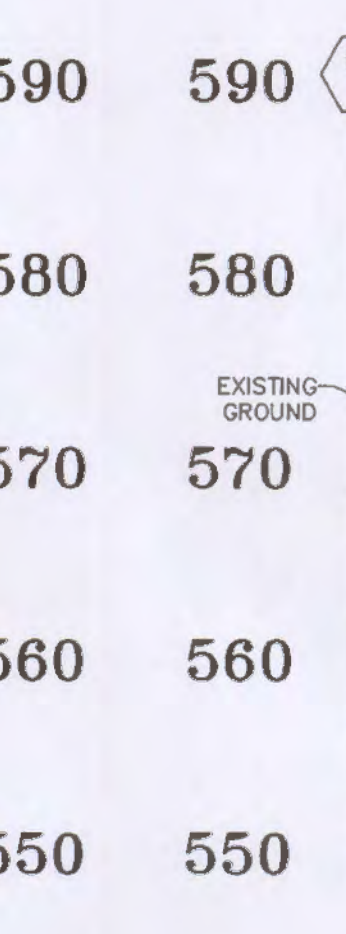

STORM SEWER PROFILE
 SCALES:
 HORIZ. 1"=40'
 VERT. 1"=10'

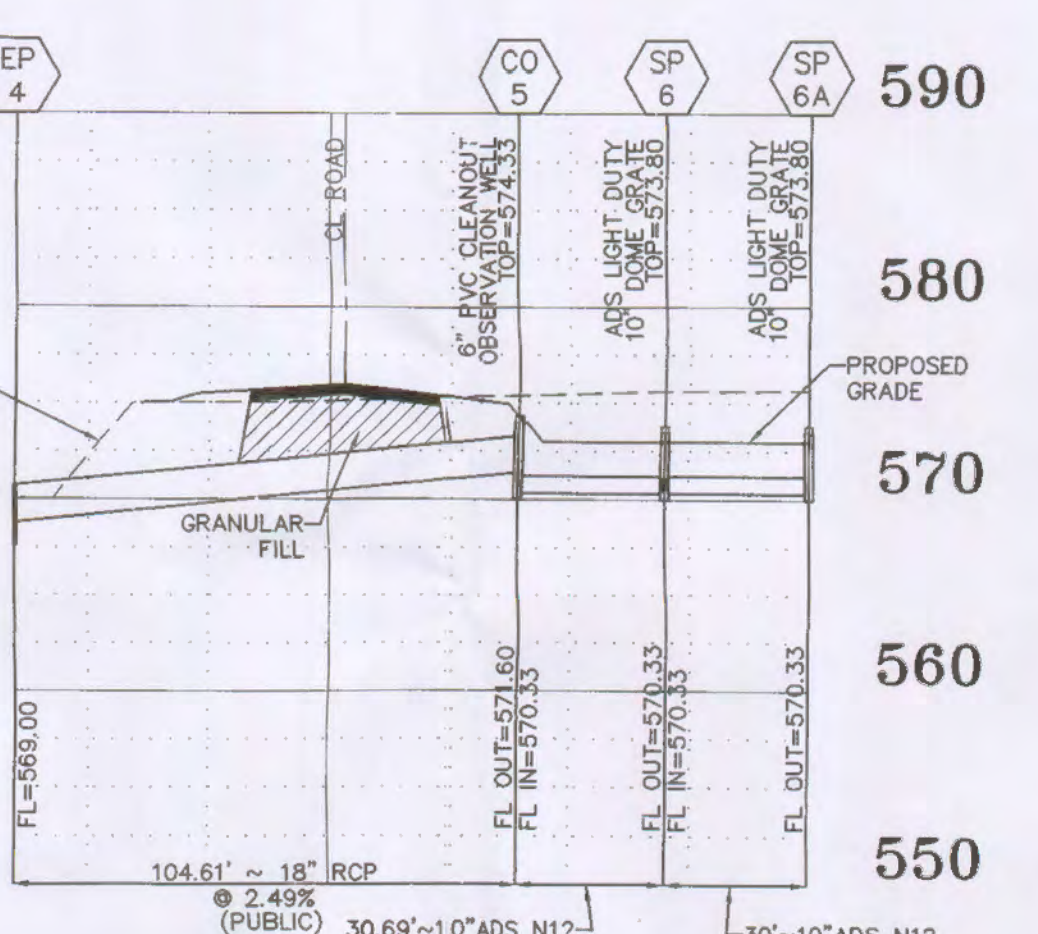

STORM SEWER PROFILE
 SCALES:
 HORIZ. 1"=40'
 VERT. 1"=10'

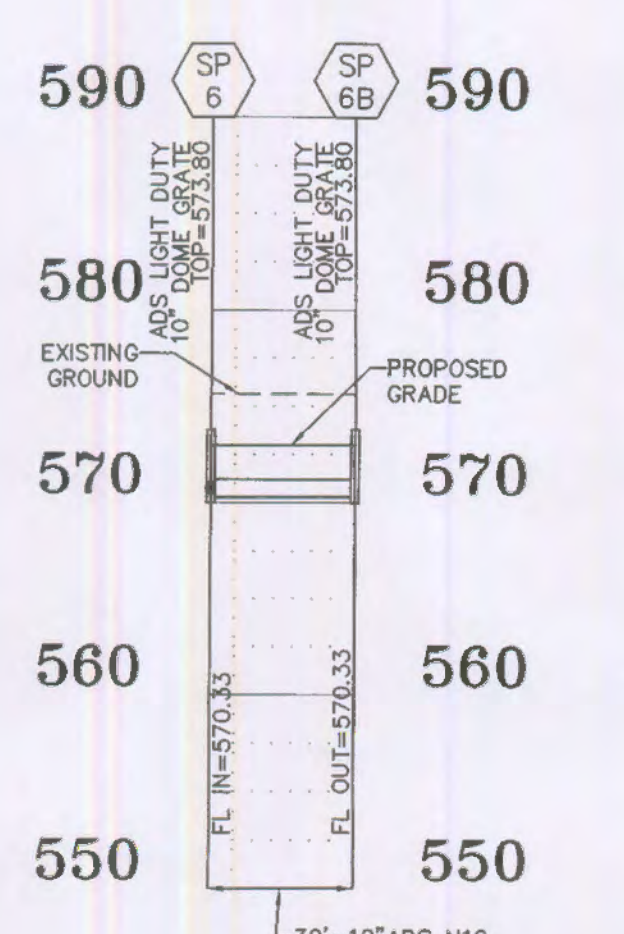

STORM SEWER PROFILE
 SCALES:
 HORIZ. 1"=40'
 VERT. 1"=10'

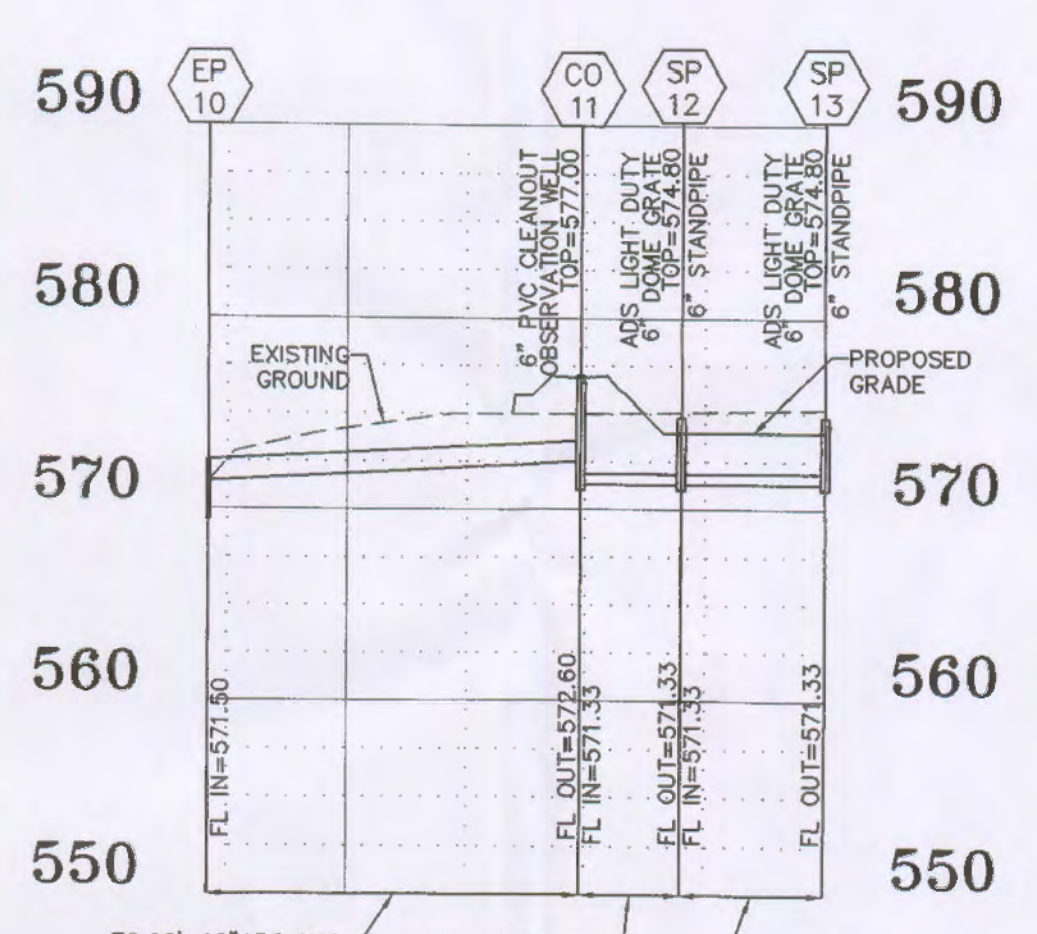

PROJECT TITLE:
PHOENIX METALS

ENGINEERING PLANNING SURVEYING
 221 Point West Blvd.
 St. Charles, MO 63301
 636-949-0682
 FAX 636-949-1716



DISCLAIMER OF RESPONSIBILITY
 I hereby certify that the documents intended to be authenticated by my seal are limited to this sheet, and I hereby disclaim any responsibility for all other drawings, specifications, estimates, reports or other documents or instruments relating to or intended to be used for any part or parts of the architectural or engineering project or survey.

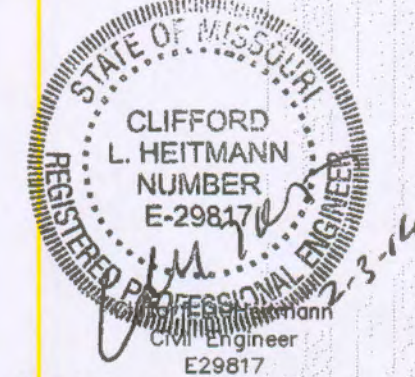

Copyright 2014
 Bax Engineering Company, Inc.
 Engineering Authority No. 000655
 Surveying Authority No. 000144
 All Rights Reserved

REVISIONS

NO.	DATE	DESCRIPTION
11/20/13		CITY/OWNER REVISIONS
01/29/14		CITY COMMENTS
02/03/14		CITY COMMENTS

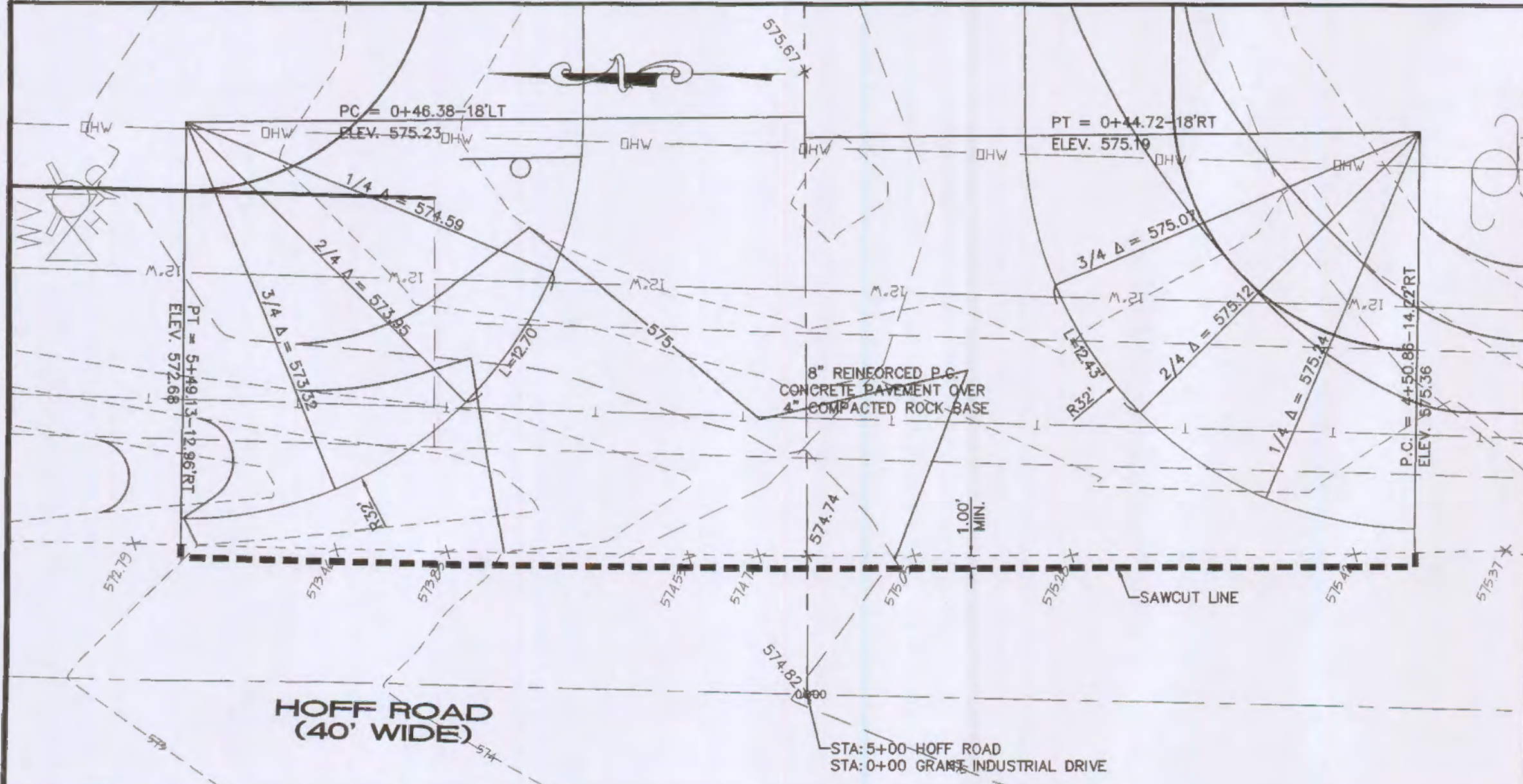

ROAD ENTRANCE DETAIL
 SCALE: 1" = 10'

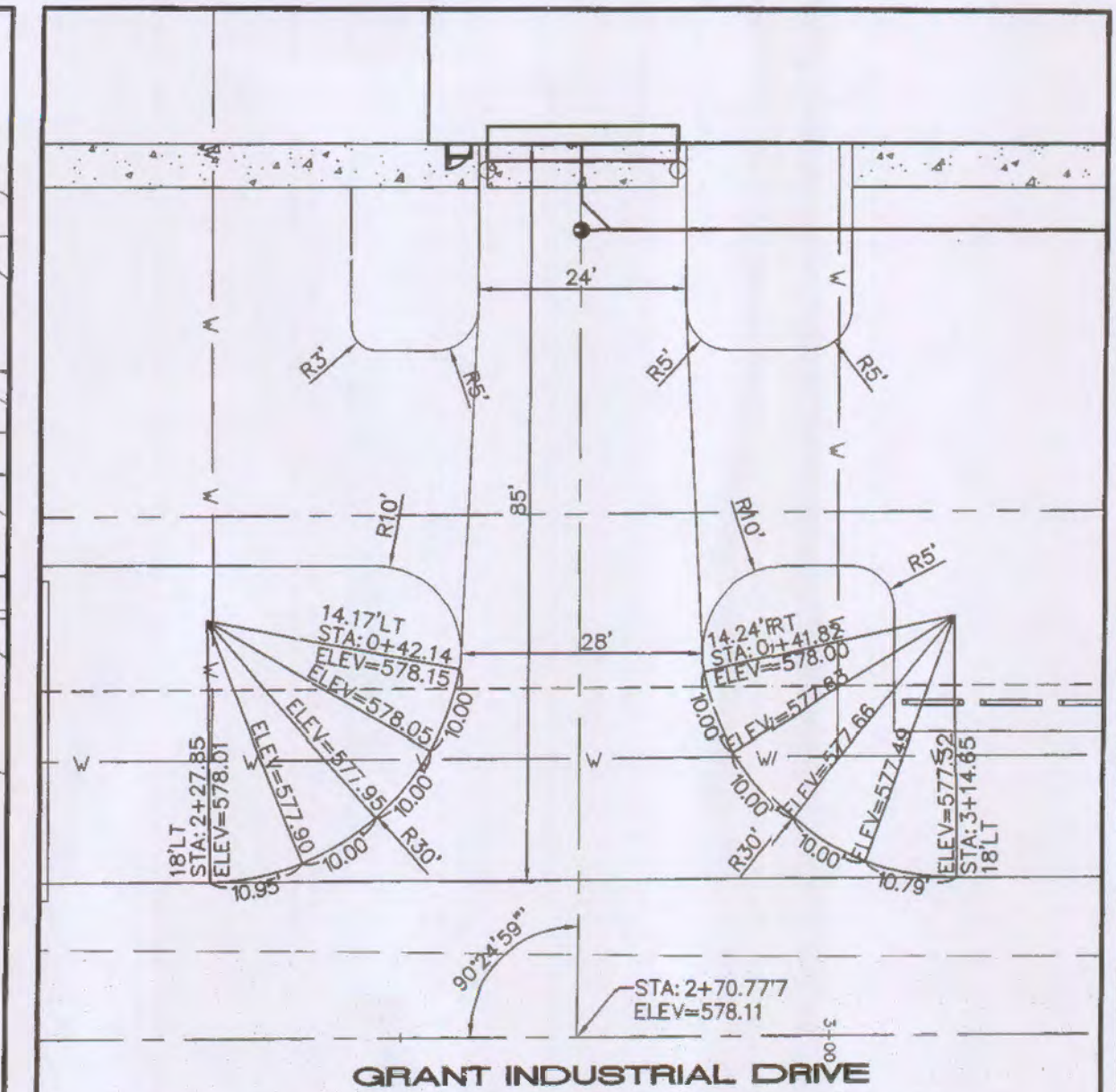

WEST ENTRANCE DETAIL
 SCALE: 1" = 20'

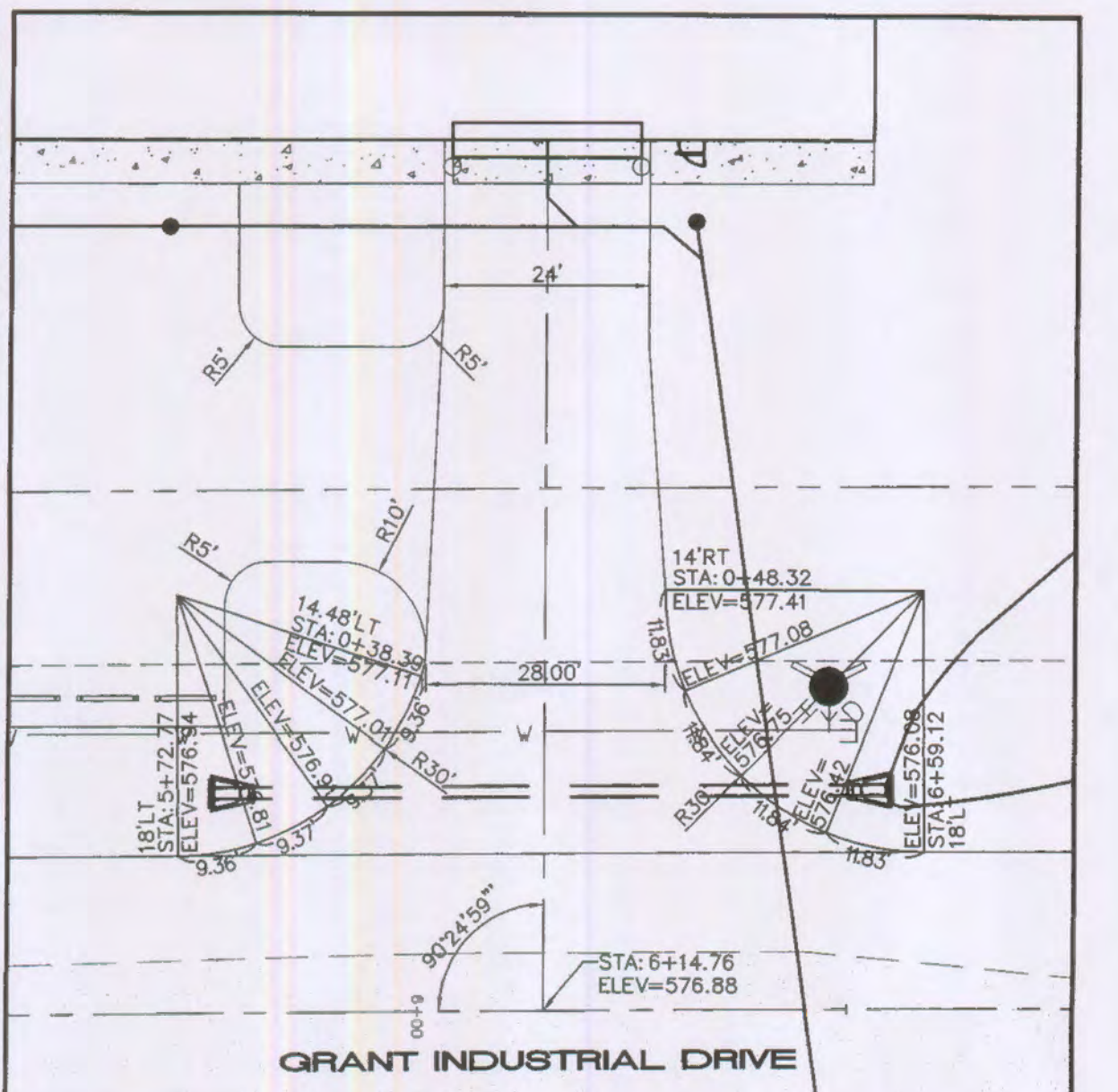

EAST ENTRANCE DETAIL
 SCALE: 1" = 20'

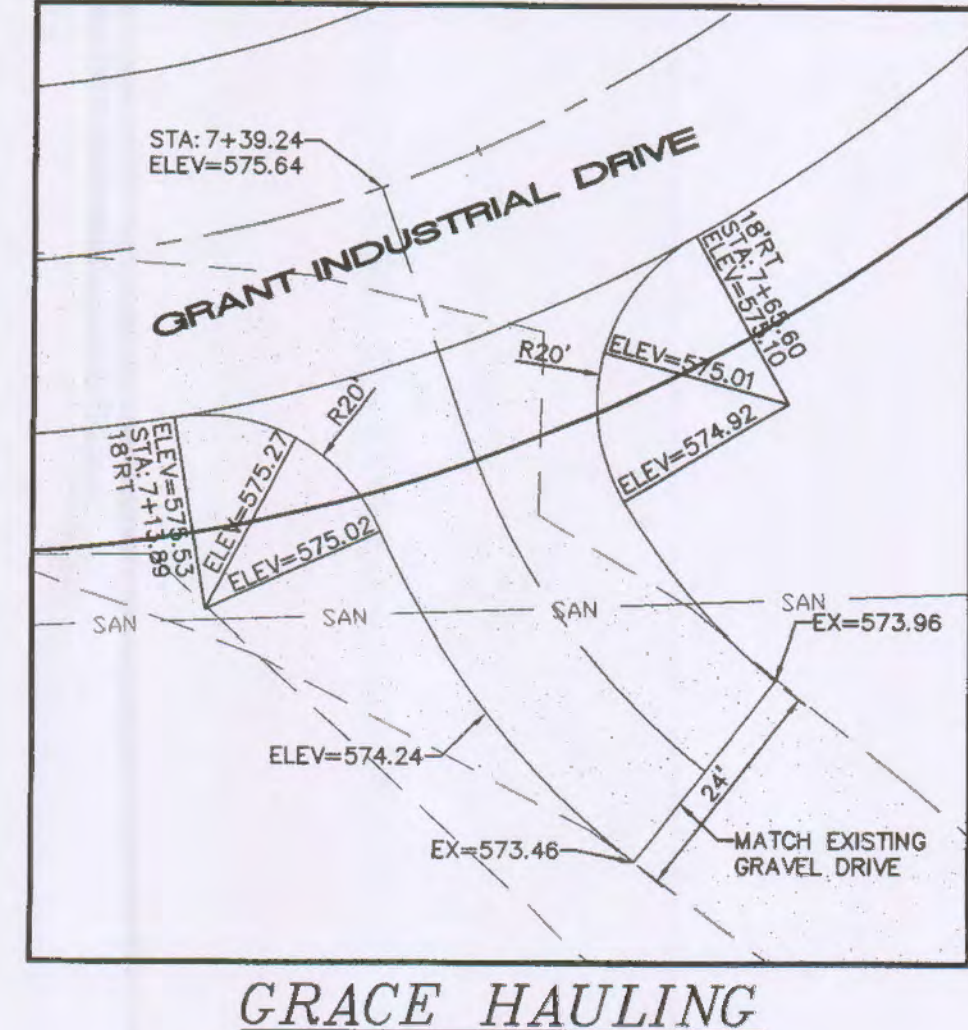

GRACE HAULING ENTRANCE DETAIL
 SCALE: 1" = 20'

Developer / Owner:
 MJSM, L.L.C.
 2209 DROSTE ROAD
 ST. CHARLES, MO 63301
 636-949-0680

P+Z No.
 #1407.05 & 1407.05.01
 Approved May 2, 2013

City No.
 #

Page No.
 7 of 11

PROFILES AND DETAILS

Bax Project #01-1692D Issue Date: 06/06/2018