

1 PLAN VIEW OF WALL 1
 SCALE: 1"=20'-0"
 NOTE: ANGLE POINTS MAY BE CONSTRUCTED AS RADII - SEE DETAIL 3/D2

THIS WALL PLAN IS INTENDED FOR GENERAL LOCATION PURPOSES ONLY. REFER TO PROJECT SITE PLANS FOR SPECIFIC DIMENSIONS.

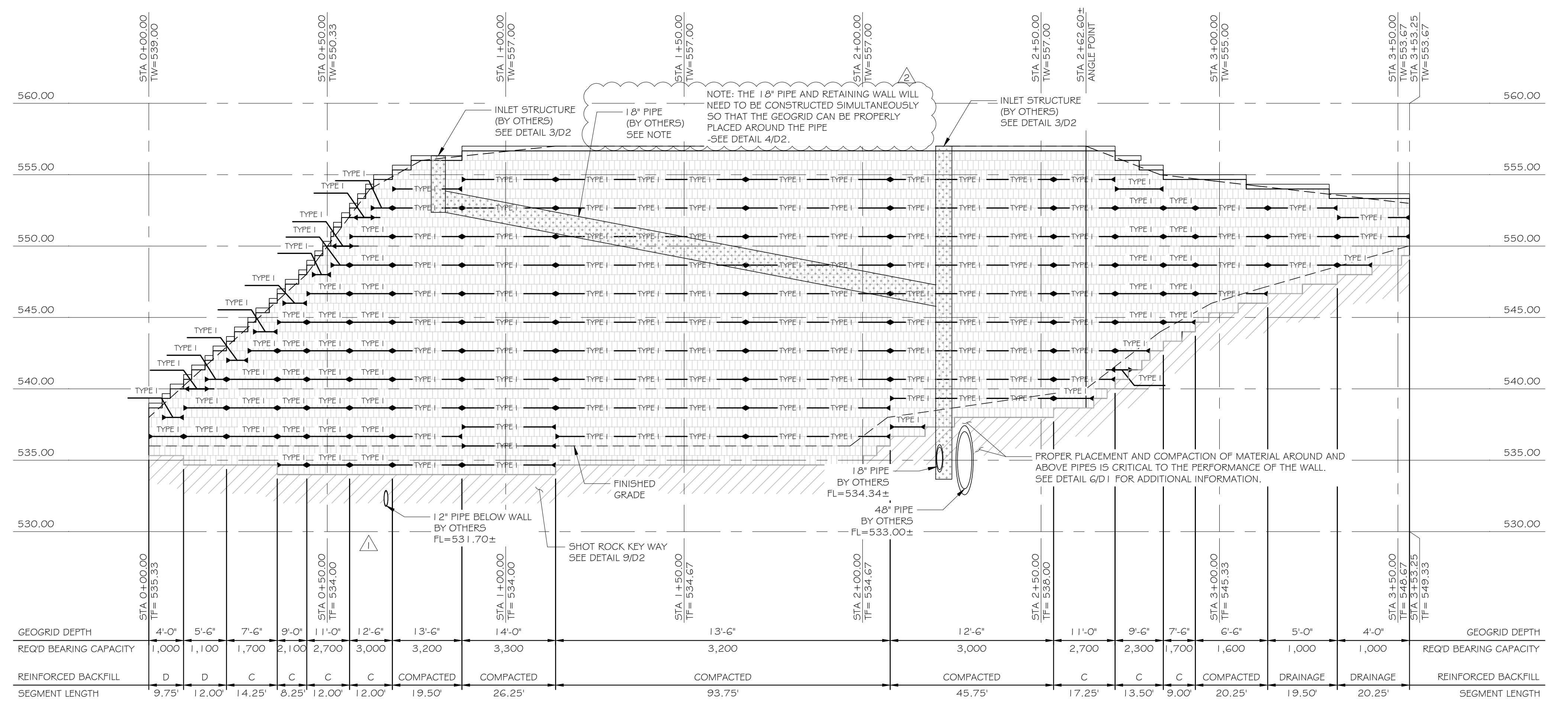

2 WALL 1 ELEVATION
 SCALE: 1"=20'-0" HORIZONTAL
 SCALE: 1"=5'-0" VERTICAL

NOTE: ACCORDING TO THE SCI GEOTECH REPORT NO. 2020-1191, I.O., TASK 300, THE ALLOWABLE BEARING CAPACITY IS 2,000 PSF. THE MAXIMUM BEARING PRESSURE IS 3,300 PSF - ADDITIONAL RECOMMENDATIONS REQUIRED PRIOR TO WALL CONSTRUCTION.

BLOCK PROPERTIES	
BLOCK TYPE	ANCHOR
BLOCK STYLE	DIAMOND PRO

ASSUMED DESIGN SOIL PARAMETERS			
	DESCRIPTION	Φ (DEGREES)	γ (PCF)
FOUNDATION SOIL	SHOT ROCK	45	135
RETAINED SOIL	LEAN CLAY	26	125
REINFORCED BACKFILL	VARIES*	34	105/130

*SEE NOTES FOR ADDITIONAL INFORMATION

STA 0+00 TO 2+00		
WALL PROPERTIES		
BACKSLOPE	-	H:V DEGREES
TOESLOPE	3:1	H:V DEGREES
BATTER	7.13	DEGREES
SETBACK	1.0	INCH
SURCHARGE		
DEAD LOAD	0	PSF
LIVE LOAD	100	PSF

STA 2+00 TO 3+53.25		
WALL PROPERTIES		
BACKSLOPE	-	H:V DEGREES
TOESLOPE	-	H:V DEGREES
BATTER	7.13	DEGREES
SETBACK	1.0	INCH
SURCHARGE		
DEAD LOAD	0	PSF
LIVE LOAD	100	PSF

- WALL ELEVATION NOTES:**
- GEOGRID DEPTH IS MEASURED FROM THE FRONT FACE OF BLOCK
 - SEGMENT LENGTH IS THE DISTANCE BETWEEN GRID DEPTH TRANSITIONS
 - REINFORCED BACKFILL
 - (D) DRAINAGE ROCK, SEE DETAIL 1/D1
 - (C) COMPACTED ROCK, SEE DETAIL 2/D1
 - REQ'D BEARING CAPACITY IS IN PSF

STORM PIPES, STORM STRUCTURES, LIGHT POLES BASES, ETC ARE SHOWN FOR INFORMATIONAL PURPOSES ONLY AND ARE BASED ON THE INFORMATION SHOWN ON THE PROJECT CIVIL PLANS REFERENCED IN GENERAL NOTE 1.4. REFER TO CURRENT PROJECT CIVIL PLANS FOR ALL SPECIFIC INFORMATION INCLUDING BUT NOT LIMITED TO SIZE AND LOCATION.

STRUCTURAL DESIGN HEREIN REPRESENTS A FINISHED STRUCTURE. THE GENERAL CONTRACTOR/OWNER SHALL PROVIDE ALL INTERIM BRACING, SHORING, INTERIM DRAINAGE PROVISIONS, DRAINAGE DIVERSION AND EROSION PROTECTION UNTIL FINAL CAPPING, PAVING, CURBING AND COMPLETION OF FINAL STORM DRAIN SYSTEM IS COMPLETE.

REV	DATE	DESCRIPTION
8-18-21		DESIGN REVISION
8-12-21		DESIGN REVISION

ROSCH ENGINEERING
 18390 WINGS CORPORATE DRIVE
 CHESTERFIELD, MO 63005
 PHONE: 636-519-7770
 FAX: 636-532-7773

NO. CERTIFICATE OF AUTHORITY #E-2012039653

PLANET FITNESS
 O'FALLON, MO
 RETAINING WALL
 ELEVATION # PLAN

DESIGNED:	BCS
DRAWN:	JTM
DESIGN ENGINEER:	JWH
REVIEWED:	BCS
DATE:	7-12-21
JOB NO.:	21-0530
SHEET:	PI

8-18-21