

**FLUSH CURB DETAIL**  
N.T.S.

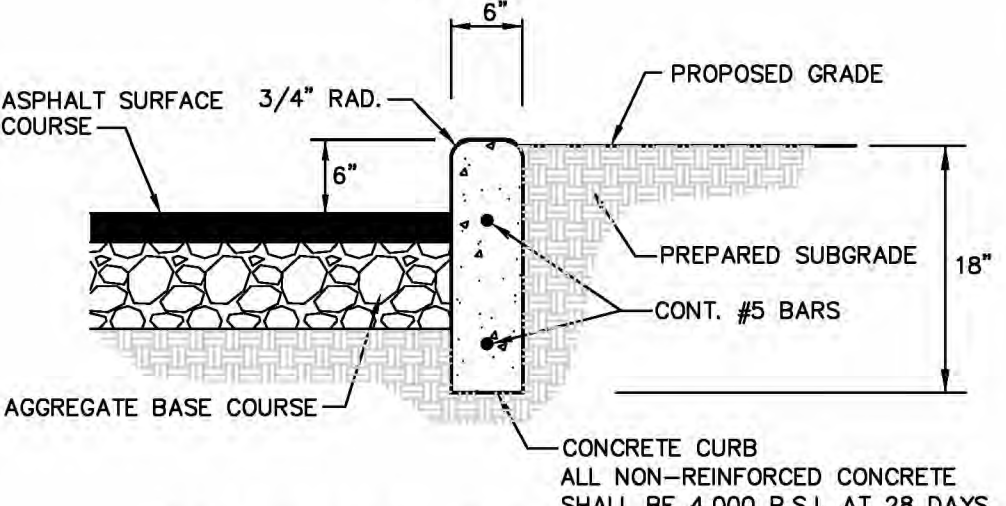

**6" VERTICAL CONCRETE CURB**  
N.T.S.

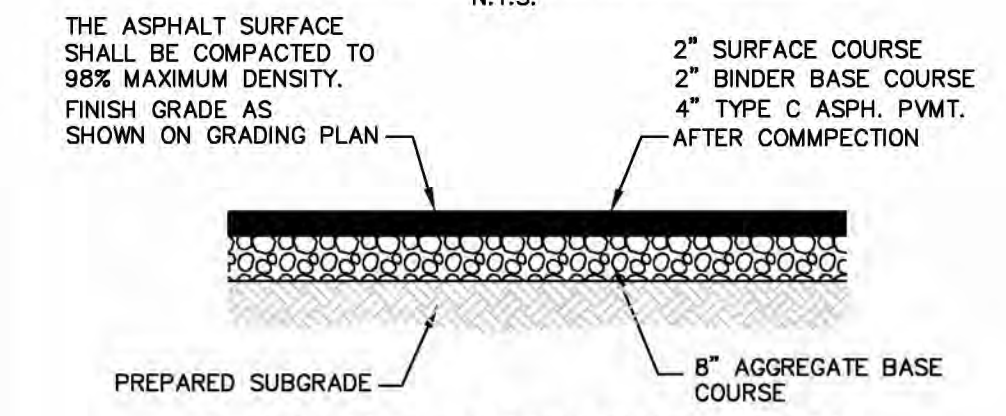

**ASPHALT PAVEMENT DETAIL**  
(FOR DRIVE ISLES ONLY)  
N.T.S.

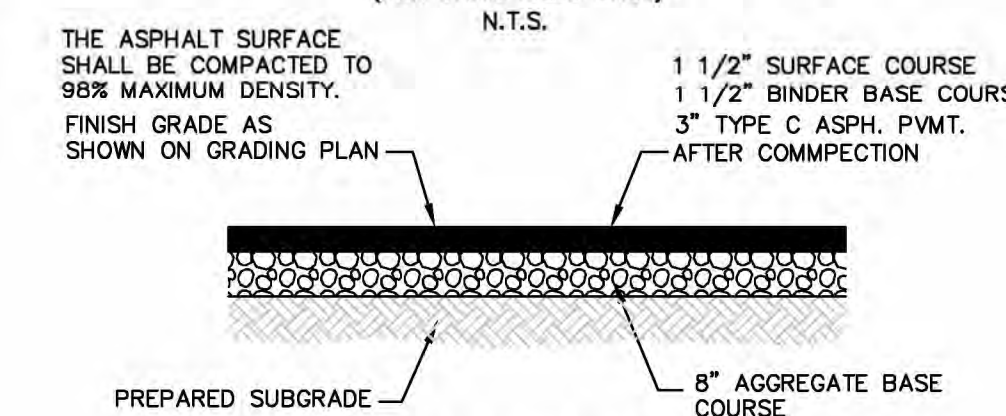

**ASPHALT PAVEMENT DETAIL**  
(FOR PARKING STALLS ONLY)  
N.T.S.

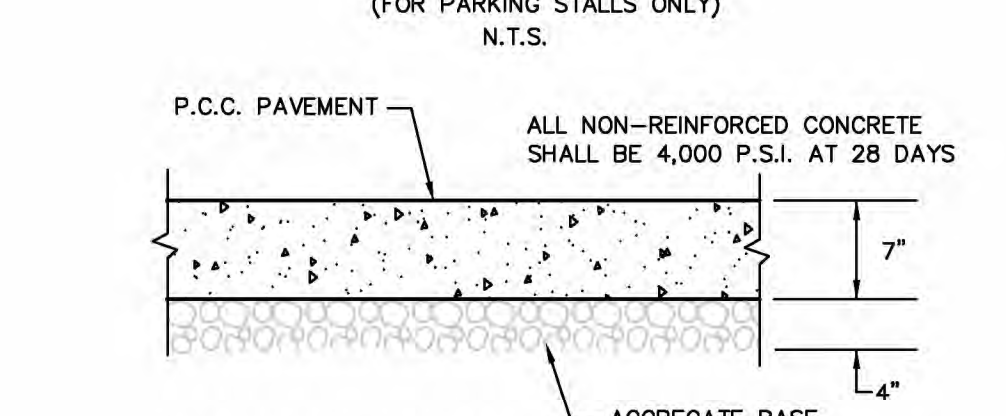

**CONCRETE PAVEMENT SECTION @ TRASH ENCLOSURE AND DRIVE THRU AISLE**  
N.T.S.

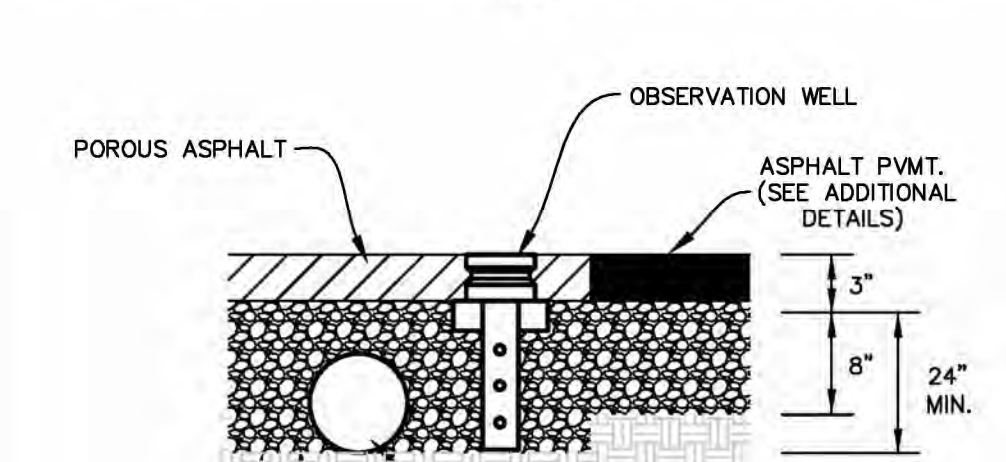

**POROUS ASPHALT PAVEMENT TYPICAL SECTION**  
N.T.S.

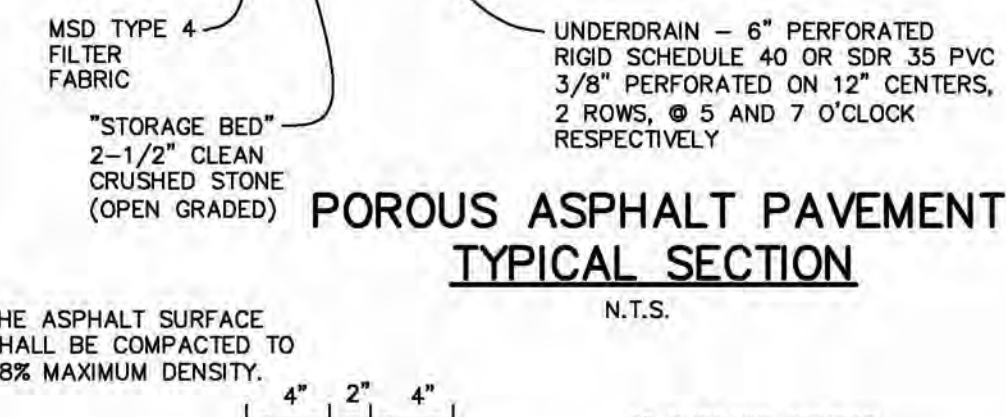

**DIVERSION BUMP**  
N.T.S.

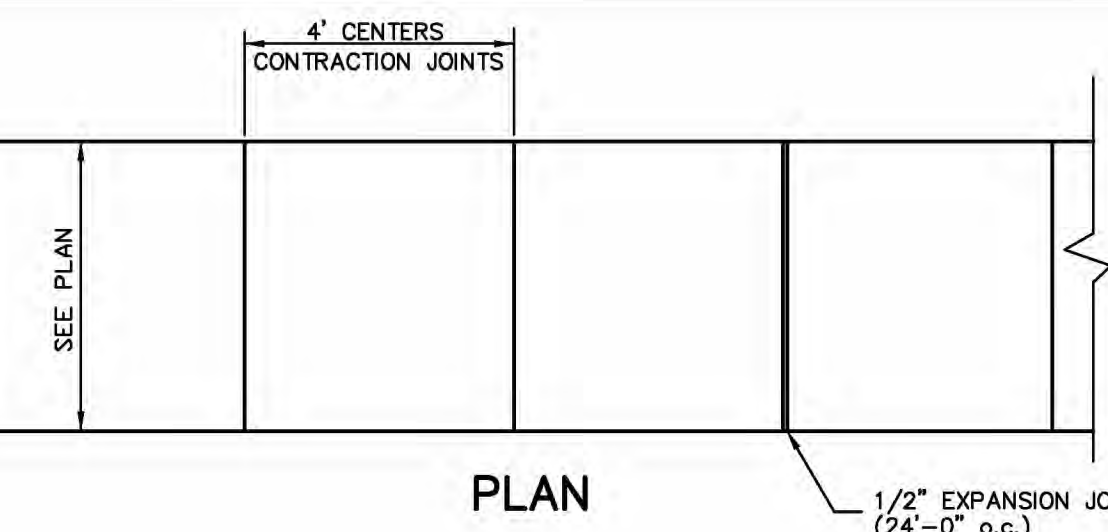
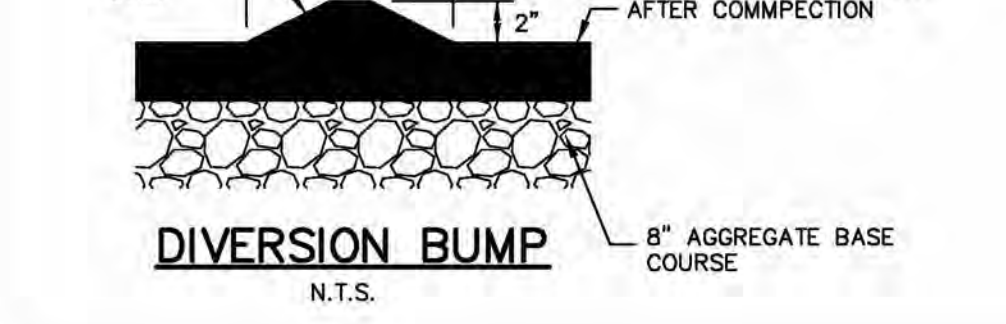

**PLAN**

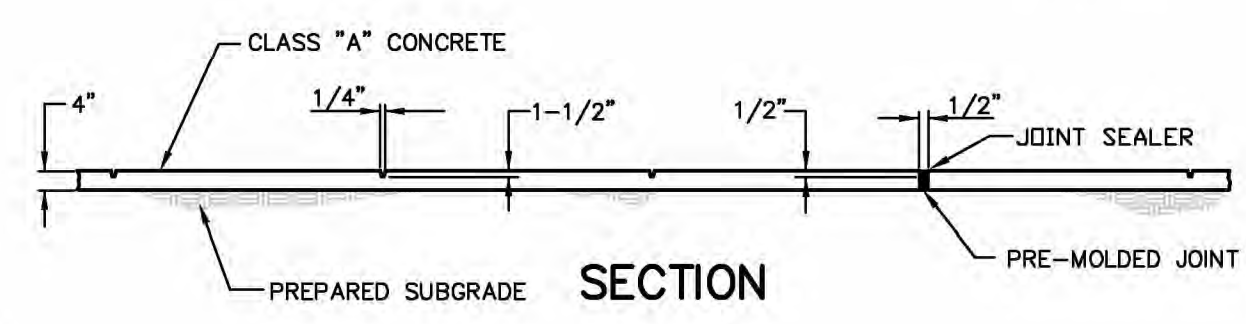

**SECTION**

**CONCRETE SIDEWALK DETAIL**  
N.T.S.

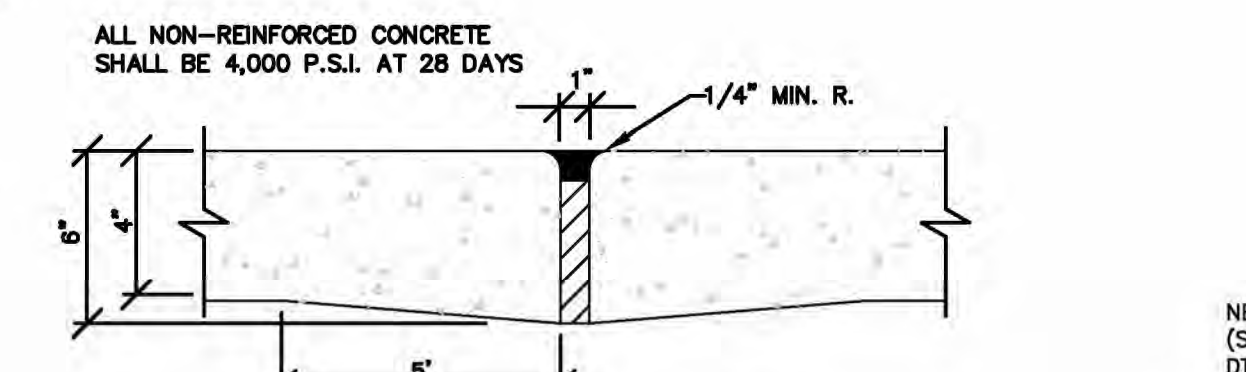

**TYPICAL EXPANSION JOINT TYPE A (4\"/>**

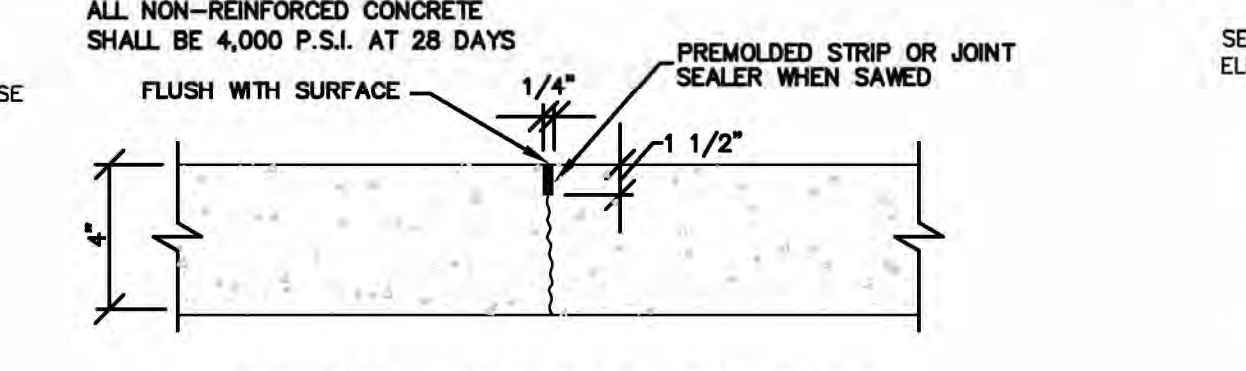

**TYPICAL CONSTRUCTION JOINT TYPE C (4\"/>**

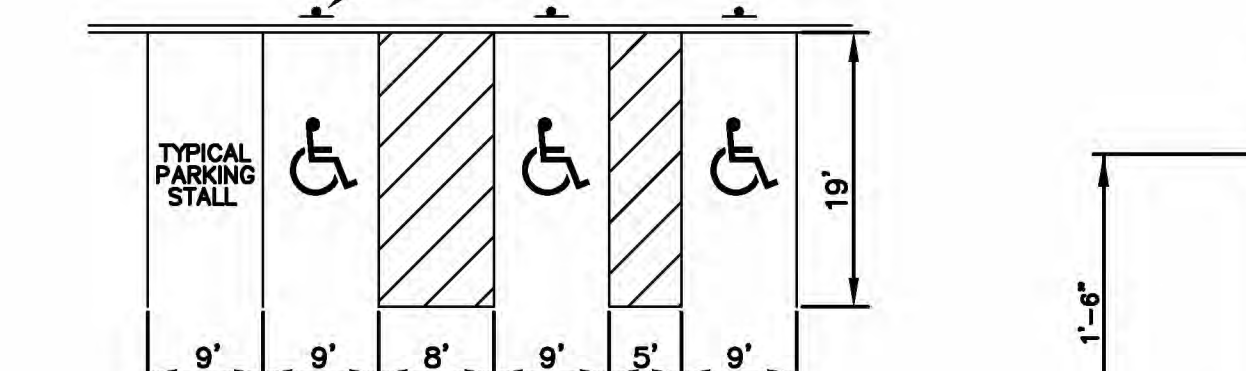

**TYPICAL PARKING SPACE**  
N.T.S.

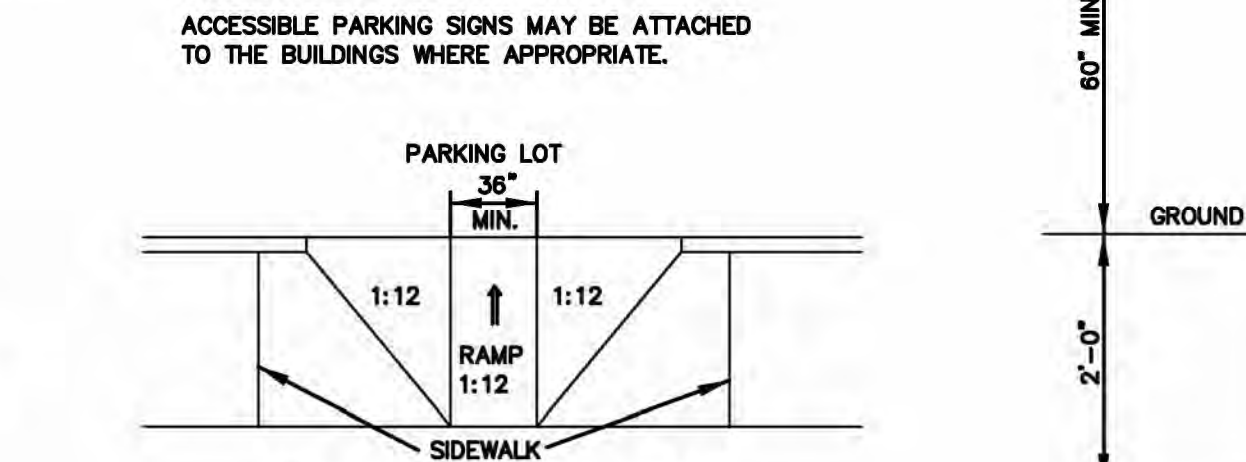

**CURB RAMP DETAIL**  
N.T.S.

- NOTE:**
1. THERE SHALL BE NO STEP AT BUILDING ENTRANCES.
  2. THERE SHALL BE WHEELCHAIR RAMPS OR DROP CURBS AT ACCESSIBLE SPACES.
  3. CURB RAMP SHALL BE MINIMUM 36" WIDE, MAXIMUM SLOPE OF RAMP 1:12, MAXIMUM SLOPE OF FLARES 1:12.
  4. ALL TURNING RADIUS WORK.

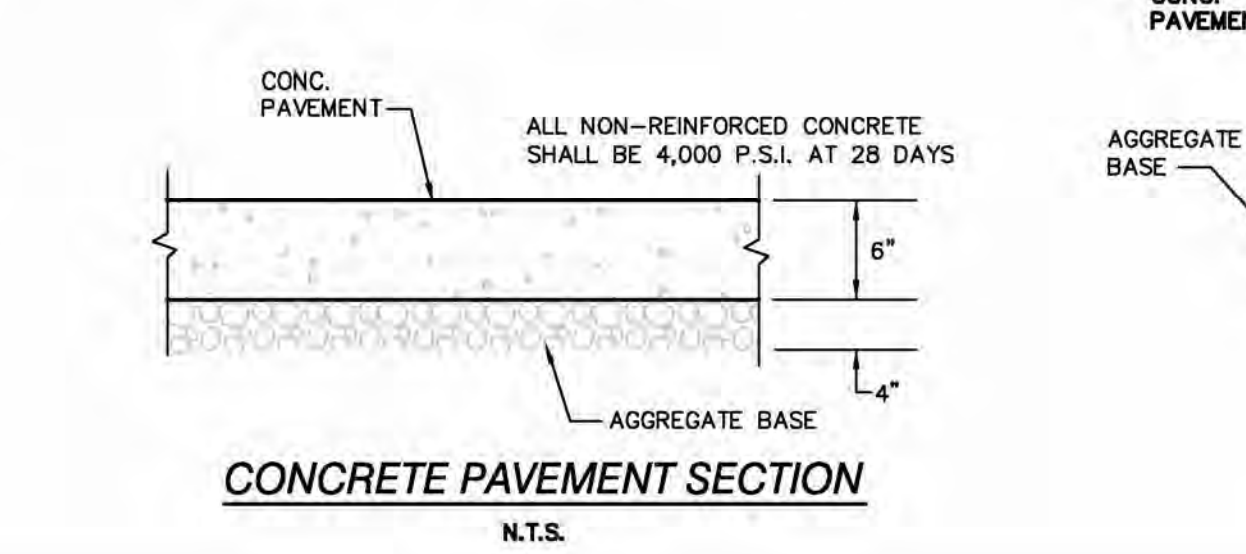

**CONCRETE PAVEMENT SECTION**  
N.T.S.

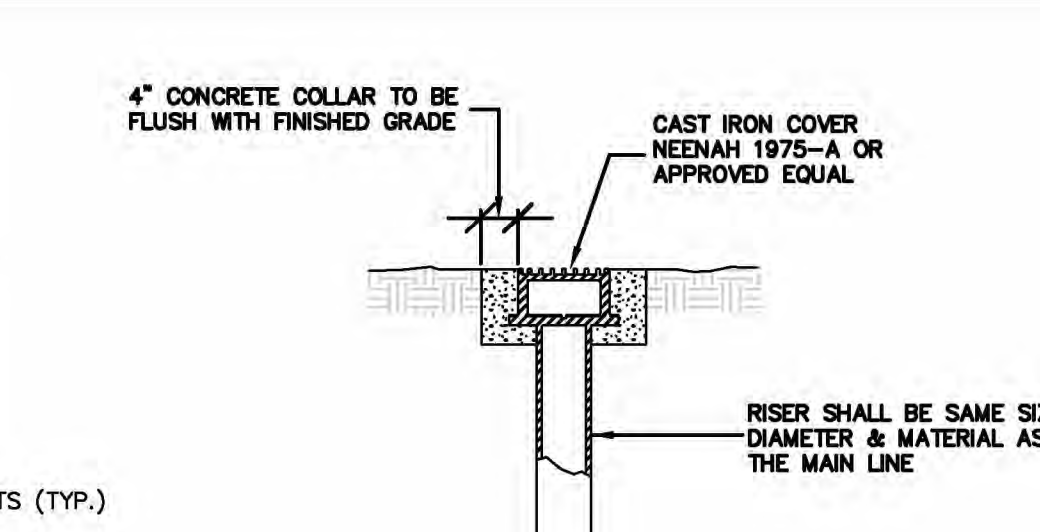

**CLEAN OUT DETAIL (SANITARY SEWER ONLY)**  
N.T.S.

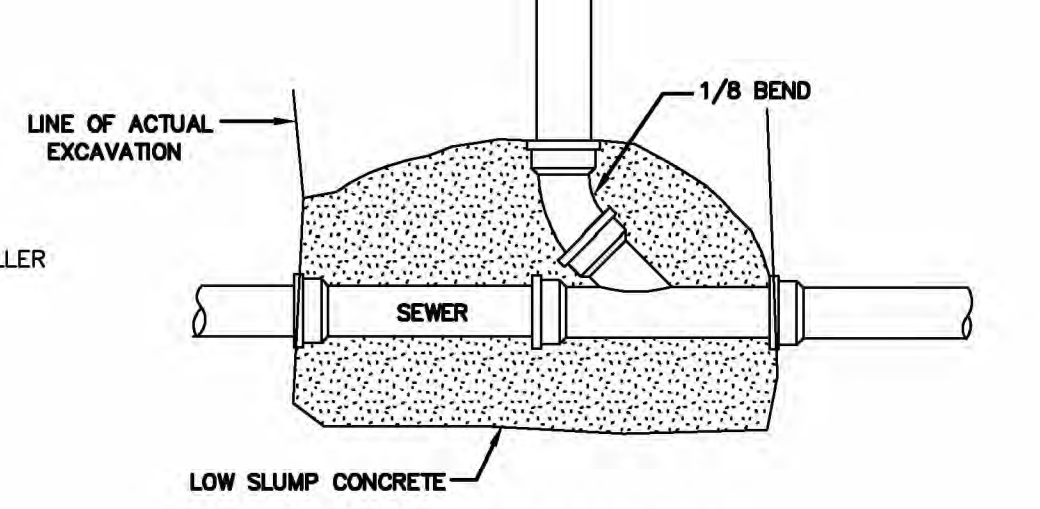

**SITE LIGHTING POLE BASE DETAIL**  
ALL LIGHT POLES ON SITE (EXCEPT IN PRETREATMENT B)  
N.T.S.

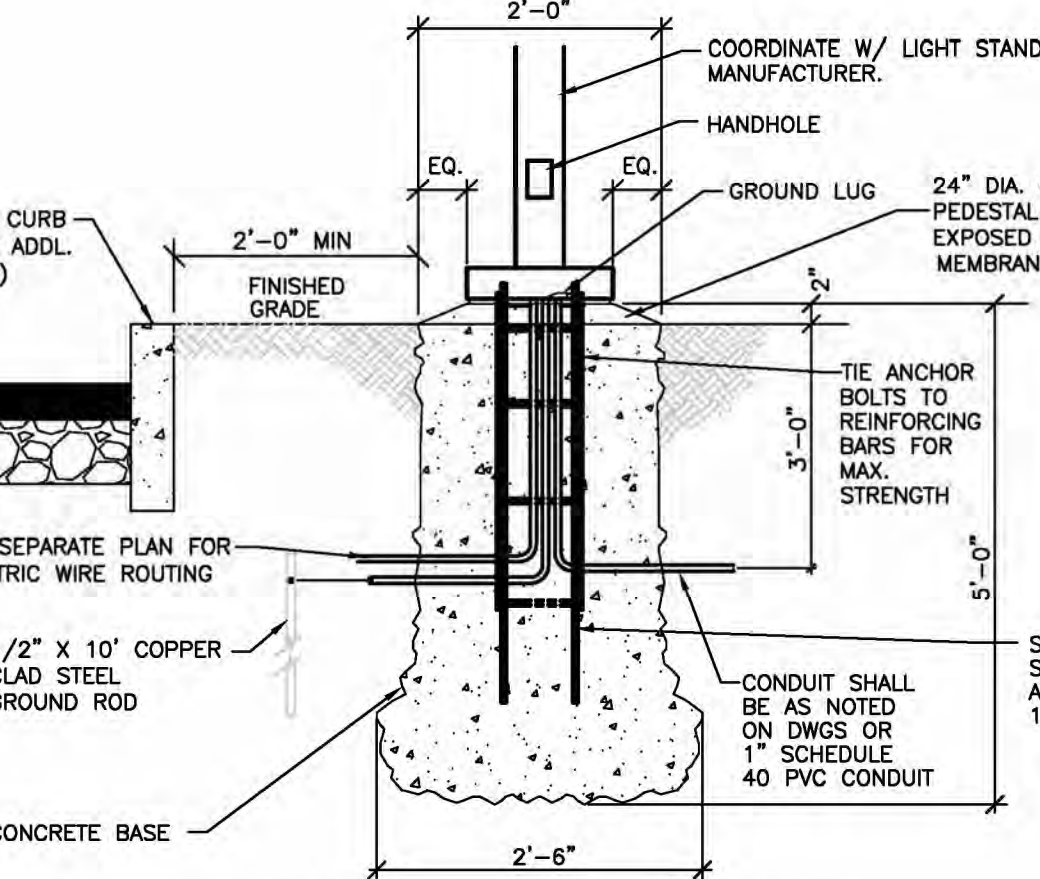

**ACCESSIBLE PARKING SIGN**  
N.T.S.



**THICKENED SLAB DETAIL**  
N.T.S.

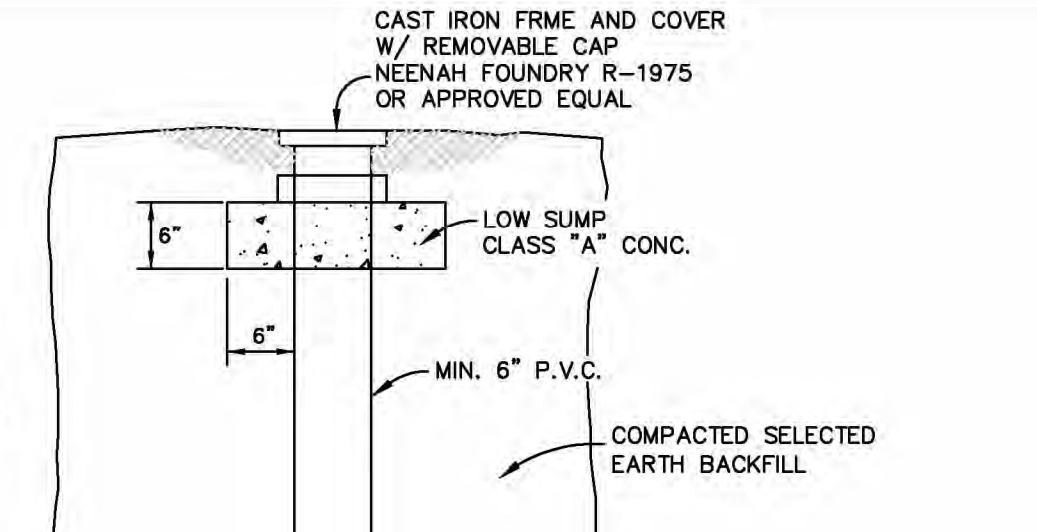

**SAMPLE TEE**  
N.T.S.

**PERVIOUS INTERLOCKING CONCRETE PAVEMENT**

POWER WASHING, RESURFACING, AND THE USE OF SAND ABRASIVES FOR WINTER TIRE TRACKING ARE PROHIBITED.

CARE SHALL BE TAKEN DURING SNOW PLOWING.

**PICP INFORMATION SIGN**  
(NOT TO SCALE)

- NOTES:**
1. STANDARD 18" X 12" X 0.08" ALUMINUM SIGN FACE WITH BLACK TEXT ON WHITE BACKGROUND GALVANIZED STEEL POST 9'-0" LONG.
  2. SET BOTTOM OF SIGN 5'-0" ABOVE GRADE.
  3. SET BOTTOM OF POST 3'-0" BELOW GRADE.

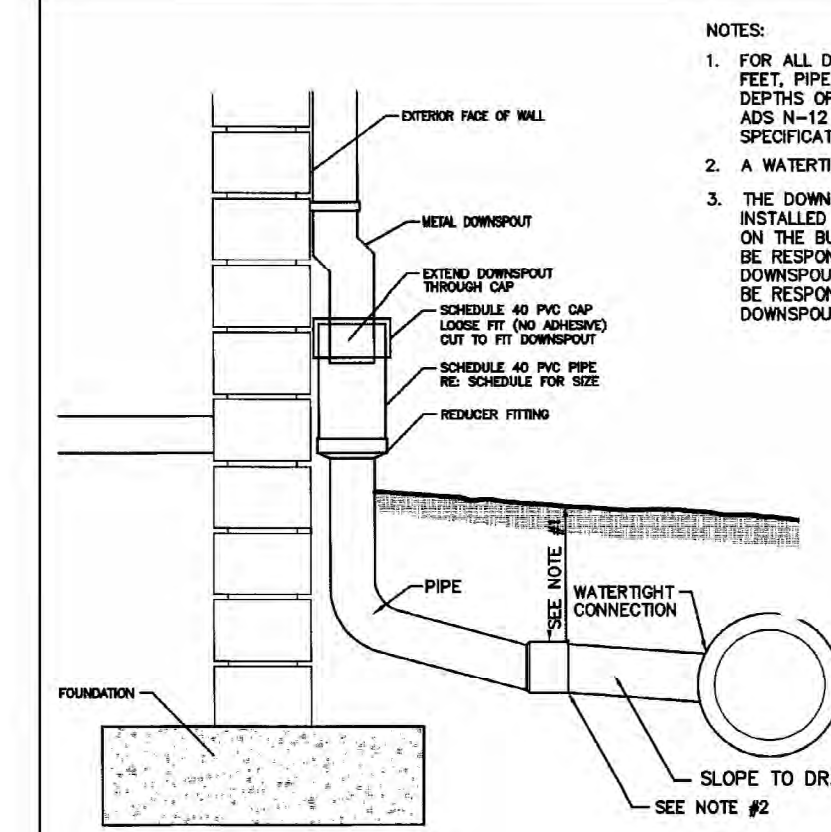

**DOWNSPOUT COLLECTOR DETAIL**  
NO SCALE

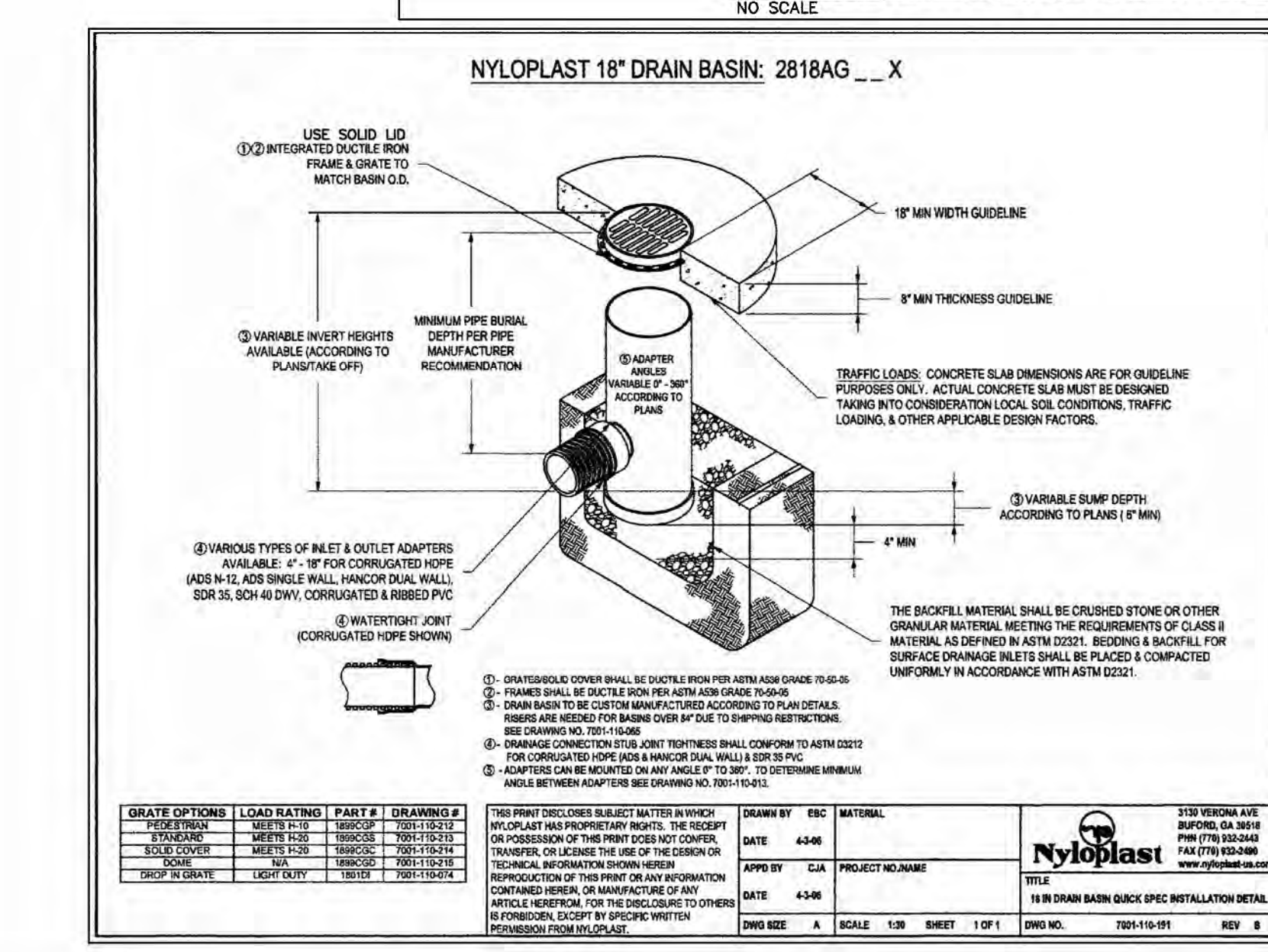

DATE	BY	DESCRIPTION
02/17/16	ESB	ISSUED FOR PERMIT
02/17/16	ESB	ISSUED FOR PERMIT
02/17/16	ESB	ISSUED FOR PERMIT
02/17/16	ESB	ISSUED FOR PERMIT
02/17/16	ESB	ISSUED FOR PERMIT
02/17/16	ESB	ISSUED FOR PERMIT
02/17/16	ESB	ISSUED FOR PERMIT
02/17/16	ESB	ISSUED FOR PERMIT
02/17/16	ESB	ISSUED FOR PERMIT
02/17/16	ESB	ISSUED FOR PERMIT

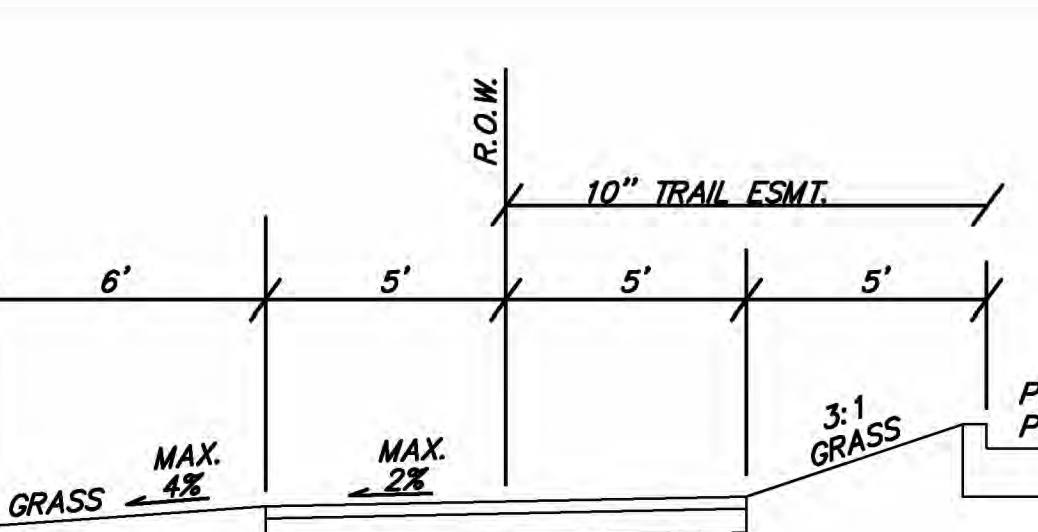

**TRAIL DETAIL**  
SCALE: 1"=4'

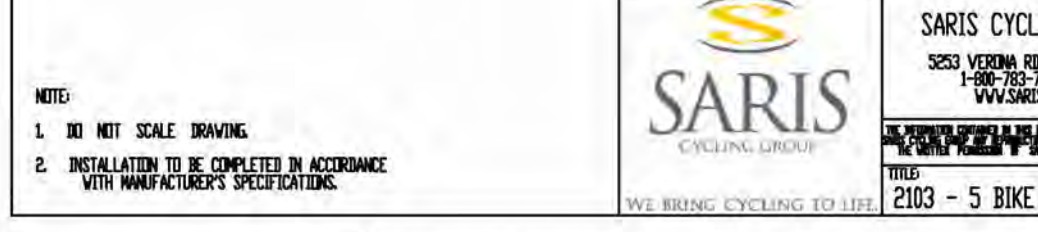
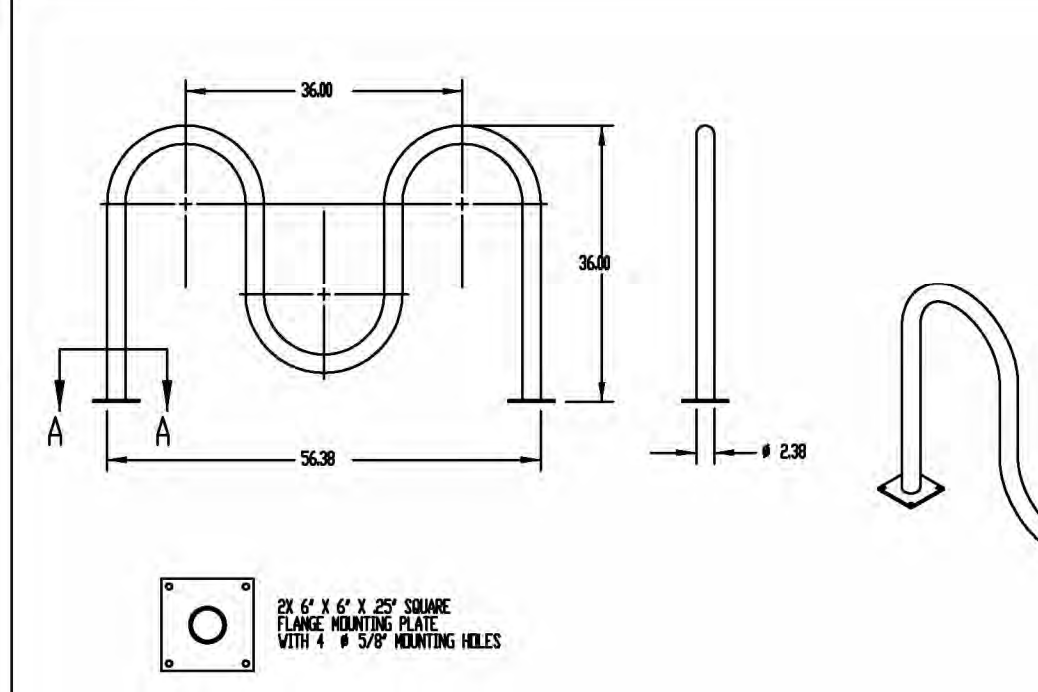

**TYPICAL EXPANSION JOINT TYPE A (4\"/>**

**TYPICAL CONSTRUCTION JOINT TYPE C (4\"/>**

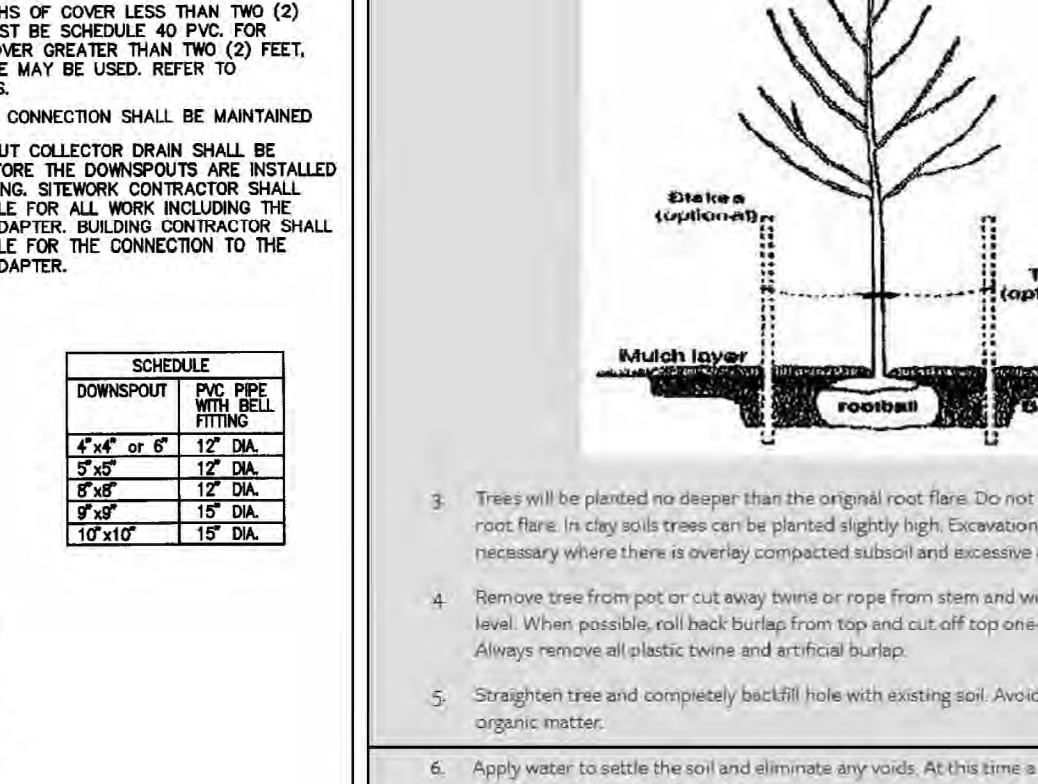

**TREE PLANTING DETAIL**  
N.T.S.

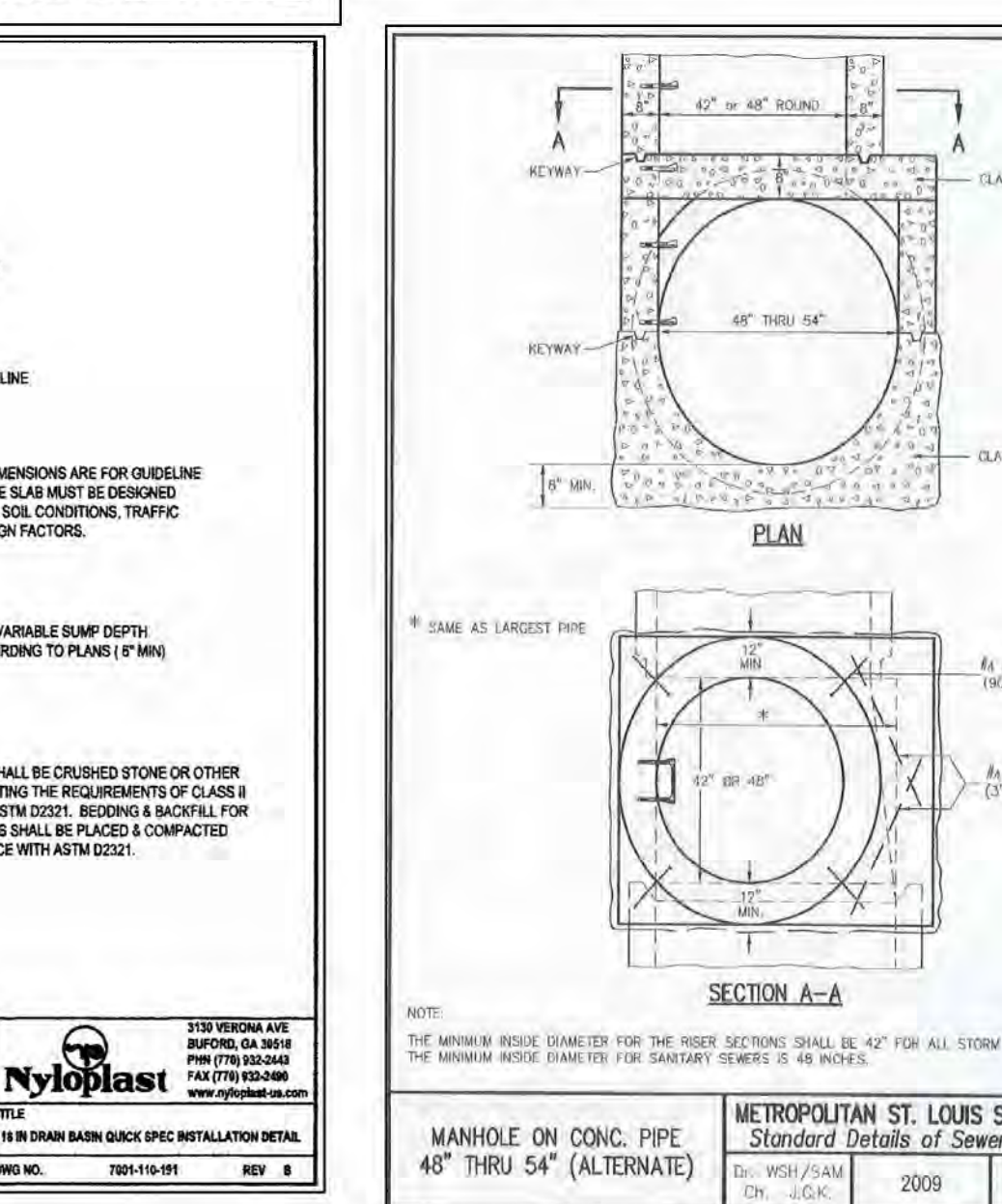

DATE	BY	DESCRIPTION
02/17/16	ESB	ISSUED FOR PERMIT
02/17/16	ESB	ISSUED FOR PERMIT
02/17/16	ESB	ISSUED FOR PERMIT
02/17/16	ESB	ISSUED FOR PERMIT
02/17/16	ESB	ISSUED FOR PERMIT
02/17/16	ESB	ISSUED FOR PERMIT
02/17/16	ESB	ISSUED FOR PERMIT
02/17/16	ESB	ISSUED FOR PERMIT
02/17/16	ESB	ISSUED FOR PERMIT
02/17/16	ESB	ISSUED FOR PERMIT

REVISED	DATE	BY	DESCRIPTION
1	2/17/16	ESB	ISSUED FOR PERMIT
2	2/23/16	ESB	ISSUED FOR PERMIT
3	4/7/16	ESB	ISSUED FOR PERMIT
4	5/12/16	ESB	ISSUED FOR PERMIT
5	6/13/16	ESB	ISSUED FOR PERMIT
6	7/17/16	ESB	ISSUED FOR PERMIT
7	10/3/16	ESB	ISSUED FOR PERMIT

Missouri Office  
5600 Grimm Rd.  
St. Louis, MO 63112  
Telephone: (314) 452-0210  
Fax: (314) 845-1718

**DOERING ENGINEERING**  
INC.  
CIVIL ENGINEERING • PLANNING • SURVEYING

Seal

STATE OF MISSOURI  
Professional Engineer  
Mark A. Doering  
10/3/16  
PE-23059

MARK A. DOERING  
CIVIL ENGINEER E-23059  
10/3/16  
EXPIRATION DATE:  
DECEMBER 31 2014  
IL EXPIRATION DATE:  
DECEMBER 31 2013  
MO. CORPORATE  
LICENSE NO. 001347  
IL. CORPORATE  
LICENSE NO. 184.003035

PLAZA TIRE  
1000 N MAIN ST.  
O'FALLON, MO 63366  
DETAILS

Date: 2/17/16	Project Number: 5030
File Name: 15030CD	Drawn By: JAB
Check By: MAD	Sheet
	C9