

STORM SEWER PROFILE
 HORIZONTAL SCALE: 1"=30'
 VERTICAL SCALE: 1"=10'

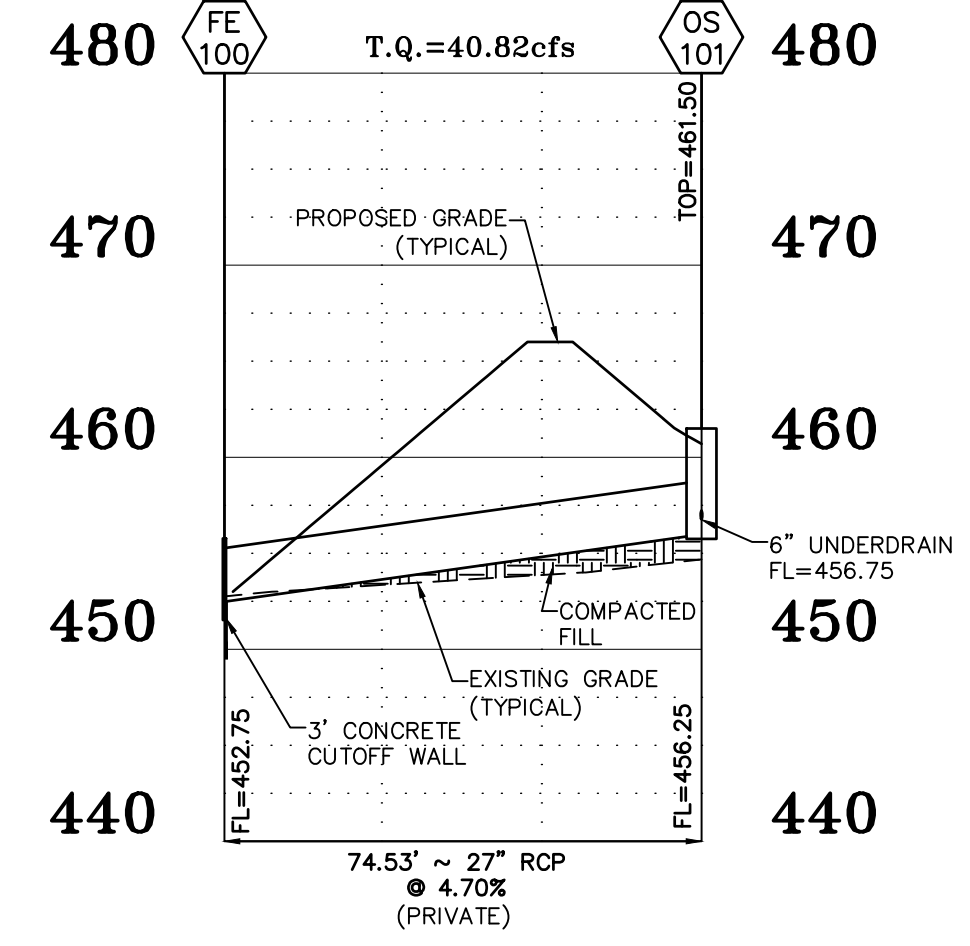

STORM SEWER PROFILE
 HORIZONTAL SCALE: 1"=30'
 VERTICAL SCALE: 1"=10'

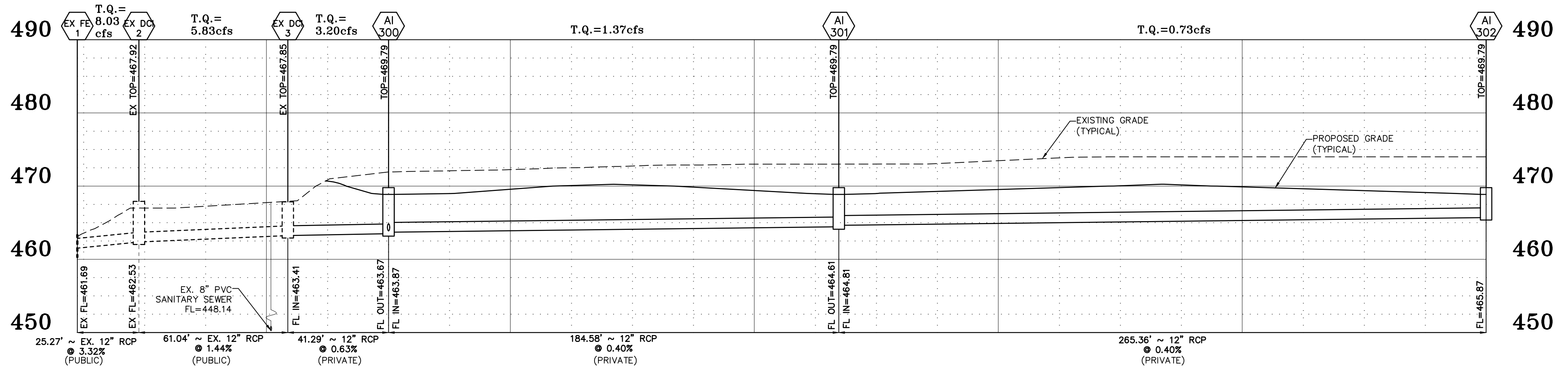

STORM SEWER PROFILE
 HORIZONTAL SCALE: 1"=30'
 VERTICAL SCALE: 1"=10'

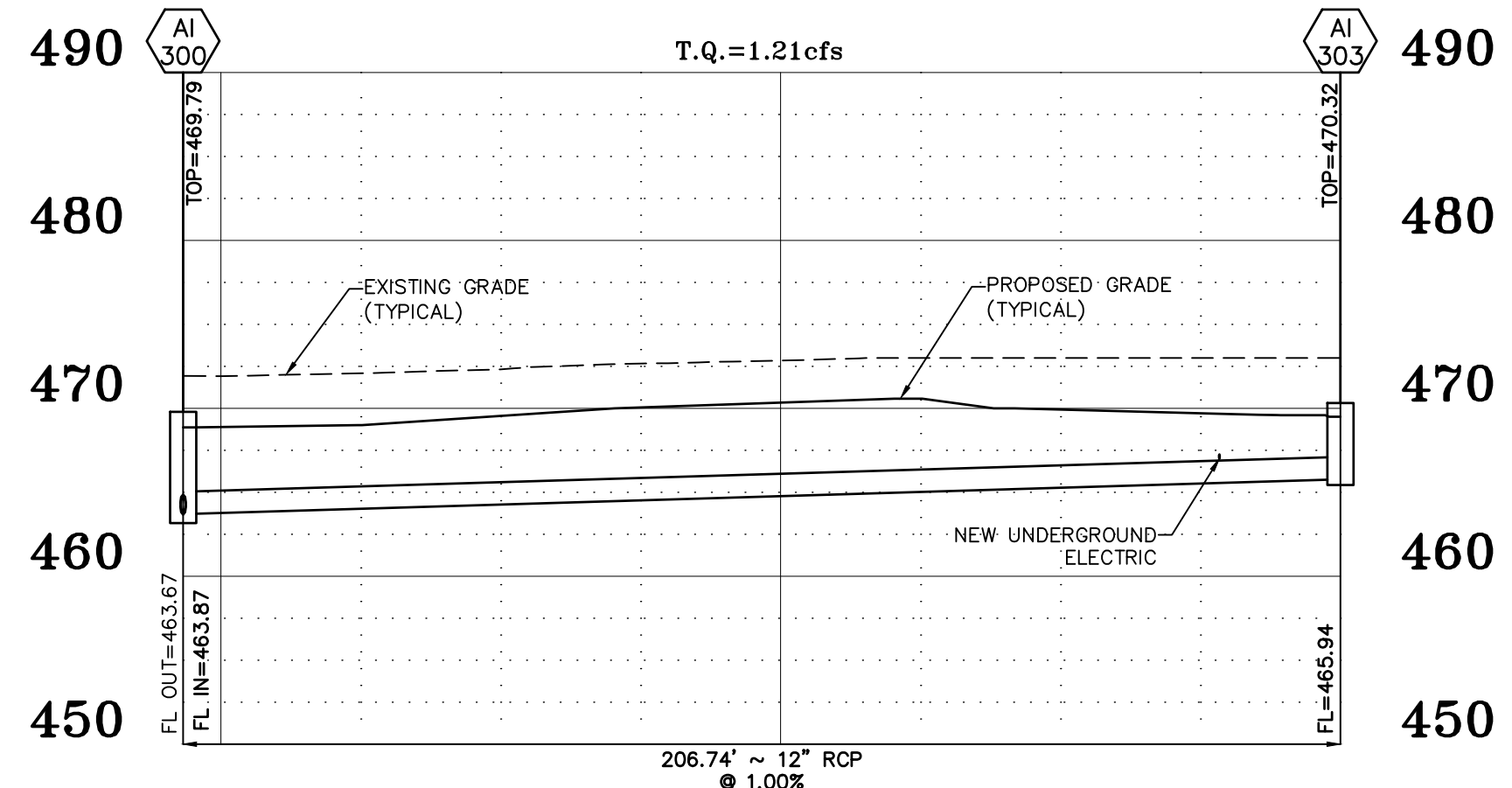

STORM SEWER PROFILE
 HORIZONTAL SCALE: 1"=30'
 VERTICAL SCALE: 1"=10'

BAX PROJECT NAME :
 BAX PROJECT NO. :
 DESIGN DATE :
 DESIGNED BY :
 SUBMITTED: FILENAME: 17337

UPP STR	LOW STR	L	DIA	FL LN	LOWER FL LN	PS	ST EL	HY GR	HY EL	HY EL	GRADE	HEAD	VEL	HEAD	LOSS	LOSS	LOSS	LOSS	GRADE	CAP	AREA	PI	Q	TQ	CAP	NUMBER	REMARKS
CI205	CI204	37	15	465.16	464.89	0.74	469.87	3.53	466.34*	466.14	.00250	0.09	2.62	0.11	0.11	0.00	0.00	0.00	0.00	0.00	0.00	0.00	0.00	3.21	5.56	1	
CI204	CI203	80	15	464.69	464.09	0.75	469.87	4.16	465.71*	465.34	.00370	0.29	3.19	0.16	0.08	0.02	0.00	0.00	0.00	0.00	0.00	0.00	0.00	3.92	5.60	2	
CI203	CI202	181	18	463.89	462.53	0.75	469.68	4.34	465.34*	464.36	.00430	0.78	3.90	0.24	0.20	0.09	0.00	0.00	0.00	0.00	0.00	0.00	0.00	6.90	9.10	3	
CI202	CI201	98	18	462.33	461.60	0.75	469.95	5.59	464.36*	463.45	.00710	0.70	5.02	0.39	0.21	0.01	0.00	0.00	0.00	0.00	0.00	0.00	0.00	8.87	9.09	4	
CI201	FE200	332	24	461.40	459.00	0.72	470.30	6.85	463.45	462.19	.00370	1.22	4.36	0.29	0.04	0.00	0.00	0.00	0.00	0.00	0.00	0.00	0.00	13.69	19.23	5	
**AI303	AI300	207	12	465.94	463.87	1.00	470.50	2.05	468.45	468.17	.00120	0.24	1.54	0.04	0.04	0.00	0.00	0.00	0.00	0.00	0.00	0.00	0.00	1.21	3.57	6	
**AI302	AI301	265	12	465.87	464.81	0.40	471.00	2.40	468.60	468.48	.00040	0.11	0.93	0.01	0.01	0.00	0.00	0.00	0.00	0.00	0.00	0.00	0.00	0.73	2.25	7	
**AI301	AI300	185	12	464.61	463.87	0.40	471.00	2.52	468.48	468.17	.00150	0.27	1.74	0.05	0.04	0.00	0.00	0.00	0.00	0.00	0.00	0.00	0.00	1.37	2.26	8	
**AI300	EXDC3	41	12	463.67	463.41	0.63	470.50	2.33	468.17	467.59	.00810	0.33	4.07	0.26	0.25	0.06	0.00	0.00	0.00	0.00	0.00	0.00	0.00	3.20	2.83	9	
EXDC3	EXDC2	61	12	463.41	462.53	1.44	467.85	0.26	467.59	465.24	.02680	1.63	7.42	0.86	0.72	0.00	0.00	0.00	0.00	0.00	0.00	0.00	0.00	5.83	4.28	10	
EXDC2	EXFE1	25	12	462.53	461.69	3.32	467.92	2.68	465.24	462.69	.05080	1.28	10.22	1.62	1.27	0.38	0.00	0.00	0.00	0.00	0.00	0.00	0.00	8.03	6.50	11	
OS101	FE100	75	27	456.25	452.75	4.70	461.50	-0.43	461.93	459.00	.01740	1.29	10.27	1.64	1.64	0.00	0.00	0.00	0.00	0.00	0.00	0.00	0.00	40.82	67.11	12	

* INDICATES CRITICAL DEPTH
 ** AREA INLETS IN SUMP, USING LOWEST ELEVATION AT TOP OF SUMP FOR STRUCTURE TOPS

PROJECT TITLE:
 POINT WEST PROPERTIES LLC
 601 PEARL DR.
 ST. PETERS MO. 63376
 Issue Date: 3/6/2019

ENGINEERING PLANNING SURVEYING
 221 Point West Blvd.
 St. Charles, MO 63301
 636-928-5552
 FAX 636-928-1718



DISCLAIMER OF RESPONSIBILITY
 I hereby certify that the documents intended to be authorized by my seal are limited to this sheet, and I hereby disclaim any responsibility for all other Drawings, Specifications, Estimates, Reports or other documents or instruments relating to or intended to be used for any project, whether or not the architectural or engineering project was prepared by me.
 CLIFFORD L. HEITMANN
 NUMBER E-29317
 CIVIL ENGINEER
 E29817
 Copyright 2019
 Bax Engineering Company, Inc.
 Engineering Authority No. 000655
 Surveying Authority No. 000144
 All Rights Reserved

REVISIONS

3-19-19	CITY COMMENTS
4-2-19	C.C.F.R. COMMENTS
5-1-19	CITY COMMENTS

Developer / Owner:
 POINT WEST PROPERTIES LLC
 103 ENTERPRISE DRIVE
 WENTZVILLE, MO 63385
 636-327-5575
STORM PROFILES

P+Z No. # 18-006296
Approval Date: Aug. 2, 2018
City No. #

Page No.
 8 of 20

CALL BEFORE YOU DIG!
 1-800-DIG-RITE
 *FIBER OPTICS ARE PRESENT

UNDERGROUND UTILITIES HAVE BEEN PLOTTED FROM AVAILABLE INFORMATION AND THEREFORE THEIR LOCATIONS SHALL BE CONSIDERED APPROXIMATE ONLY. THE VERIFICATION OF THE LOCATION OF ALL UNDERGROUND UTILITIES, EITHER SHOWN OR NOT SHOWN ON THESE PLANS SHALL BE THE RESPONSIBILITY OF THE CONTRACTOR, AND SHALL BE LOCATED PRIOR TO ANY GRADING OR CONSTRUCTION OF THE IMPROVEMENTS.