

THE POINTE AT WINGHAVEN SUBDIVISION AND FACILITIES FOR SOUTHWEST BANK AND PROFESSIONAL RESOURCE DEVELOPMENT

A TRACT OF LAND BEING PART OF
U.S. SURVEY 1669, TOWNSHIP 46 NORTH, RANGE 2 EAST OF THE 5TH PRINCIPAL MERIDIAN
ST. CHARLES COUNTY, MISSOURI

IMPROVEMENT PLANS

LEGEND

EXISTING CONTOURS	
PROPOSED CONTOURS	
EXISTING SANITARY SEWERS	
EXISTING STORM SEWERS	
PROPOSED SANITARY SEWERS	
PROPOSED STORM SEWERS	
EXISTING RIGHT-OF-WAY	
PROPOSED RIGHT-OF-WAY	
CENTERLINE	
EASEMENT	
NON-REINFORCED CONCRETE PAVEMENT	
EXISTING SPOT ELEVATION	
PROPOSED SPOT ELEVATION	
SWALE	
TO BE REMOVED	
TO BE REMOVED & RELOCATED	
TO BE USED IN PLACE	
BACK OF CURB	
FACE OF CURB	
TRASH ENCLOSURE	
LIGHT STANDARD	
GAS MAIN	
WATER MAIN	
UNDERGROUND TELEPHONE	
FIRE HYDRANT	
POWER POLE	
HAY BALE	
SILTATION CONTROL	
PROPOSED	

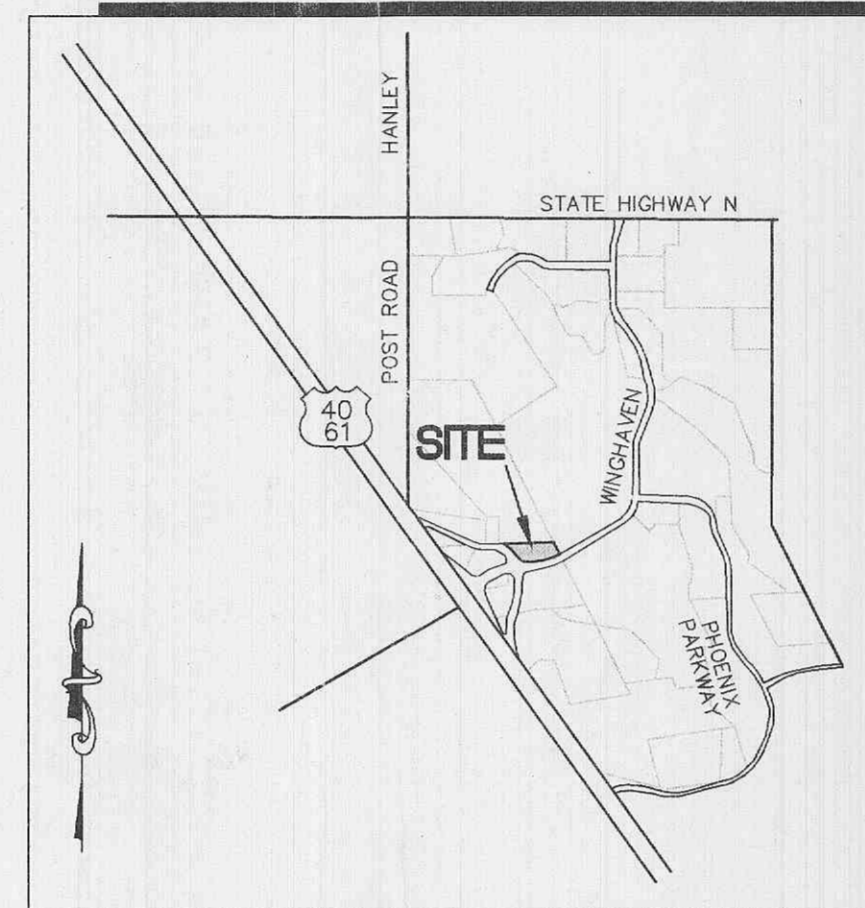

LOCATION MAP
NOT TO SCALE

PERTINENT DATA

OWNER	- THE SLOBODAN ILIJEVSKI TRUST AND THE LINDA ILIJEVSKI TRUST
ZONING	- HTCD/PUD (ORIGINAL ZONING-HTCD)
SITE ACREAGE	- 4.52 ± Acres
SITE ADDRESS	- LOT A: 3001 WINGHAVEN BOULEVARD - LOT B: 3009, 3011, 3013, 3015 WINGHAVEN BOULEVARD - LOT C: 3019-3037 WINGHAVEN BOULEVARD - OFALLON, MISSOURI 63366
DEED BOOK	- DB. 2478 Pg. 109
PARCEL ID#	- 4-0047-5614-00-11
FIRM MAP	- 29183C0240 E (REVISED AUGUST 2, 1996)
WUNNENBERG'S	- PG. 45, GRID W-20
CITY ENGINEER	- CITY OF OFALLON 100 NORTH MAIN ST. OFALLON, MO 63366 ATTN: MR. FRANK GODWIN, P.E., SR. PLAN REVIEW ENGINEER PHONE: (636) 379-5560 FAX: (636) 978-4444 fgodwin@ofallonmo.us
ELECTRIC SERVICE	- AmerenUE ELECTRIC COMPANY 200 CALLAHAN RD. WENTZVILLE, MO 63385 ATTN: MR. DAVID GRAVIETT PHONE: (636) 639-8315 dgraviett@ameren.com
FIRE DISTRICT	- OFALLON FIRE PROTECTION DISTRICT 209 WEST PEARCE BLVD. WENTZVILLE, MO 63385 ATTN: MR. JOSEPH F. HEITKAMP PHONE: (636) 327-6239
GAS SERVICE	- LACLEDE GAS COMPANY 1899 TRADE CENTER EAST ST. PETERS, MO 63376 ATTN: MR. MIKE LANGAN PHONE: (636) 978-2663 ext. 103
MoDOT	- MISSOURI DEPARTMENT OF TRANSPORTATION 6780 OLD HIGHWAY N ST. CHARLES, MO 63604 ATTN: MR. SCOTTY D. WARD, SR. TRAFFIC TECHNICIAN PHONE: (314) 340-4334 FAX: (314) 340-4119 scotty.ward@modotmo.gov
PHONE SERVICE	- CENTURY-TEL TELEPHONE 1151 CENTURY TEL DR. P.O. BOX 751 WENTZVILLE, MO 63385 ATTN: MR. CARL OWENS PHONE: (636) 332-7392
PROJ. GEOTECHNICAL ENGINEER	- GEOTECHNOLOGY, INC. (314)-997-7440, Fax (314) 997-2067 2258 GREGGSON DR. ST. LOUIS, MO 63146 ATTN: JEFFERY P. KLEIN, P.E. PROJECT MGR. PHONE: (314)-997-7440 FAX: (314) 997-2067 j.klein@geotechnology.com PROJ. NO. 077740141 OQ, 10/1/04 REPORT, 6/23/05 ADDENDUM
SEWER DISTRICT	- DUCKETT CREEK SEWER DISTRICT 3550 HIGHWAY K ST. CHARLES, MO 63304-8616 ATTN: MS. CHRISTINE BEASLEY PHONE: (636) 441-1244 FAX: (636) 498-8150
WATER SHED	- DARDENNE CREEK
WATER SERVICE	- PUBLIC WATER SUPPLY DISTRICT NO. 2 OF ST. CHARLES COUNTY 100 WATER DR. OFALLON, MO 63366 ATTN: MR. BRIAN PFEFFER PHONE: (636) 561-3737 ext. 124 bpeffer@allencwater.com

INDEX

C1	TITLE SHEET
C2	SPECIFICATION SHEET
C3	EXISTING/OVERALL CONDITIONS
C4	SITE AND GRADING PLAN
C4.1	SITE AND GRADING PLAN
C5	UTILITY PLAN
C6	SITE GEOMETRICS PLAN
C6.1	LOT A WATER PLAN
C6.2	LOT B WATER PLAN
C7	STORM SEWER PROFILES, DETAILS AND HYDRAULICS
C8	SANITARY SEWER PROFILE AND DETAILS
C9	PAVEMENT DETAILS
C9.1	SITE IMPROVEMENT DETAILS
C10	DETAILS
C11	ENTRANCE WARPING AND DUCKETT CREEK DETAILS
C11.1	WATER DISTRICT DETAILS SHEET
C12	DRAINAGE AREA PLAN
C13	EROSION AND SEDIMENT CONTROL PLAN

BENCHMARK

SC-13 ELEV=499.34
LOCATED 2.70 MILES N/W OF THE INTERSECTION OF HIGHWAY 34 AND HIGHWAY D ON THE NORTH SIDE OF WESTBOUND LANES OF HIGHWAY 40 NE A FIELD ENTRANCE GOING NORTH FOR THE WESTBOUND LANES OF HIGHWAY 40. IT IS 29.55 FEET NEAR OF A P.K. NAIL IN THE CENTER LINE OF WESTBOUND HWY 40, 38.2 FEET SW OF THE CENTER OF THE TOP OF THE NORTHWEST END OF A CORRUGATED METAL PIPE.

ABBREVIATIONS

C.O.	- CLEANOUT
DB.	- DEED BOOK
E.	- ELECTRIC
FL	- FLOWLINE
FT	- FEET
FND.	- FOUND
G	- GAS
M.H.	- MANHOLE
N/F	- NOW OR FORMER
PBL	- PLAT BOOK
PG.	- PAGE
P.V.C.	- POLYVINYL CHLORIDE PIPE
R.C.P.	- REINFORCED CONCRETE PIPE
D.I.P.	- DUCTILE IRON PIPE
SQ.	- SQUARE
T	- TELEPHONE CABLE
TS	- TAILLINE
V.C.P.	- VETRIFIED CLAY PIPE
W	- WATER
(86'W)	- RIGHT-OF-WAY WIDTH
N.T.S.	- NOT TO SCALE

- ▲ 11/07/05 LOT C DRIVE, AMEREN
- ▲ 10/07/05 REVISED SIDEWALK
- ▲ 9/26/05 WATER DISTRICT COMMENTS
- ▲ 9/12/05 ARCHITECT COMMENTS
- ▲ 8/03/05 COORDINATION
- ▲ 7/19/05 REVISED PER DUCKETT CREEK'S COMMENTS DATED 7/19/05
- ▲ 7/13/05 REVISED PER DUCKETT CREEK'S COMMENTS DATED 7/13/05
- ▲ 6/27/05 REVISED PER CITY OF OFALLON'S COMMENTS 5/22/05 & DUCKETT CREEK'S COMMENTS DATED 6/15/05
- ▲ 5/31/05 REVISED PER DUCKETT CREEK'S MARK-UP PLAN (ADD MH, REV. ALIGNMENT)
- ▲ 5/11/05 REVISED BANK'S DRIVEWAY FOR STACKING REQUIREMENT
- ▲ 5/5/05 REVISED PER CITY COMMENT LETTER DATED 4-6-05, DUCKETT CREEK COMMENTS (ALIGNMENT), MCDOTT(4-3-05)
- ▲ 3/17/05 REVISED PER CITY COMMENT LETTER DATED 2-24-05, PWSID NO. 2 (2-14-05), DUCKETT CREEK (2-15-05)

11-22-0598
APPROVED

RECEIVED
NOV 07 2005
ENGINEERING DEPARTMENT

CURRENT PROPERTY OWNER:

THE SLOBODAN ILIJEVSKI TRUST AND THE LINDA ILIJEVSKI TRUST
810 REINDEER DRIVE
BALLWIN, MO 63021

PREPARED FOR DEVELOPER/OWNER OF PROPOSED LOT A (UNDER CONTRACT)

M & I SUPPORT SERVICES CORPORATION
-SOUTHWEST BANK
770 NORTH WATER STREET
20 TH FLOOR
MILWAUKEE, WI 53202
(414) 765-7959
(414) 302-2824 Fax
MS. MARGARET KNIZE, VICE PRESIDENT
DIRECTOR CORPORATE REAL ESTATE,
CONSTRUCTION AND DESIGN
margaret.knize@micorp.com

PREPARED FOR DEVELOPER/OWNER OF PROPOSED LOT B (UNDER CONTRACT)

PROFESSIONAL RESOURCE DEVELOPMENT
307 PARK HILLS DRIVE
P.O. Box 1123
EFFINGHAM, IL 62401
(217) 254-2221
MR. ED GRUNLOH
edgrunloh@grunlohbuilding.com

UTILITY NOTE:

UNDERGROUND FACILITIES, STRUCTURES AND UTILITIES HAVE BEEN PLOTTED FROM AVAILABLE SURVEYS, RECORDS AND INFORMATION, AND, THEREFORE DO NOT NECESSARILY REFLECT THE ACTUAL EXISTENCE, NONEXISTENCE, SIZE, TYPE, NUMBER, OR LOCATION OF THESE FACILITIES, STRUCTURES AND UTILITIES. THE CONTRACTOR SHALL BE RESPONSIBLE FOR VERIFYING THE ACTUAL LOCATION OF ALL UNDERGROUND FACILITIES, STRUCTURES, AND UTILITIES, EITHER SHOWN OR NOT SHOWN ON THESE PLANS. THE UNDERGROUND FACILITIES, STRUCTURES, AND UTILITIES SHALL BE LOCATED IN THE FIELD PRIOR TO ANY GRADING, EXCAVATION OR CONSTRUCTION OF IMPROVEMENTS. THESE PROVISIONS SHALL IN NO WAY ABSOLVE ANY PARTY FROM COMPLYING WITH THE UNDERGROUND FACILITY SAFETY AND DAMAGE PREVENTION ACT, CHAPTER 319 RSMo.

FIBER OPTICS EXIST WITHIN PROJECT AREA



MoDOT 314-340-4100
FIBER OPTICS MAY BE PRESENT

P&Z NOS: 9831.52.01

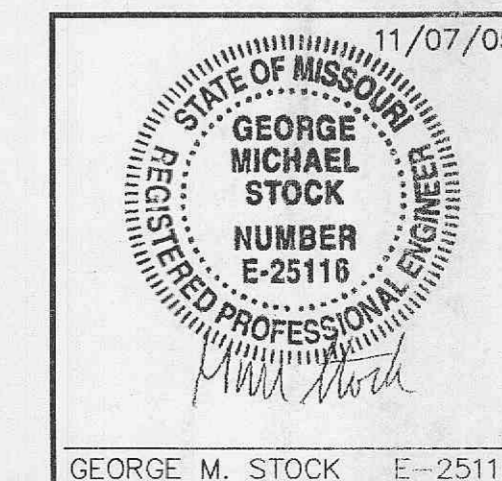

STOCK AND ASSOCIATES CONSULTING ENGINEERS, INC. AND THE UNDERSIGNED ENGINEER HAVE NO RESPONSIBILITY FOR SERVICES PROVIDED BY OTHERS TO IMPLEMENT THE IMPROVEMENTS SHOWN ON THIS PLAN AND ALL OTHER DRAWINGS WHERE THE UNDERSIGNED ENGINEER'S SEAL, SIGNATURE AND THE CONSTRUCTION MEANS AND METHODS ARE THE SOLE RESPONSIBILITY OF THE OWNER AND CONTRACTOR. STOCK AND ASSOCIATES CONSULTING ENGINEERS, INC. HAS NO RESPONSIBILITY TO VERIFY FINAL IMPROVEMENTS AS SHOWN ON THIS PLAN UNLESS SPECIFICALLY ENGAGED AND AUTHORIZED TO DO SO BY THE OWNER OR CONTRACTOR.

TITLE SHEET	
THE POINTE AT WINGHAVEN	
STOCK & ASSOCIATES Consulting Engineers, Inc.	257 Chesterfield Business Parkway St. Louis, MO 63005 PH: (636) 530-9100 FAX: (636) 530-9130 e-mail: general@stockassoc.com Web: www.stockassoc.com
DRAWN BY: J.P.P.	DATE: 2/04/05
CHECKED BY: G.M.S.	DATE: 2/04/05
JOB NUMBER: 204-3385	SHEET: C1 of 13

Const. Inspector