

**SANITARY SEWER PROFILE**

HORIZONTAL SCALE: 1"=30'  
VERTICAL SCALE: 1"=10'

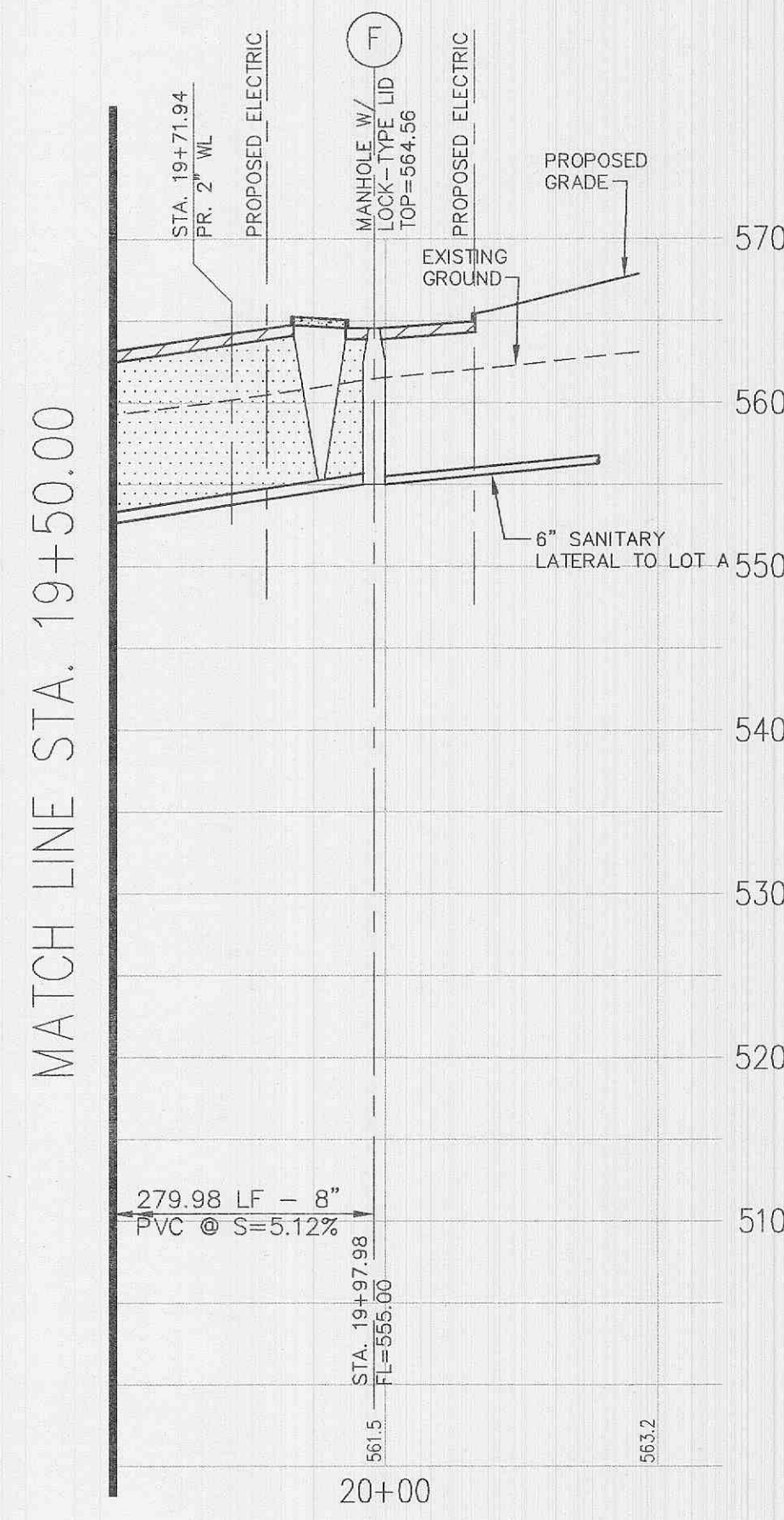

**SANITARY SEWER PROFILE**

HORIZONTAL SCALE: 1"=30'  
VERTICAL SCALE: 1"=10'

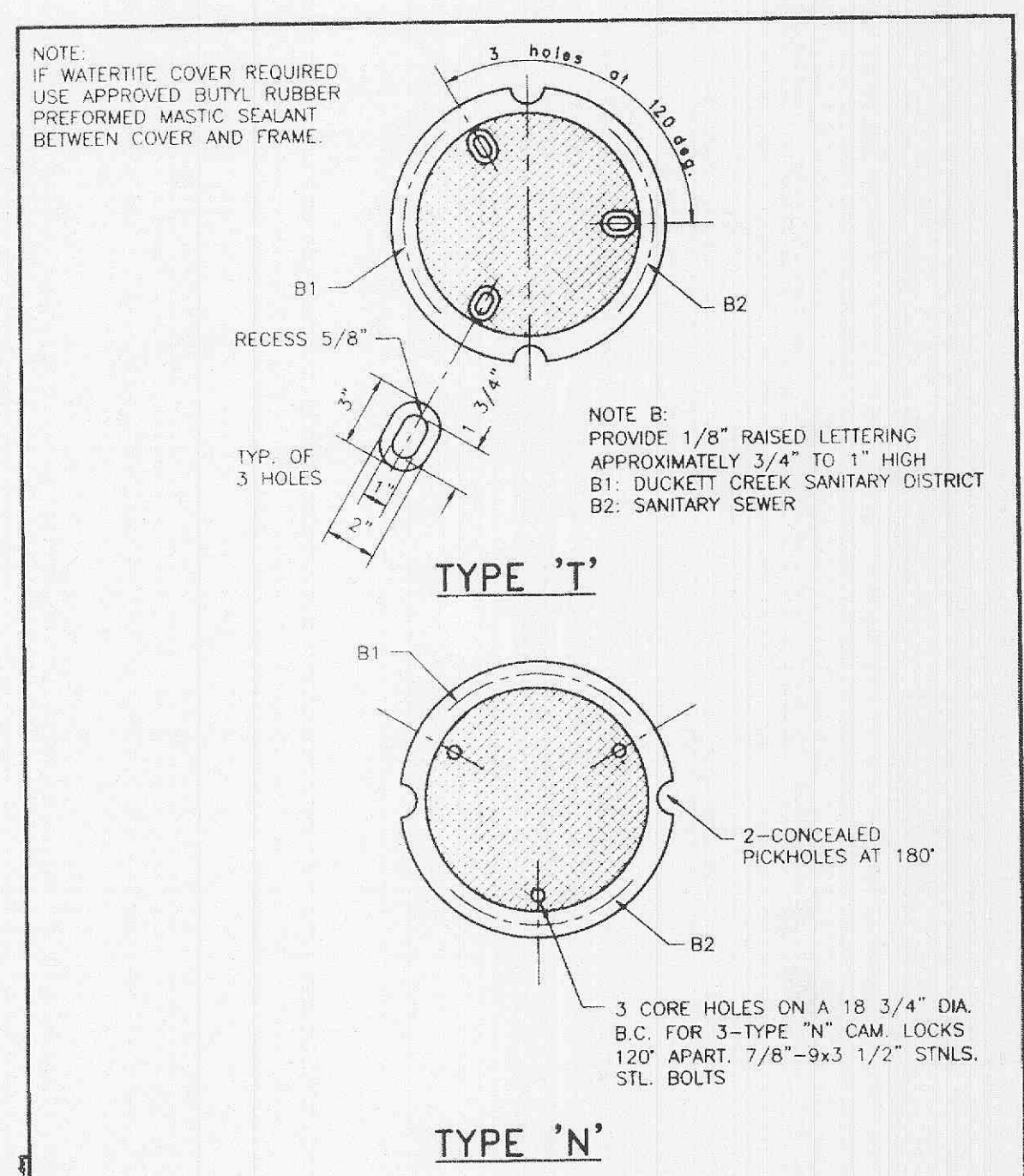

**Duckett Creek Sanitary District**  
CAST IRON MANHOLE COVERS (LOCK TYPE)  
Drawn By: BSM, App By: KLA, Detail No. 14  
Checked By: MDOB, Date: 12-27-00

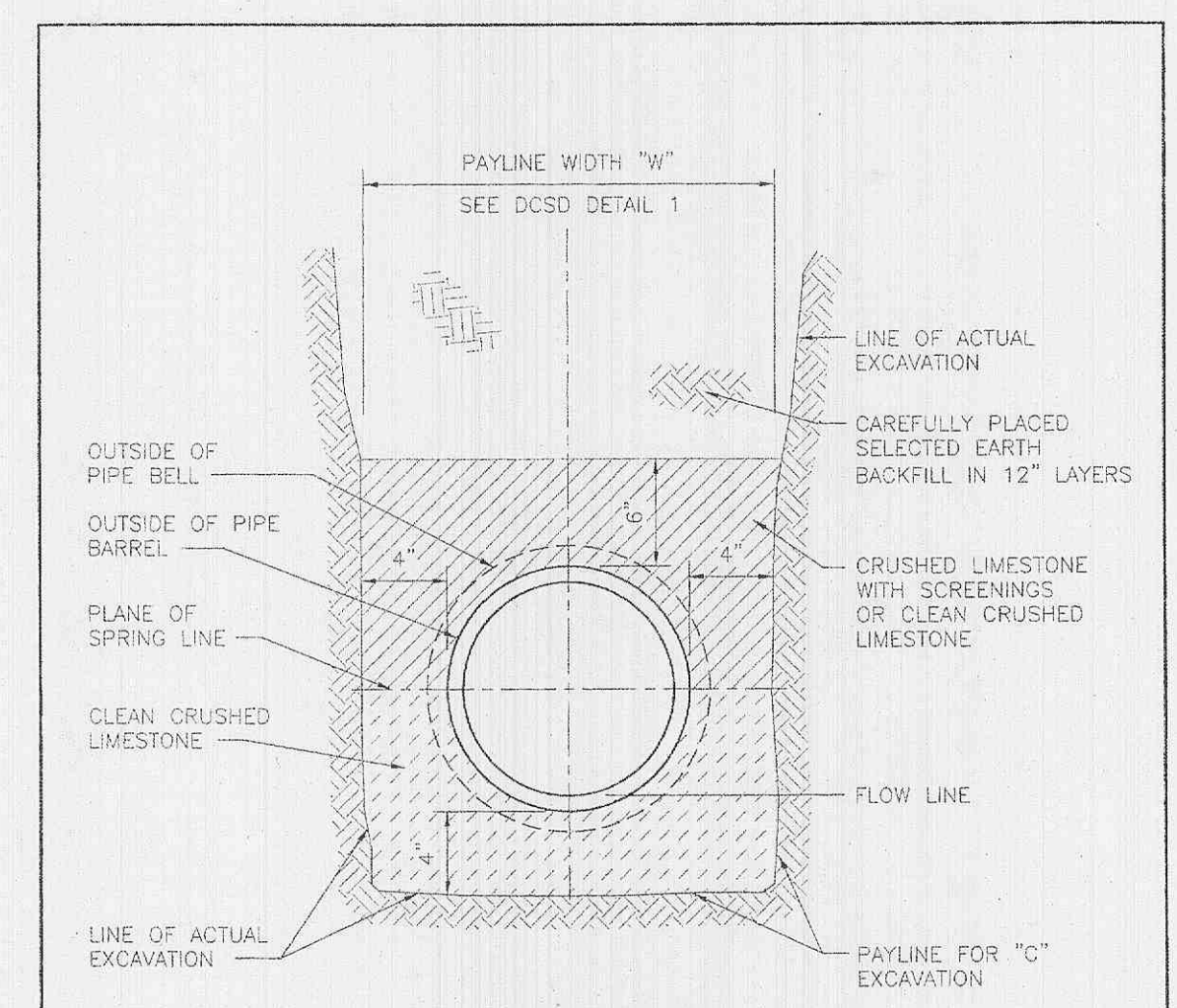

**Duckett Creek Sanitary District**  
PIPE BEDDING CLASS "C"  
(FOR ALL PIPE EXCEPT REINFORCED CONCRETE PIPE)  
Drawn By: BSM, App By: KLA, Detail No. 3  
Checked By: MDOB, Date: 12-21-99

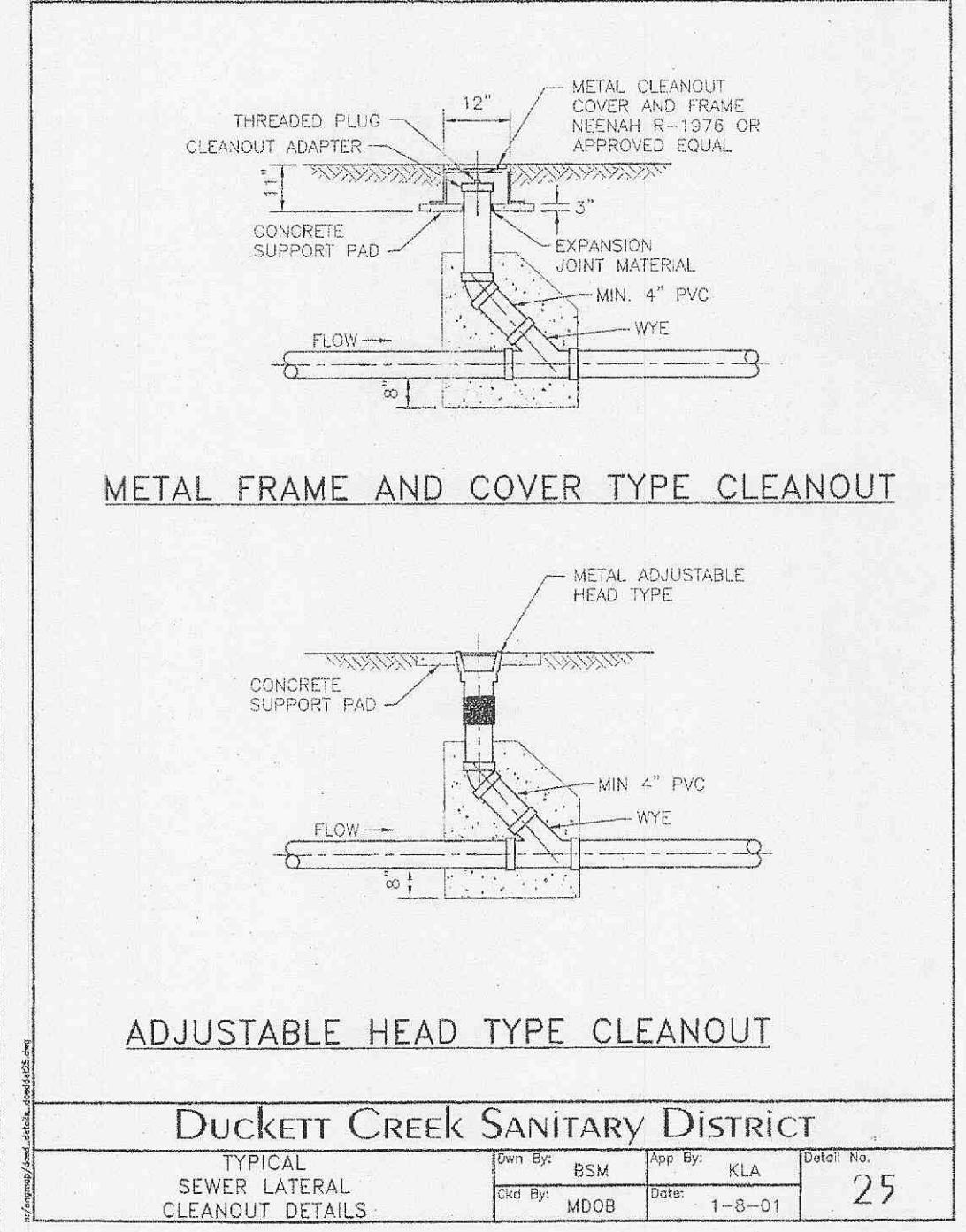

**LINETYPE LEGEND**

- EXISTING GRADE.....
- PROPOSED GRADE.....
- HYDRAULIC GRADE.....
- PROPOSED PAVEMENT.....
- GRANULAR BACKFILL.....
- COMPACTED FILL.....

- 11/07/05 LOT C DRIVE, AMEREN
- 10/07/05 REVISED SIDEWALK
- 9/28/05 WATER DISTRICT COMMENTS
- 9/12/05 ARCHITECT COMMENTS
- 8/30/05 COORDINATION
- 7/19/05 REVISED PER DUCKETT CREEK'S COMMENTS DATED 7/19/05
- 7/13/05 REVISED PER DUCKETT CREEK'S COMMENTS DATED 7/13/05
- 6/27/05 REVISED PER CITY OF O'FALLON'S COMMENTS 5/22/05 & DUCKETT CREEK'S COMMENTS DATED 6/15/05
- 5/31/05 REVISED PER DUCKETT CREEK'S MARK-UP PLAN (ADD MH, REV. ALIGNMENT)
- 5/11/05 REVISED BANK'S DRIVEWAY FOR STACKING REQUIREMENT
- 5/5/05 REVISED PER CITY COMMENT LETTER DATED 4-6-05, DUCKETT CREEK COMMENTS (ALIGNMENT), MODOT(4-8-05)
- 3/17/05 REVISED PER CITY COMMENT LETTER DATED 2-24-05, PWSO NO. 2 (2-14-05), DUCKETT CREEK (2-15-05)

**DETAILS AND SANITARY SEWER PROFILE**  
THE POINTE AT WINGHAVEN

P&Z NOS: 9831.52.01

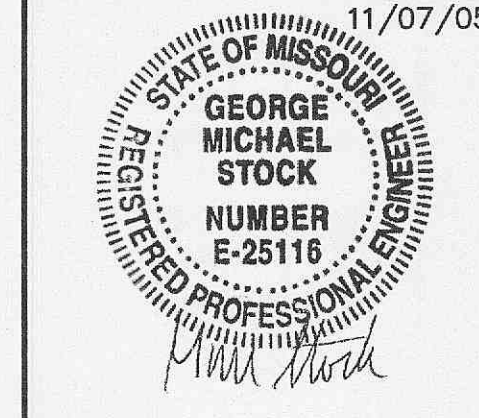

**STOCK & ASSOCIATES**  
Consulting Engineers, Inc.

257 Chesterfield Business Parkway  
St. Louis, MO 63005  
PH. (636) 530-9100  
FAX (636) 530-9130  
e-mail: general@stockassoc.com  
Web: www.stockassoc.com

**SEE SHEET C11 FOR OTHER DUCKETT CREEK SANITARY DISTRICT DETAILS**

DRAWN BY: J.P.P.	DATE: 2/04/05	CHECKED BY: G.M.S.	DATE: 2/04/05	DATE: JOB NUMBER: 204-3385	SHEET: C8 of 13
------------------	---------------	--------------------	---------------	----------------------------	-----------------