

REVISIONS	BY
APRIL 12, 2005	RWM
JULY 1, 2005	RWM
OCTOBER 14, 2005	RWM

landscape TECHNOLOGIES
 (630) 926-1250
 Fax: (630) 926-1653
 Jacobs Creek Drive
 St. Charles, Missouri 63304

**PLANTING PLAN FOR THE PROPOSED
 The Pointe at Winghaven
 WINGHAVEN, MO**

DRAWN
 R. MARDIS
 CHECKED
 RWM
 DATE
 APRIL 6, 2005
 SCALE
 1"=20'
 JOB No.
 2005-150
 SHEET
L-2
 OF THREE SHEETS

NOTES:

- All natural vegetation shall be maintained where it does not interfere with construction or the permanent plan of operation. Every effort possible shall be made to protect existing structures or vegetation from damage due to equipment usage. Contractor shall at all times protect all materials and work against injury to public.
- The landscape contractor shall be responsible for any coordination with other site related work being performed by other contractors. Refer to architectural drawings for further coordination of work to be done.
- Underground facilities, structures and utilities must be considered approximate only. There may be others not presently known or shown. It shall be the landscape contractor's responsibility to determine or verify the existence of and exact location of the above (Call 1-800-DIG-RITE).
- Plant material are to be planted in the same relationship to grade as was grown in nursery conditions.
- All mulch to be shredded oak bark mulch at 3" depth (after compaction) unless otherwise noted. Mulch shall be clean and free of all foreign materials. Edge all beds with spade-cut edge unless otherwise noted.
- It shall be the landscape contractor's responsibility to:
 - Verify all existing and proposed features shown on the drawings prior to commencement of work.
 - Report all discrepancies found with regard to existing conditions or proposed design to the landscape architect immediately for a decision.
 - Stake the locations of all proposed plant material and obtain the approval of the owner's representative or landscape architect prior to installation.
- All planting beds shall be cultivated to 6" depth minimum and graded smooth immediately before planting of plants. All shrub masses to be included & mulched into one contiguous bed unless otherwise noted.
- Topsoil mix for all proposed landscape plantings shall be five (5) parts well-drained screened organic topsoil to one (1) part Canadian sphagnum peat moss as per planting details. Landscape contractor to apply pre-emergent herbicide to all planting beds.
- All plant material (excluding ground cover, perennials and annuals) are to be warranted for a period of 12 months after installation at 100% of the installed price.
- All disturbed lawn areas to be seeded with a mixture of Turf-Type fescue (300# per acre) and bluegrass (18# per acre). Landscape contractor shall offer an alternate price for sod in lieu of seed. Lawn areas shall be unconditionally warranted for a period of 90 days from date of final acceptance. Bare areas more than one square foot per any 50 square feet shall be replaced.
- Items shown on this drawing take precedence over the material list. It shall be the landscape contractor's responsibility to verify all quantities and conditions prior to implementation of this plan. No substitutions of types or size of plant materials will be accepted without written approval from landscape architect.
- Any points carrying concentrated water loads and all slopes of 15% or greater shall be sodded.
- Siltation controls may be required to prevent run-off. Straw bales placed end-to-end shall be used, anchored with no less than two 3/8" X 36" reinforcing rods. Bales shall remain until all graded areas are seeded or sodded.
- The landscape contractor is to receive the site graded to within 1/10 of a foot. Landscape contractor to obtain letter of grade certification from the general contractor prior commencement of work.
- All lawn and landscape beds to be irrigated with a fully automatic system (by others).

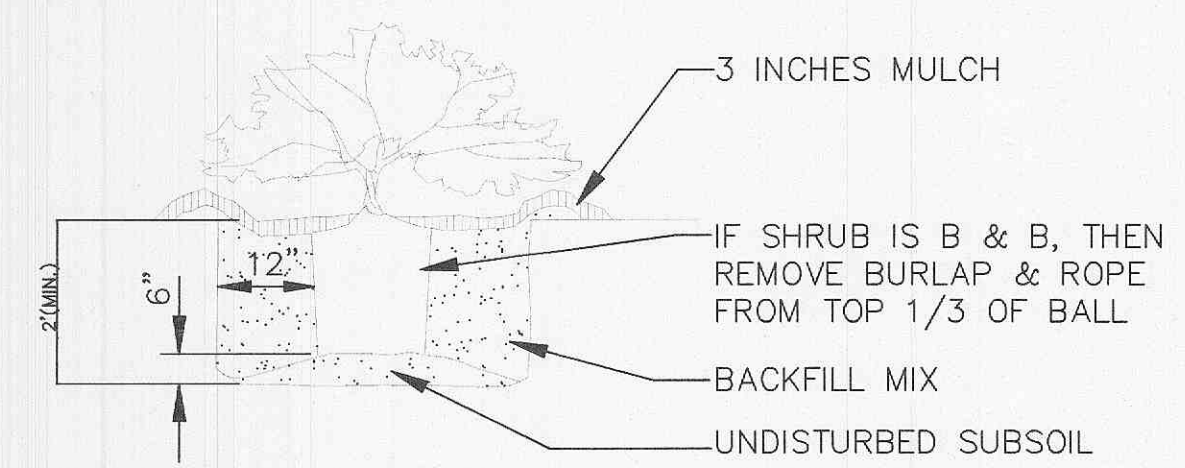

SHRUB PLANTING
N.T.S.

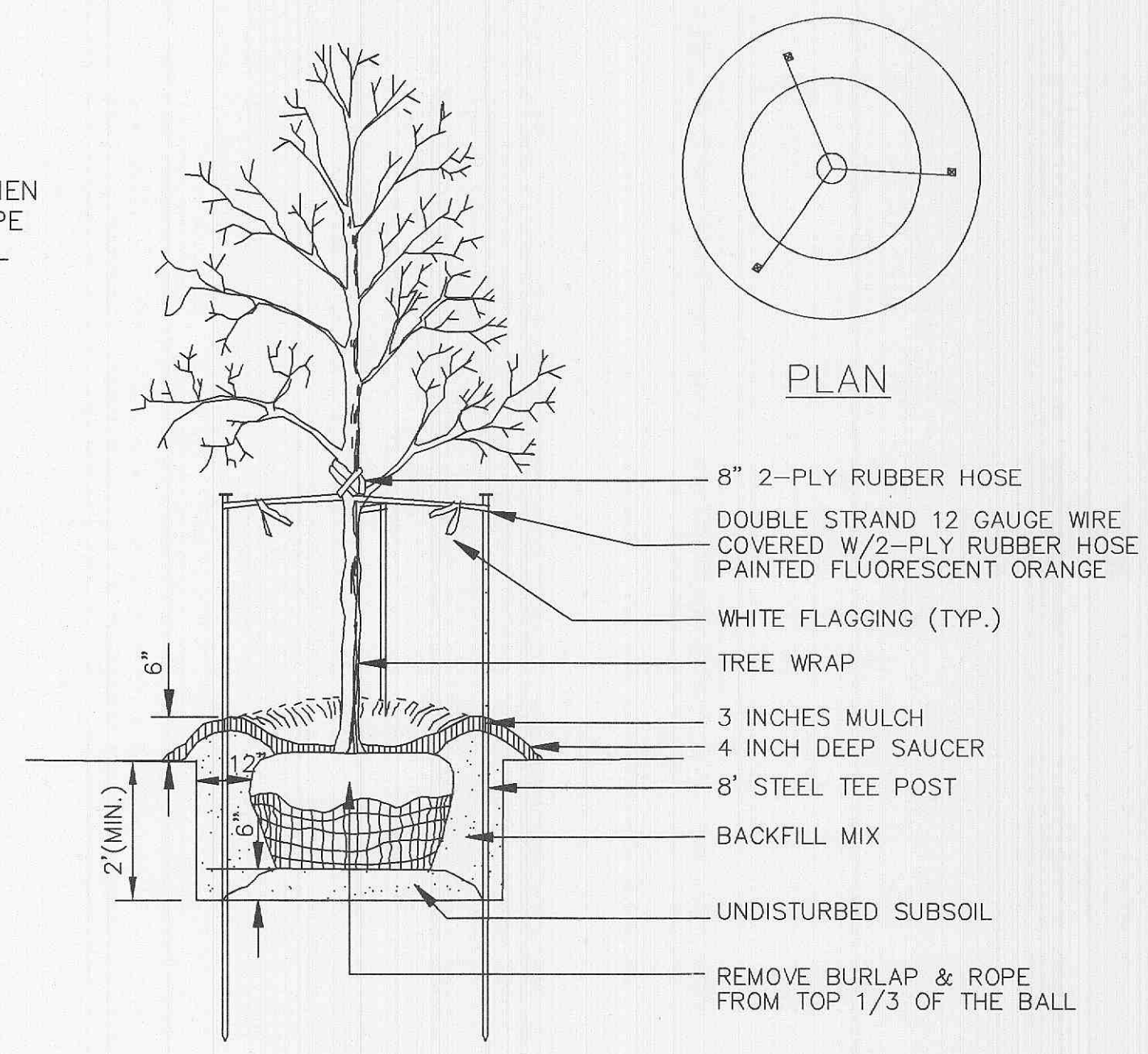

DECIDUOUS TREE PLANTING
N.T.S.

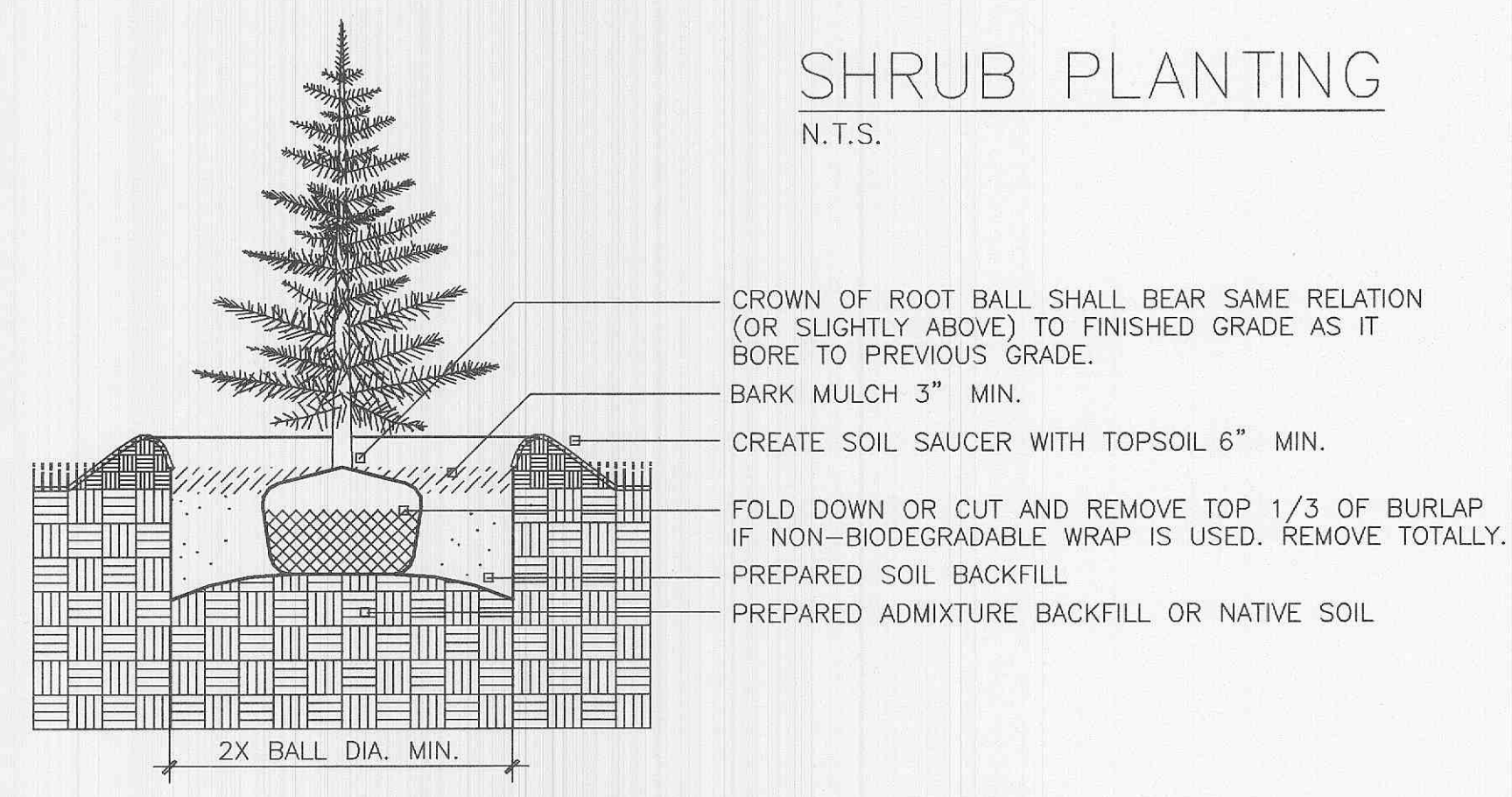

EVERGREEN TREE PLANTING
N.T.S.

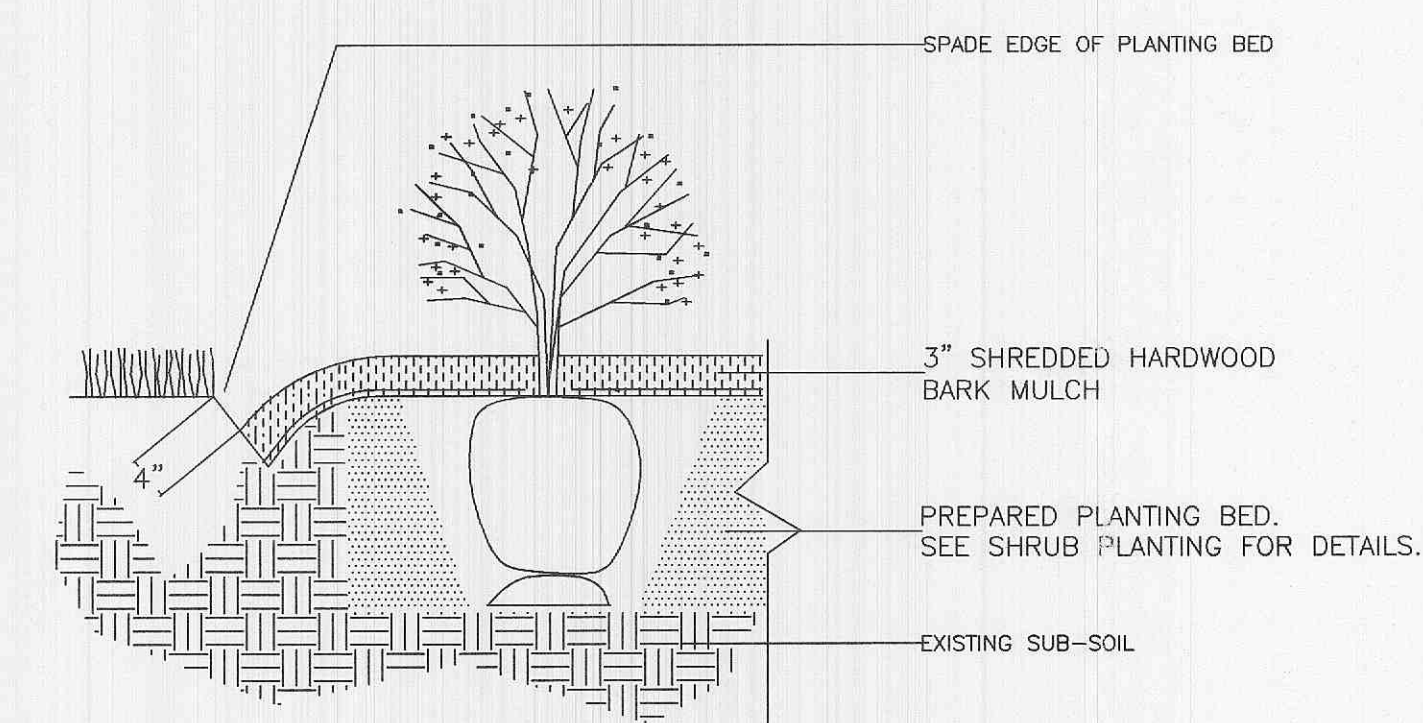

SPADE-CUT EDGE DETAIL
N.T.S.

LANDSCAPE REQUIREMENTS:

STREET TREES:
 REQUIRED: ONE TREE @ 3" CAL. PER 30 LIN. FT. OF STREET FRONTAGE.
 LOT A: ALL EXISTING STREET TREES TO REMAIN
 LOT B: FIVE (5) STREET TREES PROVIDED @ 30' ON CENTER

ADDITIONAL TREES:
 REQUIRED: ONE TREE PER 3,000 SQ. FT. OF OPEN SPACE.
 LOT A: 29,269 SQ. FT. OF OPEN SPACE PROVIDED = TEN (10) ADDITIONAL TREES REQUIRED.
 ADDITIONAL TREES PROVIDED: SEVENTEEN (17) TREES
 LOT B: 10,066 SQ. FT. OF OPEN SPACE PROVIDED = FOUR (4) ADDITIONAL TREES REQUIRED.
 ADDITIONAL TREES PROVIDED: SIX (6) TREES

PARKING AREAS:
 PARKING AREAS TO BE SCREENED FROM VIEW @ ROADWAYS OR ADJACENT PROPERTIES WHEN WITHIN 20' OF ROADWAY

PARKING LOT ISLANDS:
 REQUIRED: ONE ISLAND PER 20 PARKING SPACES, ALLOWING FOR TWO (3") TREES + ONE (5 Gallon) SHRUB PER FULL ISLAND
 LOT A: TOTAL PARKING SPACES: 34
 LOT B: TOTAL PARKING SPACES: 53

BUFFERYARD @ RESIDENTIAL PROPERTY TO THE NORTH:
 REQUIRED: TWO (2) PLANT UNITS PER 100 LIN. FT.
 ONE PLANT UNIT = 2 CANOPY TREES (2"), 2 ORNAMENTAL TREES (1") AND 2 EVERGREEN TREES (6'-8")
 LOT A:
 LIN. FT. BUFFERYARD: 324.52 LIN. FT., THEREFORE, 6.5 PLANT UNITS REQUIRED
 LANDSCAPING REQUIRED & PROVIDED:
 14 CANOPY TREES
 14 ORNAMENTAL TREES
 14 EVERGREEN TREES
 LOT B:
 LIN. FT. BUFFERYARD: 145.0 LIN. FT., THEREFORE, 2.9 PLANT UNITS REQUIRED
 LANDSCAPING REQUIRED & PROVIDED:
 6 CANOPY TREES
 6 ORNAMENTAL TREES
 6 EVERGREEN TREES

LOT A:

8	BAY	BAYBERRY	Myrica pennsylvanica	24"-30" B&B
71	BBL	BIG BLUE LIRIOPE	Liriope muscari 'Big Blue'	1" Caliper
1	CFC	CORALBURST FLOWERING CRAB	Malus 'Coralburst'	2" Caliper
17	CH	CHINA GIRL/BOY HOLLY	Ilex X meserveae 'China Girl/Boy'	5 Gallon
7	CLE	CLETHRA	Clethra alnifolia 'Hummingbird'	5 Gallon
8	CP	CAPITAL PEAR	Pyrus calleryana 'Capital'	2" Caliper
21	CPB	CRIMSON PYGMY BARBERRY	Berberis thunbergii 'Crimson Pygmy'	5 Gallon
9	DY	DENSIFORMA YEW	Taxus X media 'Densiformis'	18"-24" B&B
9	GVB	GREEN VELVET BOXWOOD	Buxus microphylla 'Green Velvet'	5 Gallon
8	HACK	HACKBERRY	Celtis occidentalis 'Prairie Pride'	2.5" Caliper
10	MKL	MISS KIM LILAC	Syringa patula 'Miss Kim'	5 Gallon
1	MP	MUGO PINE	Pinus mugo var. mugo	5 Gallon
3	PA	PATMORE ASH	Fraxinus pennsylvanica 'Patmore'	2.5" Caliper
6	PFD	PINK FLOWERING DOGWOOD	Cornus florida rubra	6'-7'
9	PJ	PROCUMBENS JUNIPER	Juniperus procumbens 'Nana'	5 Gallon
7	PSC	PURPLE SAND CHERRY	Prunus X cistena	24"-30" B&B
6	RB	REDBUD	Cercis canadensis	2" Caliper
6	RO	RED OAK	Quercus rubra	2.5" Caliper
4	SERV	AUTUMN BRILLIANCE SERVICEBERRY	Amelanchier grandiflora 'Autumn Brilliance'	2" Caliper
3	SWO	SWAMP WHITE OAK	Quercus bicolor	2.5" Caliper
14	WP	WHITE PINE	Pinus strobus	6'-7'

LOT B:

2	BAY	BAYBERRY	Myrica pennsylvanica	24"-30" B&B
5	CFC	CORALBURST FLOWERING CRAB	Malus 'Coralburst'	2" Caliper
38	CH	CHINA GIRL/BOY HOLLY	Ilex X meserveae 'China Girl/Boy'	5 Gallon
6	CP	CAPITAL PEAR	Pyrus calleryana 'Capital'	2" Caliper
15	DFG	DWARF FOUNTAIN GRASS	Pennisetum alopecuroides 'Hameln'	5 Gallon
3	HACK	HACKBERRY	Celtis occidentalis 'Prairie Pride'	2.5" Caliper
5	OGRM	OCTOBER GLORY RED MAPLE	Acer rubrum 'October Glory'	3" Caliper
2	PFD	PINK FLOWERING DOGWOOD	Cornus florida rubra	6'-7'
3	RO	RED OAK	Quercus rubra	2.5" Caliper
1	SS	SERBIAN SPRUCE	Picea omorika	6'-7'
2	SWO	SWAMP WHITE OAK	Quercus bicolor	2.5" Caliper
6	WP	WHITE PINE	Pinus strobus	6'-7'

LOT C:

5	CP	CAPITAL PEAR	Pyrus calleryana 'Capital'	2" Caliper
3	HACK	HACKBERRY	Celtis occidentalis 'Prairie Pride'	2.5" Caliper
6	PFD	PINK FLOWERING DOGWOOD	Cornus florida rubra	6'-7'
7	RO	RED OAK	Quercus rubra	2.5" Caliper
11	WP	WHITE PINE	Pinus strobus	6'-7'