

NOTE:

PREMANUFACTURED ADAPTERS SHALL BE USED AT ALL PVC TO DIP CONNECTIONS. RUBBER BOOT/MISSION TYPE COUPLINGS WILL NOT BE ALLOWED.

**POST MEADOWS
SANITARY SEWER PROFILES**

96-028

REV. 10-28-96 PER CITY OF ATASCADERO
REV. 10-28-96
REV. 11-06-96 PER DUCKETT CREEK
REV. 1-28-97 PER D.C.S.D.
REV. 2-12-97 PER D.C.S.D.

CONNECTIONS FROM
DRAINER PLUMBS

NOTE: LIDS 20' BELOW GROUND TO BE SERVED BY PRIVATE OWNER PUMPS. ALL INDUSTRY LIDS SHALL BE PUT AT 3' MIN. DEPTH FOR DUCTILE CAST IRON SANITARY SEWER DISTRICT.

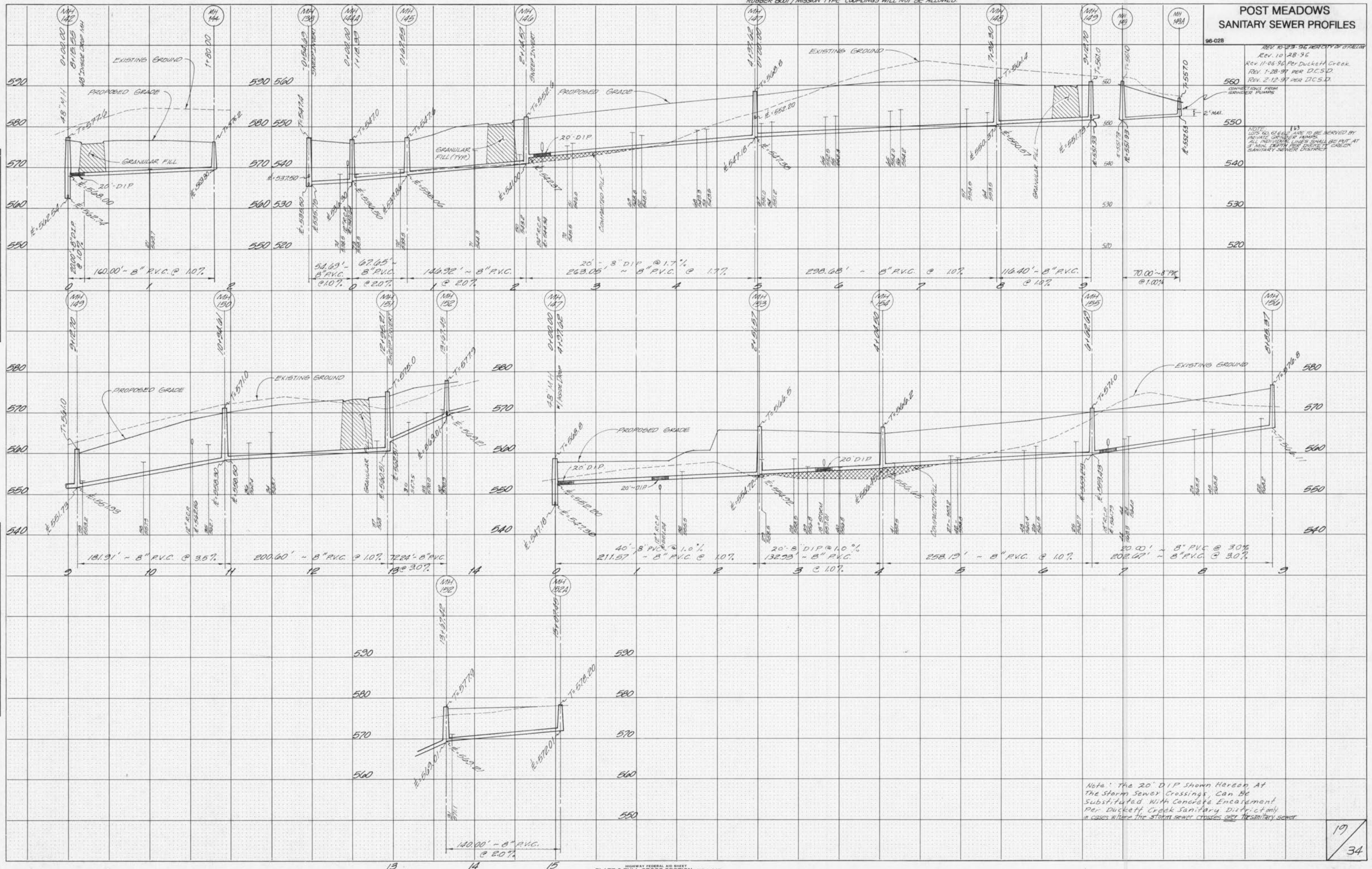

DATE: _____
BY: _____
CHECKED: _____
FINAL SURVEY PLOTTED TEMPLATE AREAS CHECKED

DATE: _____
BY: _____
CHECKED: _____
ORIGINAL SURVEY PLOTTED TEMPLATE AREAS CHECKED

Note: The 20' DIP shown hereon at the storm sewer crossings, can be substituted with concrete encasement per Duckett Creek Sanitary District only in cases where the storm sewer crosses over the sanitary sewer.