

\*\* STORM SEWERS HAVE BEEN DESIGNED TO ACCOMMODATE FUTURE DEVELOPMENT OF THE ENTIRE SITE

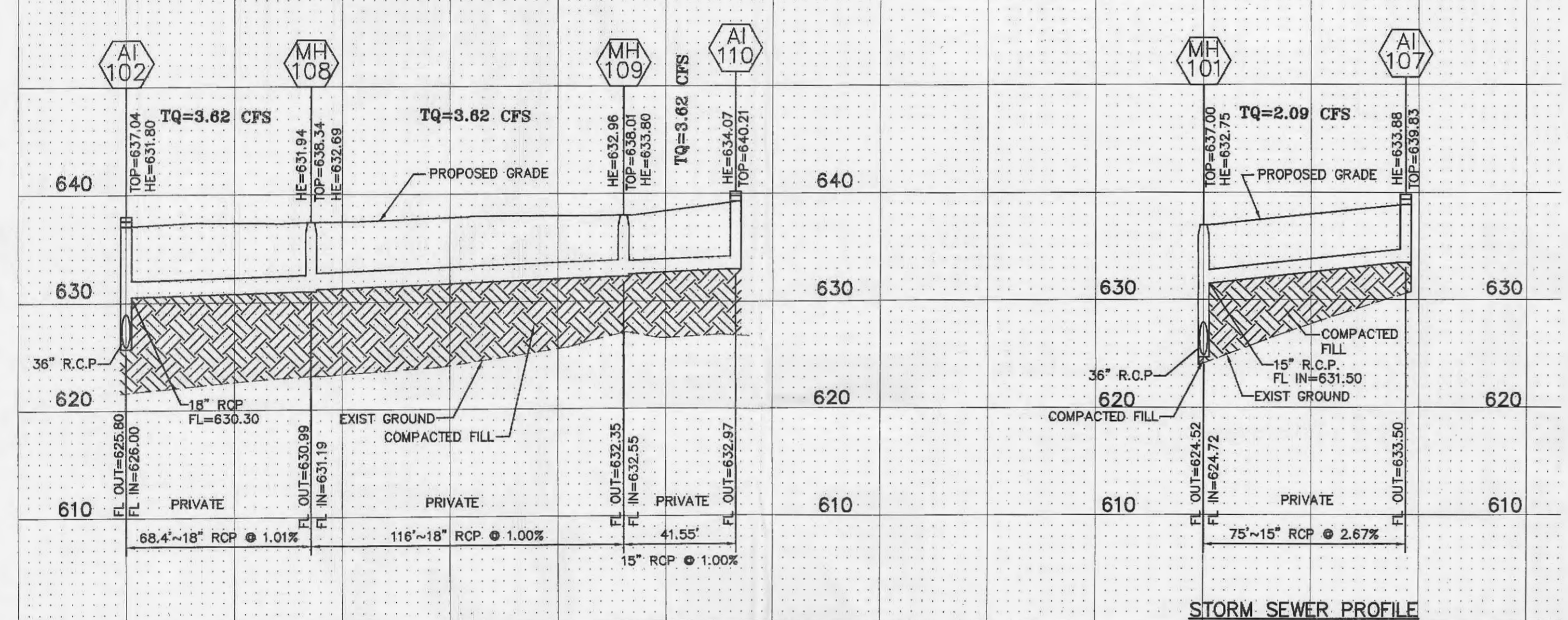

UPP STR	LOW STR	I	DIA	UPPER EL IN	LOWER EL IN	PS	UPPER ST EL	DEPTH HY GR	UPPER HY EL	LOWER HY EL	HYDR GRADE	FR HEAD	VEL	VEL HEAD	JUNC LOSS	TURN LOSS	TQ	PIPE CAP	REMARKS
AI 110	MH 109	42	15	632.97	632.55	1.01	640.21	6.14	634.07	633.80	.00310	0.13	2.95	0.14	0.14	0.00	3.62	6.49	1
MH 109	MH 108	117	18	632.35	631.19	0.99	638.01	5.05	632.96*	632.69	.00120	0.14	2.05	0.07	0.02	0.09	3.62	10.47	2
MH 108	AI 102	68	18	630.99	630.30	1.01	638.34	6.40	631.94	631.80	.00120	0.08	2.05	0.07	0.03	0.03	3.62	10.55	3
AI 107	MH 101	75	15	633.50	631.50	2.67	639.83	5.96	633.88*	632.75	.00100	0.08	1.70	0.05	0.05	0.00	2.09	10.55	4
EX MH	MH 106	134	12	635.90	633.88	1.50	641.39	4.59	636.80	634.88	.01160	1.55	4.88	0.37	0.37	0.00	3.83	4.37	5
MH 106	MH 105	227	36	631.17	629.11	0.91	643.22	10.47	632.75	632.11	.00170	0.38	3.86	0.23	0.19	0.07	27.25	63.52	6
MH 105	MH 104	51	36	628.91	628.49	0.82	644.00	12.14	631.86	631.49	.00180	0.09	3.97	0.24	0.15	0.13	28.05	60.50	7
MH 104	AI 103	119	36	628.29	627.31	0.82	642.93	12.41	630.52	630.31	.00180	0.21	3.97	0.24	0.00	0.00	28.05	60.41	8
AI 103	AI 102	136	36	627.11	626.00	0.82	641.06	11.54	629.42	629.00	.00180	0.25	4.03	0.25	0.09	0.08	28.51	60.36	9
AI 102	MH 101	132	36	625.80	624.72	0.82	637.04	8.92	628.12	627.72	.00230	0.31	4.55	0.32	0.09	0.00	32.13	60.28	10
MH 101	MH 100	169	36	624.52	623.12	0.83	637.00	10.38	626.62	626.12	.00260	0.44	4.84	0.36	0.06	0.00	34.22	60.74	11
MH 100	EX 99	14	36	622.92	622.80	0.86	628.01	2.17	625.84	625.80	.00260	0.04	4.84	0.36	0.00	0.00	34.22	61.68	12

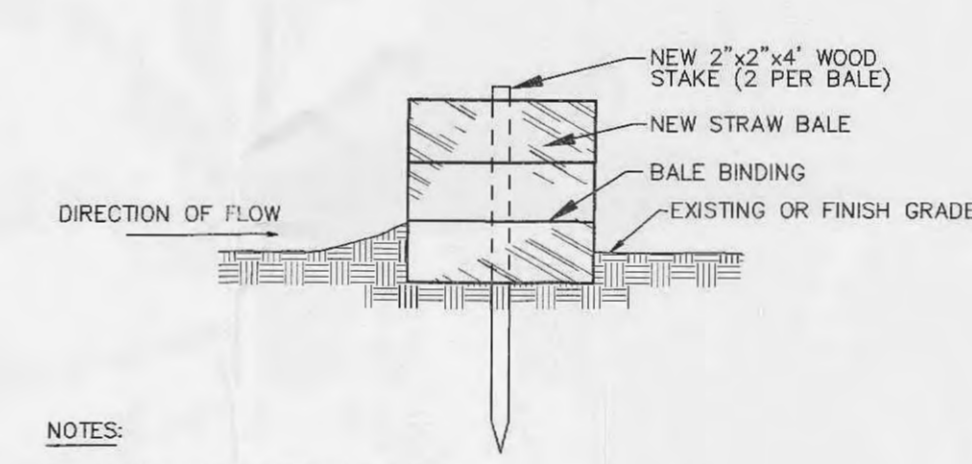

- NOTES:  
 1. STRAW BALES, NOT HAY BALES SHALL BE USED.  
 2. BUTT ENDS OF BALES TIGHTLY TOGETHER.  
 3. INSTALL BALES WITH BINDING AROUND SIDES, NOT TOP AND BOTTOM.  
 4. FILL ANY GAP BETWEEN BALES BY WEDGING LOOSE STRAW BETWEEN THEM.

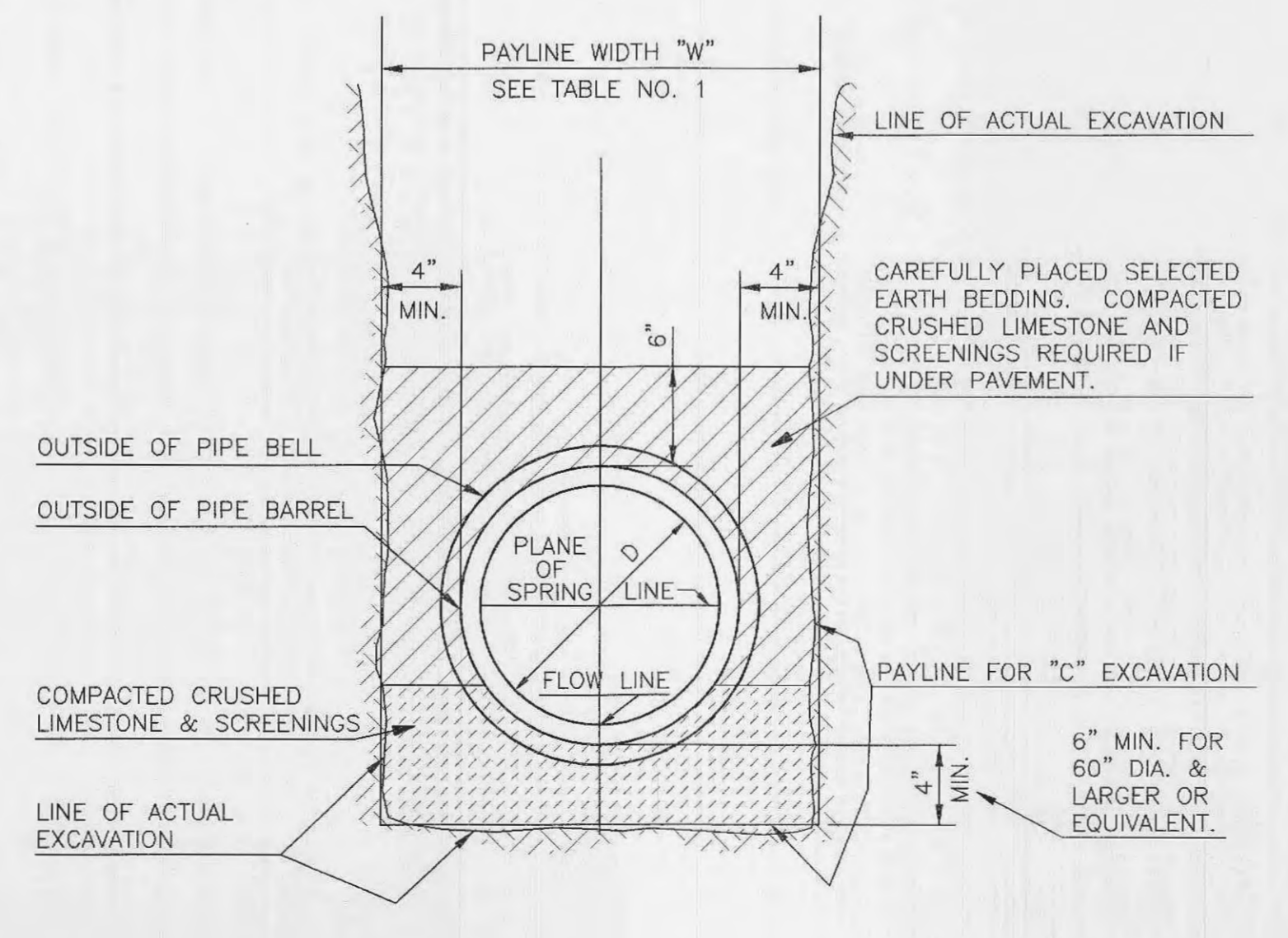
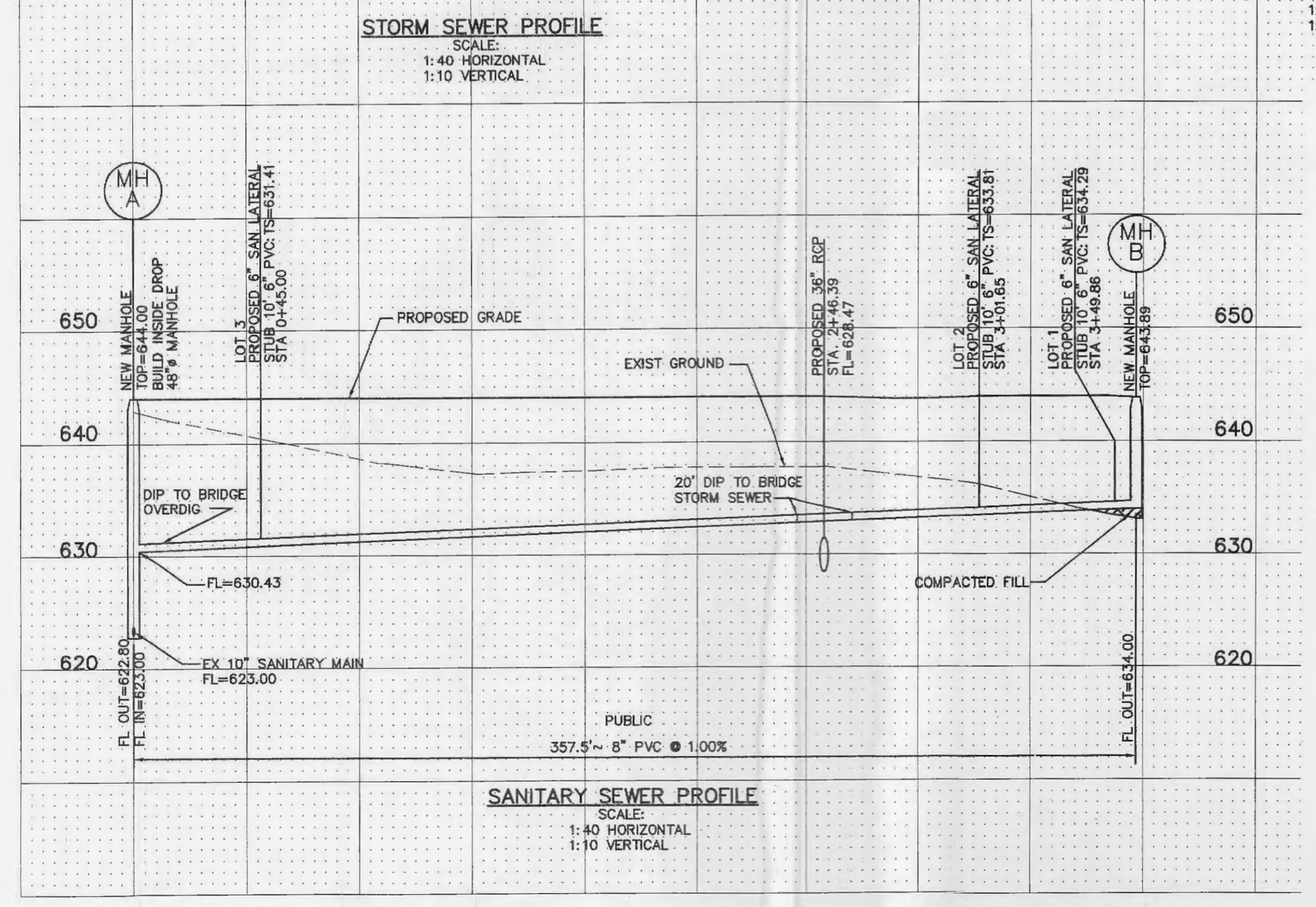
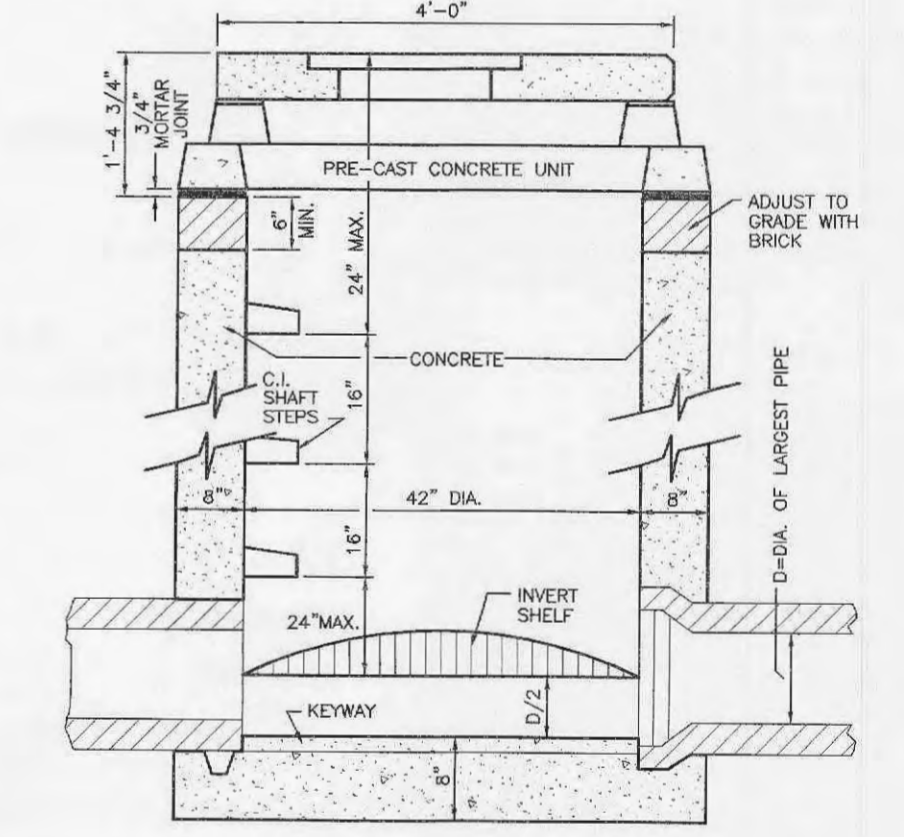
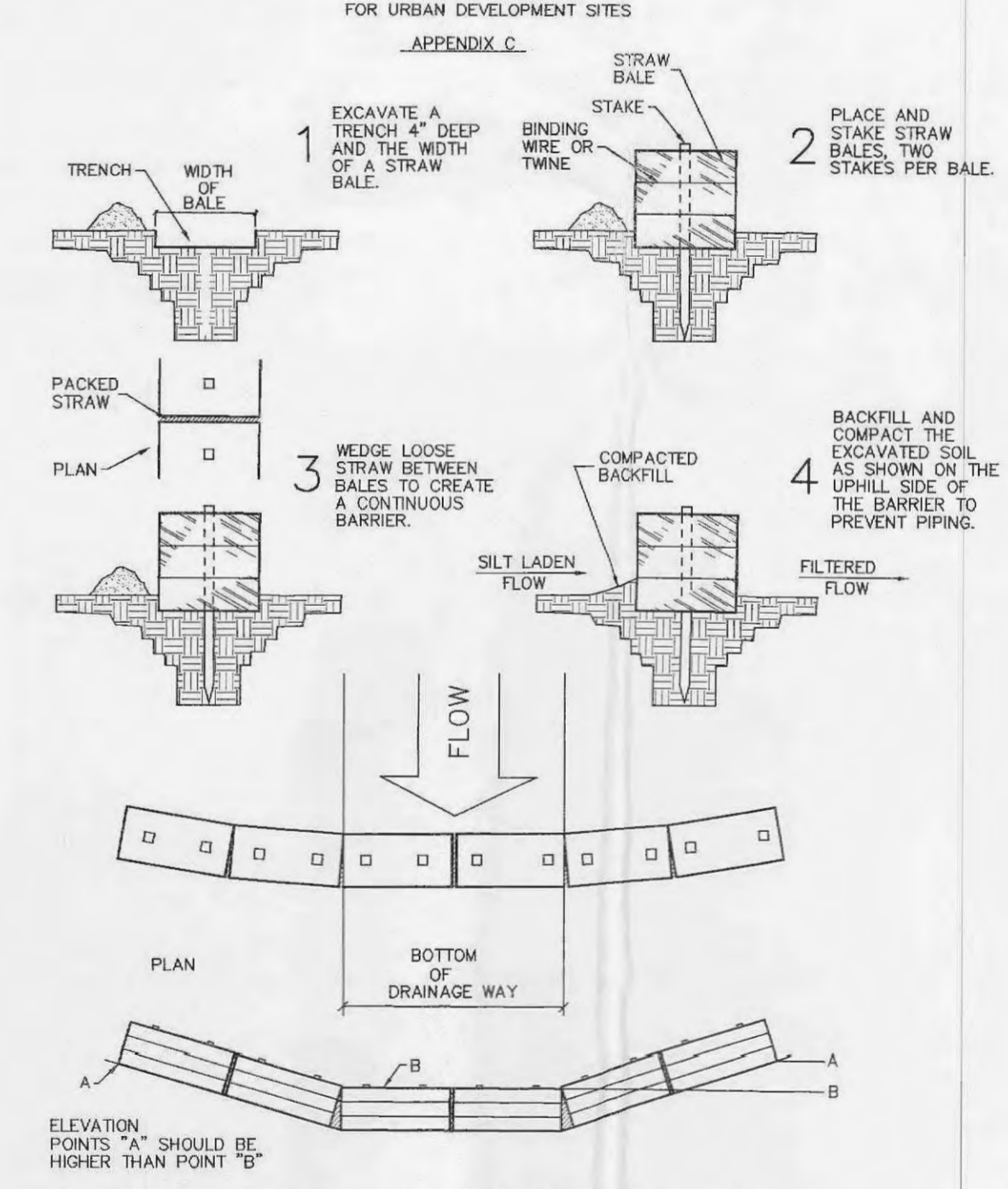

PLACEMENT AND CONSTRUCTION OF STRAW BALE BARRIER

UNDERGROUND UTILITIES HAVE BEEN PLOTTED FROM AVAILABLE INFORMATION AND THEREFORE THEIR LOCATIONS SHALL BE CONSIDERED APPROXIMATE ONLY. THE VERIFICATION OF THE LOCATION OF ALL UNDERGROUND UTILITIES, EITHER SHOWN OR NOT SHOWN ON THESE PLANS SHALL BE THE RESPONSIBILITY OF THE CONTRACTOR, AND SHALL BE LOCATED PRIOR TO ANY GRADING OR CONSTRUCTION OF THE IMPROVEMENTS.