

USER: jkwan TAB: C4.0
 DATE: Jan 10, 2008 12:28pm
 DRAWING: S:\JOBS\082007\07-0178\07-0178\07-0178\DWG\COUNTRYSHIRE CUL-DE-SAC\PLAN_C4.0 GRADING PLAN.dwg

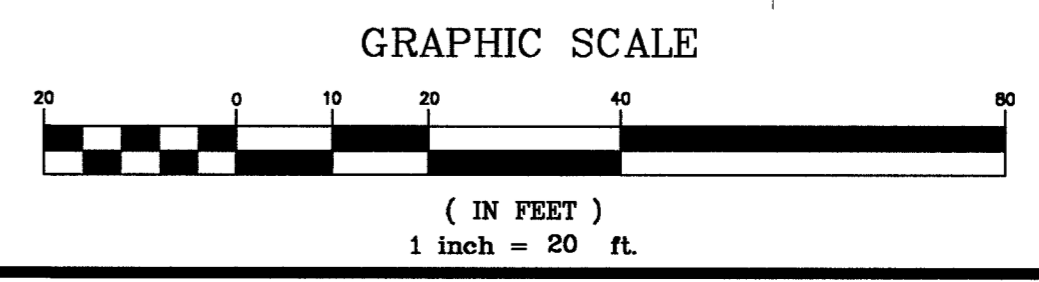
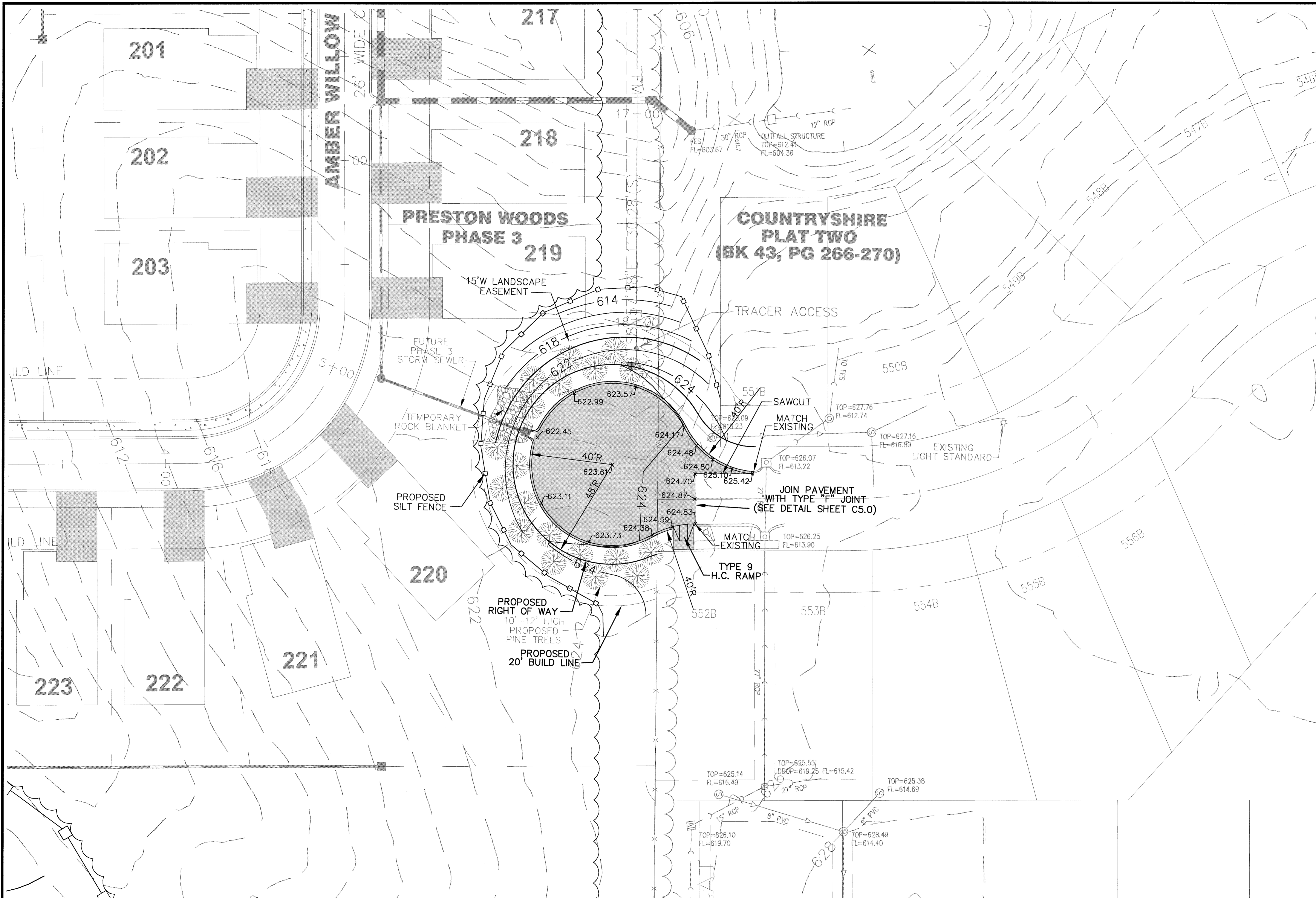

REVISIONS	
DATE	DESCRIPTION
10/9/07	DESIGN
12/3/07	CITY COMMENTS
1/20/08	CITY COMMENTS

DEVELOPER/OWNER:
THE JONES COMPANY HOMES, L.L.C.
 16640 CHESTERFIELD GROVE, SUITE 200
 CHESTERFIELD, MO 63005
 PHONE: (636) 537-7192

THE PROFESSIONAL WHOSE SIGNATURE AND PERSONAL SEAL APPEAR HEREON ASSUMES RESPONSIBILITY ONLY FOR WHAT APPEARS ON THIS PAGE, AND DISCLAIMS ALL OTHER RESPONSIBILITIES. THIS PLAN IS A PRELIMINARY DESIGN AND IS NOT TO BE USED FOR CONSTRUCTION. ESTIMATES, REPORTS, OR OTHER DOCUMENTS OR INSTRUMENTS NOT SEALED BY THE UNDERSIGNED PROFESSIONAL RELATING TO OR INTENDED TO BE USED FOR ANY PART OR PARTS OF THE PROJECT TO WHICH THIS PAGE REFERS.

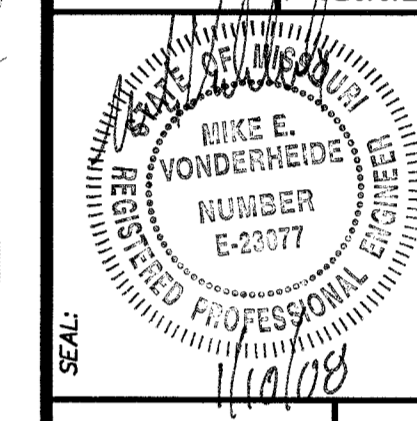

PRESTON WOODS - PHASE II
 OFFSITE CUL-DE-SAC
 PRESTON WOODS LANE
 ST. CHARLES, MO. 63366

GRADING PLAN

planning • engineering • surveying • landscape architecture

Cole and ASSOCIATES INCORPORATED
 10777 sunset office dr.
 saint louis, missouri 63127
 p: 314 984 9887 f: 314 984 0567

DESIGNED BY: JKW
 DRAWN BY: JKW
 CHECKED BY: JFH
 DATE: 8/29/07
 Job Number: 07-0178
 Sheet Number: C4.0