

USER: Mchugh, PLS_C5.3
 DATE: Jun 21, 2006
 DRAWING: S:\055\0505205\05-340\05-340\05-340\PHASE IMPROVEMENT PLANS\PLAN_C5.3 SANITARY PLAN.dwg

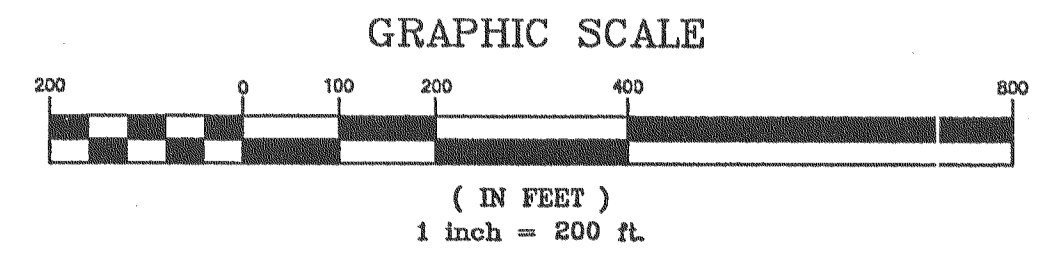
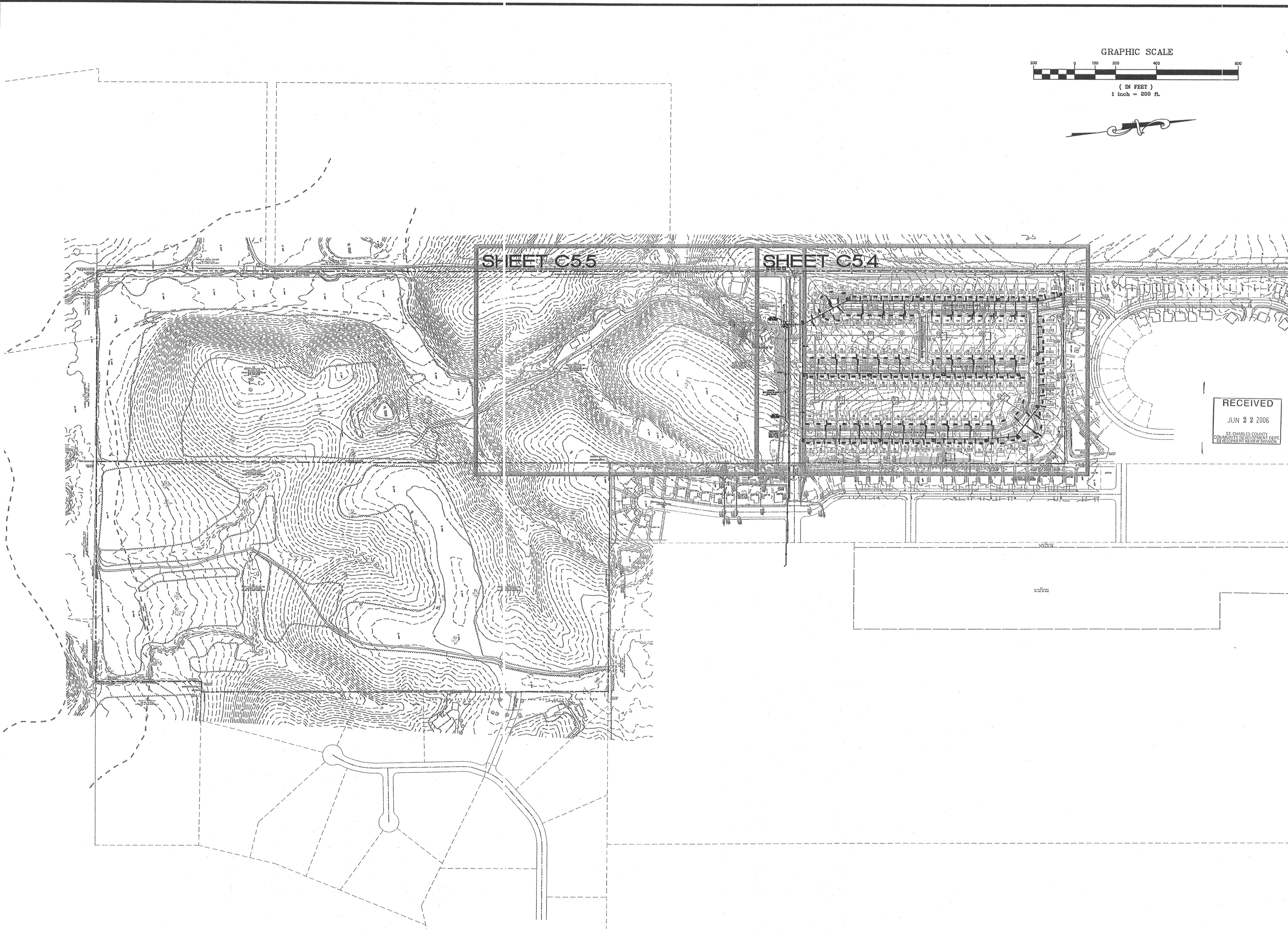

RECEIVED
 JUN 22 2006
 ST. CHARLES COUNTY
 COMMUNITY DEVELOPMENT DEPT
 DEVELOPMENT REVIEW DIVISION

DATE	BY	REVISIONS
4/28/06	JKW	ISSUE
5/18/06	JKW	OWNER/COUNTY COMMENTS
6/7/06	JKW	ST. CHARLES CO. REVIEW COMMENTS
6/7/06	JKW	BUCKETT CREEK SAN DIST COMMENTS
6/7/06	JKW	PWS# 47 REVIEW COMMENTS
6/21/06	JKW	COUNTY COMMENTS

DEVELOPER/OWNER:
 THE JONES COMPANY HOMES, L.L.C.
 16640 CHESTERFIELD GROVE, SUITE 160
 CHESTERFIELD, MO 63005
 PHONE: (636) 637-7192

THE PROFESSIONAL WHOSE SIGNATURE AND PERSONAL SEAL APPEAR HEREON ASSUMES RESPONSIBILITY ONLY FOR WHAT APPEARS ON THIS PLAN AND DESIGN. NO OTHER PROFESSIONAL OR OTHER COMMENTS OR NOTATIONS ARE TO BE ADDED TO THIS PLAN. ANY CHANGES TO THIS PLAN MUST BE MADE BY THE UNDERSIGNED PROFESSIONAL RELATING TO OR REFERRED TO BE USED FOR ANY PART OR PARTS OF THE PROJECT TO WHICH THIS PAGE REFERS.

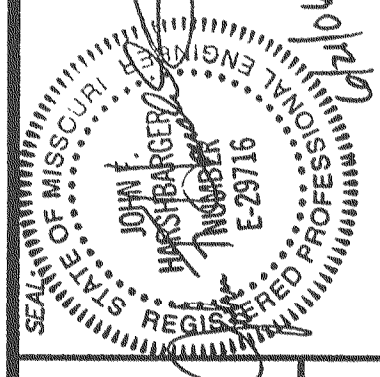

PRESTON WOODS - PHASE I
 IMPROVEMENT PLANS
 RHODES LANE
 ST. CHARLES, MO. 63366
SANITARY SEWER PLAN INDEX

planning • engineering • surveying • landscape architecture
Cole and Associates
 INCORPORATED
 10777 sunset office dr. suite 10
 saint louis, missouri 63127
 p: 314 984 9887 f: 314 984 0587

DESIGNED BY
 JKW
 DRAWN BY
 BJ
 CHECKED BY
 JFH
 DATE
 2/2/06
 Job Number
05-340
 Sheet Number
C5.3