

USER: knight TAB: C6.2
 DATE: Jun 21, 2006 - 1:33pm
 DRAWING: S:\055\055005\05-340\05-340.dwg \PHASE \IMPROVEMENT PLANS\05-340\05-340 STREET PROFILES.dwg

PRESTON WOODS PKWY CONT.

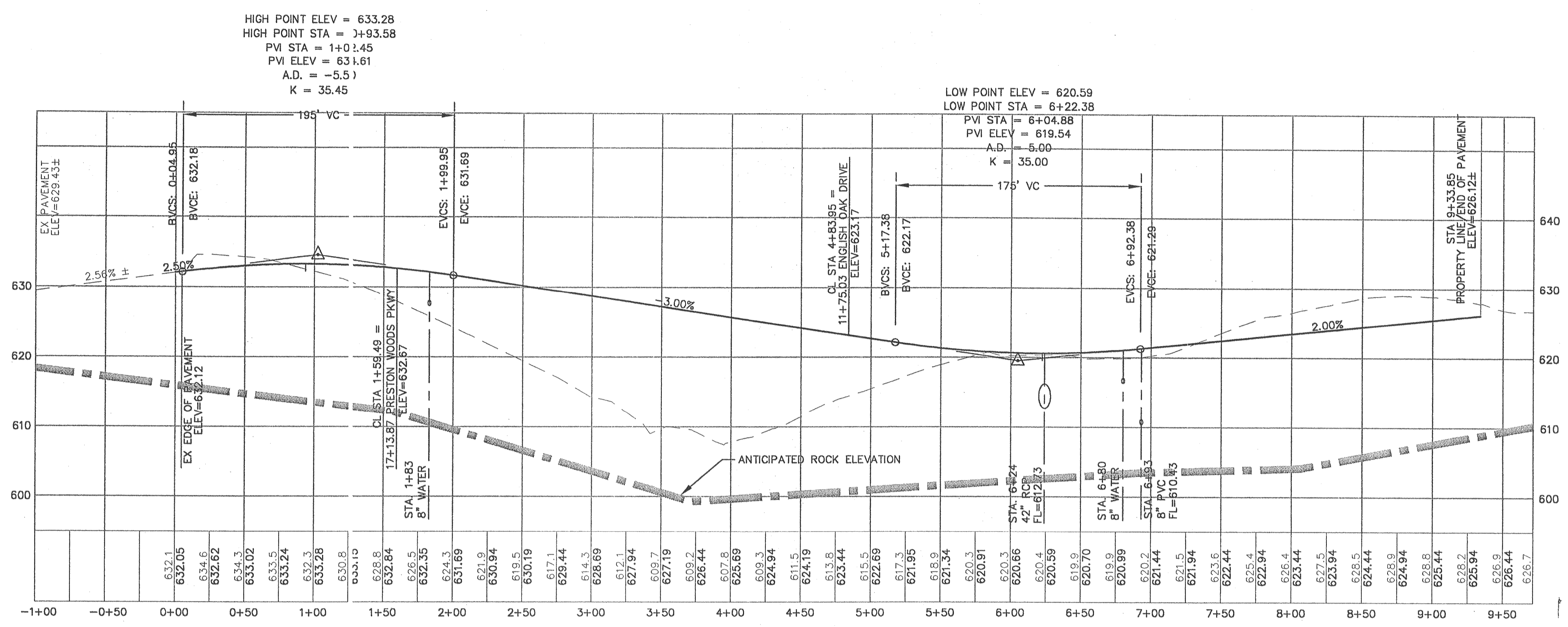

PAUL RENAUD BLVD.

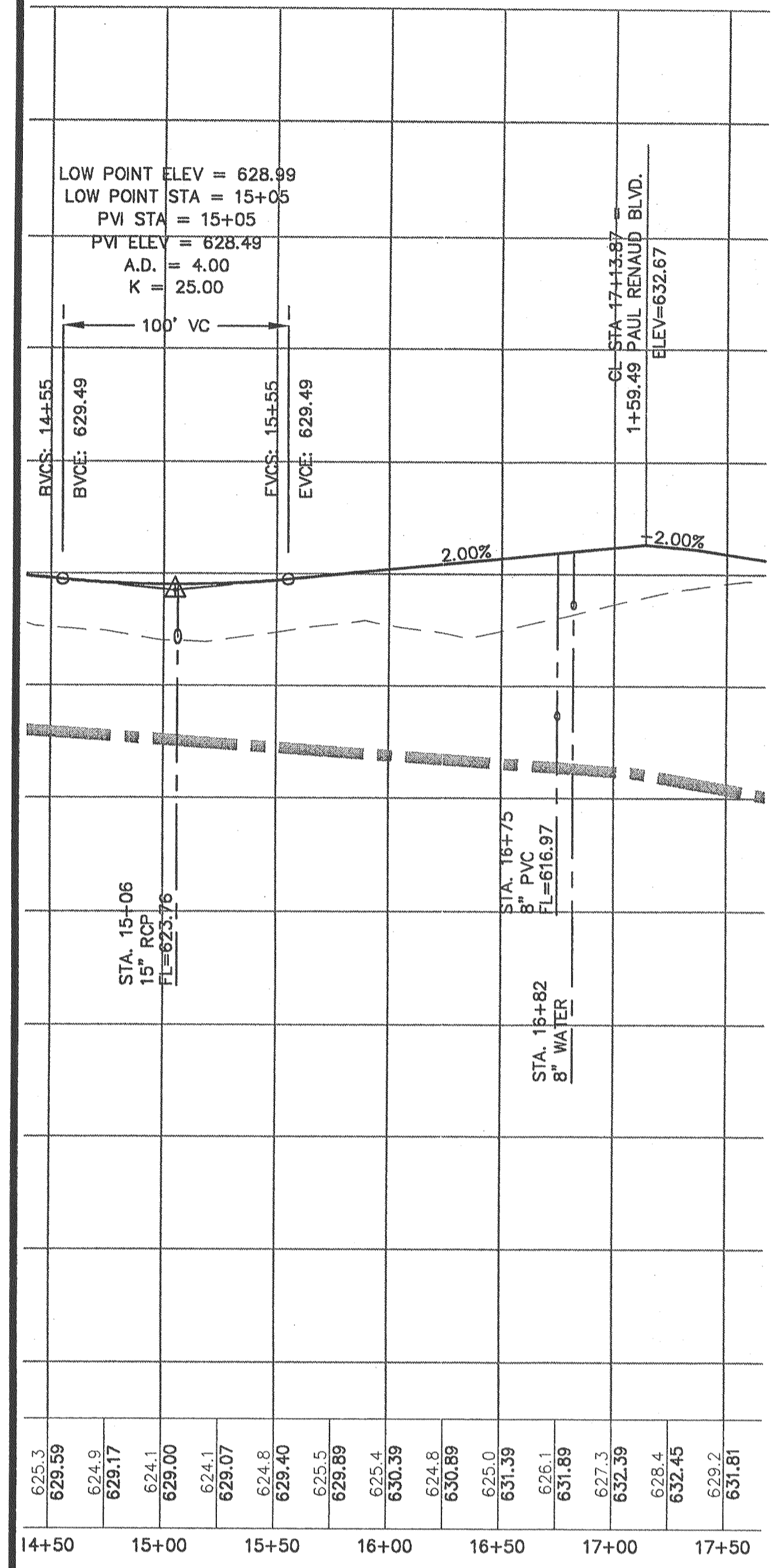
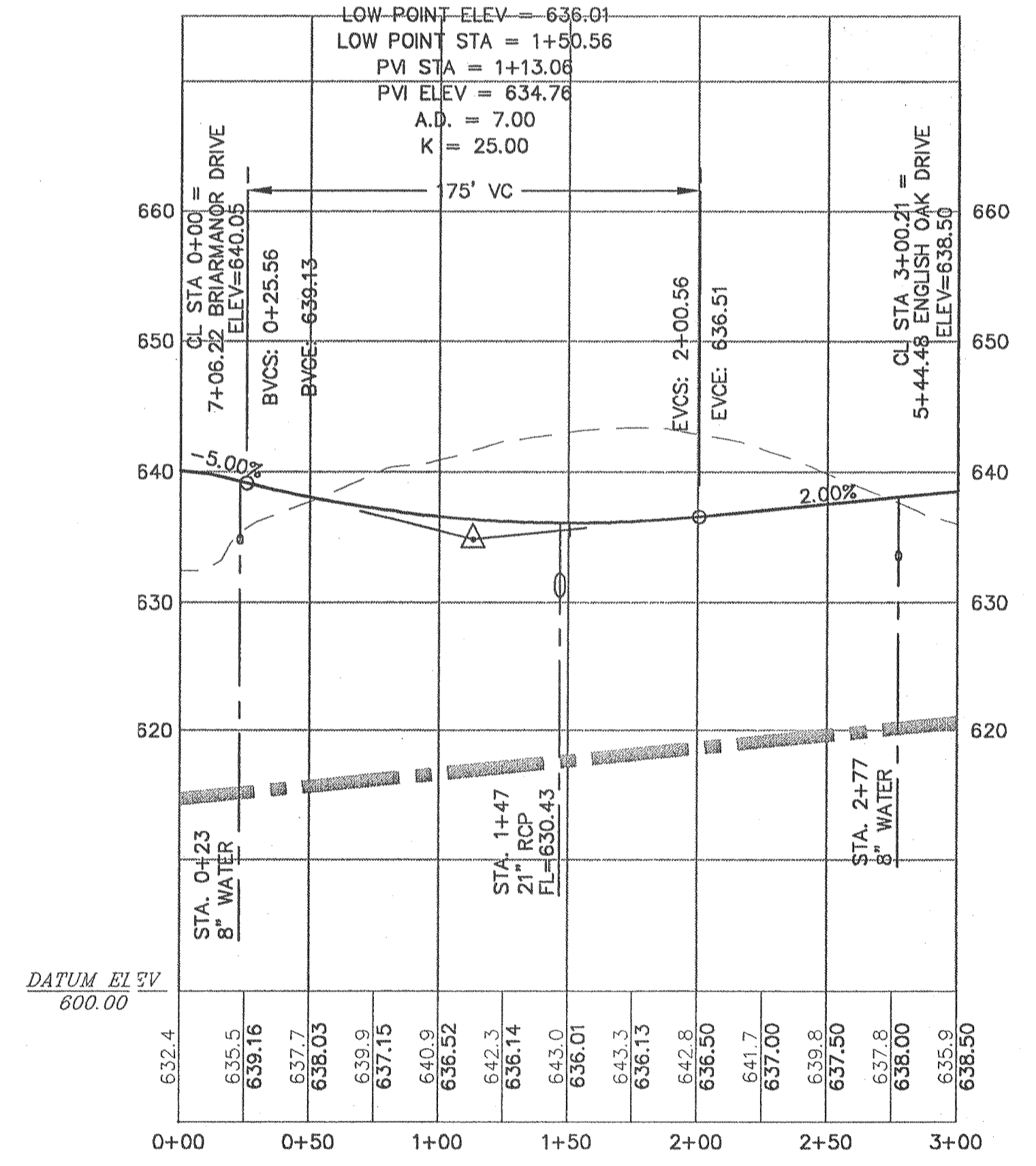

ASPEN MEADOWS DRIVE

RECEIVED
 JUN 22 2006
 ST. CHARLES COUNTY
 COMMUNITY DEVELOPMENT DEPT.
 DEVELOPMENT REVIEW DIVISION

DATE	DESC.	OWNER/COUNTY COMMENTS
4/29/06	A	ST. CHARLES CO. REVIEW COMMENTS
5/18/06	A	ST. CHARLES CO. REVIEW COMMENTS
6/2/06	A	ST. CHARLES CO. REVIEW COMMENTS
6/21/06	A	ST. CHARLES CO. REVIEW COMMENTS

DEVELOPER/OWNER:
THE JONES COMPANY HOMES, L.L.C.
 16640 CHESTERFIELD GROVE, SUITE 100
 CHESTERFIELD, MO 63005
 PHONE: (636) 637-7192

ST. CHARLES COUNTY PROFESSIONAL SEAL
 JOHN H. HARRIS
 REGISTERED PROFESSIONAL ENGINEER
 NUMBER: E-29716

PRESTON WOODS - PHASE I
 IMPROVEMENT PLANS
 RHODES LANE
 ST. CHARLES, MO. 63366
STREET PROFILES

planning • engineering • surveying • landscape architecture
Cole and Associates
 INCORPORATED
 10777 sunset office dr, suite 10
 saint louis, missouri, 63127
 p: 314 984 8687 f: 314 984 0687

DESIGNED BY: JKW
 DRAWN BY: BJ
 CHECKED BY: JFH
 DATE: 2/2/06
 Job Number: 05-340
 Sheet Number: C6.2

SCALE: 1" = 50' HORIZ.
 1" = 10' VERT.